

PLAN LEGEND

--- (dashed line)	DEMOLITION
— (solid line)	EXISTING

- DEMOLITION GENERAL NOTES**
1. WHERE EXISTING WALLS ARE REMOVED, THE CONTRACTOR SHALL REPAIR, LEVEL, AND SMOOTH THE FLOOR, CEILING, AND WALL SURFACES REMAINING TO RECEIVE THE NEW FINISHES.
 2. THE CONTRACTOR SHALL EXERCISE CAUTION WHEN PERFORMING DEMOLITION TO PREVENT THE SPREAD OF DUST AND DEBRIS AND TO PROTECT EXISTING MATERIALS AND FINISHES FROM DAMAGE.
 3. WHERE EXISTING WALLS AND CONCRETE PLANKS ARE TO BE REMOVED, THE CONTRACTOR SHALL OBSERVE EXISTING CONDITIONS AND SHALL TAKE SUCH PRECAUTION AS NECESSARY, INCLUDING THE PLACEMENT OF TEMPORARY SHORING TO SUPPORT THE BUILDING STRUCTURE UNTIL NEW SUPPORTING CONSTRUCTION IS IN PLACE.
 4. WHERE PORTIONS OF EXISTING WALLS ARE TO BE REMOVED TO ALLOW FOR INSTALLATION OF NEW DOORS AND WINDOWS, ROUGH OPENINGS SHALL BE 1/2" LARGER THAN FRAMES, TO ALLOW FOR A 1/4" SHIM SPACE ON ALL SIDES.
 5. DEMOLITION CONTRACTOR SHALL VISIT THE SITE AND FAMILIARIZE HIMSELF WITH EXISTING SITE AND BUILDING CONDITIONS. DEMOLITION DRAWINGS ARE AS THOROUGH AS POSSIBLE, BUT ARE NOT TO BE CONSIDERED EXHAUSTIVE OR COMPREHENSIVE. EVERY ITEM OF THE DEMOLITION CONTRACT SHALL SERVE AS CONFIRMATION OF CONTRACTOR'S KNOWLEDGE OF EXISTING BUILDING AND SITE CONDITIONS.
 6. THE CONTRACTOR SHALL OBSERVE EXISTING CONDITIONS AND SHALL TAKE PRECAUTIONS AS NECESSARY, INCLUDING THE PLACEMENT OF TEMPORARY SHORING TO SUPPORT THE BUILDING STRUCTURE UNTIL NEW SUPPORTING CONSTRUCTION IS IN PLACE.

- DEMOLITION NOTES**
- 1 REMOVE WALLS, DOORS, AND PARTITIONS AS REQUIRED TO COMPLETE NEW CONSTRUCTION AS NOTED.
 - 2 REMOVE EXISTING EQUIPMENT - STORE AND/OR DISPOSE AS DIRECTED BY OWNER'S REPRESENTATIVE.
 - 3 CONTRACTOR TO REMOVE OR REUSE/RELOCATE EXISTING ELECTRICAL OUTLETS/CONNECTIONS ON WALLS, CEILINGS AND IN FLOOR. COORDINATE THROUGH-IN REQUIREMENTS W/ ELECTRICAL DRAWINGS.
 - 4 CONTRACTOR TO REMOVE OR REUSE/RELOCATE EXISTING PLUMBING OUTLETS/CONNECTIONS ON WALLS, CEILINGS AND IN FLOOR. COORDINATE THROUGH-IN REQUIREMENTS W/ PLUMBING DRAWINGS.
 - 5 EXISTING FLOOR FINISHES TO BE REMOVED AS REQUIRED. PREP SURFACES AS REQUIRED FOR NEW FINISHES AS NOTED ON PLANS.
 - 6 EXISTING TO REMAIN.
 - 7 EXISTING WALL FINISHES TO BE REMOVED AS REQUIRED. PREP FOR INSTALLATION OF NEW FINISHES AS NOTED ON PLANS.
 - 8 EXISTING CEILING FINISHES TO BE REMOVED IN THIS AREA. PREP SURFACES AS REQUIRED FOR NEW FINISHES.

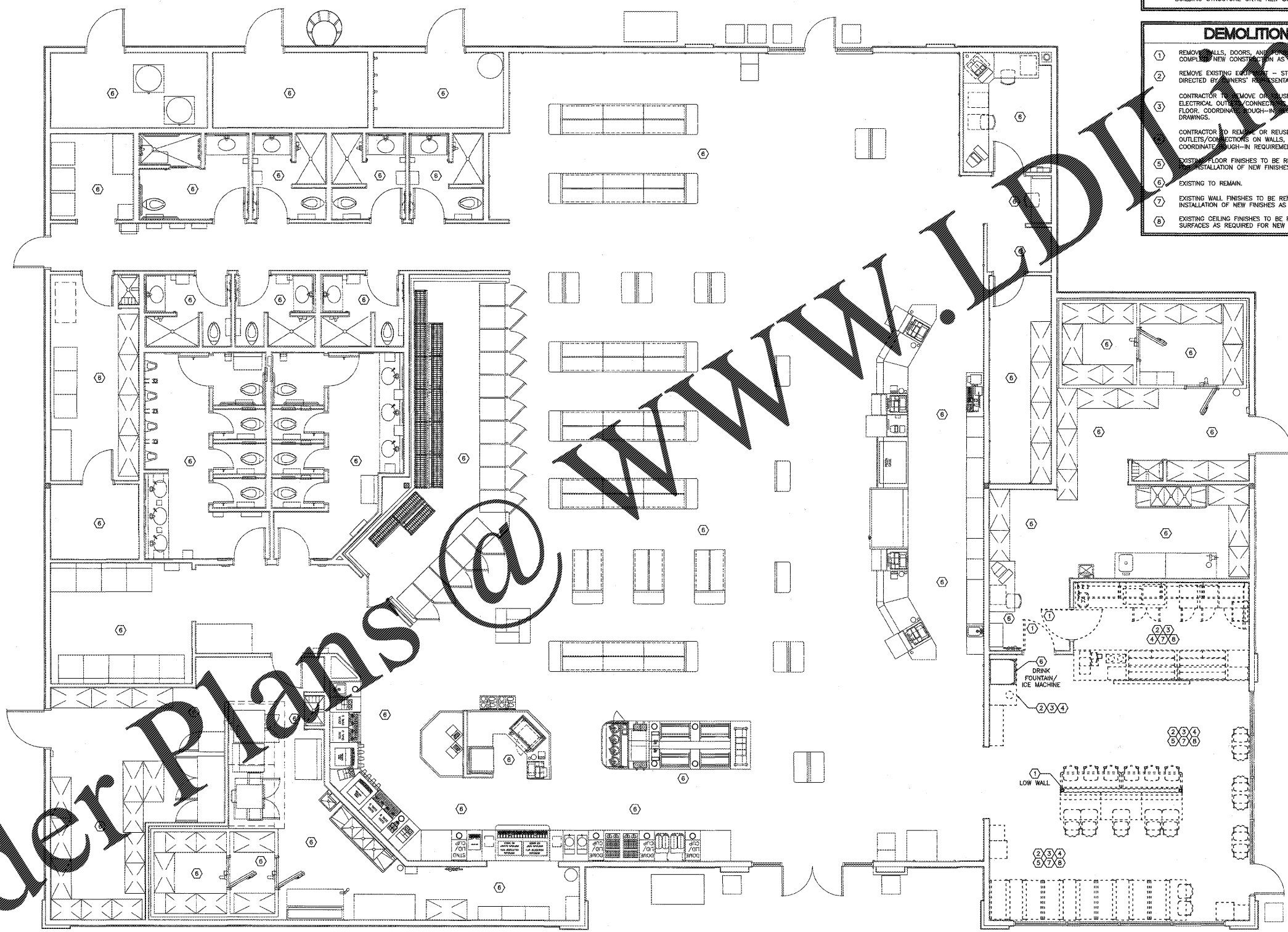

1 DEMOLITION PLAN
D1 3/16" = 1'-0"

DEMOLITION PLAN
PILOT TRAVEL CENTER
130 HONDA DRIVE
LINCOLN, AL 35096

DATE	REV.	REVISION DESCRIPTION	INT.
DATE: 02-16-18			

© COPYRIGHT 2018 (UNPUBLISHED)
PILOT TRAVEL CENTER
THIS DRAWING IS CONFIDENTIAL
NO USE OR DISCLOSURE OF THIS DRAWING
IS PERMITTED, EXCEPT AS EXPRESSLY
AUTHORIZED BY PILOT TRAVEL CENTER

SHEET:
D1