

REVISIONS	BY
1/22/18	

OLIVERI ARCHITECTS
 CA 0218
 Member of the American Institute of Architects
 32707 US Hwy. 19 • Palm Harbor, FL 34684
 Phone: 727.761.7553 • Fax: 727.761.9623
 www.oliveriarchitects.com

All ideas, designs, drawings, and specifications are the property of ARP Engineering, Inc. All rights reserved. No part of this document may be reproduced or copied without the written permission of ARP Engineering, Inc. Copyright © 2017, ARP Engineering, Inc. www.arpengineering.com

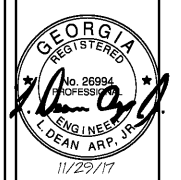

ARP ENGINEERING
 CONSULTING ENGINEERS
 PO BOX 367 • MONROE • NC 28111
 (704) 233-3079

New Free Standing Building for
POPEYE'S
 US Highway 29 & Nease Drive
 Athens, Georgia

Date: 11. 29. 17
 Scale: AS NOTED
 Project Mgr: DS
 Drawn: CAD
 QA Job: 17-083
 AEI Job: 17112
 Sheet

S3

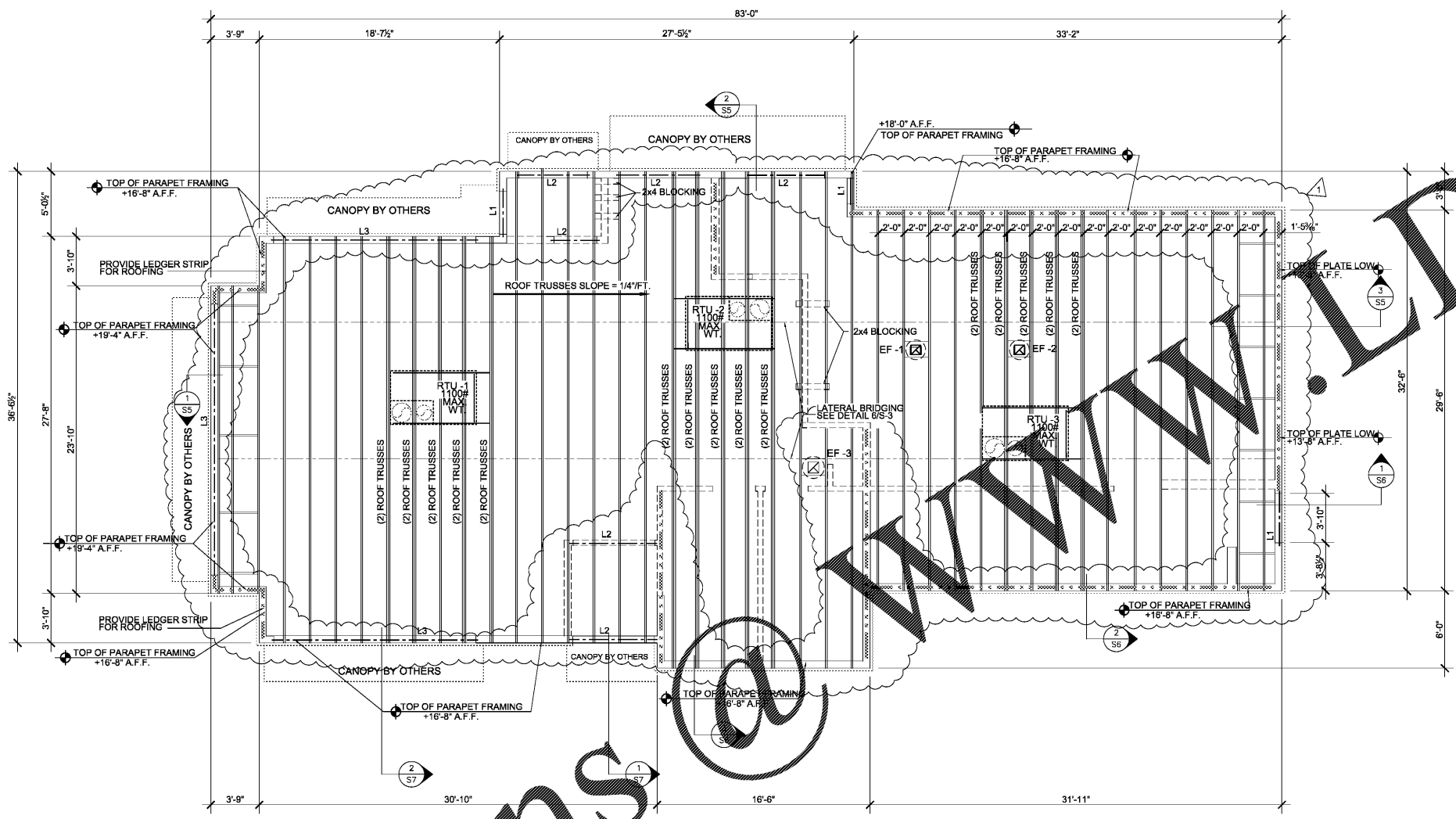

- BEAM & LINTEL NOTES FOR OPENINGS GREATER THAN 6'-4" :**
- BEAR ON STUDS CALLED OUT IN SCHEDULE @ EA. END & PROVIDE FULL HT. STUDS PER SCHEDULE AT EA. END.
 - PROVIDE CS STRAP TO BEARING STUDS AT EA. END OF LINTEL. CS STRAP CONTINUOUS OVER TOP OF LINTEL WITH 16" MIN. OF BEARING LENGTH ON BOTH SIDES OF THE STUD
 - PROVIDE LTT19 ANCHOR AT BASE OF BEARING STUDS.

- ROOF SHEATHING ATTACHMENT:**
- ROOF SHEATHING IS 3/4" (23/32") PLYWOOD APA RATED. SHEATHING EXPOSURE 1.
 - STAGGER END BUTT JOINTS OF PLYWOOD ROOF SHEATHING PANELS BY 4 FT.
 - FASTENER TYPE: 8d COMMON NAILS (0.131x2 1/2" MIN. SHAFT DIA.)
 - FASTENING PATTERN:
 6" oc AT SUPPORTED PLYWOOD EDGES
 12" oc ALONG EACH INTERMEDIATE SUPPORT OF EACH PLYWOOD PANEL
 4" oc AT PERIMETER BLOCKING, DRAG STRUT TRUSSES, & SHEARWALLS

- WOOD TRUSS BRACING NOTES:**
- PROVIDE PERMANENT DIAGONAL 2 X 4 BRACING AT EACH END OF EACH GROUP OF TRUSSES IN THE PLANE OF EACH WEB MEMBER WHICH REQUIRES CONTINUOUS LATERAL BRACING BY TRUSS DESIGN. PROVIDE PERMANENT TOP CHORD AND BOTTOM CHORD LATERAL BRACING MEMBERS 2 X 4'S AT 10 FEET ON CENTER MAX. SPACING. SEE TRUSS DRAWINGS FOR BRACING DETAILS & LOCATIONS.
 - PROVIDE PERMANENT 2 X 4 DIAGONAL BRACING ON BOTTOM CHORDS AT EACH END OF EACH GROUP OF TRUSSES.
 - ATTACH ALL BRACING WITH TWO 16d NAILS AT EACH MEMBER. EACH BRACING MEMBER SHALL BE A MINIMUM OF 8' LONG AND SPAN A MINIMUM OF FOUR TRUSSES. LAP BRACING MEMBERS OVER AT LEAST TWO TRUSSES.

1. ROOF FRAMING PLAN

1. TRUSS BEARING ELEVATION (T.B.E.) IS SHOWN ON PLAN AND MEASURED RELATIVE TO FINISHED FLOOR ELEVATION 100.00' (REF. 0'-0")
2. ALL PRE-ENGINEERED OPEN-WEB ROOF TRUSSES SHALL BE DIAGONALLY BRACED ACCORDING TO MANUFACTURER'S SPECIFICATIONS.
3. ROOF DECKING ON WOOD TRUSSES SHALL CONFORM TO THE FOLLOWING:
 A) 3/4" (23/32") PLYWOOD SHEATHING (APA RATED), 48" PANEL WIDTH w/ A MINIMUM 2 SPAN CONDITION. NAIL AS NOTED.

4. COORD. ALL MECHANICAL UNITS AND THEIR LOCATIONS WITH MECHANICAL CONTRACTOR, ARCHITECT/ENGINEER SHALL BE NOTIFIED OF CHANGES IN LOCATION, WEIGHT OR ADDITION OF ROOF SUPPORTED EQUIPMENT.
5. STEEL FABRICATOR TO COORD. EXACT LOCATION & SIZE OF ROOF OPENINGS WITH G.C. & MECHANICAL CONTRACTOR. ROOF TOP UNIT LOCATIONS SHALL BE SHOWN ON STEEL SHOP DRAWINGS.
6. COORDINATE ALL DIMENSIONS & TRUSS BRG. ELEVATIONS WITH ARCHITECTURAL DRAWINGS. NOTIFY IMMEDIATELY OF ANY DISCREPANCIES.

7. THE FOLLOWING ARE ABBREVIATION DEFINITIONS:
- FOS — INDICATES FACE OF STUD
 - FOB — INDICATES FACE OF BUILDING
 - FFE — INDICATES FINISHED FLOOR ELEVATION
 - TBE — INDICATES TRUSS BEARING ELEVATION
 - P.E. — INDICATES PRE-ENGINEERED
 - F.V. — INDICATES FIELD VERIFY
 - — — INDICATES SHEARWALL SEE SHEET S2 FOR LABELS & NOTES DETAILS ON S8 AT RIGHT.
 - FD — FLOOR DRAIN
 - FS — FLOOR SINK
 - CO — CLEANOUT
 - HD — HUB DRAIN
 - L' — INDICATES LINTEL SEE SCHEDULE THIS SHEET

8. G.C. TO VERIFY LOCATION OF ALL MECHANICAL EQUIPMENT PRIOR TO CONSTRUCTION
9. G.C. TO PROVIDE DOUBLE 2x4 BLOCKING FOR P.O.S MONITOR BRACKETS. G.C. TO SECURE TO TRUSSES PER P.O.S VENDOR DIRECTION.
10. ROOF IS NOT DESIGNED TO SUPPORT ANY FUTURE MECHANICAL EQUIPMENT OR ANY OTHER LOADS.

LINTEL SCHEDULE

MARK	WALL	DESCRIPTION	14" MAXIMUM SPACING	MAX. SPACING	TYPE	HOLD DOWN ANCHORS
L1	248	2-2x4 STRIP No. 2 W/ (2) 1" PLYWOOD FLUSHES	(1)2-04	(2)2-04	4'-0"	1
L2	248	2-2x4 STRIP No. 2 W/ (2) 1" PLYWOOD FLUSHES	(2)2-04	(2)2-04	6'-4"	1
L3	248	3-1 1/2"x4" LVL, 1.5E 2800PS-B-42E	(2)2-04	(2)2-04	3'-0" EXTERIOR	1

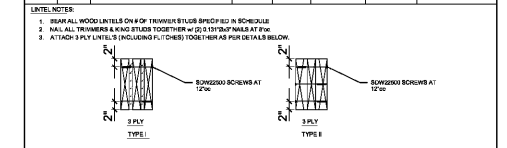

Order Plans

WWW.DLINE.COM