

**GENERAL NOTES**

- TRANSITION LINE OF TILE TO BE HIDDEN UNDER FRONT LINE MILLWORK.
- MIX-UP FLOOR TILES BOXES WHEN INSTALLING.
- SEE SLAB PENETRATION PLAN ON SHEET A10 FOR CORE DRILL TABLE LOCATIONS.
- FREEZER WITH FLOOR SUPPLIED BY K.E.S. FREEZER FLOOR TO SET ON TOP OF FLOOR TILE.

**GENERAL NOTES**

- FLOOR TRANSITION LINE
- FREEZER/COOLER - SEE DETAIL C/A2
- SLAB RECESS FOR MOP SINK SEE DETAIL V/AB2
- STAINLESS STEEL CAP & SOFFIT - G.C. TO INSTALL
- G.C. - COORDINATE TILE FLOOR/BASE AT H-CABINET

**ROOM FINISH SCHEDULE**

| NO. | ROOM NAME      | FLOOR CODE | BASE CODE | WALL CODE                      | CEILING CODE   | NOTES                                      |
|-----|----------------|------------|-----------|--------------------------------|----------------|--|
| 101 | ENTRY          | T-1        | CB-1      | SEE INT. ELEV.                 | ACOU-1, GRID-1 |  |
| 102 | ENTRY          | T-1        | CB-1      | SEE INT. ELEV.                 | ACOU-1, GRID-1 |  |
| 103 | DINING AREA    | T-1        | CB-1      | SEE INT. ELEV.                 | ACOU-1, GRID-1 |  |
| 104 | SALES AREA     | T-1        | CB-1      | SEE INT. ELEV.                 | ACOU-1, GRID-1 |  |
| 105 | SERVICE AREA   | GT-1       | GT-2      | W-1, SEE INT. ELEV.            | ACOU-1, GRID-1 | BULKHEAD CEILING TO BE GFBD-1, PAINTED P-8 |
| 106 | DRIVE-THRU     | GT-1       | GT-2      | W-1, SEE INT. ELEV.            | ACOU-2, GRID-2 | BULKHEAD CEILING TO BE GFBD-1, PAINTED P-8 |
| 107 | KITCHEN        | GT-1       | GT-2      | W-1, SEE INT. ELEV.            | ACOU-2, GRID-2 |  |
| 108 | OFFICE         | GT-1       | GT-2      | W-1, SEE INT. ELEV.            | ACOU-2, GRID-2 |  |
| 109 | PREP AREA      | GT-1       | GT-2      | W-1, SEE INT. ELEV.            | ACOU-2, GRID-2 |  |
| 110 | NOT USED       | --         | --        | --                             | --             |  |
| 111 | KITCHEN        | GT-1       | GT-2      | W-1, SEE INT. ELEV.            | ACOU-2, GRID-2 |  |
| 112 | WOMEN'S TOILET | T-1        | CB-1      | P-10, P-2, T-3, SEE INT. ELEV. | GFBD-1, P-8    |  |
| 113 | MEN'S TOILET   | T-1        | CB-1      | P-10, P-2, T-3, SEE INT. ELEV. | GFBD-1, P-8    |  |
| 114 | CORRIDOR       | T-1        | CB-1      | SEE INT. ELEV.                 | ACOU-1, GRID-1 |  |
| 115 | CLOSET         | T-1        | CB-1      | SEE INT. ELEV.                 | ACOU-1, GRID-1 |  |

1. REFER TO INTERIOR ELEVATIONS SHEET A10 AND A30 FOR PROPER WALL FINISHES.

**FLOOR FINISH MATERIAL SCHEDULE**

| CODE | MATERIAL       | MANUFACTURER         | COLOR             | SPECIFICATION | DESCRIPTION / REMARKS                            |
|------|----------------|----------------------|-------------------|---------------|--|
| T-1  | PORCELAIN TILE | INTERCERAMIC         | FRENCH BROWN      | CUSTOM        | 3" X 18" FLOOR TILE / FIELD DINING AND RESTROOMS |
| CB-1 | PORCELAIN TILE | INTERCERAMIC         | FRENCH BROWN      | CUSTOM        | 6" X 18" COVE BASE / DINING AREA BASE            |
| G-1  | GROUT          | CUSTOM BLDG. PRODUCT | 145 - LIGHT SMOKE | POLYBLEND     | SANDED OR EPOXY BLEND / DINING ROOM GROUT        |
| GT-1 | QUARRY TILE    | INTERCERAMIC         | MATYFLUER RED 31A | QUARRY BASICS | ABRASIVE 6" X 6" KITCHEN AREA FLOOR              |
| GT-2 | QUARRY TILE    | INTERCERAMIC         | MATYFLUER RED 31A | QUARRY BASICS | QUARRY 6" X 6" COVE BASE / KITCHEN AREA BASE     |
| G-2  | GROUT          | CUSTOM BLDG. PRODUCT | 6-2 - CHARCOAL    | POLYBLEND     | SANDED OR EPOXY BLEND / KITCHEN AREA GROUT       |

**WALL AND DOOR FINISH MATERIAL SCHEDULE**

| CODE  | MATERIAL                             | MANUFACTURER         | COLOR   | SPECIFICATION                   | DESCRIPTION / REMARKS                                       |
|-------|--------------------------------------|----------------------|---|---------------------------------|---|
| P-1   | ACRYLIC LATEX                        | BENJAMIN MOORE       | 2199-30 "APPLE CRISP"                                 | PRIME / PAINT                   | 1 COAT 912 PRIMER, 2 COATS, ULTRA SPEC 9000 SUGHELL         |
| P-2   | ACRYLIC LATEX                        | BENJAMIN MOORE       | 2146-10 "DARK CELERY"                                 | PRIME / PAINT                   | 1 COAT 912 PRIMER, 2 COATS, ULTRA SPEC 9000 SUGHELL         |
| P-3   | ACRYLIC LATEX                        | BENJAMIN MOORE       | 2004-10 "DEEP ROSE"                                   | PRIME / PAINT                   | 1 COAT 912 PRIMER, 2 COATS, ULTRA SPEC 9000 SUGHELL         |
| P-6   | ACRYLIC LATEX                        | BENJAMIN MOORE       | 2199-30 "APPLE CRISP"                                 | PRIME / PAINT                   | 1 COAT 912 PRIMER, 2 COATS, ULTRA SPEC 9000 SUGHELL         |
| P-7   | ACRYLIC LATEX                        | BENJAMIN MOORE       | R4: BRONZETONE (2134-20)                              | PRIME / PAINT                   | 1 COAT 912 PRIMER, 2 COATS 916 SEMI-GLOSS                   |
| AP-1  | CANVAS                               | GRAPHICS VENDOR      | AP-1 "12 HOURS"                                       | DIGITALLY PRINTED               | FRAME, WALL GRAPHIC 36" X 48"                               |
| AP-2  | CANVAS                               | GRAPHICS VENDOR      | AP-2 "TRINITY"  | DIGITALLY PRINTED               | FRAME, WALL GRAPHIC 36" X 48"                               |
| AP-3  | CANVAS                               | GRAPHICS VENDOR      | AP-3 "BUTTERMILK BISCUITS"                            | DIGITALLY PRINTED               | FRAME, WALL GRAPHIC 36" X 48"                               |
| AP-4  | CANVAS                               | GRAPHICS VENDOR      | AP-4 "PURE CANE"                                      | DIGITALLY PRINTED               | FRAME, WALL GRAPHIC 36" X 48"                               |
| AP-5  | CANVAS                               | GRAPHICS VENDOR      | AP-5 "RED BEANS & RICE"                               | DIGITALLY PRINTED               | FRAME, WALL GRAPHIC 36" X 48"                               |
| AP-10 | WOOD FLANK                           | GRAPHICS VENDOR      | AP-10 "LOUISIANA KITCHEN"                             | STORY GRAPHIC                   | WALL GRAPHIC 36" X 48"                                      |
| AP-11 | PAINTED                              | GRAPHICS VENDOR      | AP-11 "PAINTED POPEYE'S SEAL"                         | "1" LK LOGO                     | CLEAR FIN TONGUE AND GROOVE FLANK WALL GRAPHIC, 1" DIA. FIN |
| AP-12 | PLYWOOD                              | GRAPHICS VENDOR      | AP-12 "DIM. POPEYE'S SEAL"                            | "2" LK LOGO                     | CLEAR FIN TONGUE AND GROOVE FLANK WALL GRAPHIC, 1" DIA. FIN |
| T-2   | MOSAIC TILE                          | INTERCERAMIC         | MARDI GRAS CARNIVAL                                   | SERIES DB PATTRN / BORDR / MURL | 6" STRIP  |
| T-2   | PORCELAIN TILE                       | INTERCERAMIC         | GOLD MEMBER   | NOT                             | 18" X 18" BULLNOSE  |
| T-2   | PORCELAIN TILE                       | INTERCERAMIC         | GOLD MEMBER   | NOT                             | 18" X 18"   |
| P-10  | EPOXY PAINT                          | BENJAMIN MOORE       | 2199-30 "APPLE CRISP"                                 | PRIME / PAINT                   | 1 COAT 912 PRIMER, 2 COATS 916 SEMI-GLOSS                   |
| US-1  | FAUX WOODGRAIN                       | CUSTOM BLDG. PRODUCT | 145 - LIGHT SMOKE                                     | POLYBLEND                       | SANDED OR EPOXY BLEND                                       |
| CR-1  | 4"X12" SOLID MAPLE                   | SEATING VENDOR       | 50/50 BLEND OF MOHAWK DARK FRUITWOOD STAIN #845-D4641 | MAPLE                           | 1 COAT VARTATHANE WATER BASED POLYURETHANE SEMI-GLOSS       |
| TR-1  | 1 1/2"X1 1/4" MAPLE                  | SEATING VENDOR       | 50/50 BLEND OF MOHAWK DARK FRUITWOOD STAIN #845-D4641 | MAPLE                           | 1 COAT VARTATHANE WATER BASED POLYURETHANE SEMI-GLOSS       |
| CG-1  | 1" X 1/4" MAPLE                      | SEATING VENDOR       | 50/50 BLEND OF MOHAWK DARK FRUITWOOD STAIN #845-D4641 | MAPLE                           | 1 COAT VARTATHANE WATER BASED POLYURETHANE SEMI-GLOSS       |
| UC-1  | 1/8" FINE TONGUE & GROOVE WALL FLANK | GRAPHICS VENDOR      | 50/50 BLEND OF MOHAWK DARK FRUITWOOD STAIN #845-D4641 | NATURAL WOOD                    | 1 COAT VARTATHANE WATER BASED POLYURETHANE SEMI-GLOSS       |
| LP-83 | METAL                                | GRAPHICS VENDOR      | AE-1 "LOUISIANA KITCHEN RING"                         | "1" LK LOGO                     | CIRCULAR SUSPENDED SOFFIT                                   |
| W-1   | FRP SHEET                            | MAR                  | FRP   | FRP                             | KITCHEN WALLS, PEBBLE FINISH                                |
| SW-1  | WINDOW BILLS SOLID WOOD MAPLE        | SEATING VENDOR       | 50/50 BLEND OF MOHAWK DARK FRUITWOOD STAIN #845-D4641 | MAPLE                           | 1 COAT VARTATHANE WATER BASED POLYURETHANE SEMI-GLOSS       |
| ST-1  | RESTROOM KITCHEN DOORS - SOLID WOOD  | GENERAL CONTRACTOR   | 50/50 BLEND OF MOHAWK DARK FRUITWOOD STAIN #845-D4641 | MAPLE                           | 1 COAT VARTATHANE WATER BASED POLYURETHANE SEMI-GLOSS       |
| ST-1  | RESTROOM KITCHEN DOORS - SOLID WOOD  | GENERAL CONTRACTOR   | 50/50 BLEND OF MOHAWK DARK FRUITWOOD STAIN #845-D4641 | MAPLE                           | 1 COAT VARTATHANE WATER BASED POLYURETHANE SEMI-GLOSS       |
| HW-1  | DOOR HARDWARE                        | GENERAL CONTRACTOR   | BATH NICKEL   | ALL                             | BATH DOOR HARDWARE  |

**CEILING FINISH MATERIAL SCHEDULE**

| CODE   | MATERIAL                            | MANUFACTURER         | COLOR                 | SPECIFICATION                  | DESCRIPTION / REMARKS                                   |
|--------|-------------------------------------|----------------------|-----------------------|--------------------------------|---|
| P-8    | EPOXY PAINT                         | BENJAMIN MOORE       | 2169-10 RACING ORANGE | PRIME / PAINT                  | MENUBOARD BULKHEAD, 912 PRIMER, 916 SEMI-GLOSS          |
| P-9    | EPOXY PAINT                         | BENJAMIN MOORE       | 1061 BLONE WOOD       | PRIME / PAINT                  | RESTROOM CEILING, 1 COAT 912 PRIMER, 2 COAT 916 S/GLOSS |
| GT-1   | ACCOUSTICAL TILE                    | G.C. / USG INTERIORS | "1"01-BL              | GLACIER                        | DINING ROOM CEILING, SHADOW LINE FINISH                 |
| GRID-1 | 3/8" EXPOSED GRID                   | G.C. / USG INTERIORS | WHITE                 | DONN DXL                       | DINING GRID, FLAT FINISH                                |
| ACOU-1 | 6"X6" FIBERGLASS                    | G.C. / USG INTERIORS | 3710 - WHITE          | SHERROCK BRAND GLAFIBLUS VINYL | RESTROOM CEILING FINISH, 24"X24" @ SERVICE AREA         |
| GRID-2 | 1/8" DBL-DEB HOT DIPPED GALV. STEEL | G.C. / USG INTERIORS | WHITE                 | DONN DXL ENVIRONMENTAL         | KITCHEN GRID, FLAT FINISH                               |

**SERVICE COUNTERS MATERIAL SCHEDULE**

| CODE | MATERIAL    | MANUFACTURER          | COLOR   | SPECIFICATION                   | DESCRIPTION / REMARKS  |
|------|-------------|-----------------------|---|---------------------------------|--|
| SS-1 | HI-MAC      | LG HAUBYS AMERICA     | ST 917  | CAYENNE                         | SERVICE COUNTERTOPS, SMOOTH FINISH                               |
| FL-2 | LAMINATE    | FORMICA               | FLANKED DELUDE PEAR                                   | 6206-43                         | CABINETRY/DOORS, MATTE FINISH                                    |
| M-1  | MOSAIC TILE | INTERCERAMIC          | MARDI GRAS CARNIVAL                                   | SERIES DB PATTRN / BORDR / MURL | FRONT COUNTER SURFACE, 1 1/2" MOSAIC TILE ON 12"X12" MESH SHEETS |
| G-1  | GROUT       | CUSTOM BLDG. PRODUCTS | 145 - LIGHT SMOKE                                     | POLYBLEND                       | ACCENT TILE GROUT, NON-SANDED OR EPOXY BLEND                     |
| ST-1 | MAPLE WOOD  | GENERAL CONTRACTOR    | 50/50 BLEND OF MOHAWK DARK FRUITWOOD STAIN #845-D4641 | MAPLE                           | 1 COAT VARTATHANE WATER BASED POLYURETHANE SEMI-GLOSS            |

**SEATING/TABLES & DECOR MATERIAL SCHEDULE**

| CODE  | MATERIAL             | MANUFACTURER          | COLOR  | SPECIFICATION                   | DESCRIPTION / REMARKS   |
|-------|----------------------|-----------------------|--|---------------------------------|---|
| LP-30 | LAMINATE             | FORMICA               | FLANKED DELUDE PEAR  | 6206-43                         | TABLE TOPS (A-LIGHT), MATTE FINISH  |
| LP-32 | STEEL                | SEATING VENDOR        | TCI-CHROME II POWDER 9911-010201   | POWDER COATED                   | TABLE BASE  |
| TH-1  | VINYL                | CHARTER INDUSTRIES    | HJ BEIGE   | T-MOLD-4245                     | T-MOLDINGS, MATTE FINISH  |
| LP36  | HI-MAC               | LG HAUBYS AMERICA     | ORANGE   | 9 21                            | 96-2 P. COUNTER TOP, SMOOTH FINISH  |
| LP36  | HI-MAC               | LG HAUBYS AMERICA     | FIERY RED  | 9 25                            | 96-3 P. COUNTER TOP, SMOOTH FINISH  |
| LP36  | LAMINATE             | FORMICA               | DARK CHOCOLATE 2202  | 9 25                            | P. COUNTER BASE, MATTE FINISH   |
| LP36  | COVE BASE            | JOHNSONITE            | BROWN  | TOELESS "CBT-40 20"             | P. COUNTER BASE   |
| LP36  | MOSAIC TILE          | INTERCERAMIC          | MARDI GRAS CARNIVAL  | SERIES DB PATTRN / BORDR / MURL | WALL PARTITION WITH SPICE RACK AND WALL PARTITION, 1 1/2" MOSAIC TILE ON 12"X12" MESH SHEETS, 6" STRIP                          |
| LP36  | GROUT                | CUSTOM BLDG. PRODUCTS | 145 - LIGHT SMOKE  | POLYBLEND                       | WALL PARTITION WITH SPICE RACK AND WALL PARTITION, NON-SANDED OR EPOXY BLEND  |
| LP36  | METAL                | STEEL                 | TCI-CHROME II POWDER 9911-010201   | POWDER COATED                   | WALL PARTITION WITH SPICE RACK AND WALL PARTITION   |
| LP36  | WOOD                 | SEATING VENDOR        | 50/50 BLEND OF MOHAWK DARK FRUITWOOD STAIN #845-D4641  | MAPLE                           | WALL PARTITION WITH SPICE RACK AND WALL PARTITION, 1 COAT VARTATHANE WATER BASED POLYURETHANE SEMI-GLOSS                        |
| LP36  | COVE BASE            | JOHNSONITE            | BROWN  | TOELESS "CBT-40 20"             | WALL PARTITION WITH SPICE RACK AND WALL PARTITION   |
| LP36  | LAMINATE             | FORMICA               | FLANKED DELUDE PEAR  | 6206-43                         | WALL PARTITION WITH SPICE RACK AND WALL PARTITION, MATTE FINISH   |
| LP36  | METAL / MOULDED      | SEATING VENDOR        | RAL3004, TCI9840-30019R  | METAL LEGS                      | CHAIR - RED W/ WOOD SEAT, BAR STOOL   |
| LP36  | METAL / MOULDED      | SEATING VENDOR        | SHERWIN WILLIAMS REDUCIBLE WIPING STAIN BROWN, 84-DUNBROU-0389 MIXED WITH WATER AT 3:1 RATIO | MOULDED WOODEN SEAT             | CHAIR - RED W/ WOOD SEAT, BAR STOOL, 1 COAT VARTATHANE WATER BASED POLYURETHANE SEMI-GLOSS                                      |
| LP36  | FIBERGLASS SEAT      | POLYSTONE             | TCI-CHROME II POWDER 9911-010201   | METAL LEGS                      | CHAIR - RED W/ WOOD SEAT, BAR STOOL   |
| LP36  | FIBERGLASS SEAT      | POLYSTONE             | PBL2066-RANB66   | ROCK ISLAND                     | BOOTH/STRAIGHT SETTEE, FIBERGLASS SEAT & UPHOLSTERED BACK PAD   |
| LP23  | UPHOLSTERED BACK PAD | ARC COM               | PAFRIKA 40   | UOVEN CONNECTIONS - URBAN       | BOOTH/STRAIGHT SETTEE, NANOTEX STAIN RESISTANT FINISH / ACRYLIC BACKING   |
| LP23  | WOOD                 | SEATING VENDOR        | 50/50 BLEND OF MOHAWK DARK FRUITWOOD STAIN #845-D4641  | MAPLE                           | BOOTH/STRAIGHT SETTEE, WALL PARTITION WITH SPICE RACK AND WALL PARTITION, 1 COAT VARTATHANE WATER BASED POLYURETHANE SEMI-GLOSS |
| LP26  | COVE BASE            | JOHNSONITE            | BROWN  | TOELESS "CBT-40 20"             | BOOTH/STRAIGHT SETTEE   |
| LP26  | FIBERGLASS SEAT      | POLYSTONE             | POLYSTONE PBL2066-RANB66   | ROCK ISLAND                     | CURVED SETTEE, FIBERGLASS SEAT & UPHOLSTERED BACK PAD   |
| LP26  | UPHOLSTERED BACK PAD | ARC COM               | PAFRIKA 40   | UOVEN CONNECTIONS - URBAN       | CURVED SETTEE, NANOTEX STAIN RESISTANT FINISH / ACRYLIC BACKING   |
| LP26  | MOSAIC TILE          | INTERCERAMIC          | MARDI GRAS CARNIVAL  | SERIES DB PATTRN / BORDR / MURL | CURVED SETTEE, 1 1/2" MOSAIC TILE ON 12"X12" MESH SHEETS, 6" STRIP  |
| LP26  | GROUT                | CUSTOM BLDG. PRODUCTS | 145 - LIGHT SMOKE  | POLYBLEND                       | CURVED SETTEE, NON-SANDED OR EPOXY BLEND  |
| LP26  | METAL                | STEEL                 | TCI-CHROME II POWDER 9911-010201   | POWDER COATED                   | CURVED SETTEE   |
| LP26  | WOOD                 | SEATING VENDOR        | 50/50 BLEND OF MOHAWK DARK FRUITWOOD STAIN #845-D4641  | MAPLE                           | CURVED SETTEE, WALL PARTITION WITH SPICE RACK AND WALL PARTITION, 1 COAT VARTATHANE WATER BASED POLYURETHANE SEMI-GLOSS         |
| LP26  | COVE BASE            | JOHNSONITE            | BROWN  | TOELESS "CBT-40 20"             | CURVED SETTEE   |
| LL-1  | GLASS PENDANT        | HERITAGE LIGHTING     | "EDJ311  | RED GLASS CYLINDR               | PENDANT LIGHTS  |
| LL-2  | PENDANT              | HERITAGE LIGHTING     | FP34631216A  | CRAB POT                        | PENDANT LIGHTS  |
| LP41  | GLASS PENDANT        | HERITAGE LIGHTING     | MULTIPLE   | FLAVORITY                       | PENDANT LIGHTS  |
| LP41  | LAMINATE             | FORMICA               | FLANKED DELUDE PEAR  | 6206-43                         | TRASH RECEPTILES, MATTE   |
| LP43  | HI-MAC               | LG HAUBYS AMERICA     | 921  | ORANGE                          | TRASH RECEPTILES, SMOOTH  |

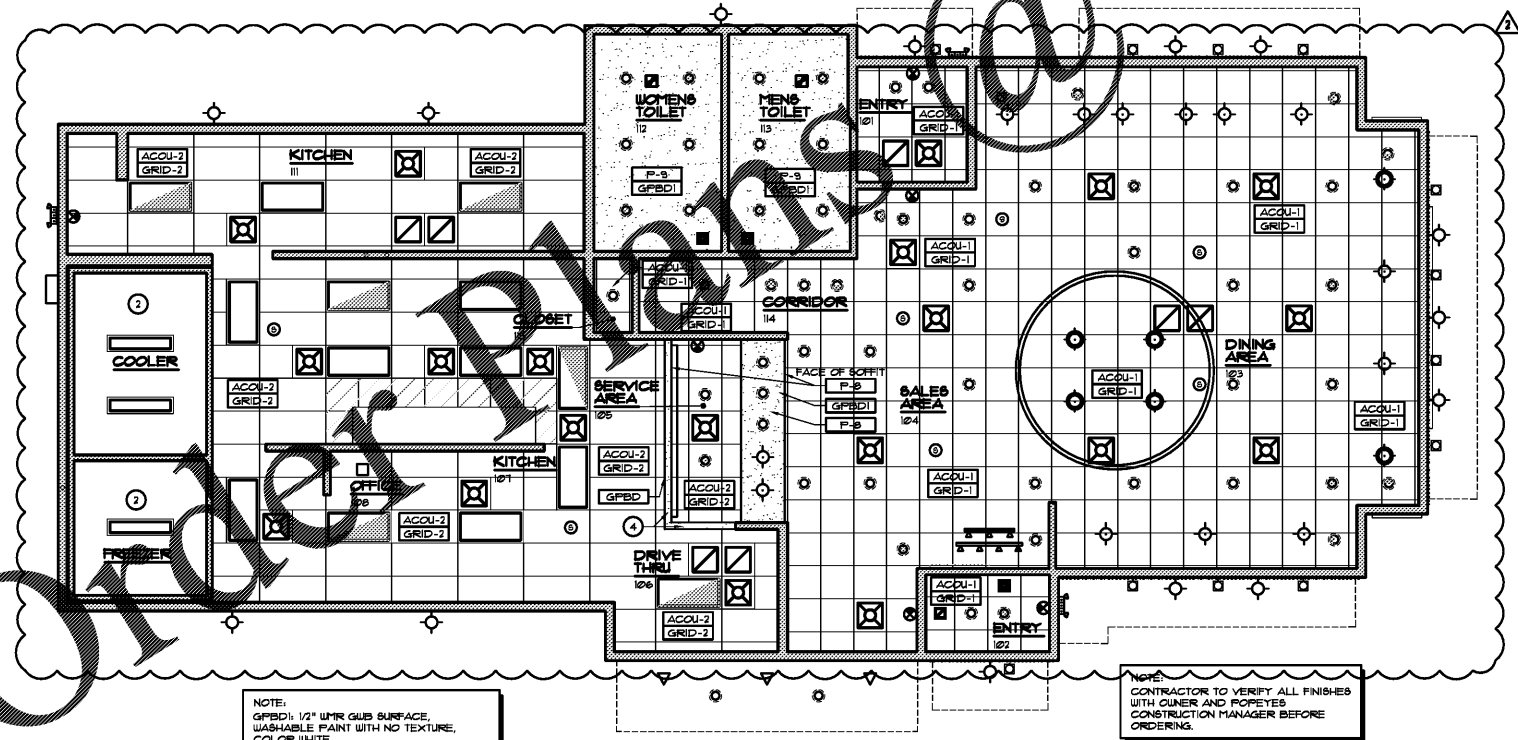
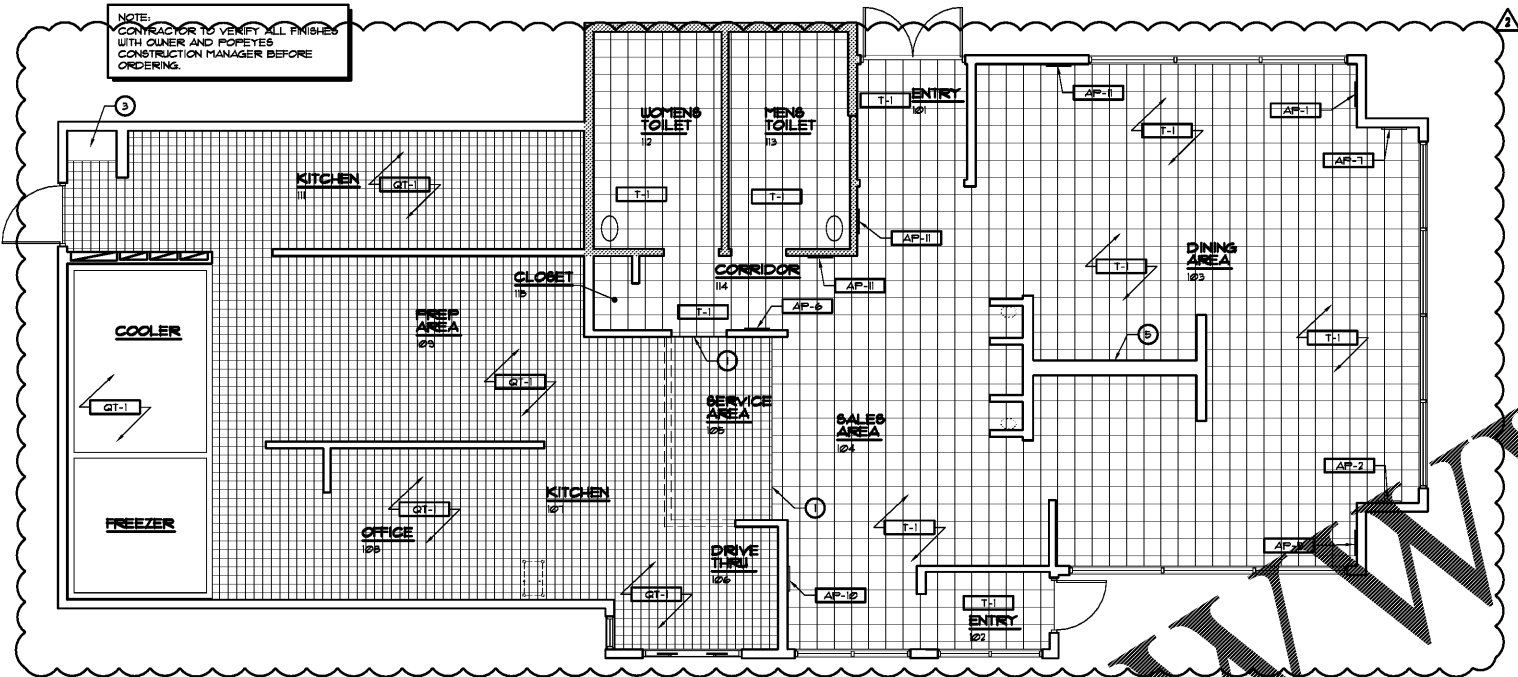

**REVISIONS**

| NO. | DATE       | BY |
|-----|------------|----|
| 1   | 07.16.2018 | DD |

**OLIVERI ARCHITECTS**  
Member of the American Institute of Architects  
32707 US Hwy 19 • Palm Harbor, FL 34884  
Phone 727.781.7520 • Fax 727.781.0623  
www.oliveriarchitects.com

**POPEYE'S**  
New Free Standing Building for  
US Highway 29 & Nease Drive  
Athens, Georgia

Date: 11.07.17  
Scale: AS NOTED  
Project Mgr: DG  
Drawn: GN11  
Job: 17-083  
Sheet: ID1