

GENERAL NOTES (CONT.)

- 13. SEE A/A4b FOR DOOR MANEUVERING CLEARANCES DETAILS.
- 14. DETECTABLE WARNING TEXTURES ON WALKING SURFACES SHALL CONSIST OF EXPOSED AGGREGATE CONCRETE, CUSHIONED SURFACES MADE OF RUBBER OR PLASTIC, RAISED STRIPS, OR GROOVES.
- 15. PROVIDE STAINLESS STEEL ENCLOSURE AT WALK-IN FREEZER AND COOLER CORNERS. SEE DETAIL C/A2.
- 16. INSTALL 3'-0" W x 8'-0" H x 1/8 GA. STAINLESS STEEL PANEL BEHIND OVENS. REFER TO INTERIOR ELEVATIONS AND EQUIPMENT PLAN FOR EXACT LOCATION.
- 17. ALL GYPSUM BOARD BELOW FINISHED CEILING HEIGHT IS TO BE PREPARED FOR PAINTING OR WALLCOVERING AS INDICATED ON INTERIOR ELEVATIONS AND FINISH SCHEDULE.
- 18. NEW HOOD WALL TO BE CONSTRUCTED WITH 3-5/8" 1/2 GAUGE METAL STUDS AT 24" O.C. AND 5/8" DUROCK ON HOOD WALL SIDE.
- 19. ALL DOORS SHALL BE ABLE TO BE OPENED FROM THE EGRESS SIDE WITHOUT THE USE OF A KEY, SPECIAL KNOWLEDGE OR EFFORT. MANUALLY OPERATED FLUSH BOLTS OR SURFACE BOLTS SHALL NOT BE USED.
- 20. HANDICAP ACCESS TO BUILDING IS DESIGNED ACCORDING TO APPLICABLE CODE. G.C. TO ENSURE THAT ALL DIRECTIONS AND DIMENSIONS GIVEN ARE STRICTLY ADHERED TO. IF CHANGES ARE MADE THAT CONTRADICT WITH THE DRAWINGS, OR IF EXISTING FIELD CONDITIONS MAKE THE DRAWINGS NOT APPLICABLE, THE ARCHITECT MUST BE CONTACTED IMMEDIATELY.

GENERAL NOTES

- 1. SEE K1 - K3 FOR EQUIPMENT SCHEDULES AND SPECIFICATIONS.
- 2. SEE SHEET A10 FOR DIMENSIONS.
- 3. SEE SHEET I01 FOR FINISH SCHEDULES AND MATERIALS.
- 4. ALL G.W.B. TO RECEIVE SLICK LEVEL (S) FINISH.
- 5. TYPICAL SUBSTRATES FOR INTERIOR WALLS SHALL BE AS FOLLOWS:
 KITCHEN, TOILETS AND STORAGE AREAS:
 5/8" DUROCK CEMENT BOARD (WHERE TILE IS USED), 3'-0" AND ABOVE - 5/8" PLYWOOD.
 SERVICE AREA AND DRIVE THRU:
 5/8" MIN. PLYWOOD,
 5/8" DUROCK CEMENT BOARD (WHERE TILE IS USED)
 SALES AND SEATING AREAS:
 5/8" GYPSUM BOARD.
 OFFICE:
 5/8" MIN. PLYWOOD.
- 6. PROVIDE 5/8" DUROCK CEMENT BOARD TO 3'-0" AFF. THEN PLYWOOD SHEATHING OVER 1x3 FURRING OVER 1" RIGID INSULATION OVER ALL CMU WALLS AT DRIVE-THRU SERVICE AREA AND KITCHEN AREAS.
- 7. PROVIDE R-19 BATT INSULATION AT ALL EXTERIOR FRAMED WALL SYSTEMS.
- 8. EQUIPMENT SUPPLIER TO PLACE ALL NEW EQUIPMENT.
- 9. G.C. TO COORDINATE PERMIT, APPROVALS AND LOCATION OF DUMPSTER ENCLOSURE.
- 10. G.C. TO MAKE ALL MECHANICAL, PLUMBING AND ELECTRICAL CONNECTIONS FOR ALL EQUIPMENT AS INDICATED ON EQUIPMENT PLAN. COORDINATE WITH EQUIPMENT SUPPLIER.
- 11. G.C. TO VERIFY CLEARANCES FOR INSTALLATION OF EQUIPMENT.
- 12. SEE PLUMBING DRAWINGS FOR SODIUM CHASES.

WALL LEGEND

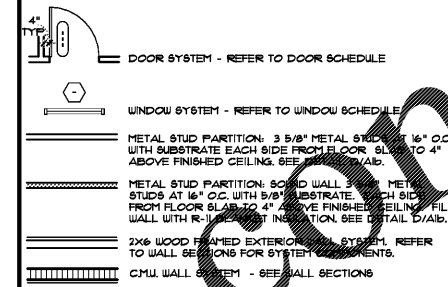

KEYED NOTES

- 1 ASPHALT DRIVE - SEE CIVIL DRAWINGS
- 2 LANDSCAPE AREA - SEE LANDSCAPE DRAWINGS
- 3 6" CONCRETE DRIVE - SEE SITE PLAN AND CIVIL DRAWINGS
- 4 ELECTRICAL SERVICE - SEE ELECTRICAL DRAWINGS
- 5 GAS METER - SEE PLUMBING DRAWINGS
- 6 LOCATION OF GREASE TRAP - SEE CIVIL DRAWINGS AND PLUMBING DRAWINGS
- 7 CONCRETE CURB - SEE SITE PLAN
- 8 CONCRETE WALK - SEE SITE PLAN
- 9 3'-6" STEEL GUARDRAIL SYSTEM - SEE EXTERIOR ELEVATIONS AND DETAIL C/A1a
- 10 PIPE BOLLARD - SEE SITE PLAN
- 11 MENU BOARD WITH TOPPER - SEE SITE PLAN AND ELECTRICAL DRAWINGS
- 12 18" x 60" GROUND LOOP VEHICLE DETECTOR IN CONCRETE DRIVE - SEE DETAIL A/A5b AND ELECTRICAL DRAWINGS
- 13 NOT USED
- 14 PREVIEW BOARD (NOT SHOWN) - SEE SITE PLAN
- 15 5'-0" WIDE CONCRETE RAMP - SEE SITE DRAWINGS
- 16 DETECTABLE WARNING STRIP - SEE GENERAL NOTE #4 ON THIS SHEET
- 17 DIRECTIONAL ARROW - SEE CIVIL DRAWINGS
- 18 CLEARANCE SIGN (NOT SHOWN) - SEE SITE PLAN
- 19 PREP SINK - SEE PLUMBING DRAWINGS
- 20 EQUIPMENT / CASEWORK BY OTHERS - SEE KITCHEN DRAWINGS
- 21 GREASE / CO2 ENCLOSURE
- 22 DOWNSPOUT - CONNECT TO UNDERGROUND STORM SYSTEM
- 23 STOREFRONT WINDOW SYSTEM - SEE WINDOW SCHEDULE
- 24 30" x 48" CLEAR FLOOR SPACE
- 25 HAND SINK - SEE PLUMBING DRAWINGS
- 26 SEATING AND TABLES - SEE A10 FOR CORE DRILL TABLE LOCATIONS
- 27 ACCESSIBLE SEATING - SEE DETAIL E/A1b
- 28 PROVIDE UTILITY AND CLEANING ACCESS AT ALL FRONT LINE CASEWORK WITH DRAINS (TYP.)
- 29 SALES COUNTER TO BE 34" HIGH SEE DETAIL 6/A8a
- 30 (3) COMPARTMENT SINK - SEE PLUMBING DRAWINGS
- 31 WATER HEATER - SEE PLUMBING DRAWINGS
- 32 ELECTRICAL PANELS - SEE ELECTRICAL DRAWINGS
- 33 DRIVE THRU SLIDING WINDOW SYSTEM - SEE WINDOW SCHEDULE
- 34 MOP SINK - SEE PLUMBING DRAWINGS AND EQUIPMENT SCHEDULE
- 35 DESK AND SHELF - SEE EQUIPMENT SCHEDULE AND DETAIL 3/A8b
- 36 WALK-IN COOLER / FREEZER
- 37 WALL HUNG FIRE EXTINGUISHER
- 38 EXTERIOR WALL SYSTEM - SEE WALL SECTIONS
- 39 AWNING SYSTEM ABOVE - SEE WALL SECTIONS AND EXTERIOR ELEVATIONS
- 40 ROOF ACCESS LADDER - SEE DETAIL D/A3
- 41 EXTERIOR DOOR SYSTEM - SEE DOOR SCHEDULE
- 42 STOREFRONT DOOR SYSTEM - SEE DOOR SCHEDULE
- 43 DRIVE THRU CANOPY SYSTEM ABOVE - SEE WALL SECTIONS AND EXTERIOR ELEVATIONS
- 44 NEW 1/4" COUNTER - SEE SHEET A8a
- 45 OUTLINE OF CEILING MOUNTED RING - SEE SHEET A2
- 46 GENERAL CONTRACTOR TO PROVIDE 2"x2"x4'-0" HIGH CORNER GUARDS ON ALL OUTSIDE CORNERS AT KITCHEN WALLS. PROVIDE COMPLETE WRAP ON END WALLS. SEE DETAIL A/A1a AND B/A1a
- 47 GENERAL CONTRACTOR TO INSTALL 1/8 GA. STAINLESS STEEL PANELS ON WALL - SEE MECHANICAL DRAWINGS FOR PANEL SIZES
- 48 FIRE EXTINGUISHER CABINET - SEE DETAIL A/A4a
- 49 DRIVE THRU CANOPY WITH SPEAKER - SEE SITE PLAN
- 50 BEVERAGE COUNTER - SEE DETAIL 5/A8a
- 51 TRASH RECEPTACLE - SEE EQUIPMENT PLANS
- 52 RECESS CONCRETE SLAB 6" FOR MOP SINK AS REQUIRED - SEE DETAIL 1/A8b
- 53 WALL MOUNTED FLAT SCREEN TV BY OWNER
- 54 48" HIGH MASONRY EQUIPMENT SCREEN WALL
- 55 STRIPED CROSSWALK - SEE CIVIL DRAWINGS
- 56 GATE W/ LOCKABLE LATCH - 3'-0" W x 3'-0" H
- 57 4"x2" SCUFFERS - SLOPE CONC. TO SCUFFERS
- 58 DRIVE-THRU STRIPING - SEE CIVIL DRAWINGS
- 59 STRIPED ZONE MARKING - SEE CIVIL DRAWINGS

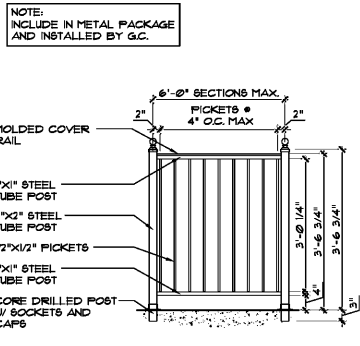
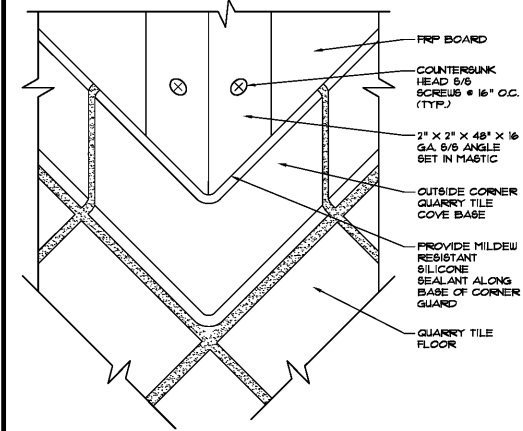
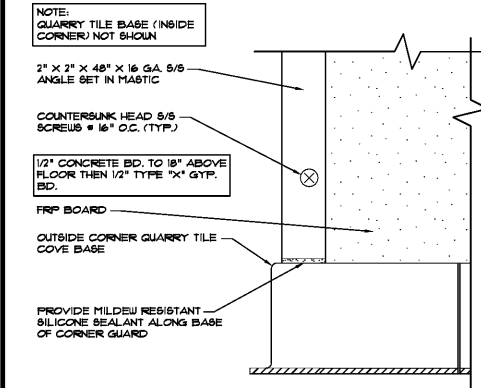

A KITCHEN CORNER GUARD - ELEVATION SCALE: 1/4" = 1'-0"

B KITCHEN CORNER GUARD - ISOMETRIC SCALE: 1/4" = 1'-0"

C GUARD RAIL DETAIL SCALE: 1/2" = 1'-0"

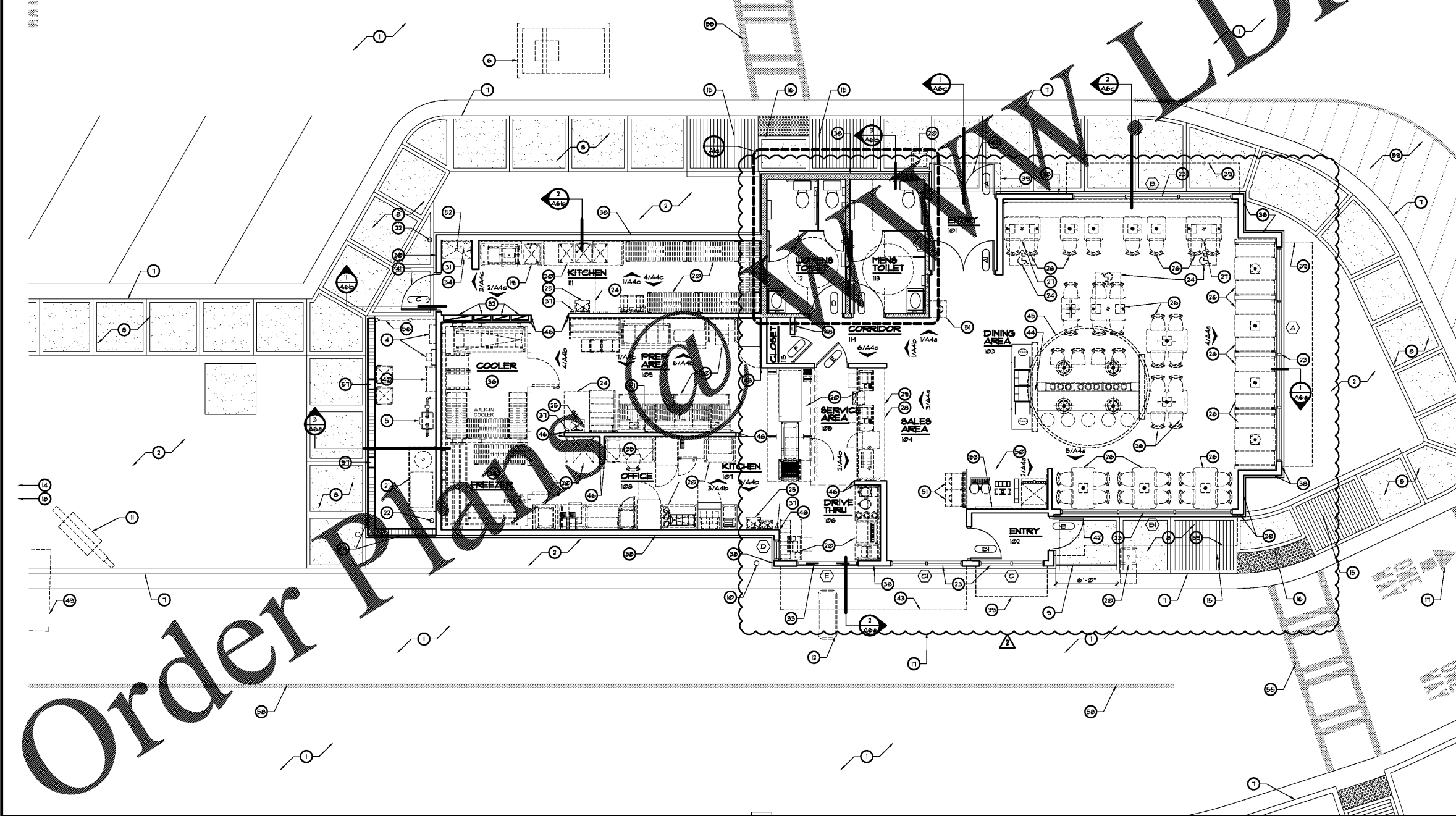

1 FLOOR PLAN SCALE: 3/16" = 1'-0"

Order Plans

NEW WORLD DINE

REVISIONS BY

02	16	2018	FLW/REY	DG
----	----	------	---------	----

OLIVERI ARCHITECTS

Member of the American Institute of Architects
 32707 US Hwy 19 • Palm Harbor, FL 34684
 Phone 727 781 7525 • Fax 727 781 0623
 www.oliveriarchitects.com

Joseph L. Oliveri, AIA
 State of Georgia
 License #6101552

New Free Standing Building for
POPEYE'S
 US Highway 29 & Nease Drive
 Athens, Georgia

Date: 11. 07. 17
 Scale: AS NOTED
 Project Mgr: DG
 Drawn: GN11
 Job: 17-083
 Sheet
A1a