



Chick-fil-A
5200 Buffington Road
Atlanta, Georgia 30349-2998

INTERPLAN
ARCHITECTURE
ENGINEERING
INTERIOR DESIGN
PROJECT MANAGEMENT

604 COURTLAND STREET
SUITE 100
ORLANDO, FLORIDA 32804
PH 407.645.5008
FX 407.629.9124

SEAL
THIS DOCUMENT IS NOT FOR CONSTRUCTION
UNLESS THE ARCHITECT'S OR ENGINEER'S
SIGNATURE AND SEAL APPEAR BELOW

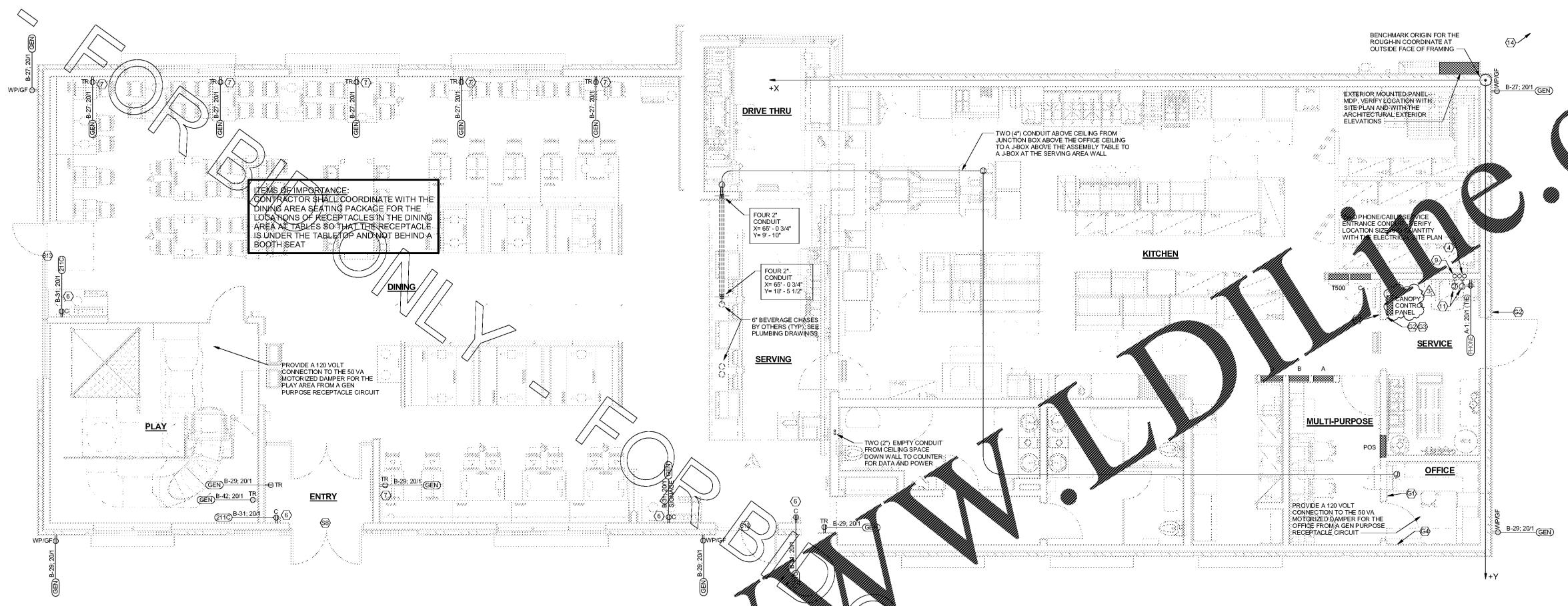

C1 POWER AND SYSTEMS PLAN - LRG
1/4" = 1'-0"

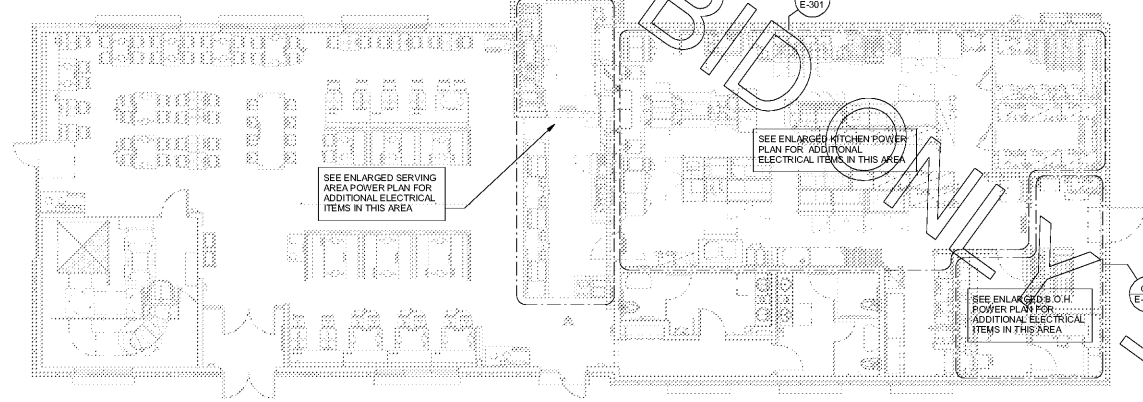

A1 ELECTRICAL KEY PLAN - LRG
1/8" = 1'-0"

CHICK-FIL-A
P12_LS

SAR South Cobb Drive FSR
3100 South Cobb Dr SE, Smyrna, GA 30080

FSR# 00810

NO.	DATE	DESCRIPTION
3	12.12.17	COORDINATION REVISIONS

CONSULTANT PROJECT #	2017.0165
PRINTED FOR	BID
DATE	September 06 2017
DRAWN BY	MI

SHEET
POWER AND SYSTEMS
PLAN - LRG

SHEET NUMBER
E-221L

Order Plans @ www.lddilline.com

2/5/2018 8:43 PM

COPYRIGHT © 2017 INTERPLAN, LLC. REPEATS COPYRIGHT © OTHER RIGHTS RESERVED. THESE DOCUMENTS TO THE ORIGINAL OR PARTIAL COPY WHICH THEY WERE PREPARED. REPRODUCTION, CHANGE OR ASSIMILATION ARE PROHIBITED.