

12144.400

NO.	DESCRIPTION	DATE
1	ELECTRICAL COMMENTS	11/17/2017

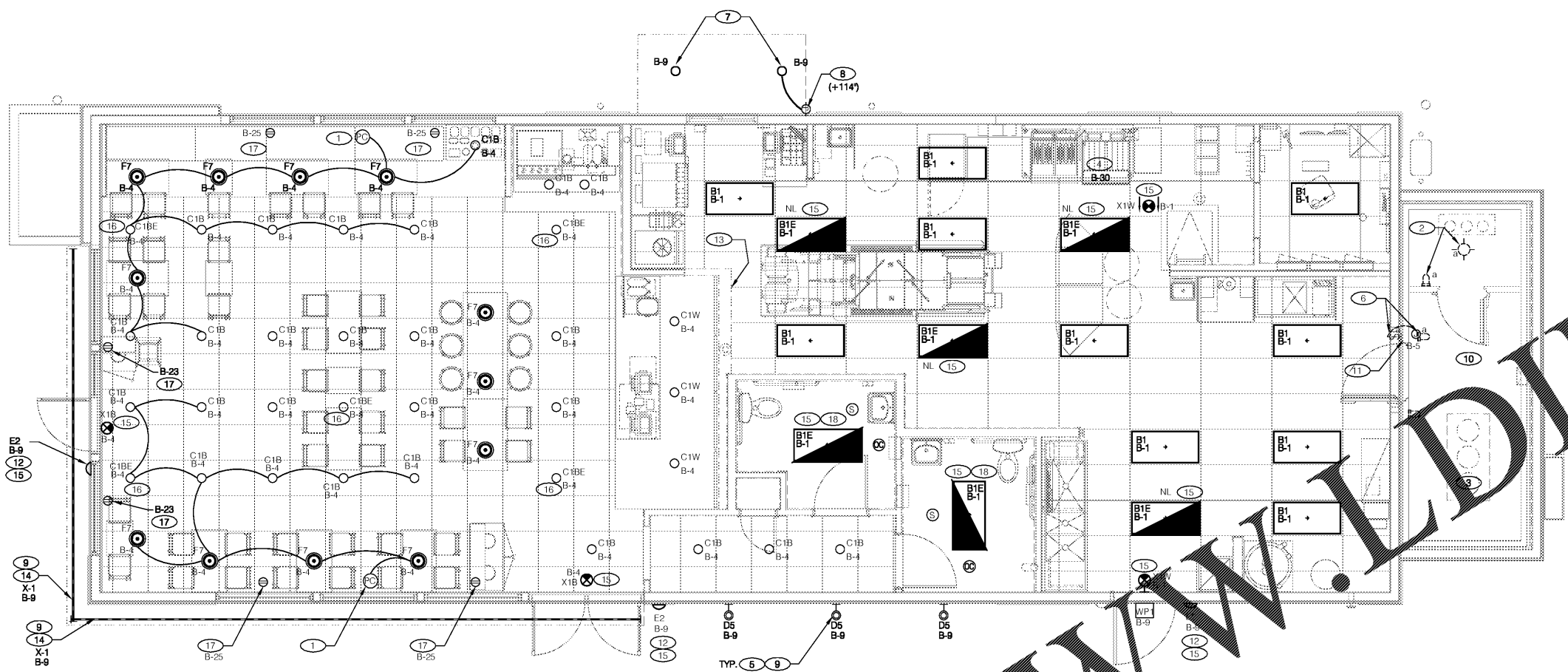

- GENERAL NOTES**
- CONFIRM LIGHTING FIXTURE QUANTITIES WITH SUPPLIER.
  - EMERGENCY AND NORMAL LIGHTING MARKED WITH 'NL' SUBSCRIPT SHALL OPERATE CONTINUOUSLY. PROVIDE UNSWITCHED HOT TO NORMAL AND EMERGENCY BALLAST.
  - EMERGENCY LIGHTING NOT MARKED WITH 'NL' SUBSCRIPT SHALL OPERATE UNDER CONTROL OF LIGHTING SWITCH AS INDICATED. PROVIDE UNSWITCHED CONSTANT HOT TO EMERGENCY BALLAST AND SWITCHED HOT TO NORMAL BALLAST.
  - ALL CIRCUITS FEEDING OR LEAVING COOLER/FREEZER SHALL BE PROVIDED WITH SEAL SWITCHING WITH COMPOUND PER NEC 300.7(B).
  - ALL INTERIOR LIGHTING CIRCUITS TO BE WIRED THRU THE LIGHTING CONTROL RELAYS. SEE 2/E.O.
  - CONTRACTOR TO FIELD VERIFY CEILING TYPE AND PROVIDE PROPER MOUNTING HARDWARE.
  - ALL FIXTURES SUPPLIED WITH LAMPS.

- LINE VOLTAGE PHOTOCELL TO BE CEILING MOUNTED. LOCATION TO BE INSTALLED PER MANUFACTURER RECOMMENDATIONS TO OBTAIN OPTIMAL LIGHTING CONTROL.
- INDICATES LIGHTING FIXTURES PROVIDED WITH WALK-IN COOLER. REFER TO GENERAL NOTE D.
- WALK-IN COOLER / FREEZER - SEE SCOPE OF WORK.
- EXHAUST HOOD LIGHT FIXTURES SUPPLIED WITH HOOD AND MTD IN PRE-WIRED J-BOX. COMPLETE CIRCUITING PER DETAIL 2/E.0.
- COORD. J-BOX LOCATION SO IT REMAINS CONCEALED BEHIND FIXTURE. REFER TO ARCH. DWGS. A4.0 AND A4.1 FOR HEIGHT AND LOCATION.
- FIXTURE AND SWITCH FACTORY INSTALLED WITH UNIT. G.C. TO COMPLETE CIRCUITING.
- CANOPY DOWN LIGHTS FURNISHED WITH CANOPY.
- J-BOX FOR CANOPY LIGHTS. VERIFY POINT OF CONNECTION. WIRE VIA EXTERIOR LIGHTING CONTACTOR.
- CONFIRM LENGTH OF FIXTURE WITH ARCHITECTURAL ELEVATIONS.
- WATER PROOF ELECTRICAL CONDUITS PER GENERAL NOTE 'D' OF THIS SHEET.
- J-BOX FOR COOLER/FREEZER LIGHTS. COORDINATE WITH MANUFACTURER.
- MOUNT TYPE E2 FIXTURE 8'-0" A.F.G. TO CENTER OF FIXTURE. CIRCUIT TO UNSWITCHED HOT CONDUCTOR OF CIRCUIT INDICATED.
- ALERT LIGHT: ONLY APPLIES WHEN A GEN IV POWER SOAK IS USED. DISREGARD IF GEN III POWER SOAK IS USED. SEE SHEET E3.0 FOR POWER REQUIREMENTS.
- COORDINATE POWER CONNECTION REQUIREMENTS FOR FIXTURE TYPE 'X1' WITH SIGN VENDOR AND CONSTRUCTION MANAGER PRIOR TO ROUGH-IN.
- CONNECT EMERGENCY BALLAST OR BATTERY BACKUP OF EMERGENCY LIGHT OR EXIT SIGN TO UNSWITCHED CONTINUOUSLY HOT CONDUCTOR OF LOCAL LIGHTING CIRCUIT INDICATED. NORMAL LIGHTING FIXTURES NOT MARKED AS 'NL' FOR NIGHT LIGHT SHALL BE WIRED FOR SWITCHED NORMAL OPERATION.
- C1BE HAS INTEGRAL BATTERY PACK. FIXTURES CIRCUITED THROUGH INVERTER IMI-12-LC-V1-TB (OR APPROVED EQUAL) ON SPARE CIRCUIT ON PANEL B.
- MOUNT SHOW WINDOW RECEPTACLE WITHIN 18" OF TOP OF WINDOW. OUTLET COVER PLATES TO BE BLACK.
- PROVIDE HARD CEILING FLANGE KIT.

LIGHTING PLAN 1/4"=1'-0" **A**

KEY NOTES **B**

NOTE:  
 \*CONTRACTOR SHALL VERIFY ALL QUANTITIES OF LIGHT FIXTURES. NOT ALL FIXTURE TYPES MAY BE USED.\*

NO.	LOCATION	MFR / CATALOG NUMBER	DESCRIPTION	LAMP		MOUNTING			VOLTS	WATT	REMARKS
				#	TYPE	TYPE	HT.	HT.			
B1	KITCHEN & OFFICE	MAXLITE MLFP-24DE-45-41	2x4 LED FLAT PANEL	1	LED	RECESSED TRID			120	45	
B1E	RESTROOM & KITCHEN	MAXLITE MLFP-24DE-45-41-EM	2x4 LED FLAT PANEL	1	LED	RECESSED FLAT			120	45	PROVIDED WITH INTEGRAL BATTERY PACK (15)
E2	EXTERIOR	LIGHT-ALARMS CAM-SD-DB-CW	EXTERIOR EMERGENCY EGRESS FIXTURE	1	LED	WALK	SEE KEY NOTES		120	18	UNSWITCHED HOT
X1W	KITCHEN	LIGHT-ALARMS QLXN500R-N	EXIT SIGN, LED UNIVERSAL MOUNT LED	1	LED	WALK/CEILING			120	3	
X1B	DINING	LIGHT-ALARMS QLXN500R-N, PW-08118-L	EXIT SIGN, LED UNIVERSAL MOUNT LED	1	LED	CEILING			120	3	PENDANT MOUNT FIXTURE +9" A.F.F. TO BOTTOM
E3	DINING	EVENLITE EVCV1-TB	BATTERY BACK-UP/INVERTER	1	LED				120		CONVERTS STANDARD FIXTURES TO EMER.
A	SITE LIGHT	LSI INDUSTRIES XALM-F110-LED-RO-20	LED AREA LIGHTS FORWARD THROW, POLE MOUNTED	1	LED	POLE	VERIFY		206	241	SEE CIVIL PLANS FOR POLE DETAILS
C1B	DINING	TCP: LED14DR5630KB95 ELITE HOUSING: 580C-AT-P-CL-BK	RECESSED LED DOWNLIGHT	1	LED	RECESSED DROP CLG.			120	14	
C1BE	DINING	TCP: LED14DR5630KB95 ELITE HOUSING: 580C-AT-P-CL-BK	RECESSED LED DOWNLIGHT	1	LED	RECESSED DROP CLG.			120	14	(16)
C1W	DINING	TOP: ED14DR56L30K95 ELITE HOUSING: E46180172	RECESSED LED DOWNLIGHT	1	LED	RECESSED HARD CLG.			120	14	
F4	DINING	BASELIGHT CO15/78EXT/59INT/8LC25WINC MAX	DINING ROOM PENDANT	1	11W LED A19 LAMP	PENDANT	BOT @ 8'-0" A.F.F.		120	11	
F7	DINING	HI-LITE H-15114-98/CB8-98/LED	DINING ROOM PENDANT	1	11W LED A19 LAMP	PENDANT	BOT @ 6'-0" A.F.F.		120	9	LAMP (60W) EQ WARM WHITE (2700K) LED
D6	EXTERIOR WALL	PROGRESS LTG-P5642-20 LENS P8798-31	BRONZE 6" UP/DOWN CYL.	2	(2) TCP L14PAR38 D30KFLW	PENDANT	CENTER OF BRACKET AT 14'-0" A.F.F.		120	9	
C4	PATIO	SPECTRUM LIGHTING SPC0340INC-PAR20-SM-MB	LED PENDANT	1	(1) SOLAIS LR20/4Q/27K/975/BK	PENDANT	CENTER OF BRACKET AT 14'-0" A.F.F.		120	12	
G3	COLOR CHANGING LIGHT WALL	LED POWER #HB-40 W/ ACCESSORIES	DINING ROOM LED STRIP	-	LED				120	96	
WP1	EXTERIOR WALL	LUMARK (EATON) LDWP-GL-3B-120V	LED WALL PACK	1	LED	WALL	8'-6"		120	27	
X1	EXTERIOR	CONTECH TLTO-12V-2-WW-16CR	LED TAPE LIGHT	1	LED				120	2/FT	BY SIGN VENDOR

LIGHTING FIXTURE SCHEDULE **D**

**ELECTRICAL SYSTEM AND EQUIPMENT**

ENERGY CODE:  PRESRIPTIVE  PERFORMANCE  
 ASHRAE 90.1:  PRESRIPTIVE  PERFORMANCE

**LIGHTING SCHEDULE**  
 LAMP TYPE REQUIRED IN FIXTURE SEE LIGHTING FIXTURE SCHEDULE THIS SHEET  
 NUMBER OF LAMPS IN FIXTURE SEE LIGHTING FIXTURE SCHEDULE THIS SHEET  
 BALLAST TYPE USED IN THE FIXTURE ENERGY EFFICIENT, HIGH POWER FACTOR, ELECTRONIC  
 NUMBER OF BALLASTS IN FIXTURE 1 OR 2  
 TOTAL WATTAGE PER FIXTURE SEE LIGHTING FIXTURE SCHEDULE THIS SHEET  
 TOTAL INTERIOR WATTAGE SPECIFIED VS. ALLOWED 1290 VS. 1883  
 TOTAL EXTERIOR WATTAGE SPECIFIED VS. ALLOWED 2198 VS. 3922

**EQUIPMENT SCHEDULES WITH MOTORS (NOT USED BY MECHANICAL SYSTEMS)**  
 MOTOR HORSEPOWER N/A  
 NUMBER OF PHASES N/A  
 MINIMUM EFFICIENCY N/A  
 MOTOR TYPE N/A  
 NUMBER OF POLES N/A

**ADDITIONAL PRESRIPTIVE COMPLIANCE**  
 508.2.1 MORE EFFICIENT MECHANICAL EQUIPMENT  
 508.2.2 REDUCED LIGHTING POWER DENSITY  
 508.2.3 ENERGY RECOVERY VENTILATION SYSTEMS  
 508.2.4 HIGHER EFFICIENCY SERVICE WATER HEATING  
 508.2.5 ON-SITE SUPPLY OF RENEWABLE ENERGY  
 508.2.6 AUTOMATIC DAYLIGHTING CONTROL SYSTEMS  
 N/A

**DESIGNER STATEMENT:**  
 TO THE BEST OF MY KNOWLEDGE AND BELIEF, THE DESIGN OF THIS BUILDING COMPLIES WITH THE ELECTRICAL SYSTEMS AND EQUIPMENT REQUIREMENTS OF THE NORTH CAROLINA STATE ENERGY CODE (2012 EDITION).

SIGNED: \_\_\_\_\_  
 NAME: RYAN A. GRAY  
 TITLE: ELECTRICAL ENGINEER

KEY NOTES **C**

Order Plans

TACO BELL  
 3923 SHAKEDOWN ST.  
 CHARLOTTE, NC



**LIGHTING PLAN AND SCHEDULE**  
**E4.0**