

RIGHT SIDE ELEVATION 1/4" = 1'-0" A

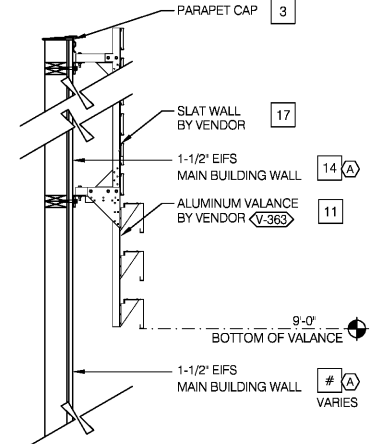

SLAT WALL COLOR TRANSITION N.T.S. I

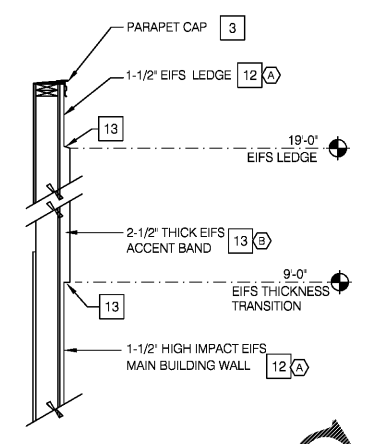

EIFS THICKNESS COLOR TRANSITION N.T.S. G

**MISCELLANEOUS**  
 A. SEE SHT A1.1 "WINDOW TYPES" FOR WINDOW ELEVATIONS.  
**SEALERS (REFER TO SPECS):**  
 A. SEALANT AT ALL WALL AND DOOR PENETRATIONS.  
 B. SEALANT AT ALL WINDOW AND DOOR FRAMES AT HEAD AND JAMB. DO NOT SEAL SILL @ WINDOWS.  
 C. APPLY NEOPRENE BASKET (CONNECT BETWEEN) BUILDING & CANOPY.  
**"CRITICAL" DIMENSIONS:**  
 A. REQUIRED CLEAR OPER. WIDTH TO ENSURE COORDINATION WITH STANDARD SIGNAGE/ BUILDING ELEMENT DIMENSIONS.

NOTE: NO EXTERIOR SIGNS ARE WITHIN THE SCOPE OF WORK COVERED BY THE BUILDING PERMIT APPLICATION. THE GENERAL CONTRACTOR SHALL BE RESPONSIBLE FOR COORDINATING THE INSTALLATION OF ALL EXTERIOR SIGNS AND INSTALLATION OF REQUIRED BLOCKING AND ELECTRICAL CONNECTIONS FOR FINAL APPROVED SIGNS.

GENERAL NOTES F

NOT USED N.T.S. E

- (1) BUILDING SIGN, BY VENDOR. REQUIRES ELECTRICAL. SEE ELECTRICAL PLANS.
- (2) DRIVE THRU WINDOW. SEE SHEET A1.0 AND A1.1.
- (3) DASHED LINE INDICATES ROOF BEYOND.
- (4) STOREFRONT, TYPICAL. REFER TO SHEET A1.1.
- (5) WALL PACK LIGHT FIXTURE.
- (6) SWITCH GEAR. PAINT TO MATCH WALL.
- (7) ZURN Z199 LAMBS TONGUE OVERFLOW DRAIN THROUGH PARAPET WALL TO BE INSTALLED 2" ABOVE ROOF DRAIN.
- (8) LIGHT SCENCE. ALIGN BOTTOM OF FIXTURE'S MOUNTING BRACKET WITH EIFS REVEAL / CHANGE IN EIFS THICKNESS.
- (9) ASSUME D/T LANE SURFACE IS 6" BELOW THE FINISH FLOOR. REFER TO GRADING & SITE PLAN.
- (10) NOT USED.
- (11) TOWER WITH METAL PANEL FINISH.
- (12) PARAPET COPING. IF DURO-LAST EDGE TRIM IS USED. USE THE DURO-LAST PRE-FINISHED EDGE TRIM. SEE DETAIL 2/A6.0.
- (13) CO2 FILLER VALVE & COVER. SEE DETAIL 5/A6.2 SIM.
- (14) DRIVE-THRU CANOPY BY OTHERS.
- (15) GAS SERVICE.
- (16) WALL SHALL BE FINISHED PRIOR TO INSTALLATION OF SWITCHGEAR.
- (17) NOT USED.
- (18) CONCRETE CURB.
- (19) RTU BEYOND. PAINT TO MATCH MAIN BUILDING COLOR.
- (20) BREAK METAL COVER OVER WOOD STUDS TO MATCH STOREFRONT. SEE 3/A6.1
- (21) NOT USED.
- (22) NOT USED.
- (23) BOLLARD.
- (24) SINGLE MEMBRANE ROOFING.
- (25) IF THE DURO LAST PARAPET CAP TRIM IS USED IT SHALL NOT BE PAINTED.
- (26) NOT USED.
- (27) NOT USED.
- (28) NOT USED.
- (29) STOREFRONT DOOR. REFER TO DOOR SCHEDULE.
- (30) HOSE BIBB LOCATION. REFER TO PLUMBING AND DETAIL 8/A6.2
- (31) NOT USED.
- (32) NOT USED.
- (33) NOT USED.
- (34) EIFS (TYP). SEE 2 & 4/A6.2.

- (A) BASE THICKNESS - 1-1/2" THICK EIFS.
- (B) BASE THICKNESS - 2-1/2" THICK EIFS.

E.I.F.S. THICKNESS N.T.S. B

NOTE: SIGNAGE UNDER SEPARATE PERMIT

V-XXX	QTY	ITEM DESCRIPTION	ELEC
V-930	2	TB 3'-6" x 4'-0" LOGO BELL - FACE LIT	X
V-940	3	TB 14" CHANNEL LETTER - WHITE	X
V-350	1	DRIVE-THRU CANOPY - 4'-0"D x 9'-0"W x 6'H	X

SIGN SCHEDULE N.T.S. C

SYMBOL	AREA	MANUFACTURER	COLOR	ALTERNATE MFR.	ALTERNATE COLOR	CONTACT INFORMATION
1	NOT USED					
2	NOT USED					
3	PARAPET CAP (TOWER)	DUROLAST (25)	MEDIUM BRONZE (FACTORY FINISH)	SHERWIN WILLIAMS	SW 7069 'IRON ORE'	DURO-LAST; LEE COBB, 800-434-3876 (PHONE)
4	NOT USED					
5	NOT USED					
6	PARAPET CAP (COOLER)	DUROLAST (25)	GALVALUM. PLUS (FACTORY FINISH)			
7	STOREFRONT WINDOWS	TBD	CLEAR ANODIZED			
8	PIPE BOLLARDS	STREET SIGN	YELLOW - 1/4" THICK PLASTIC COVER (US.POSTMAN.COM) OR EQUAL			
9	PARAPET BACK ROOFING	DURO-LAST	THE COLOR SHALL BE FACTORY COLORED 'TAN' EQUAL ALTERNATE ALLOWED.			DURO-LAST; LEE COBB, 800-434-3876 (PHONE)
10	AWNING	BERRIDGE	S-DECK PREWEATHERED GALVALUME			
11	VALANCE COLOR		SW 7034 'STATUS BRONZE' (EQUAL)			
12	MAIN BUILDING COLOR	SHERWIN WILLIAMS	SW 7067 'CITYSCAPE'	STO LOTUSAN	NA17-0014	SHERWIN WILLIAMS: BRAD HARRINGTON, 216-341-5558 X115 (PHONE), BRAD.E.HARRINGTON@SHERWIN.COM
13	ACCENT COLOR	SHERWIN WILLIAMS	SW 6098 'PACER WHITE'	STO LOTUSAN	NA17-0008	EIFS CONTACT: STO CORP.: CHUCK DUFFIN, 940-894-2092 (PHONE), 940-894-2095 (FAX), CDUFFIN@STOCORP.COM
14	WALL COLOR BEHIND SCREEN WALL	SHERWIN WILLIAMS	SW 6831 'CLEMATIS'	STO LOTUSAN	NA14-0004	
15	NOT USED					
16	METAL PANELS	WESTERN STATES METAL ROOFING	18" A606-4 RUSTWALL PANELS			
17	SLAT WALL	SIGN VENDOR	WOOD LIKE FINISH TBD BY VENDOR			

EXTERIOR FINISH SCHEDULE H

KEY NOTES D

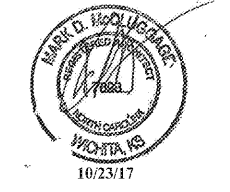

12144.400

CONTRACT DATE: 10/23/17  
 BUILDING TYPE: EXP. LITE MED/0  
 PLAN VERSION: DECEMBER 2016  
 SITE NUMBER: 311687  
 STORE NUMBER: 436583

TACO BELL  
 3923 SHAKEDOWN ST.  
 CHARLOTTE, NC



EXTERIOR ELEVATIONS  
**A4.0**