

FLOOR / BASE

1. REMOVE EXISTING FLOORING & BASE & INSTALL NEW V.C.T. FLOORING & NEW 4" RUBBER BASE.
2. EXISTING FLOORING & BASE TO REMAIN.
3. REMOVE EXISTING QUARRY TILE FLOORING, BASE & MORTAR BED. REPLACE RECESSED MORTAR BED W/ THIN-SET CONCRETE. APPLY EPOXY RESINOUS FLOORING W/ 4" TROWELED COVE EPOXY RESINOUS BASE AT WALLS. POSITIVE SLOPE NEW FLOOR TO FLOOR DRAINS.
4. EXISTING WOOD FLOORING TO REMAIN. CONTRACTOR WILL BE REQUIRED TO PROTECT FLOOR DURING CONSTRUCTION.
5. REMOVE EXISTING CARPET & BASE. INSTALL NEW L.V.T. & NEW 4" RUBBER WALL BASE.
6. REMOVE EXISTING CERAMIC TILE FLOORING, BASE & MORTAR BED. REPLACE RECESSED MORTAR BED W/ THIN-SET CONCRETE. APPLY EPOXY RESINOUS FLOORING W/ 4" RUBBER BASE AT WALLS.
7. REMOVE EXISTING V.C.T. FLOORING & BASE. INSTALL NEW L.V.T. FLOORING & NEW 4" RUBBER WALL BASE.
8. REMOVE EXISTING FLOORING & WALL BASE. INSTALL NEW EPOXY RESINOUS FLOORING W/ 4" RUBBER WALL BASE AT WALL.

FINISH BAR DESCRIPTION SCHEDULE

CEILING

1. REMOVE EXISTING CEILING SYSTEM & INSTALL NEW 2x2 SUSPENDED CEILING SYSTEM.
 2. REMOVE EXISTING CEILING SYSTEM & INSTALL NEW M.R. 2x2 SUSPENDED CEILING SYSTEM.
 3. EXISTING CEILING SYSTEM TO REMAIN.
- ALSO REFER TO DEMOLITION PLANS FOR ADDITIONAL SCOPE OF WORK TO REMOVE EXISTING CEILING SYSTEM.

WALLS/ HOLLOW-METAL FRAMES

1. EXISTING & NEW C.M.U. WALLS TO BE EPOXY PAINTED. REFER TO SPECS. PAINT EXISTING & NEW DOOR/WINDOW HOLLOW-METAL FRAMES ON BOTH SIDES (INTERIOR & EXTERIOR). RE-PAINT TO MATCH EXISTING ACCENT WALLS & WALL STRIPES.
2. EXISTING CERAMIC TILE WALLS TO REMAIN. CONTRACTOR TO PATCH IN NEW MATCHING CERAMIC WALL TILE IN WALL AREAS WHERE EXISTING SCREEN WALL &/OR TOILET PARTITION WALL ARE RE-LOCATED.
3. EXISTING WALLS TO REMAIN. PAINT EXISTING & NEW DOOR/WINDOW HOLLOW-METAL FRAMES ON BOTH SIDES (INTERIOR & EXTERIOR).
4. EXISTING & NEW C.M.U. WALLS TO BE EPOXY PAINTED. REFER TO SPECS. PAINT EXISTING & NEW DOOR/WINDOW HOLLOW-METAL FRAMES ON BOTH SIDES (INTERIOR & EXTERIOR).
5. NEW & EXIST. GYP BOARD WALLS TO BE PAINTED. ALSO PAINT ALL H.M. DOOR FRAMES ON BOTH SIDES.
6. NEW GYP. BOARD WALLS TO BE PAINTED W/ EPOXY. ALSO PAINT ALL H.M. DOOR FRAMES ON BOTH SIDES.
7. EXISTING WALLS TO REMAIN. NO RE-PAINTING REQUIRED.

CEILING HEIGHT

NOTE: DIMENSION INDICATES NEW CEILING HEIGHT.
M.E. INDICATES "MATCH EXISTING"

LEGEND TO PLANS:

1. REFER TO REFLECTED CEILING PLANS FOR INFORMATION ON WALL RATING AND CONSTRUCTION.
 2. N.I.C. - INDICATES "NOT IN CONTACT"
 3. REFER TO COVER SHEET FOR THE COMPLETE KEYNOTE LIST AND DESCRIPTIONS.
 4. REFER TO THE DEMOLITION PLANS FOR THE DEMOLITION ITEM MATCHING.
 5. SHADED WALL AREAS INDICATES NEW WALL CONSTRUCTION.
- INDICATES ROOM FINISHES. REFER TO FINISH BAR DESCRIPTION SCHEDULE ON 1/8" SCALE FLOOR PLANS.
- INDICATES WINDOW NUMBER. REFER TO WINDOW SCHEDULE SHOWN ON DRAWING A601.
- INDICATES NEW ALUMINUM (AL) OR LOW-METAL (HM) WINDOW UNITS. REFER TO DRAWING A502 FOR NEW WINDOW ELEVATION, DESCRIPTION AND DETAILS.
- INDICATES NEW WALL CONSTRUCTION. REFER TO PLANS FOR DESCRIPTION OF WALL.
- * FE - INDICATES NEW SEMI-RECESSED FIRE EXTINGUISHER. REFER TO DET. K6/A301.
- SYMBOL INDICATES NEW GYP. BOARD & METAL STUD WALLS. REFER TO DETAIL E1.4/A402 FOR DESCRIPTION OF NEW WALL MATERIAL & CONSTRUCTION.
- NOTE A: INDICATES EXISTING MARKERBOARDS TO REMAIN
NOTE B: INDICATES EXISTING TACKBOARD TO REMAIN.
- NOTE C: INDICATES EXISTING MILLWORK TO REMAIN.
- NOTE D: INDICATES INSTALLING NEW DOUBLE STACK TACKABLE DISPLAY RAILS. REFER TO DETAIL N16/A403 ADG. DIMENSIONS ON FLOOR PLANS INDICATES LENGTH OF NEW DOUBLE ROW DISPLAY RAILS.
- NOTE E: INDICATES WALL PAINTING DETAIL FOR WALL STRIPES ON ALL WALLS. REFER TO CORRIDOR WALL PAINTING K19/A403 AD6.

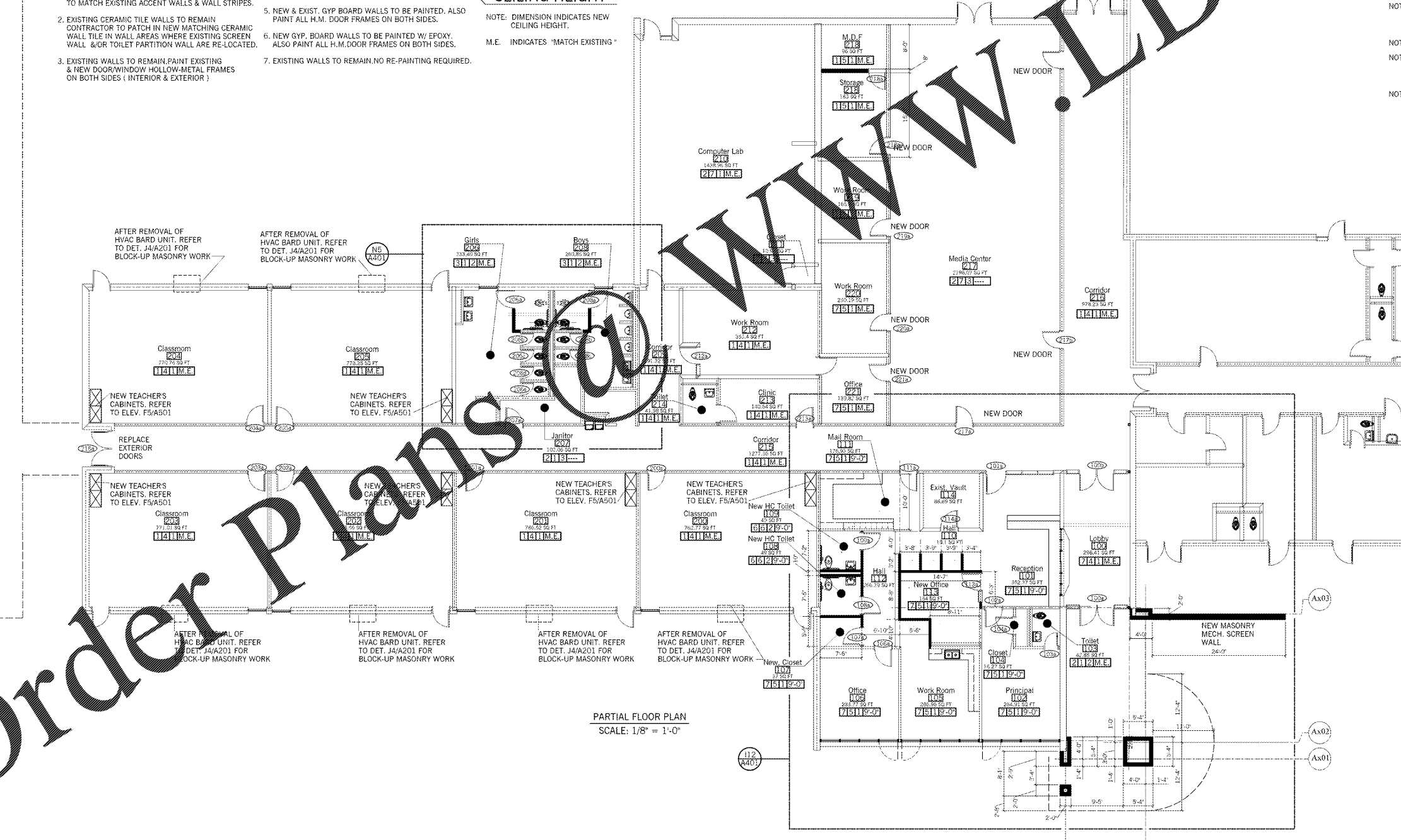

PARTIAL FLOOR PLAN
SCALE: 1/8" = 1'-0"

Southern A&E REVISION
7951 Iron Circle
Austell, Ga. 30168
(770) 819-7777
architects & engineers DATE February 28, 2018
JOB NUMBER 01-847-061
FACILITY CODE NUMBER: 664-1856
RENOVATIONS TO:
BELWOOD ELEMENTARY SCHOOL
GORDON COUNTY BOARD OF EDUCATION
CALHOUN, GEORGIA
DRAWING NUMBER
A103

STATE OF GEORGIA
REGISTERED ARCHITECT

Order Plans

WWW.LDILINE.COM