

ALL DOCUMENTS INCLUDING DRAWINGS, SPECIFICATIONS, CONTRACTS, AND INSTRUMENTS OF SERVICE IN RESPECT OF THE ELD AND TRICE, P.C. INTEREST SHALL REMAIN AN OWNERS PROPERTY. PROJECTS COMPLETED BY TRICE, P.C. SHALL BE THE PROPERTY OF TRICE, P.C. AND SHALL NOT BE REPRODUCED OR TRANSMITTED IN ANY FORM OR BY ANY MEANS, ELECTRONIC OR MECHANICAL, INCLUDING PHOTOCOPYING, RECORDING, OR BY ANY INFORMATION STORAGE AND RETRIEVAL SYSTEM, WITHOUT THE WRITTEN PERMISSION OF TRICE, P.C. THIS NOTICE SHALL BE APPLIED TO ALL REVISIONS AND ADDENDUMS TO THESE DRAWINGS.

TRICE, P.C.
CONSULTING ENGINEERS
CIVIL, ELECTRICAL, TRANSPORTATION, PLANNING
1875 Washington Drive, Suite 300, Huntsville, AL 35894
256-536-6336

**LEGACY AT JONES FARM
PHASE 2**

CLIENT
RBJ BAILEY, LLC
PO BOX 2545
HUNTSVILLE, AL 35804

SITE ADDRESS
1 LEGACY FARM DR SE
HUNTSVILLE, AL 35802

REVISIONS

SHEET TITLE
WATER AND SEWER PLAN

SCALE: 1"=20'
APPROVED BY: JRT
PROJECT NO: 17-105
DATE: 12/29/17
SHEET NUMBER
C5.3 OF C5.3

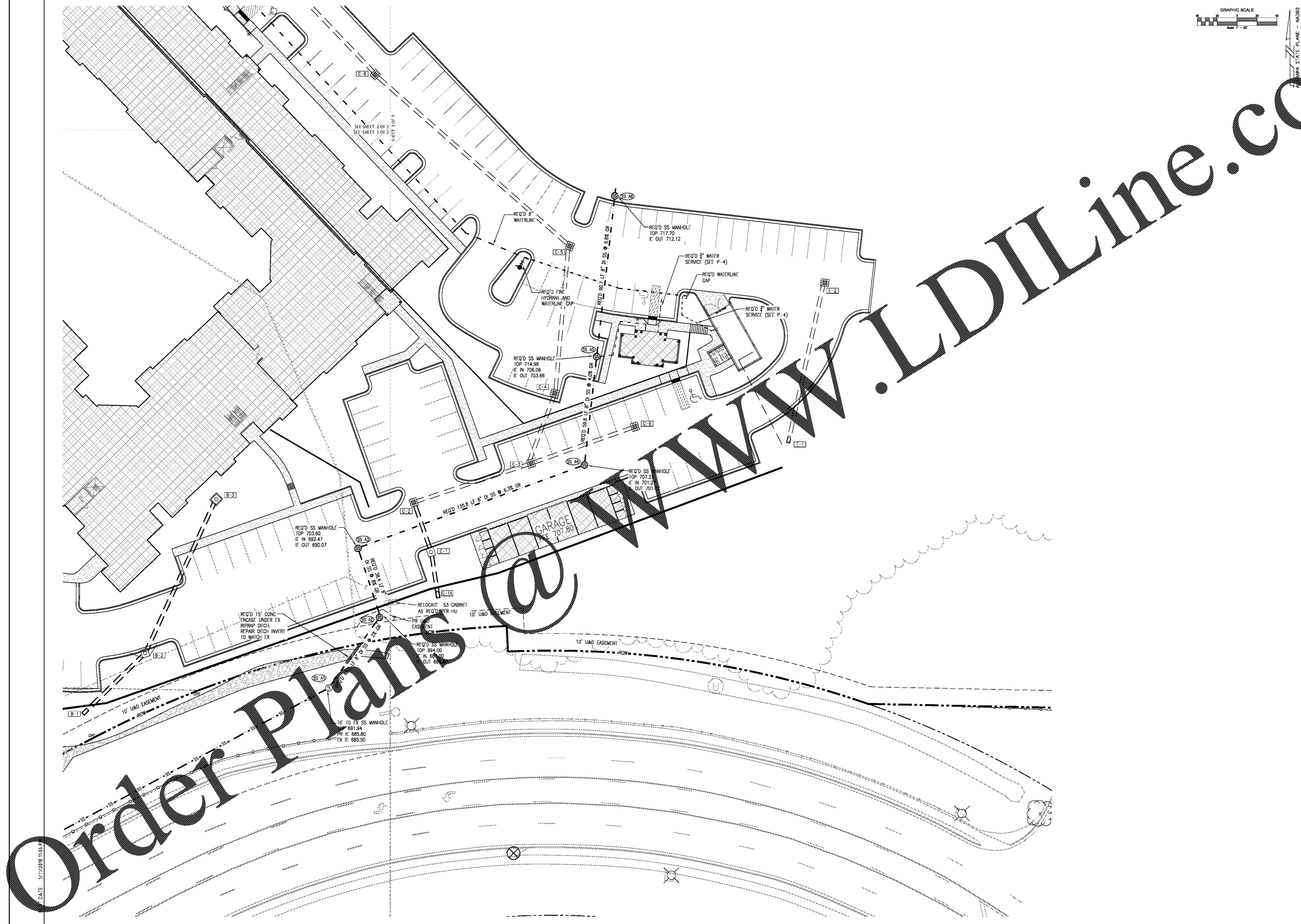

Order Plans @

WWW.LDILine.com

DATE: 1/17/2018 11:06 P