

ALL DOCUMENTS INCLUDING DRAWINGS, SPECIFICATIONS, CONTRACTS, AND PROJECTIONS SHALL BE THE PROPERTY OF PRICE, P.C. AND SHALL REMAIN THE PROPERTY OF PRICE, P.C. UNLESS OTHERWISE SPECIFIED. THE CLIENT OR USER OF THESE DOCUMENTS SHALL BE RESPONSIBLE FOR OBTAINING ALL NECESSARY PERMITS AND APPROVALS FROM THE APPROPRIATE AGENCIES. PRICE, P.C. SHALL NOT BE RESPONSIBLE FOR ANY DAMAGE TO PERSONS OR PROPERTY CAUSED BY THE USE OF THESE DOCUMENTS WITHOUT THE WRITTEN CONSENT OF PRICE, P.C. TO BE ADDED UPON WRITING.

PRICE, P.C.
CONSULTING ENGINEERS
CIVIL, ENVIRONMENTAL, TRANSPORTATION, PLANNING
1000 UNIVERSITY BLVD. SUITE 200
HUNTSVILLE, AL 35893

**LEGACY AT JONES FARM
PHASE 2**

CLIENT
RBJ BAILEY, LLC
PO BOX 2545
HUNTSVILLE, AL 35804

SITE ADDRESS
1 LEGACY FARM DR SE
HUNTSVILLE, AL 35802

REVISIONS

NO.	DATE	DESCRIPTION

SHEET TITLE
EROSION AND SEDIMENT CONTROL PLAN

SCALE 1"=20'
APPROVED BY: J.R.P.
PROJECT NO: 17-105
DATE: 12/29/17
SHEET NUMBER
C4.3 OF C4.3

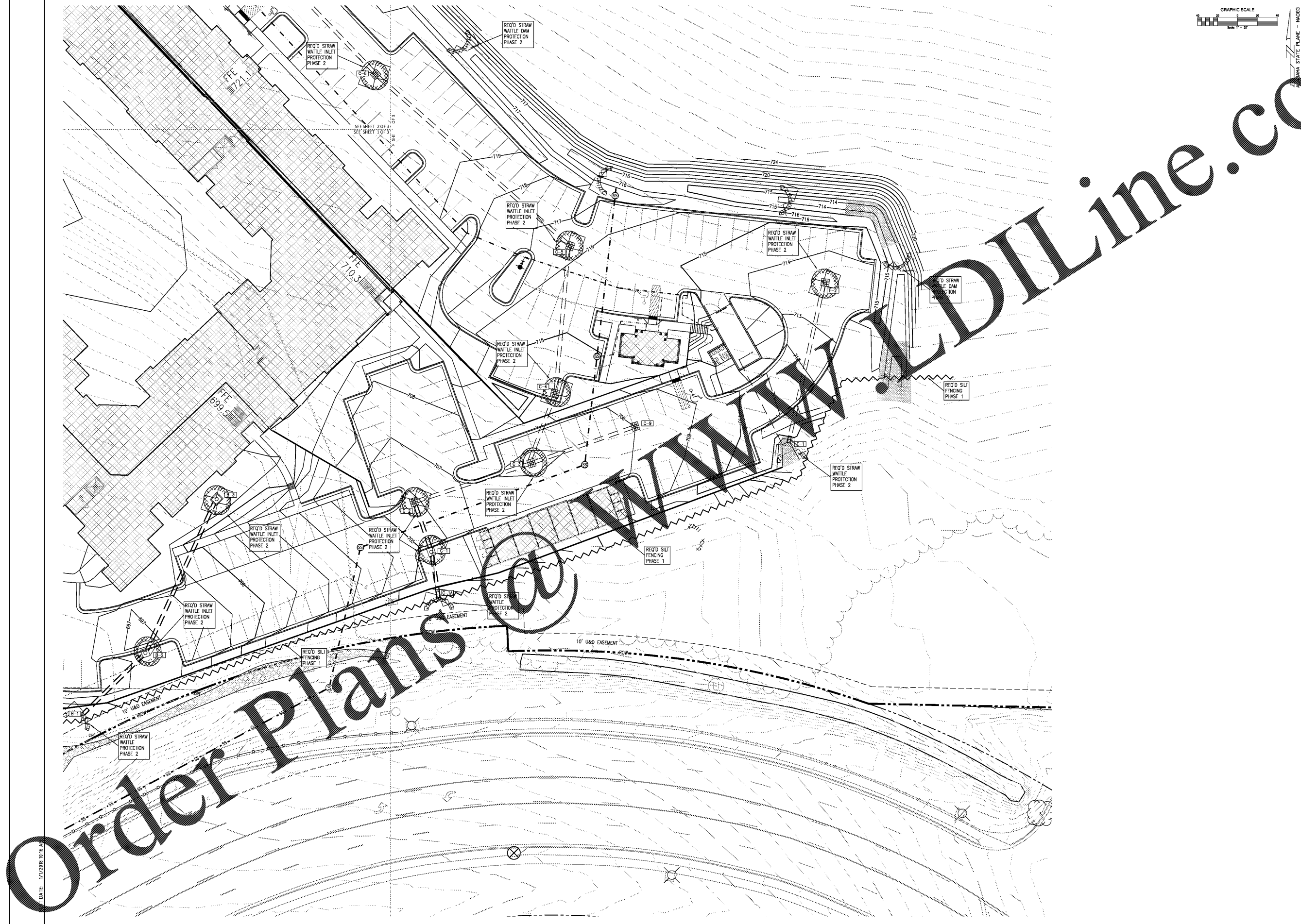

DATE: 1/7/2018 10:16 AM