

UNIT MIX									
BLDG #	A1 (1 BR, 1 BATH)	A2 (1 BR, 1 BATH)	A3 (1 BR, 1 BATH)	B1 (2 BR, 2 BATH)	B2 (2 BR, 2 BATH)	B2a (2 BR, 2 BATH)	C1 (3 BR, 2 BATH)	C1a (3 BR, 2 BATH)	TOTAL UNITS
TERRACE	1	3	-	1	1	-	3	-	9
GROUND	1	12	7	8	1	1	4	-	34
SECOND	1	20	7	11	1	1	4	2	47
THIRD	1	20	7	13	1	1	5	2	50
FOURTH	-	15	5	10	-	1	-	2	33
<b>TOTAL UNITS</b>	<b>4</b>	<b>70</b>	<b>20</b>	<b>43</b>	<b>4</b>	<b>4</b>	<b>10</b>	<b>6</b>	<b>173</b>
PERCENTAGE	2.31%	40.46%	11.56%	24.86%	2.31%	2.31%	5.78%	3.47%	100%

\*NOTE:  
6 UNITS USED FOR LEASING OFFICE/AMENITY AREA (2 C1 AND 4 B1 UNITS NOT SHOWN IN UNIT MIX)

UNIT SQ. FOOTAGE SCHEDULE			
UNIT TYPE	HEATED SQ. FOOTAGE	UNHEATED SQ. FOOTAGE	TOTAL GROSS
A1	698	74	772
A2	761	75	836
A3	756	100	856
B1	1059	96	1155
B2	1212	298	1510
B2a	1212	131	1343
C1	1435	310	1745
C1a	1435	143	1578
MAINT/PUMP ROOM	0	0	0
CLUBHOUSE	7136	90	8100

**SITE DATA:**

- 1 LEASING OFFICE (INTERNAL BLDG. 1)
- 1 POOL AREA
- 1 TRASH COMPACTOR AREA
- 1 MAIL KIOSK
- 1 DOGWASH/MAINTENANCE BUILDING
- 24 TOTAL STORAGE UNITS
- 1 TOTAL APARTMENT BUILDING WITH ELEVATORS

**UNIT & PARKING DATA:**

- 214 SURFACE PARKING
- 32 EXISTING PARKING
- 19 NET STORAGE BAYS (1 H/C)
- 24 STORAGE CLOSETS

173 TOTAL UNITS

1.54 SPACES PER UNIT

**SPRINKLER NOTES:**

1. ALL APARTMENTS TO BE SPRINKLERED IN ACCORDANCE WITH NFPA 13-R. PROVIDE SHOP DRAWINGS WITH REGISTERED (ALABAMA) ENGINEER'S STAMP FOR APPROVAL.

2. SPRINKLER COVERAGE SHALL INCLUDE LEASING OFFICE, STAIRS, BALCONIES, CORRIDORS & PATIOS WITH SIDEWALL HEADS.

**FAIR HOUSING NOTE:**

ALL UNITS TO BE CONSTRUCTED PER THE FAIR HOUSING ACT.

**FIRE DEPARTMENT CONNECTION:**

ALL FDC'S SHALL BE LOCATED AT THE SPRINKLER RISER ROOM MOUNTED AT 48" A.F.F. AND LABELED WITH 4" RED TEXT

**HANDICAP UNIT DATA:**

REQUIRED 2% OF TOTAL UNITS TO BE H/C ACCESSIBLE

2% OF THE ACCESSIBLE UNITS TO BE ADAPTED FOR THE HEARING/VISUAL IMPAIRED

UNIT A2 (1 BEDROOM) : 3 TOTAL UNITS  
UNIT B1 (2 BEDROOM) : 3 TOTAL UNITS  
UNIT C1 (3 BEDROOM) : 1 TOTAL UNITS

7 TOTAL HANDICAP UNITS (MARKED \*H/C\*)  
3 TOTAL AUDIO/VISUAL UNITS (1 EACH TYPE) (MARKED \*AV\*)

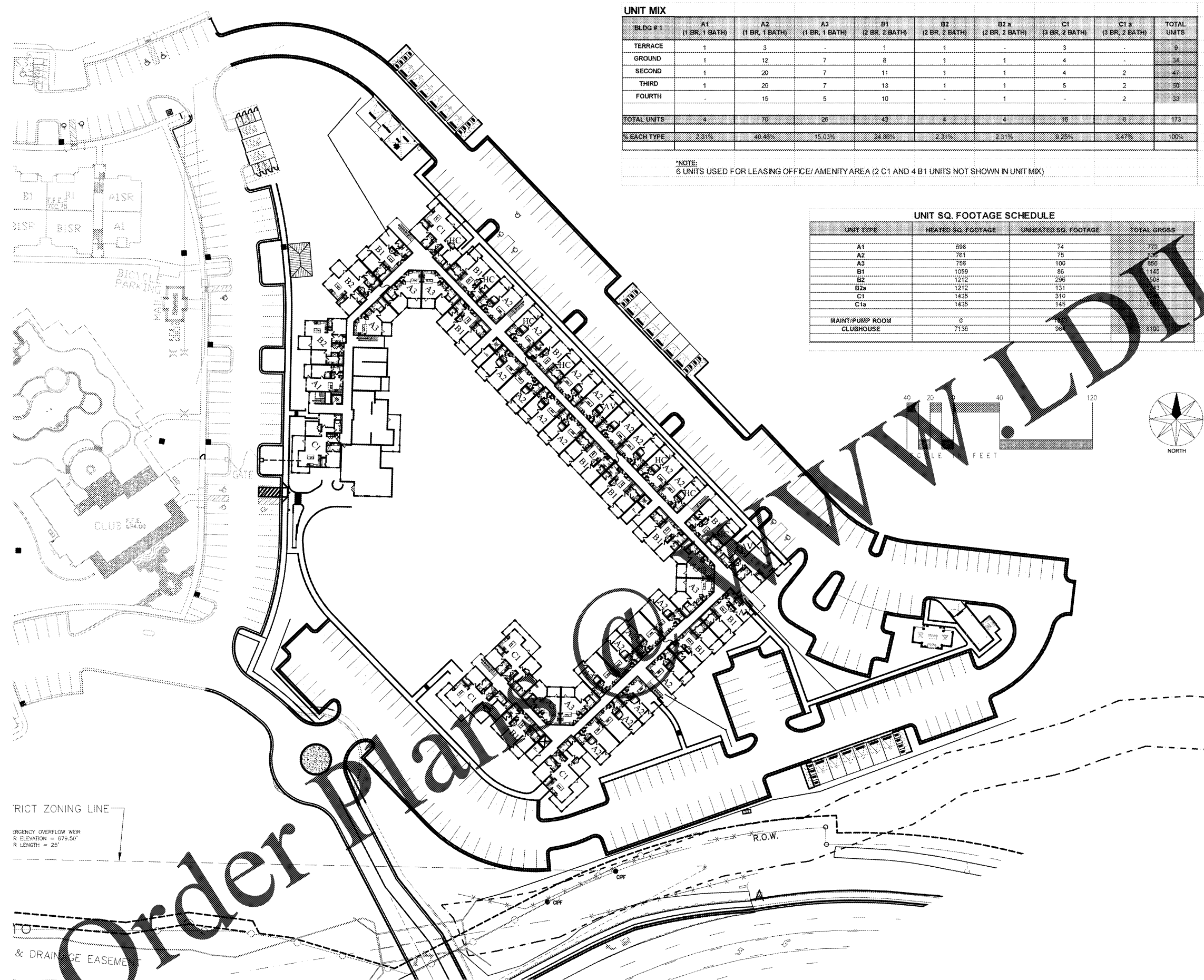

1 ARCHITECTURAL SITE PLAN  
A0.2 SCALE: 1" = 40'-0"

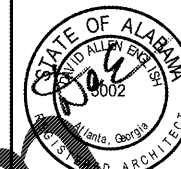

**PUCCIANO & ENGLISH, INC.**  
ARCHITECTS, AIA  
3084 MERCER UNIVERSITY DRIVE, SUITE 110  
ATLANTA, GA 30334  
PH 770-457-4823; FAX 770-451-0082  
dpenglish@pucciano-english.com



JOB No: 1701  
DRAWN BY:  
CHECK BY:  
JOB PROGRESS:  
ITEM DATE  
PRICING SET 07-14-2017  
PERMIT SET 02-26-2018

REVISIONS:  
DATE NO.

This drawing, as an instrument of service, is and shall remain the property of the Architect and shall not be reproduced, published or used in any way without the permission of the Architect.

*Legacy at Jones Farm Phase 2*  
HUNTSVILLE, ALABAMA  
AN APARTMENT COMMUNITY FOR  
RBJ BAILEY, LLC

ARCHITECTURAL SITE PLAN

SHEET NO.

A0.2