

**REVISIONS**

PROJECT: 1342  
 DATE: 11/11/16  
 DRAWN BY: ASA  
 CHECKED BY: MDH

**electrical ground floor lighting plan**

**E1.0**  
 10 OF 24

OPTIMA #: 16-0194

**GENERAL NOTES:**

1. REFER TO SHEET E0.1 FOR SYMBOL ABBREVIATIONS AND GENERAL NOTES.
2. CONTRACTOR SHALL COORDINATE ALL ELECTRICAL DEVICE AND LIGHT FIXTURE LOCATIONS WITH OTHER TRADES PRIOR TO INSTALLATION.
3. ALL EXIT SIGNS, NIGHT RINGS AND EMERGENCY EGRESS LIGHTS SHALL BE CONNECTED TO THE NEAREST LIGHTING CIRCUIT UNSWITCHED.  
 CONTRACTOR SHALL COORDINATE MOUNTING HEIGHTS OF ALL LIGHT FIXTURES PRIOR TO

**KEYED NOTES: (X)**

- 1 PROVIDE 600VA CENTRAL INVERTER ABOVE ACCESSIBLE CEILING WITH TEST SWITCH.
- 2 MOUNT FIXTURE 16 INCHES ABOVE STAIR STRINGER.

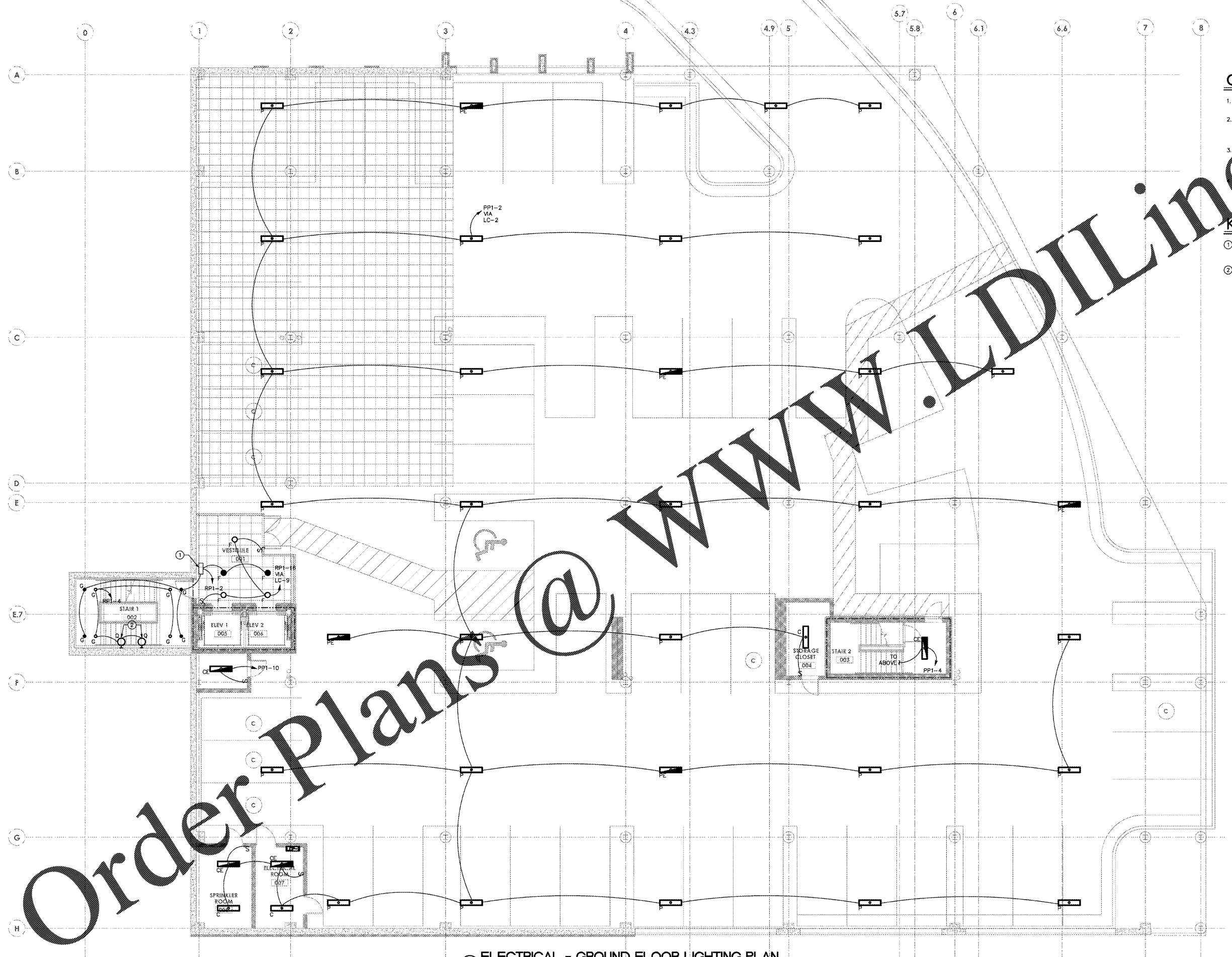

**1 ELECTRICAL - GROUND FLOOR LIGHTING PLAN**  
 1/8" = 1'-0"

L:\2016-R114-0194\AETIG.DWG

Order Plans @