

RECEIVED  
NOV 03 2017  
1736 E. SUNSHINE ST. SUITE 417  
SPRINGFIELD, MO

**STAGES OF CONSTRUCTION:**

1. THE OWNER/CONTRACTOR SHALL CONTACT THE DEPARTMENT OF PUBLIC WORKS' ENVIRONMENTAL COMPLIANCE MANAGER, 365-6181, A MINIMUM OF 48 HOURS PRIOR TO COMMENCEMENT OF LAND DISTURBANCE ACTIVITIES. A PRE-CONSTRUCTION MEETING IS REQUIRED UNLESS IT IS WAIVED BY THE ENVIRONMENTAL COMPLIANCE MANAGER.
2. CONTRACTOR TO PERFORM DETAILED SITE INSPECTION TO LOCATE ALL EXISTING UTILITIES AND VERIFY ANY POSSIBLE CONFLICTS WITH PROPOSED IMPROVEMENTS PRIOR TO BEGINNING ANY CONSTRUCTION. CONTACT OWNER WITH ANY CONFLICTS. MONTH 1
3. INSTALLATION OF CONSTRUCTION ENTRANCE. MONTH 1
4. INSTALLATION OF EROSION CONTROL FENCE. MONTH 1
5. DEMOLITION OF EXISTING TREES IN INDICATED LIMITS OF DISTURBANCE AREA. MONTH 1
6. INSTALLATION OF EXISTING INLET PROTECTION. MONTH 1
7. SCHEDULE AND OBTAIN APPROVAL FROM CHESTERFIELD COUNTY ENVIRONMENTAL ENGINEERING INSPECTOR BEFORE PROGRESSING. MONTH 1
8. INSTALLATION OF ALL STORMWATER DRAINAGE IMPROVEMENTS. MONTH 1
9. INSTALLATION OF INLET PROTECTION ON NEW STRUCTURES. MONTH 1
10. ROUGH GRADING. MONTH 1 & MONTH 2
11. REMOVE STOCKPILE. MONTH 2
12. CONSTRUCTION OF NEW SITE IMPROVEMENTS, SUCH AS BUT NOT LIMITED TO: UTILITIES, CURB & GUTTER, BUILDING, PAVEMENT. MONTH 2
13. FINAL GRADING. MONTH 3
14. PLACEMENT OF FINAL LANDSCAPING ITEMS AND SOD. MONTH 3
15. ONCE THE SITE HAS BEEN STABILIZED, THE DIRECTOR OF PUBLIC WORKS OR HIS DESIGNATED AGENT SHOULD BE CONTACTED FOR AN INSPECTION. UPON HIS APPROVAL, THE REMAINING EROSION CONTROL DEVICES MAY BE REMOVED. MONTH 3

**KEY NOTES:**

- E1 LIMITS OF SILT FENCE PER VESCH STD & SPEC 3.05. REFER TO DETAIL 1/C1.4.
- E2 INSTALL TEMPORARY STONE CONSTRUCTION ENTRANCE PER VESCH STD & SPEC 3.02. REFER TO DETAIL 2/C1.4.
- E3 INSTALL INLET PROTECTION PER VESCH STD & SPEC 3.07. REFER TO DETAILS 3/C1.4 & 4/C1.4.
- E4 INSTALL CONCRETE WASHOUT. REFER TO DETAILS 5/C1.4.
- E5 TEMPORARY SEEDING. PER COUNTY SEEDING NOTES ON SHEET C1.3.
- E6 PERMANENT SEEDING. PER COUNTY SEEDING NOTES ON SHEET C1.3.
- E7 MULCHING. PER COUNTY MULCHING NOTES ON SHEET C1.3.
- E8 INSTALL 5' X 5' RIP-RAP PAD. REFER TO RIP-RAP NOTES ON SHEET C1.4.

**EROSION & SEDIMENT CONTROL NARRATIVE:**

**PROJECT DESCRIPTION**  
THE PURPOSE OF THIS PROJECT IS THE CONSTRUCTION OF A NEW RETAIL AUTO PARTS STORE. THE SITE IS LOCATED ON CROSSWHITTS DRIVE (VA STATE ROUTE 1339), IMMEDIATELY SOUTHWEST OF THE SHEETZ CONVENIENCE STORE LOCATED ON THE WEST CORNER OF LEADBETTER RD AND SLIDING HILL ROAD (VIRGINIA STATE ROUTE 656). THE SITE WILL CONSIST OF CONSTRUCTION OF ONE 10,000 SF BUILDING, PARKING AREAS, AND LAWN. A TOTAL OF 0.70 ACRES WILL BE DISTURBED DURING CONSTRUCTION.

**EXISTING SITE CONDITIONS**  
THE EXISTING SITE HAS SLOPES RANGING FROM 7.0:1 TO 4.0:1 AND DRAINS TOWARD THE NORTHEASTERN BOUNDARY. THE SITE IS VACANT AND IS COVERED WITH GOOD CONDITION GRASS. THE SITE CONSISTS OF TWO DRAINAGE AREAS, ONE DRAINING TO THE EXISTING INLET ON THE EAST SIDE OF THE SITE AND ONE SURFACE DRAIN TO THE EXISTING STORMWATER SYSTEM IN THE JOINT ACCESS ROAD. THE SITE SLOPES AT APPROXIMATELY 1.0%-2.0% FROM SOUTHWEST TO NORTHEAST, WITH THE EXCEPTION OF 4.0:1 SLOPES ON THE EAST SIDE OF THE SITE NEXT TO THE EXISTING INLET.

**ADJACENT PROPERTY**  
CROSSWHITTS DRIVE (VA STATE ROUTE 1339) BORDERS THE PROPERTY ON THE WEST. ON THE NORTH IS THE JOINT ACCESS DRIVE AND SHEETZ CONVENIENCE STORE. ON THE EAST IS THE EXISTING FROZEN YOGURT STORE. TO THE SOUTH AND WEST ARE VACANT LOTS.

**OFF-SITE AREAS**  
THERE IS NO PROPOSED OFF-SITE WORK.

**SOILS**  
SEE ON-SITE STORMWATER POLLUTION PREVENTION PLAN FOR SOIL AREAS.

1. NORFOLK FINE SANDY LOAM, MAP UNIT=47B, HSG=B, ERODIBILITY (K)<sub>s</sub>=0.32, STRUCTURE: 0'-14"=FINE SANDY LOAM; 14"-79"=CLAY LOAM; WATER TABLE=48"-72", PERMEABILITY=0.57-1.99 IN/HR
2. DUPLIN FINE SANDY LOAM, MAP UNIT=25A/B, HSG=C, ERODIBILITY (K)<sub>s</sub>=0.32, STRUCTURE: 0'-9"=FINE SANDY LOAM; 9"-79"=SANDY CLAY; WATER TABLE=24"-42", PERMEABILITY=0.20-0.57 IN/HR

**CRITICAL EROSION AREAS**  
3:1 SLOPES ALONG PARKING LOT TO BE STABILIZED WITH TEMPORARY EROSION CONTROL BLANKETS TO PREVENT EROSION.

**EROSION AND SEDIMENT CONTROL MEASURES - STRUCTURAL PRACTICES**

1. SILT FENCE BARRIER - 3.05  
SILT FENCE SEDIMENT BARRIERS WILL BE INSTALLED DOWNSLOPE OF AREAS WITH MINIMAL GRADES TO FILTER SEDIMENT-LADEN RUNOFF FROM SHEET FLOW AS INDICATED ON THE PLAN.
2. TEMPORARY CONSTRUCTION ENTRANCE - 3.02  
A TEMPORARY CONSTRUCTION ENTRANCE SHALL BE INSTALLED WHERE THE ACCESS AREA INTERSECTS WITH THE SHARED ENTRANCE.
3. STORM DRAIN INLET PROTECTION - 3.07  
ALL STORM SEWER INLETS SHALL BE PROTECTED DURING CONSTRUCTION. SEDIMENT-LADEN RUNOFF SHALL BE FILTERED BEFORE ENTERING THE STORM SEWER INLETS. ALL STORM SEWER INLET PROTECTION SHALL REMAIN IN PLACE UNTIL ALL ONSITE CONTRIBUTING WATERSHEDS ARE STABILIZED.

**STABILIZATION**  
ALL AREAS OF THE SITE WILL BE STABILIZED PER THE EROSION AND SEDIMENT CONTROL AND POLLUTION PREVENTION PLAN NOTES. REFER TO SHEET C1.3 FOR EROSION CONTROL AND STABILIZATION METHODS.

**STORMWATER MANAGEMENT**  
THE FROZEN STORMWATER MANAGEMENT SYSTEM HAS BEEN SIZED TO DISCHARGE THE PROPOSED STORMWATER AT OR BELOW THE ALLOWABLE RATES FOR THE EXISTING SYSTEM, REFER TO THE SUBMITTED STORMWATER REPORT.

**MANAGEMENT STRATEGIES**

1. CONSTRUCTION WILL BE SEQUENCED SO THAT GRADING OPERATIONS CAN BEGIN AND END AS QUICKLY AS POSSIBLE.
2. TEMPORARY SEEDING OR OTHER STABILIZATION WILL FOLLOW IMMEDIATELY AFTER GRADING.
3. AREAS WHICH ARE NOT TO BE DISTURBED WILL BE CLEARLY MARKED BY FLAGS, SIGNS, ETC.
4. THE JOB SUPERINTENDENT SHALL BE RESPONSIBLE FOR THE INSTALLATION AND MAINTENANCE OF ALL EROSION AND SEDIMENT CONTROL PRACTICES.
5. AFTER ACHIEVING STABILIZATION, THE TEMPORARY EAS CONTROLS WILL BE CLEANED UP AND REMOVED, AND THE SEDIMENT CONTROLS WILL BE CLEANED UP AND SEDIMENT REDISTRIBUTED ACROSS THE SITE.

**MAINTENANCE**  
IN GENERAL, ALL EROSION AND SEDIMENT CONTROL MEASURES WILL BE CHECKED DAILY AND AFTER EACH SIGNIFICANT RAINFALL. THE FOLLOWING ITEMS WILL BE CHECKED IN PARTICULAR:

1. THE SILT FENCE BARRIER WILL BE CHECKED REGULARLY FOR UNDERMINING OR DETERIORATION OF THE FABRIC. SEDIMENT SHALL BE REMOVED UNTIL THE LEVEL OF SEDIMENT DEPOSITION REACHES HALF TO THE TOP OF THE BARRIER. ADJUST SILT FENCE PER FIELD CONDITIONS TO CONTAIN ALL SEDIMENT ON SITE.
2. THE SEEDED AREAS WILL BE CHECKED REGULARLY TO ENSURE THAT A GOOD STAND IS MAINTAINED. AREAS SHOULD BE FERTILIZED AND RESEDED AS NEEDED.

**EROSION CONTROL & MAINTENANCE PLAN NOTES:**

1. PRIOR TO COMMENCEMENT OF ANY LAND DISTURBANCE ACTIVITIES, A LAND DISTURBANCE PERMIT MUST BE ISSUED BY THE DEPARTMENT OF PUBLIC WORKS. AN APPROVED EROSION AND SEDIMENT CONTROL PLAN AND BONDING OF THE EROSION AND SEDIMENT CONTROL MEASURES IS REQUIRED FOR PERMIT ISSUANCE.
2. A SEPARATE LAND DISTURBANCE PERMIT OR AN ESC PLAN AMENDMENT TO THIS PLAN MUST BE SUBMITTED TO, AND APPROVED BY HANOVER COUNTY DPW PRIOR TO ANY OFF-SITE LAND DISTURBANCE (BORROW / FILLING / DISPOSAL ACTIVITIES) ASSOCIATED WITH THIS PROJECT. THE OFF-SITE PORTION OF THE PROJECT IS LOCATED WITHIN HANOVER COUNTY. ADDITIONAL EAS INSPECTION FEES WILL BE REQUIRED.
3. CONTACT THE DEPARTMENT OF PUBLIC WORKS' ENVIRONMENTAL COMPLIANCE MANAGER, 365-6181, A MINIMUM OF 48 HOURS PRIOR TO COMMENCEMENT OF LAND DISTURBANCE ACTIVITIES. A PRE-CONSTRUCTION MEETING IS REQUIRED UNLESS IT IS WAIVED BY THE ENVIRONMENTAL COMPLIANCE MANAGER.
4. NO WORK MAY OCCUR OUTSIDE THE LIMITS OF DISTURBANCE SHOWN ON THE APPROVED PLANS. WORKING OUTSIDE OF THE LIMITS OF DISTURBANCE SHOWN ON THE APPROVED PLANS WILL RESULT IN A STOP WORK ORDER BEING ISSUED WITH THE POTENTIAL FOR FINES BEING LEVIED.
5. PERMANENT OR TEMPORARY SOIL STABILIZATION SHALL BE APPLIED TO DENuded AREAS WITHIN SEVEN (7) DAYS AFTER THE FINAL GRADE IS REACHED ON ANY PORTION OF THE SITE.
6. TEMPORARY SOIL STABILIZATION SHALL BE APPLIED WITHIN SEVEN (7) DAYS TO DENuded AREAS THAT MAY NOT BE AT FINAL GRADE BUT WILL REMAIN DORMANT FOR LONGER THAN THIRTY (30) DAYS.
7. DURING CONSTRUCTION OF THE PROJECT, SOIL STOCK PILES SHALL BE STABILIZED OR PROTECTED WITH EROSION AND SEDIMENT TRAPPING MEASURES.
8. STABILIZATION MEASURES SHALL BE APPLIED TO EARTHEN STRUCTURES SUCH AS DIKES, DITCHES, AND TRENCHES IMMEDIATELY AFTER INSTALLATION.
9. EROSION AND SEDIMENT CONTROL MEASURES SHALL BE CONSTRUCTED AND INSTALLED AS A FIRST STEP IN ANY LAND-DISTURBING ACTIVITY AND SHALL BE MADE FUNCTIONAL BEFORE UPOUSE LAND DISTURBANCE TAKES PLACE. INITIAL CLEARING MUST BE THE FIRST STEP IN INSTALLING EROSION AND SEDIMENT CONTROL MEASURES AND DEVICES. SHOULD EITHER THE EROSION AND SEDIMENT CONTROL NARRATIVE OR SEEDING OF CONSTRUCTION CONFLICT WITH THIS REQUIREMENT, THE CONFLICTING PORTIONS OF EITHER WILL BE DETERMINED TO BE INVALID.
10. A PERMANENT VEGETATIVE COVER SHALL BE ESTABLISHED IN DENuded AREAS NOT OTHERWISE PERMANENTLY STABILIZED. PERMANENT VEGETATION SHALL NOT BE CONSIDERED ESTABLISHED UNTIL A GROUND COVER IS ACHIEVED. IN THE OPINION OF THE COUNTY ENGINEER OR HIS DESIGNATED AGENT, IS UNIFORM MATURE ENOUGH TO SURVIVE AND WILL INHIBIT EROSION.
11. UNDERGROUND UTILITY LINES SHALL BE INSTALLED IN ACCORDANCE WITH THE FOLLOWING STANDARDS IN ADDITION TO OTHER APPLICABLE CRITERIA:  
11.a. NO MORE THAN 500 LINEAR FEET OF TRENCH MAY BE OPEN AT ONE TIME.  
11.b. EXCAVATED MATERIAL SHALL BE PLACED ON THE UPPER END OF TRENCHES.  
11.c. EFFLUENT FROM DEMANDING OPERATIONS SHALL BE TRAPPING DEVICE, OR BOTH, AND DISCHARGED IN A MANNER THAT DOES NOT ADVERSELY AFFECT FLOWING STREAMS OR ON SITE PROPERTY.  
11.d. RESTABILIZATION SHALL BE IN ACCORDANCE WITH THE ABOVE NOTES.
12. ALL APPLICABLE FEDERAL, STATE, AND LOCAL REGULATIONS PERTAINING TO WORKING IN OR CROSSING LIVE WATERCOURSES SHALL BE MET.
13. WHERE CONSTRUCTION ACCESS ROUTES INTERSECT PAVED PUBLIC ROADS, PROVISIONS SHALL BE MADE TO MINIMIZE THE TRANSPORT OF SEDIMENT BY TRACKING ONTO THE PAVED SURFACE. THE SEDIMENT IS TRANSPORTED ONTO A PUBLIC ROAD SURFACE, THE ROAD SHALL BE CLEANED THOROUGHLY AT THE END OF EACH DAY. SEDIMENT SHALL BE REMOVED FROM THE ROADS BY SHOVELING OR SWEEPING AND TRANSPORTED TO A DISPOSAL AREA.
14. IT SHALL BE THE OWNER'S RESPONSIBILITY TO INSPECT EROSION CONTROL DEVICES PERIODICALLY AND AFTER EVERY ERODIBLE RAINFALL. ANY NECESSARY REPAIRS OR CLEAN UP TO MAINTAIN THE EFFECTIVENESS OF THE EROSION CONTROL DEVICES SHALL BE MADE IMMEDIATELY.
15. ADDITIONAL EROSION AND SEDIMENT CONTROL MEASURES AND DEVICES MAY BE REQUIRED BY THE DIRECTOR OF PUBLIC WORKS OR HIS DESIGNATED AGENT IF DEEMED NECESSARY.
16. THE OWNER SHALL INSTALL ADDITIONAL EROSION AND SEDIMENT CONTROL DEVICES AND MEASURES IF THE REGISTERED LAND DISTURBER DETERMINES THAT SUCH ADDITIONAL DEVICES AND MEASURES ARE NECESSARY.
17. ALL EROSION CONTROL DEVICES SHALL BE IN PLACE AND FUNCTIONAL AT ALL TIMES AND IF REMOVED FOR CONSTRUCTION PROGRESS, SHALL BE REPLACED BY THE CLOSE OF EACH WORKDAY.
18. REMOVAL OF EROSION CONTROL DEVICES SHALL NOT OCCUR UNTIL THE DIRECTOR OF PUBLIC WORKS OR HIS DESIGNATED AGENT DEEMS THE SITE STABILIZED.
19. PERMANENT SEEDING IS TO BE IN ACCORDANCE WITH THE ACCOMPANYING SEEDING SCHEDULE.
20. CONSTRUCTION SITE OPERATORS ARE REQUIRED TO CONTROL WASTE SUCH AS DISCARDED BUILDING MATERIALS, CONCRETE TRUCK WASHOUT, CHEMICALS, LITTER, AND SANITARY WASTE AT THE CONSTRUCTION SITE THAT MAY CAUSE ADVERSE IMPACTS TO WATER QUALITY.
21. CONSTRUCTION SITE OPERATORS ARE REQUIRED TO CONTROL THE TRANSPORT OF DUST AND OTHER WIND BORN CONTAMINANTS AS A RESULT OF LAND-DISTURBING, DEMOLITION AND CONSTRUCTION ACTIVITIES. THE OPERATOR SHALL PREVENT THE SURFACE AND AIR MOVEMENT OF AIRBORNE SUBSTANCES IN ACCORDANCE WITH STD AND SPEC 3.30 OF THE VIRGINIA EROSION AND SEDIMENT CONTROL HANDBOOK OR AS APPROVED BY THE DIRECTOR OF PUBLIC WORKS OR HIS DESIGNATED AGENT.

**SYMBOLS LEGEND**

	PROPOSED NEW GRADE LINES
	EXISTING GRADE LINES
	SOIL MAP LIMITS
	LIMITS OF DISTURBANCE
	SILT FENCE
	PROPOSED FLOW ARROW
	INLET PROTECTION
	CONSTRUCTION EGRESS
	CONCRETE WASHOUT

**EROSION & SEDIMENT CONTROL MEASURES QUANTITIES**

ITEM #	ITEM	UNIT	QUANTITY
1.	SILT FENCE	LF	600
2.	TEMPORARY STONE CONSTRUCTION ENTRANCE	EA	1
3.	INLET PROTECTION	EA	5
4.	CONCRETE WASHOUT	EA	1
5.	TEMPORARY SEEDING	AC	0.11
6.	PERMANENT SEEDING	AC	0.11
7.	MULCHING	AC	0.11
8.	RIP-RAP PAD	EA	1

**RESPONSIBLE LAND DISTURBER:**  
THE CONTRACTOR SHALL LIST THE RESPONSIBLE LAND DISTURBER, THE NAME, "WALK-IN ADDRESS", AND TELEPHONE NUMBER OF A LOCAL REGISTERED AGENT REPRESENTING THE OWNER FOR SERVICE OF PROCESS MUST BE PROVIDED ON THE PLANS IN THE BLOCK BELOW. THE RESPONSIBLE LAND DISTURBER MUST ALSO BE PRESENT AT THE PRE-CONSTRUCTION MEETING PRIOR TO ISSUANCE OF A LAND DISTURBANCE PERMIT. ON THE FOLLOWING LINE:

NAME & ADDRESS DISTURBER # PHONE #  
CONSTRUCTION CANNOT BEGIN UNTIL THIS INFORMATION IS PROVIDED. REGISTRATION CAN BE OBTAINED AT THE FOLLOWING WEBSITE: www.dcr.virginia.gov/soil\_e\_water/eas\_rfd.shtml



**ANDERSON ENGINEERING**  
EMPLOYEE OWNED  
ENGINEERS - SURVEYORS - LABORATORIES - DRILLING  
2646 W. WOODS DRIVE, SPRINGFIELD, MISSOURI 65807  
PHONE: (417) 862-2741  
FAX: (417) 862-2741  
ANDERSON COUNTY REG. # 036269  
PROJ # 10017 DRAWING # WB-110-811

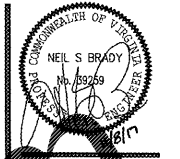

**CRAIG A. SCHNEIDER, AIA**  
ARCHITECT  
1736 East Sunshine, Suite 417  
Springfield, Missouri 65804  
e-mail: architect@estcrtschneider.com  
PHONE: (417) 862-0558  
FAX: (417) 862-0558

**ORGANIC MULCH MATERIALS AND APPLICATION RATES**

MULCHES	Per Acre	Per 1000 sq. ft	NOTES
Straw or Hay	1 1/2 - 2 tons (Minimum 2 tons for winter cover)	350 lbs.	Free from weeds and coarse matter. Must be anchored. Spread with mulch blower or by hand.
Fiber Mulch	1500 lbs	35 lbs.	Do not use as mulch for winter cover or during hot, dry periods. * Apply as slurry
Coarse Stalks	4-6 - tons	185-275 lbs	Cut or shredded in 4-6" lengths. Air-dried. Do not use in fine turf areas. Apply with mulch blower or by hand.
Wood Chips	4-6 tons	185- 275 lbs.	Free of coarse matter. Air-dried. Treat with 12 lbs nitrogen per ton. Do not use in fine turf areas. Apply with mulch blower, chip handler, or by hand.
Bark Chips Or Shredded Bark	50-70 cu. Yds.	1-2 cu. Yds.	Free of coarse matter. Air-dried. Do not use in fine turf areas. Apply with mulch blower, chip handler, or by hand.

\* When fiber mulch is the only available mulch during periods when straw should be used, apply at a minimum rate of 2000 lbs./ac. Or 45 lbs./1000 sq ft.

**LIMING REQUIREMENTS FOR TEMPORARY SITES**

pH Test	Recommended Application of Agricultural Limestone
Below 4.2	3 tons per acre
4.2 to 5.2	2 tons per acre
5.2 to 6	1 ton per acre

**SEEDING MIXTURES, RATES, AND DATES: SOUTHERN PIEDMONT AND COASTAL PLAIN**

SITE CONDITIONS	SEEDING MIXTURES	RATES		DATES		
		PER ACRE	PER 1000 ft <sup>2</sup>	3/1 to 4/15	4/15 to 8/1	8/1 to 10/15
High Maintenance Lawns	1. Tall fescue - 90% Kentucky bluegrass - 10%	250 lbs	6 lbs	X	no	X
Low Maintenance General Use	2. Tall fescue - 50% Ladino clover - 10% Red clover - 10% Korean lespedeza - 15% Annual ryegrass - 15%	80 lbs	2 lbs	X	(a,b) X	X
	3. Tall fescue - 50% Sericea lespedeza - 30% Annual ryegrass - 20%	70 lbs	1 1/2 lbs	X	(a)X	X
Droughty Areas, Sandy Soils	4. Tall fescue - 50% Sericea lespedeza - 20% Korean lespedeza - 15% Annual ryegrass - 15%	80 lbs	2 lbs	X	(a,b) X	X
Poorly Drained Areas	5. Tall fescue - 65% Korean lespedeza - 20% Annual ryegrass - 10% Redtop - 5%	80 lbs	2 lbs	X	(a,b) X	X

- a) After May 1, use 10 lb/A german millet or 2 lb/A weeping lovegrass in place of annual ryegrass.
- b) After May 1, Korean lespedeza will not reseed itself. You may increase the amount of other legumes accordingly.

**ACCEPTABLE TEMPORARY SEEDING PLANT MATERIALS "QUICK REFERENCE FOR ALL REGIONS"**

Planting Dates	Species	Rate (lbs./acre)
Sept. 1 - Feb. 15	50/50 Mix of Annual Ryegrass (Lolium multi-florum) & Cereal (Winter) Rye (Secale cereale)	50 - 100
Feb. 16 - Apr. 30	Annual Ryegrass (Lolium multi-florum)	60 - 100
May 1 - Aug. 31	German Millet (Setaria italica)	50

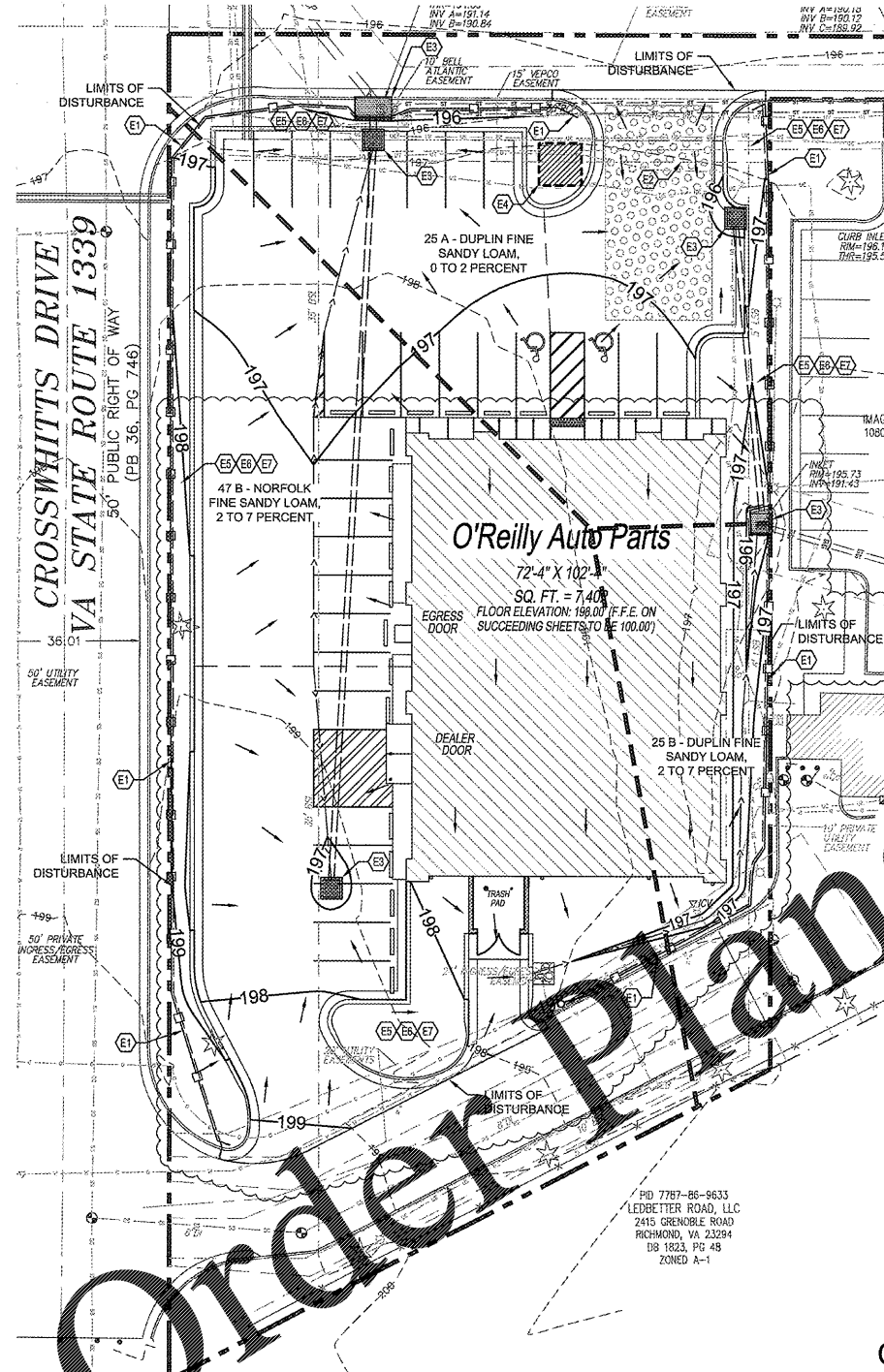

**1 EROSION AND SEDIMENT CONTROL PLAN**  
C1.3 SCALE: 1" = 20'

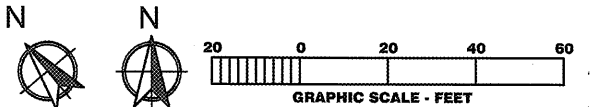

**DEVELOPER INFO:**

O'REILLY AUTOMOTIVE STORES, INC.  
233 SOUTH PATTERSON  
SPRINGFIELD, MO 65802  
PHONE: (417) 862-3333

PROJECT ADMINISTRATOR:  
ROBERT TURRENTINE  
PHONE: (417) 868-4248  
FAX: (417) 874-7112

Source: VA SWCC

SPR-7-17  
HTE 17-3000019

**PROJECT:**  
NEW O'REILLY AUTO PARTS STORE  
SLIDING HILL PLACE  
ASHLAND, VA #2 - ASHLAND MAGISTERIAL DISTRICT  
EROSION AND SEDIMENT CONTROL PLAN

**O'Reilly AUTO PARTS**  
CORPORATE OFFICES  
233 SOUTH PATTERSON  
SPRINGFIELD, MISSOURI 65802  
(417) 862-2674 TELEPHONE

COMM # 3993  
DATE: 2-24-17  
REVISION DATE: 8-16-17  
11-3-17

C1.3