

LIFE SAFETY LEGEND

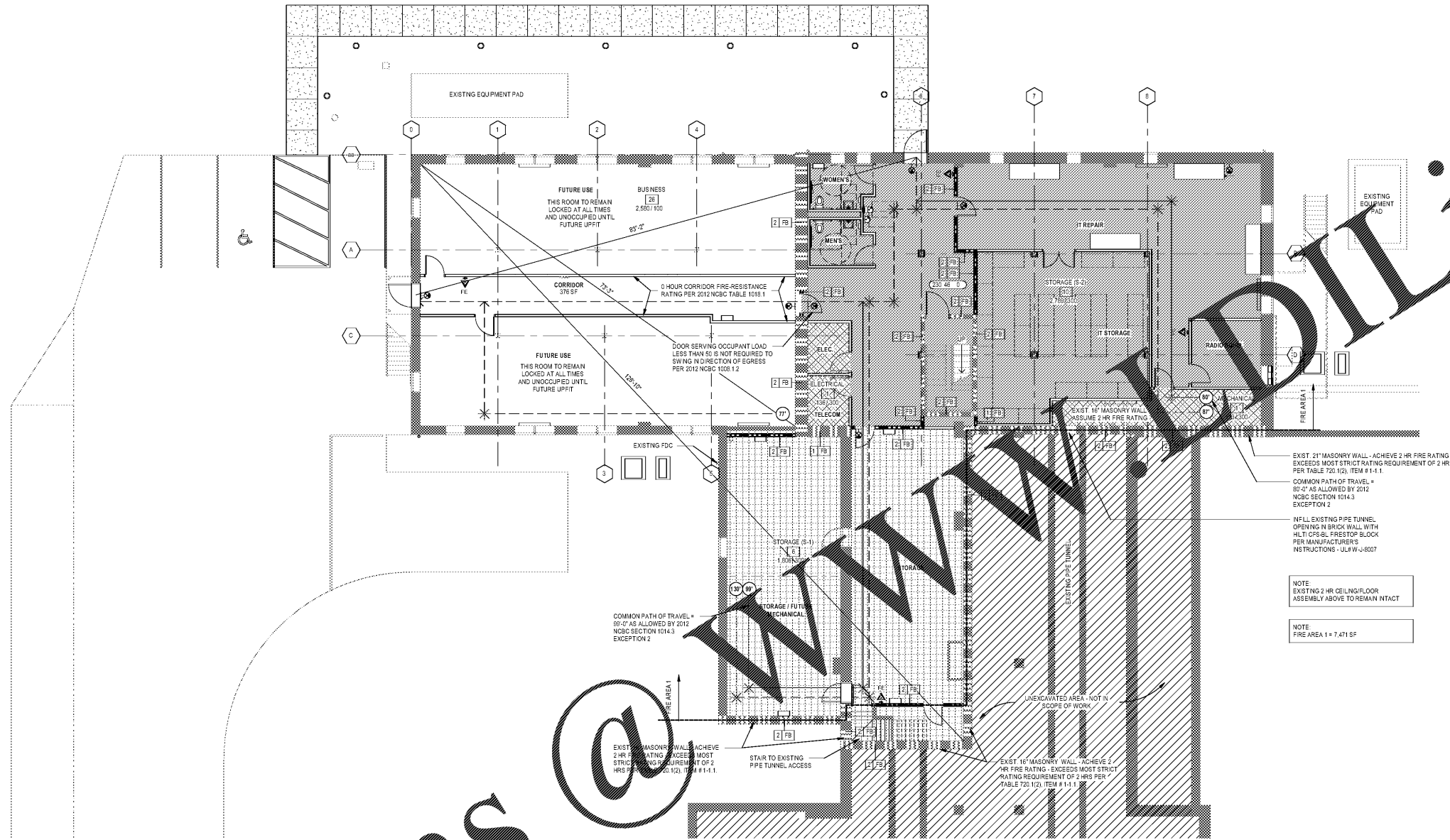

EXIST. 21' MASONRY WALL - ACHIEVE 2 HR FIRE RATING - EXCEEDS MOST STRICT RATING REQUIREMENT OF 2 HRS PER TABLE 702.1(2), ITEM #1-1.1.
COMMON PATH OF TRAVEL = 80'-0" AS ALLOWED BY 2012 NCBC SECTION 1014.3 EXCEPTION 2.
NOTE: EXISTING 1 HR CEILING/FLOOR ASSEMBLY ABOVE TO REMAIN INTACT.
NOTE: FIRE AREA 1 = 7,471 SF.

2 BASEMENT FLOOR LIFE SAFETY PLAN
1/8" = 1'-0"

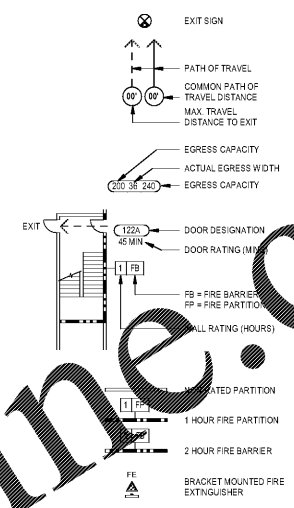
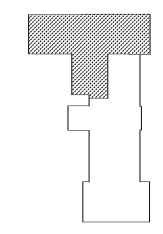

KEY PLAN



WESTERN CAROLINA UNIVERSITY
MOORE HALL GROUND FLOOR RENOVATION
CULLOWHEE, NC

| SHEET NO. | DATE | DESCRIPTION | BY |
|-----------|----------|---------------|----|
| 1 | 03/07/18 | ISSUE FOR BID | AR |

PRINCIPAL IN CHARGE: RS
PROJECT ARCHITECT: LR
DRAWN BY: AR
SHEET TITLE: BASEMENT LIFE SAFETY

SHEET NO. G110
PROJ. NO. 017384
AGENCY REVIEW ID: 17-1742-G1A

Order Plans

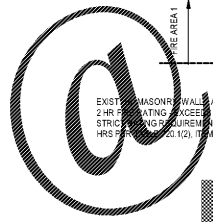

WWW.DILine.com

McMillan Adam Smith ARCHITECTURE
305 Commerce Street, Salisbury, NC 28134
704.338.8888
www.mcmillanadamsmith.com