

Order Plans

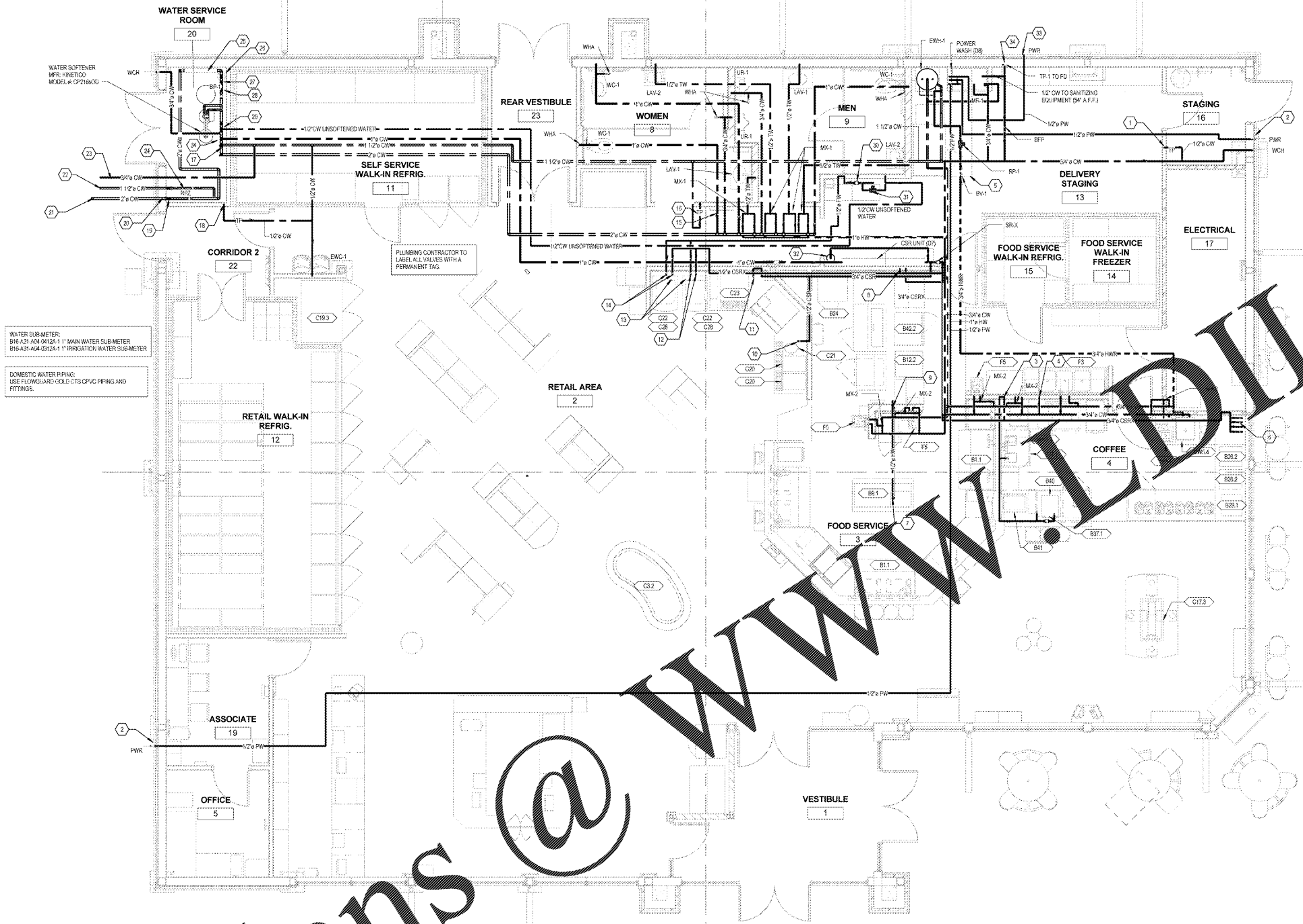

- PLUMBING KEYNOTES**
- 1/2" TRAP PRIMER TO FLOOR DRAIN IN THE STAGING AREA.
 - 1/2" PW SUPPLY DN TO OUTLET BOX.
 - RUN 3/4" CSRX WATER LINE DOWN NEAR WALL AND CONNECT TO (2) B31.1 & ENG ADD WATER FILTER TO BAS.
 - 1/2" TRAP PRIMER TO FLOOR DRAIN FOR WALK-IN REFRIG. AND FREEZER.
 - BALANCING VALVES SET TO 1 GPM.
 - 1/2" CSRX WATER TO E28.2 (2), 1/2" CSRX WATER TO E28.1, 1/2" CSRX WATER TO FUTURE MACHINE.
 - RUN 1/2" HW LINE UNDER SLAB AND THEN COME UP TO CONNECT TO B31.1 FLOOR FITTING TO USED RUN FLEX UNDERGROUND INSIDE 1-1/2" CONDUIT.
 - 1/2" CSRX AND CW PROVIDE 3/4" MALE HOSE OUTLET CONNECTED TO B42.2 BREAD OVEN. CSRX TO GENERATOR AND TAP WATER TO CLEAN THE OVEN.
 - RUN 1/2" HW LINE AND CONNECT TO B31.1 FLOOR FITTING.
 - 1/2" CSRX WATER LINE TO C21.
 - 1/2" CSRX WATER TO C23.
 - 1/2" FILTER TO C23. CSRX WATER TO B31.1 FLOOR FITTING.
 - 1/2" WATER LINE TO STAGING AREA. PANEL AVOID CONFLICTS WITH ELECTRICAL LINES.
 - 1/2" COLD WATER TO C28. CSRX WATER TO C28.
 - MANIFOLD VALVES FOR RESTROOMS TO BE LOCATED 12 INCHES ABOVE DROP CEILING.
 - 1/2" TRAP PRIMER TO FLOOR DRAINS IN MEN'S AND WOMEN'S RESTROOMS.
 - MESSENGER WATER MANIFOLD: 1" CW TO CSRX SYSTEM, 2" CW TO TOILET ROOMS AND 1 1/2" FUTURE. LOCATE SHUT-OFF VALVES 24" BELOW CEILING IN WATER ROOM.
 - 1/2" TRAP PRIMER TO FLOOR DRAIN IN WATER SERVICE ROOM AND WALK-IN REFRIGERATOR. LOCATE 12" ABOVE DROP CEILING.
 - INCOMING PRESSURE TO BUILDING SHALL BE A MINIMUM OF 55 PSI STATIC AT STREET AND A MINIMUM OF 20 PSI STATIC SHALL BE MAINTAINED AT BUILDING AFTER METER AND BACKFLOW. INSTALL A 1" WATER SUB-METER WITH 10-GALLON DRY CONTACT PULSE FOR INTERLINK TO BAS SYSTEM.
 - WATER SERVICE SHALL COME DIRECTLY INTO BUILDING WITH NO FITTING PER SITE ENGINEERING PLAN SE-1. (DEEP LONG SWEEP IS REQUIRED TO GET INTO BUILDING).
 - 2" DOMESTIC WATER SERVICE METER LOCATED IN EXTERIOR PIT. SEE CIVIL PLAN FOR CONTRADICTION.
 - 1 1/2" LAWN IRRIGATION SPRINKLER SUPPLY. VERIFY REQUIREMENTS WITH WAWA PROJECT MANAGER.
 - 3/4" COLD WATER LINE RUN DOWN IN WALL AND THEN UNDERGROUND. CONTINUE COLD WATER LINE UNDERGROUND TO WALL WYERANT LOCATED IN COLUMN IN GAS CANOPY AREA. USE BLACK POLY PEV PIPE. REFER TO GAS CANOPY SHEET CA-1.
 - 1 1/2" LAWN IRRIGATION SUPPLY. 1" RP2 BACKFLOW PREVENTER, 1" WATER SUB-METER WITH 1 GALLON DRY CONTACT PULSE FOR INTERLINK TO BAS SYSTEM. (DO NOT INTERLINK IRRIGATION TO BAS IF RECLAIM WATER IS AVAILABLE.)
 - BOOSTER PUMP CONTROLLER (WITH BYPASS SEE WATER RISER).
 - DIAPHRAGM TANK.
 - 40" PRESSURE TRANSDUCER. PART # ADFP-100-20.
 - WATER PRESSURE GAUGE WATTS LFDPG1-3 (0-100 PSI).
 - 1/2" CW BEFORE WATER SOFTENER SYSTEM FOR FREESTYLE.
 - FREESTYLE FILTER MOUNTED TO WALL.
 - FREESTYLE BOOSTER PUMP MOUNTED ON BIB RACK AT APPROX. 6' 6".
 - CSRX SURGE TANK MOUNTED ON PLATFORM (MOUNT @ 7'-10" A.F.F.).
 - 1/2" PW SUPPLY DOWN IN WALL AND RUN UNDERGROUND TO OUTLET BOX LOCATED IN DUMPSTER AREA.
 - 1/2" TRAP PRIMER LINE TO FLOOR DRAIN IN DELIVERY STAGING.

WATER METER:
B16-A21-A04-0412A-1 1" MAIN WATER SUB-METER
B16-A31-A04-0312A-1 1" IRRIGATION WATER SUB-METER

DOMESTIC WATER PIPING:
USE FLOW/LOAD-GOLD-CITS CPVC PIPING AND FITTINGS.

1 WATER PIPING PLAN

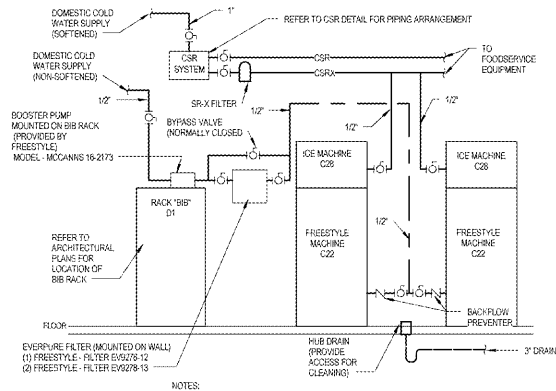

2 FREESTYLE PLUMBING DETAIL
NOT TO SCALE

1925 Prospect Ave.
Orlando, FL 32814
P (407) 661-9100
F (407) 661-9101
www.rjg.com

CLIENT NAME
WAWA
280 WEST BALTIMORE PIKE
WAWA, PENNSYLVANIA 19083

PROJECT NAME
WAWA F85FB 2017.01 STORE #5294-CNY
28508 US 19 NORTH
CLEARWATER, FL 33761

SHEET TITLE
WATER PIPING PLAN

Rev	Description	Date
1	PRELIMINARY	01/17/2017
2	PERMITS REVIEW SET	07/28/2017
3	BID SET	09/04/2017

PROJECT NO.
2016022

DATE
01/12/2017

DRAWN
JAC

CHECKED
C/cher

2017.01.12