

Order Plans

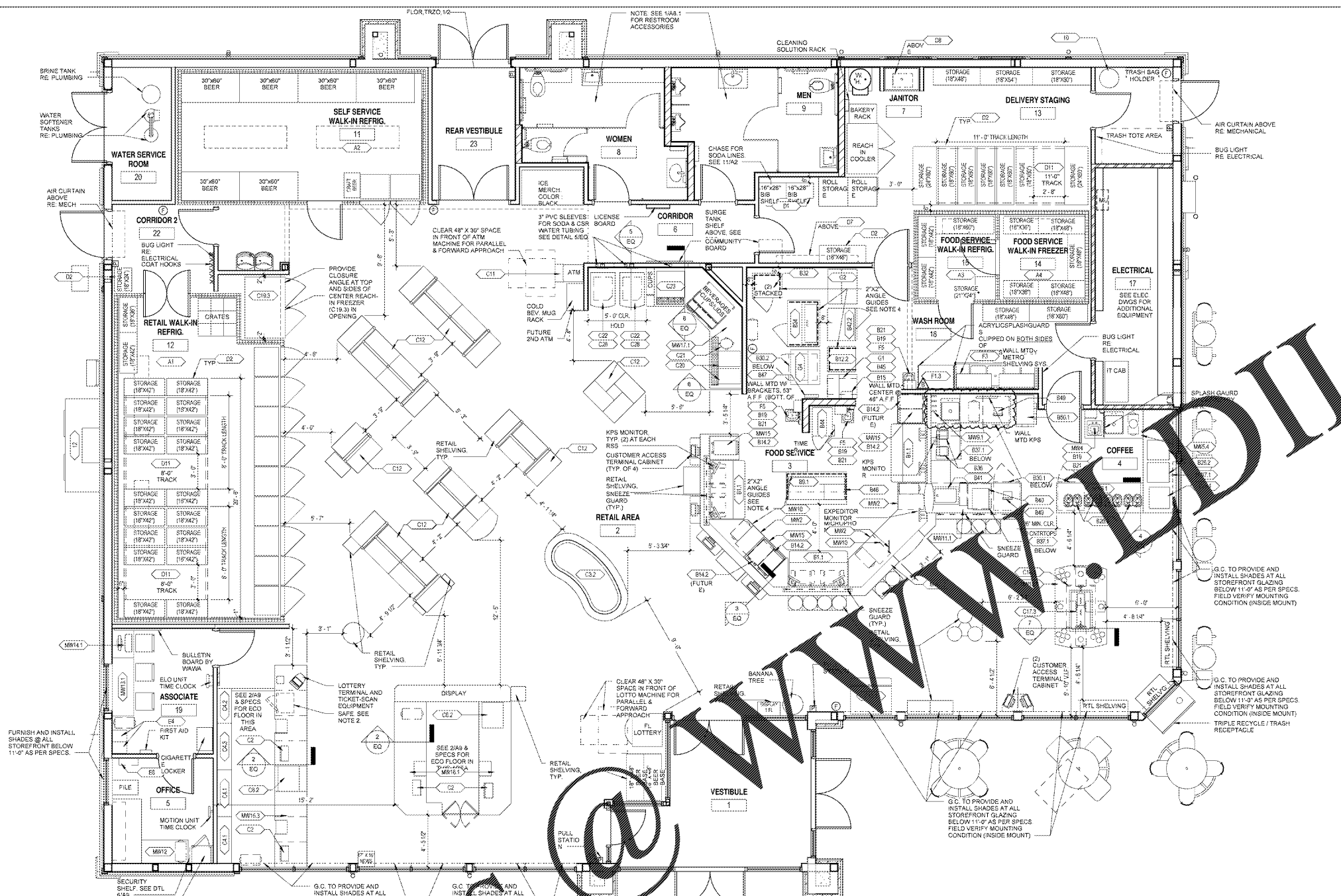

1 EQUIPMENT PLAN  
EQ 1/4" = 1'-0"

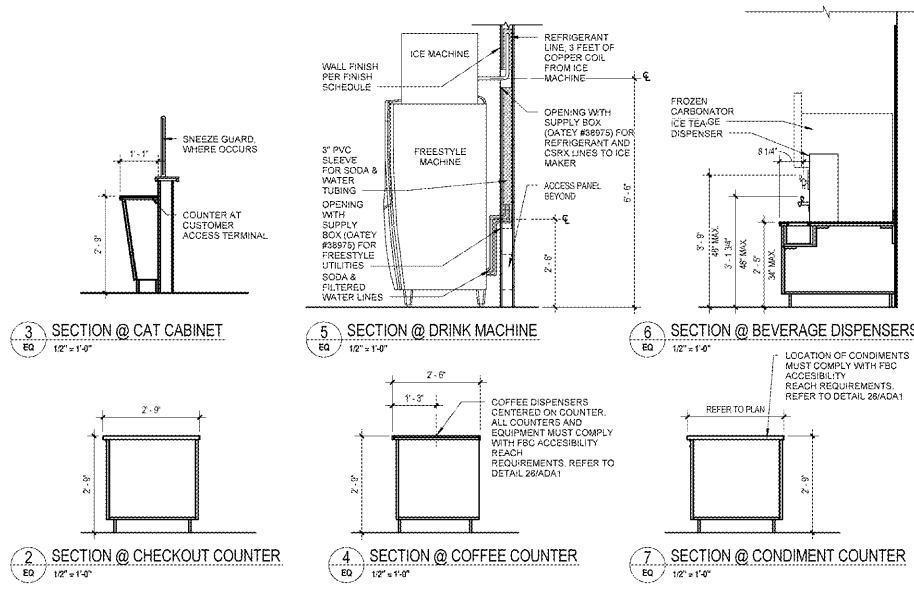

EQ#	DESCRIPTION	INSTALLED BY
A-1	WALK-IN REFRIGERATOR	REF
A-2	RETAIL WALK-IN REFRIGERATOR	REF
A-3	SELF SERVICE WALK-IN REFRIGERATOR	REF
A-4	FOOD SERVICE WALK-IN REFRIGERATOR	REF
A-5	FOOD SERVICE WALK-IN FREEZER	REF
B-1	FOOD SERVICE COFFEE	WAWA
B-1.1	REFRIGERATED SANDWICH STATION (8" RISS)	GC
B-1.2	HOT FOOD TABLE W/ OVERSHELF	GC
B-1.3	REFRIGERATED DISPLAY CASE	GC
B-1.4	TOASTER OVEN	WAWA
B-1.5	COFFEE UNIT	GC
B-1.6	SCAP DISPENSER	GC
B-1.7	PAPER TOWEL DISPENSER	GC
B-1.8	OPEN WORKSTATION	WAWA
B-1.9	COFFEE BREWER DOUBLE	WAWA
B-1.10	COFFEE DISPENSER WITH STAND	WAWA
B-1.11	COMPACTION MACHINE - 6 FLAVOR	WAWA
B-1.12	27" UNDERCOUNTER REFRIGERATOR	GC
B-1.13	27" UNDERCOUNTER FREEZER	GC
B-1.14	CONVECTION OVEN & STAND	WAWA
B-1.15	SMOOTHIE BLENDER	WAWA
B-1.16	UNDERCOUNTER ICE MACHINE	WAWA
B-1.17	ESPRESSO MACHINE W/ WALL FILTER	WAWA
B-1.18	REFRIGERATED DRIP IN	WAWA
B-1.19	ROLL OVEN (LEFT HINGED)	GC
B-1.20	ROLL OVEN (RIGHT HINGED)	GC
B-1.21	PEP DRINK DISPENSER	WAWA
B-1.22	FLING UNIT	WAWA
B-1.23	MAINTENANCE BLENDER	GC
B-1.24	SOFT ICE SINGLE MOUNT	WAWA
C-1	AREA	WAWA
C-1.1	ICE	GC
C-1.2	REFRIGERATED DISPLAY - 4' ISLAND	WAWA
C-1.3	REFRIGERATED DISPLAY W/ STORAGE 4 TOB	WAWA
C-1.4	REFRIGERATED DISPLAY W/ STORAGE 3 TOB	WAWA
C-1.5	REFRIGERATED DISPLAY W/ STORAGE 4 TOP	WAWA
C-1.6	REFRIGERATED DRIP IN CONDENSER LARGE	GC
C-1.7	SOFT ICE MACHINE - 2 TIER LARGE	WAWA
C-1.8	COFFEE CONDIMENT DISPLAY - FLORIDA SMALL	WAWA
C-1.9	BEAN IN REFRIGERATOR - 2 DOOR	REF
C-1.10	ICE TEA MACHINE	WAWA
C-1.11	REFRIGERATED DRIP IN CONDENSER LARGE	GC
C-1.12	COFFEE DISPENSER	WAWA
C-1.13	ICE TEA MACHINE	WAWA
C-1.14	FREE STYLE BEVERAGE DISPENSER	WAWA
C-1.15	FROZEN CARBONATOR BEVERAGE (P-2)	VENDOR
C-1.16	CLUBBED ICE MACHINE ABOVE VENDOR	VENDOR
D-1	BACK OF HOUSE	WAWA
D-1.1	BAG IN BOX SHIELDING RACK	WAWA
D-1.2	STORAGE SHELVING	WAWA
D-1.3	MPT TRASH UNIT	GC
D-1.4	DISPENSER UNIT	GC
D-1.5	POWER WASH	GC
D-1.6	ROLLING STORAGE SHELVES	WAWA
D-1.7	LOCKERS	GC
D-1.8	VEEDER FOOT	GAS
F-1	WASHROOM	WAWA
F-1.1	DRINKING FOUNTAIN	WAWA
F-1.2	COMPARTMENT SINK	GC
F-1.3	S.S. HAND SINK WALL HUNG	GC
G-1	ASSEMBLED WORKSTATIONS (METRO)	WAWA
G-1.1	METRO RETAILMANAGER FREEZERS/STATION	WAWA
G-1.2	METRO ROLL BAKING FREEZERS/STATION	WAWA
G-1.3	SUZUKI WORKSTATION	WAWA
Z-1	EXTERIOR EQUIPMENT	WAWA
Z-1.1	PORTABLE POWER WASH (FUTURE)	GC
Z-1.2	BILLY LIGHT	GC
Z-1.3	CALIBRATION CONTAINER	GC
Z-1.4	BAG OF SALT	GC
Z-1.5	SALT DISPENSER	GC
Z-1.6	SAFETY CLEAN	GC
Z-1.7	CO2 TANK	GC
Z-1.8	OUTDOOR ICE MERCHANTS	GC

EQ#	DESCRIPTION	INSTALLED BY
MW-1	MILLWORK	WAWA
MW-2	ROLLING DRAWER CABINET	CABINET
MW-3	WRAP COUNTER	CABINET
MW-4	HANDSINK CABINET	CABINET
MW-5	COFFEE BREWER W/ SINK S.S. COUNTERTOP	CABINET
MW-6	COFFEE SERVER COUNTER	CABINET
MW-7	COFFEE DISPENSER CABINET	CABINET
MW-8	FULL SERVICE DRINK COUNTER	CABINET
MW-9	DRINK DISPENSER	CABINET
MW-10	FULL SERVICE DRINK COUNTER	CABINET
MW-11	DESK UNIT	CABINET
MW-12	TABLE 22" X 30"	CABINET
MW-13	ASSOCIATE COUNTER TABLE (30" X 22")	CABINET
MW-14	DRAWER	CABINET
MW-15	ISLAND CHECKOUT COUNTER	CABINET
MW-16	MAIN CHECKOUT COUNTER 17'-0"	CABINET
MW-17	BEVERAGE CENTER COUNTER	CABINET
MW-18	CONDIMENT COUNTER	CABINET

**LEGEND**

(1) LOCATED IN TRASH COMPOUND. SEE SHEET A16

ATM AUTOMATIC TELLER MACHINE

(2) FIRE EXTINGUISHER. LOCATE TOP OF UNIT 48" MAX AFF

(3) EQUIPMENT NUMBER. SEE EQUIPMENT SCHEDULE

(4) SPLASH GUARD

(5) MUSIC SYSTEM ON 12" X 18" SHELF

(6) 1/2" PVC TUBE WITH THREADED CAP 30" IN LENGTH. MTD. VERTICALLY TO WALL WITH METAL STRAPS

**GENERAL NOTES**

1. FLOOR ANCHORS: ALL TOP TRACK ROLLING STORAGE SHELVES SYSTEMS MUST BE BOLTED TO THE FLOOR TO KEEP THE SYSTEM FROM MOVING. G.C. TO BOLT THE TRIANGULAR FOOT PLATES OF THE STATIONARY UNITS WITH 3/8" DIAMETER SELF-ANCHORING BOLTS TO EXTEND INTO THE FLOORING MATERIAL AT LEAST ONE INCH.

2. G.C. TO BOLT TWO SAFES TO THE FLOOR. ONE IN THE MANAGER'S OFFICE AND ONE AT CHECKOUT CORE.

3. WALK-IN BOX MANUFACTURER TO PROVIDE VINYL BASE FOR INTERIOR OF BOXES ONLY.

4. PROVIDE 2" X 2" ANGLE GUIDES FOR EQUIPMENT AS NOTED. 3 SIDES.

1925 Prospect Ave  
Orlando, FL 32814  
P (407) 661-9100  
F (407) 661-9101  
www.cpa.com

**CLIENT NAME**  
WAWA  
280 WEST BALTIMORE PIKE  
WAWA, PENNSYLVANIA 19083

**PROJECT NAME**  
WAWA F85FB 2017.01 STORE #5294-CNY  
28008 US 19 NORTH  
CLEARWATER, FL 33761

**SHEET TITLE**  
EQUIPMENT PLAN

201602  
DATE 01/03/2017  
FILE NO. REVIEWSHEET 07/28/2017  
BID SET 09/04/2017  
REVISED 09/06/2017

PROJECT NO.  
DATE  
PROJECT  
CHECKED  
DATE

EQ