

PROPOSED  
FINISHED  
FLOOR  
100.00

MONUMENT OR PYLON SIGN. PROVIDE DISCONNECT SWITCH & WEATHER-RESISTANT G.F.I. OUTLET IN LOCKABLE WEATHER-PROOF ENCLOSURE AT BOTTOM OF STRUCTURE. PROVIDE 120V CIRCUIT W/ 2000 PLUS 100-0ND IN 1" PVC. MAKE CONNECTIONS TO SIGNAGE PER MANUFACTURER'S RECOMMENDATIONS FROM LOAD SIDE OF SWITCH COORDINATE ALL REQUIREMENTS WITH PROPERTY MANAGEMENT PRIOR TO EXCAVATION. COORDINATE WITH EASEMENTS AND EASEMENT ENTITIES IN THE IMMEDIATE AREA.

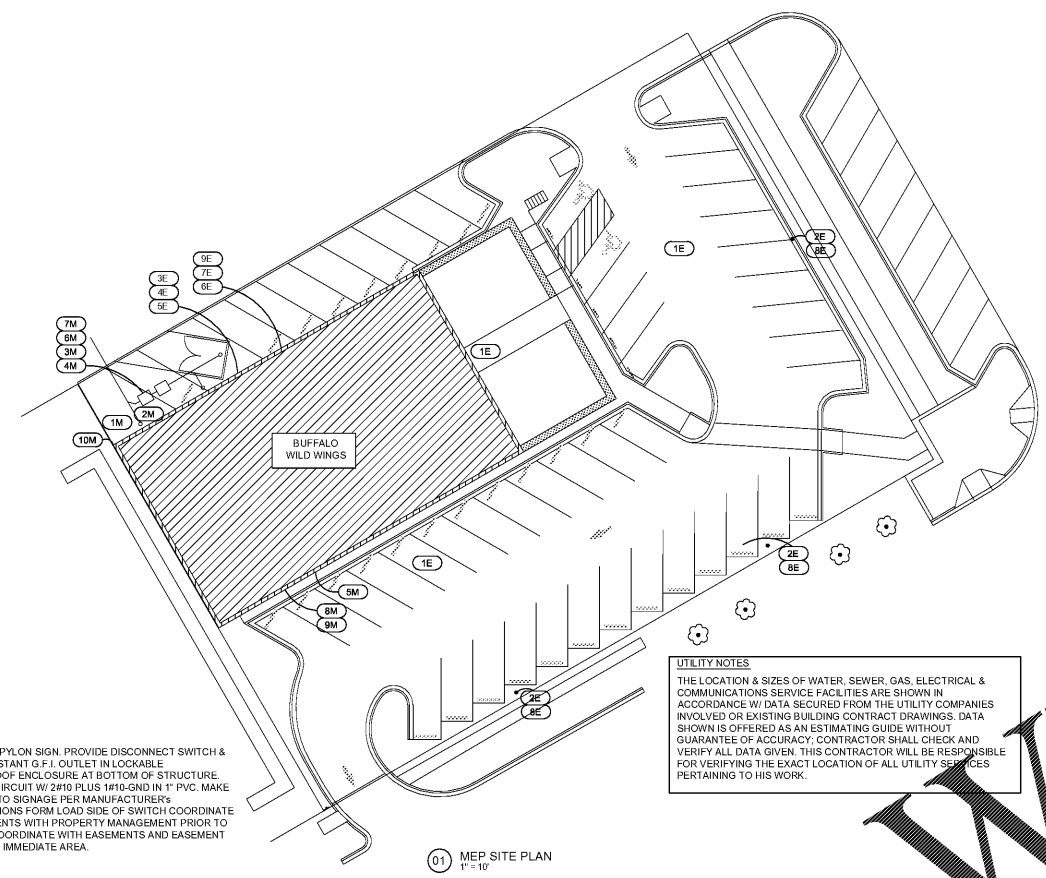

01 MEP SITE PLAN  
1"=10'

**UTILITY NOTES**  
THE LOCATION & SIZES OF WATER, SEWER, GAS, ELECTRICAL & COMMUNICATIONS SERVICE FACILITIES ARE SHOWN IN ACCORDANCE W/ DATA SECURED FROM THE UTILITY COMPANIES INVOLVED OR EXISTING BUILDING CONTRACT DRAWINGS. DATA SHOWN IS OFFERED AS AN ESTIMATING GUIDE WITHOUT GUARANTEE OF ACCURACY. CONTRACTOR SHALL CHECK AND VERIFY ALL DATA GIVEN. THIS CONTRACTOR WILL BE RESPONSIBLE FOR VERIFYING THE EXACT LOCATION OF ALL UTILITY SERVICES PERTAINING TO HIS WORK.

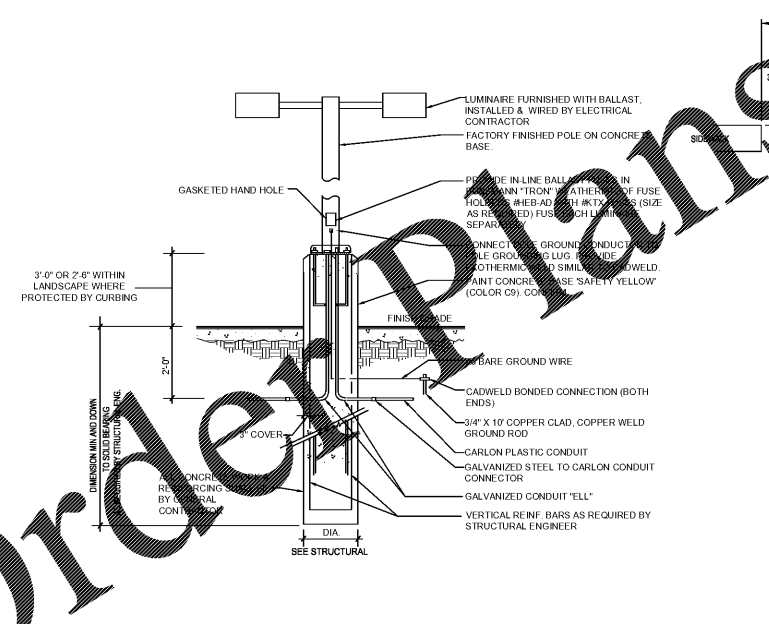

02 LIGHT POLE ASSEMBLY FOUNDATION WITH CONCRETE BASE  
N.T.S.

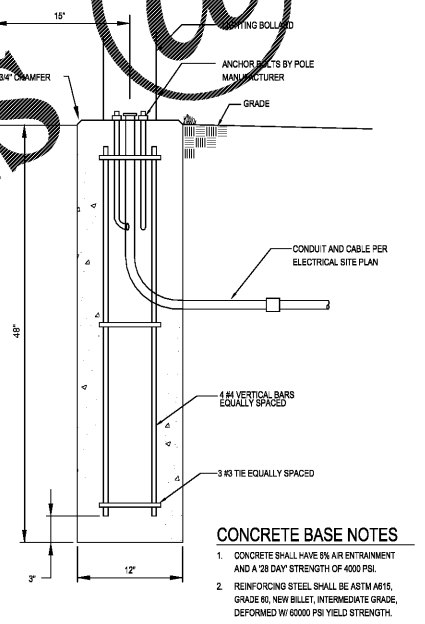

05 BOLLARD ASSEMBLY FOUNDATION WITH CONCRETE BASE  
N.T.S.

**CONCRETE BASE NOTES**  
1. CONCRETE SHALL HAVE 2% AIR ENTRAINMENT AND A 28 DAY STRENGTH OF 4000 PSI.  
2. REINFORCING STEEL SHALL BE ASTM A615, GRADE 60, NEW BILLET, INTERMEDIATE GRADE, DEFORMED W/ 60000 PSI YIELD STRENGTH.

**ELECTRICAL KEY NOTES**

- 1E ROUTE EXTERIOR LIGHTING & SIGN CIRCUITS THROUGH LIGHTING RELAYS. REFER TO SHEET E302 FOR ADDITIONAL INFORMATION.
- 2E REFER TO LIGHT POLE ASSEMBLY FOUNDATION DETAIL LOCATED ON THIS SHEET FOR LIGHT POLE MOUNTING DETAIL.
- 3E PROVIDE ELECTRICAL UTILITY SERVICE DISCONNECT (208V/3PH/4W, 800A SERVICE ENTRANCE RATED SWITCH) AS NECESSARY BY APPLICABLE LOCAL CODES. VERIFY FIRE DEPARTMENT REQUIREMENTS PRIOR TO SITE EXCAVATION. ROUTE SECONDARY AS INDICATED ON SHEETS E201 & E302.
- 4E PROVIDE ELECTRICAL UTILITY SERVICE METERING ROUGH-IN PER LOCAL POWER UTILITY COMPANY REQUIREMENTS. PROVIDE CT4, CT ENCLOSURE, WIRING, ETC. AS NECESSARY TO SATISFY ALL APPLICABLE REQUIREMENTS. SEE SHEETS E201 & E302.
- 5E ELECTRICAL UNDERGROUND PRIMARY SERVICE TO BUILDING. COORDINATE ELECTRIC SERVICE CONTRACTOR REQUIREMENTS W/ UTILITY COMPANY PRIOR TO SITE EXCAVATION.
- 6E PROVIDE TWO 2" CONDUIT FOR TELECOMM SERVICE. ROUTE ALL CONDUITS UNDERGROUND. COORDINATE ALL UTILITY SERVICES W/ SERVICE PROVIDERS PRIOR TO SITE EXCAVATION.
- 7E PROVIDE ONE 2" FOR CATV SERVICE. ROUTE ALL CONDUITS UNDERGROUND. COORDINATE ALL UTILITY SERVICES W/ SERVICE PROVIDERS PRIOR TO SITE EXCAVATION.
- 8E REFER TO BOLLARD ASSEMBLY FOUNDATION DETAIL LOCATED ON THIS SHEET FOR LIGHT POLE MOUNTING DETAIL.
- 9E PROVIDE NEW UNDERGROUND ELECTRICAL SERVICE SECONDARY CONDUITS AND CONDUCTORS. COORDINATE WITH CIVIL ENGINEER AND POWER COMPANY PRIOR TO COMMENCING WORK.

**ELECTRICAL GENERAL NOTES**

1. SIGNAGE SHOWN ON THIS PLAN IS PROPOSED ONLY & IS TO BE VERIFIED BY A SIGN SURVEY.
2. ELECTRICAL CONTRACTOR SHALL VERIFY ALL POWER & COMMUNICATIONS REQUIREMENTS PRIOR TO COMMENCING WORK.
3. ELECTRICAL CONTRACTOR TO VERIFY SERVICE ENTRANCE METHODS PRIOR TO COMMENCING WORK. VERIFY WHETHER SERVICE ENTRANCE IS OVERHEAD OR UNDERGROUND.
4. SIGNAGE TO BE INSTALLED BY SIGN CONTRACTOR. VERIFY EXACT LOCATIONS, LOADS & WIRING REQUIREMENTS PRIOR TO INSTALLATION.
5. ELECTRICAL CONTRACTOR SHALL PROVIDE ALL CONDUIT, POWER WIRING, GROUNDINGS & ALL ESSENTIAL CONNECTIONS FOR SIGNAGE, PARKING LOT LIGHTS, IRRIGATION SYSTEM & OTHER SYSTEMS REQUIRED TO MAKE COMPLETE OPERABLE SYSTEMS FOR THIS PROJECT.
6. ELECTRICAL CONTRACTOR SHALL COORDINATE ALL INSTALLATIONS WITH CIVIL ENGINEER & WITH SITE CONTRACTOR. REVIEW ALL ASSOCIATED DRAWINGS RELATED TO THIS SITE PRIOR TO COMMENCING WORK.
7. UNDERGROUND CONDUIT INSTALLATIONS SHALL COMPLY WITH NEC ARTICLE 300.5.
8. POLE LIGHT ASSEMBLIES: PROVIDE POLES AND LIGHT FIXTURES AS SPECIFIED UNLESS OTHERWISE INDICATED. VERIFY WITH PROPERTY REPRESENTATIVE AND APPLICABLE CODES. ALL REQUIREMENTS REGARDING SITE & SIGNAGE LIGHTING. WHERE DEVELOPER SPECIFIC POLE LIGHT ASSEMBLIES, PROVIDE ASSEMBLIES IN ACCORDANCE TO SUCH REQUIREMENTS. ALL SITE LIGHTING SHOULD BE SITE ADAPTED TO THE STANDARD APPROVED LOCAL ENERGY CODES. LIGHTING REQUIREMENTS SHALL BE PROVIDED BY THE DEVELOPER.
9. ON THE SITE SURVEY OF PROPERTY, THEN LOCATE & IDENTIFY ALL UNDERGROUND EXISTING PIPING, DUCT BANKS, DIRECT BURIED CABLE, AND OTHER SYSTEMS THAT MAY BE LOCATED UNDERGROUND WITHIN THE AREA OF THE BUILDING SITE.
10. COORDINATE ALL EXCAVATION WITH APPROPRIATE OWNER'S REPRESENTATIVES AND UTILITY OFFICIALS PRIOR TO BEGINNING CONSTRUCTION. UTILITY OFFICIALS SHALL BE DEFINED AS THE COMPANIES PROVIDING ELECTRICAL SERVICE, TELEPHONE AND COMMUNICATIONS SERVICE, CABLE TV SERVICE & OTHER COMPANIES THAT MAY HAVE SERVICES TO THIS BUILDING. CONFIRM ALL EXISTING UTILITY SERVICE COMPANIES WITH OWNER, LANDLORD AND/OR DEVELOPER PRIOR TO BEGINNING CONSTRUCTION.
11. WHERE EXCAVATION IS NECESSARY IN AREAS WHERE KNOWN UNDERGROUND ENTITIES ARE PRESENT (REGARDLESS OF INDICATED DEPTHS), THE CONTRACTOR SHALL TAKE PRECAUTIONS TO PREVENT THE DISRUPTION OF EXISTING UNDERGROUND ENTITY. THE CONTRACTOR SHALL BE RESPONSIBLE FOR THE REPAIR AND/OR RE-INSTALLATION OF ENTITIES OR SYSTEMS, WHICH ARE DAMAGED DURING EXCAVATION.
12. COORDINATE THE INSTALLATION OF NEW UNDERGROUND CONDUITS WITH OTHER TRADES TO MINIMIZE EXCAVATIONS & TO PREVENT CONFLICT OR INTERRUPTION OF SERVICES DURING EXCAVATION.
13. UNDERGROUND ELECTRICAL SERVICE CONDUITS SHALL BE INSTALLED AT 30" BELOW FINISHED GRADE. PROVIDE A MINIMUM OF SIX INCHES OF CONCRETE COVER WITH RED DYE FINISH AT 1" TOP OF CONCRETE SURFACE. ALLOW TO PROPERLY CURE PRIOR TO BACKFILL.
14. POWER & LIGHTING CONDUITS SHALL BE BURIED AT 24" BELOW GRADE. WHERE CONDUITS ARE INDICATED TO PASS BENEATH EXISTING CONCRETE SURFACES, PROVIDE PROTECTION FOR EXISTING SURFACE PRIOR TO BORING BENEATH THE INDICATED SURFACE. CONDUITS MAY BE BURIED TO 12" BELOW BOTTOM OF EXISTING CONCRETE SURFACE.

03 ELECTRICAL SITE NOTES

**NOTES BY SYMBOL**

- 1M CONNECT SANITARY WASTE AT LOCATION PROVIDED BY CIVIL. SEE CIVIL SITE UTILITY PLANS FOR CONTINUATION.
- 2M TWO-WAY CLEANOUT REFER TO 30P101 FOR DETAIL.
- 3M BELOW GRADE GREASE INTERCEPTOR REFER TO P101 FOR DETAIL. COORDINATE LOCATION WITH CONSTRUCTION MANAGER & CIVIL ENGINEER'S SITE UTILITY PLANS.
- 4M GREASE INTERCEPTOR VENTS BELOW GRADE, EXTEND TO BUILDING.
- 5M 2" DOMESTIC WATER SERVICE. SEE CIVIL SITE UTILITY PLANS FOR CONTINUATION.
- 6M GREASE INTERCEPTOR VENT THRU ROOF. TO BE INSTALLED 10'-0" MIN. FROM ANY FRESH AIR INTAKE ON ROOF. COORDINATE WITH MECHANICAL EQUIPMENT ON ROOF.
- 7M SAMPLE WELL REFER TO P102 FOR DETAIL.
- 8M 8" FIRE PROTECTION LINE TO BUILDING. SEE CIVIL ENGINEER'S CONSTRUCTION DRAWINGS FOR CONTINUATION.
- 9M WALL MOUNTED FIRE DEPARTMENT CONNECTION.
- 10M PLUMBING CONTRACTOR TO COORDINATE WITH GENERAL CONTRACTOR AND GAS UTILITY COMPANY TO HAVE GAS SERVICE AND METER INSTALLED AT BUILDING. GAS SERVICE TO BE 2" PSI MEDIUM PRESSURE. SEE SHEET P-001 FOR GAS DEMAND SCHEDULE.
- 11M CLEANOUT REFER TO 38P101 FOR DETAIL.

**PLUMBING UTILITIES NOTES:**

- A. COORDINATE ALL SERVICE REQUIREMENTS WITH UTILITY COMPANIES AND INCLUDE ALL WORK REQUIRED IN BID.
- B. UTILITIES INFORMATION ARE APPROXIMATELY SHOWN. CONTRACTOR SHALL FIELD VERIFY ALL LOCATIONS AND SITE CONDITIONS PRIOR TO BID/CONSTRUCTION.
- C. PLUMBING CONTRACTOR SHALL PAY FOR ALL EXPENSES TO RELOCATE/REMOVE EXISTING UTILITIES BUT ARE NOT LIMITED TO WATER, SEWER, GAS, ETC. PER UTILITY COMPANIES SPECS. AND REQUIREMENTS.
- D. GENERAL CONTRACTORS SHALL NOTE THAT ALL WORK TO BE DONE SUCH AS EXCAVATIONS, TRENCHES, CAISSONS, WALLS, ETC. AS INDICATED ON DRAWINGS IS SHOWN WITHOUT KNOWLEDGE OF UNDERGROUND UTILITIES ON THIS PARTICULAR SITE. THE ENGINEER AND OWNER ASSUME NO RESPONSIBILITY FOR DETERMINING THEIR LOCATION, SIZE, DEPTH OR HAZARD.
- E. CONTRACTOR TO CONTACT ALL UTILITY COMPANIES FOR LINE LOCATIONS 72 HOURS PRIOR TO EXCAVATION.

04 PLUMBING SITE NOTES

CERTIFICATION



PROJECT NUMBER  
5748

**BUFFALO WILD WINGS**  
BIRMINGHAM  
1416 4th AVENUE SOUTH,  
BIRMINGHAM, AL 35233



DRAWING ISSUE		DATE
NO.	DESCRIPTION	
1		
2		
3		
4		
5		
6		
7		

Drawing Title  
**MEP SITE PLAN**

**MEP001**