

**OCCUPANCY LOAD FACTORS:**  
 NON- SEPARATED MIXED USE  
 GROUP S1 - 100 GROSS SF / OCCUPANT

**LEGEND- EXIT**  
 36" - CLEAR EXIT WIDTH  
 ◊ - ACTUAL EXIT DOOR OCCUPANT LOAD  
 180 - EXIT DOOR CAPACITY  
 OCCUPANCY CLASSIFICATION  
 S1 / 225 / 11- AREA OCCUPANT LOAD  
 AREA SF  
 TOTAL GROSS BUILDING AREA = 15,140 SF  
 TOTAL OCCUPANT LOAD = 151

USE GROUP OR SPACE DESCRIPTION	OCCUPANCY TYPE	EXIT WIDTH				NUMBER AND ARRANGEMENT OF EXITS											
		(A) AREA SQ. FT.	(B) AREA PER OCCUPANT (T. 1004.1.1)	CALCULATED OCCUPANT LOAD	TOTAL OCCUP. LOAD PER AREA	EXIT WIDTH (IN)				MINIMUM NUMBER OF EXITS		TRAVEL DISTANCE		ARRANGEMENT OF MEANS OF EGRESS (SECTION 1015.2)			
						STAIR	LEVEL	STAIR	LEVEL	STAIR	LEVEL	REQUIRED	SHOWN ON PLANS	ALLOWABLE TRAVEL DISTANCE (TABLE 1016.1) *	ACTUAL TRAVEL DISTANCE SHOWN ON PLANS	REQ'D MIN. DISTANCE BETWEEN EXIT DOORS (1015.2.1.2) *	ACTUAL DISTANCE SHOWN ON PLANS *
AREA 1	REPAIR GARAGE S-1	2311	100	24	28	3'	2'	N/A	5.6'	N/A	108'	2	3	250'	52'	21'-4"	75'-0"
AREA 2	REPAIR GARAGE S-1	6746	100	68	109	3'	2'	N/A	21.8'	N/A	108'	2	3	250'	141'-0"	41'-5"	121'-0"
AREA 3	STORAGE S-1	248	100	5	5	3'	2'	N/A	1.0'	N/A	144'	2	2	250'	48'	NA	NA
AREA 4	OFFICE B	1740	100	18	18	3'	2'	N/A	3.6'	N/A	156'	4	4	300'	65'	NA	NA
AREA 5	MEZZANINE S-1	1740	100	18	18	3'	2'	5.31'	3.6'	48'	NA	1	1	250'	113'	NA	NA

\*BUILDING IS FULLY SPRINKLERED PER NCBC 909.3.1.1.

**LEGEND- LIFE SAFETY**  
 ▲ TRAVEL DIRECTION TO EXIT  
 ▲ EXIT DISCHARGE  
 - - - - - EGRESS PATH  
 - - - - - COMMON PATH OF TRAVEL (100'-MAX)  
 ○ END OF COMMON PATH OF TRAVEL  
 ⊗ EXIT SIGN  
 ☒ F.E.C. FIRE EXTINGUISHER CABINET  
 ● REMOTE POINT  
 ⊕ PANIC HARDWARE  
 ○ FE WALL MOUNTED FIRE EXTINGUISHER

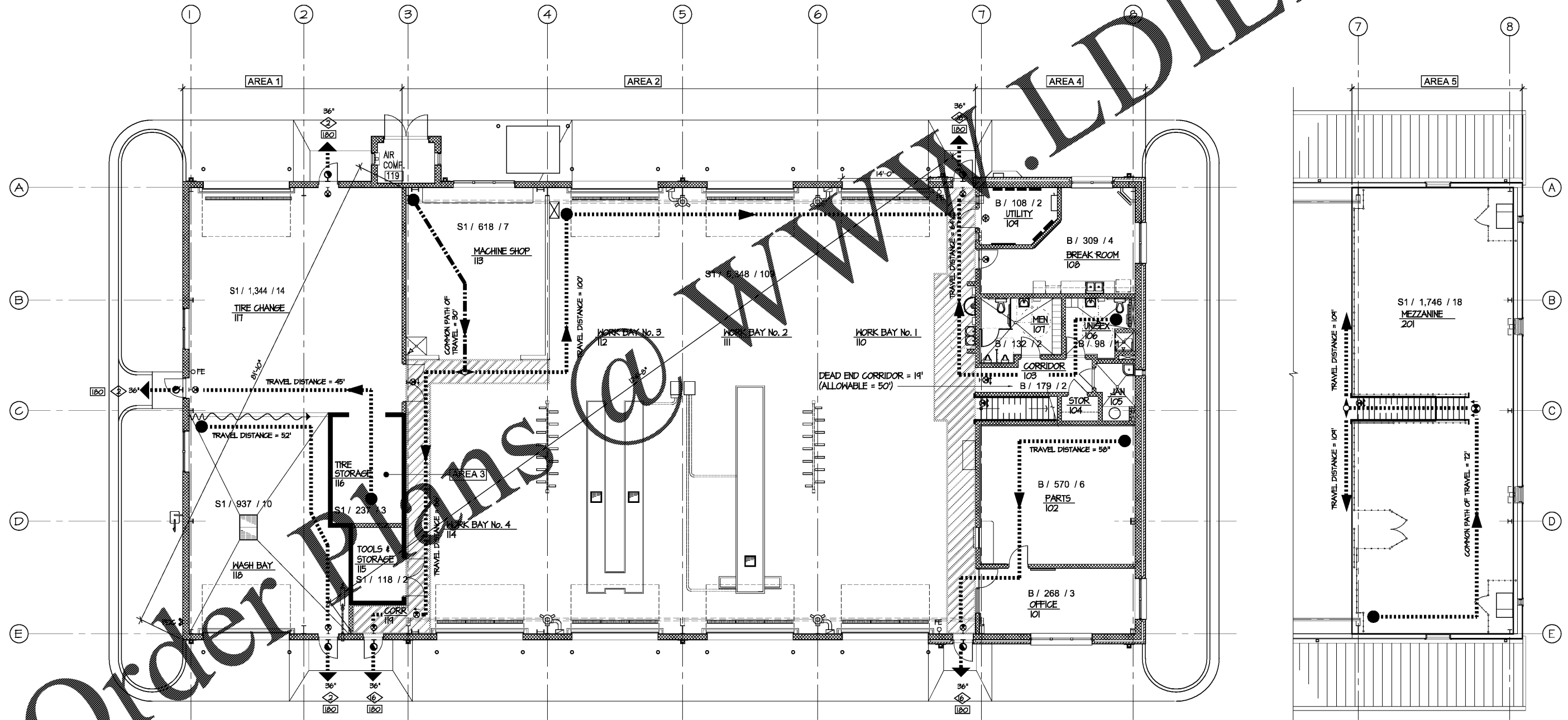

2 G3 GROUND FLOOR LIFE SAFETY PLAN  
 SCALE: 1/8" = 1'-0"

1 G3 MEZZANINE LIFE SAFETY PLAN  
 SCALE: 1/8" = 1'-0"

Order Plans @ WWW.LDILine.com

**BIDDING DOCUMENTS**

DESIGNED BY:  
**FACILITIES DESIGN ARCHITECTS & ENGINEERS**  
 FACILITIES MANAGEMENT DIVISION, INCORPORATED  
 1000 WILMINGTON STREET  
 WILMINGTON, NORTH CAROLINA 28403  
 PHONE: 910/717-4640 FAX: 910/717-0899

CONSULTANT:  
**LIFE SAFETY PLANS**

PROJECT TITLE / DESCRIPTION:  
**LUMBERTON EQUIPMENT SHOP**  
 LUMBERTON HIGHWAY DIVISION 6

8722 NO. 7TH HIGHWAY  
 LUMBERTON, NORTH CAROLINA 28860

STATE CONSTRUCTION ID.# 16-12916-01A  
 ASSET NUMBER:  
 CO. # SITE # BLDG.#  
 78 - 06 - 00

REVISIONS NO. DATE

DATE ISSUED: 12/16/2017  
 DRAWN BY:  
 CHECKED BY:  
 SHEET NO.

G3