

REVISED KEYNOTES

1. PROVIDE NEW PRE-CAST LINTEL AT NEW CMU OPENING. BEARING 8" MINIMUM EACH SIDE ON SOLID GROUTED CMU JAMBS.
2. REPAIR EXISTING CMU WALL WHERE EXISTING PERPENDICULAR WALL IS REMOVED. PRIME AND PAINT WALL CORNER TO CORNER.
3. REPAIR EXISTING CMU WALL WHERE EXISTING PLUMBING SUPPLY IS CAPPED IN WALL.
4. REPAIR EXISTING CONCRETE FLOOR WHERE EXISTING PLUMBING WASTE IS CAPPED BELOW SLAB.
5. PROVIDE NEW 1/4" TEMPERED GLASS PANEL IN EXISTING SOLID CORE WOOD DOOR. SIZE 24"Wx34"H.
6. REINSTALL SALVAGED ROOM IDENTIFICATION NUMBER ON ROOM NUMBER IDENTIFIED WITH KEYNOTE. REFER TO SPECIFICATION SECTION 101423 FOR MOUNTING REQUIREMENTS.
7. PROVIDE NEW ROOM IDENTIFICATION NUMBER AS SPECIFIED.
8. PROVIDE NEW WOOD TRIM WHERE EXISTING BOOK CASE SECTION WAS SELECTIVELY DEMOLISHED FROM SECTION TO REMAIN. PRIME AND PAINT.
9. PRIME AND PAINT EXISTING BOOK CASE AND SHELVING TO REMAIN.
10. TOUCH UP PAINT WHERE EXISTING SURFACE WIRE MOULD AND DATA DEVICES ARE REMOVED BY OWNER. PRIME AND PAINT NEW CONSTRUCTION TO BLEND WITH EXISTING.
11. PROVIDE NEW SIGN ON DOOR TO READ, "THIS DOOR TO REMAIN UNLOCKED WHEN BUILDING IS OCCUPIED". TEXT SHALL BE 1" LETTERS.
12. PROVIDE NORTHEASTERN TECHNICAL COLLEGE LOGO IN ALTERNATE FLOOR. APPROXIMATE LOGO DIMENSION 8 FEET WIDE.

LEGEND

- PROVIDE NEW DOOR, DOOR FRAME AND HARDWARE
- DOOR NUMBER - SEE SCHEDULE
- EXISTING DOOR AND FRAME TO REMAIN.
- DOOR NUMBER - SEE SPECIFICATIONS FOR NEW HARDWARE. REMOVE AND PROVIDE NEW HARDWARE SPECIFIED.

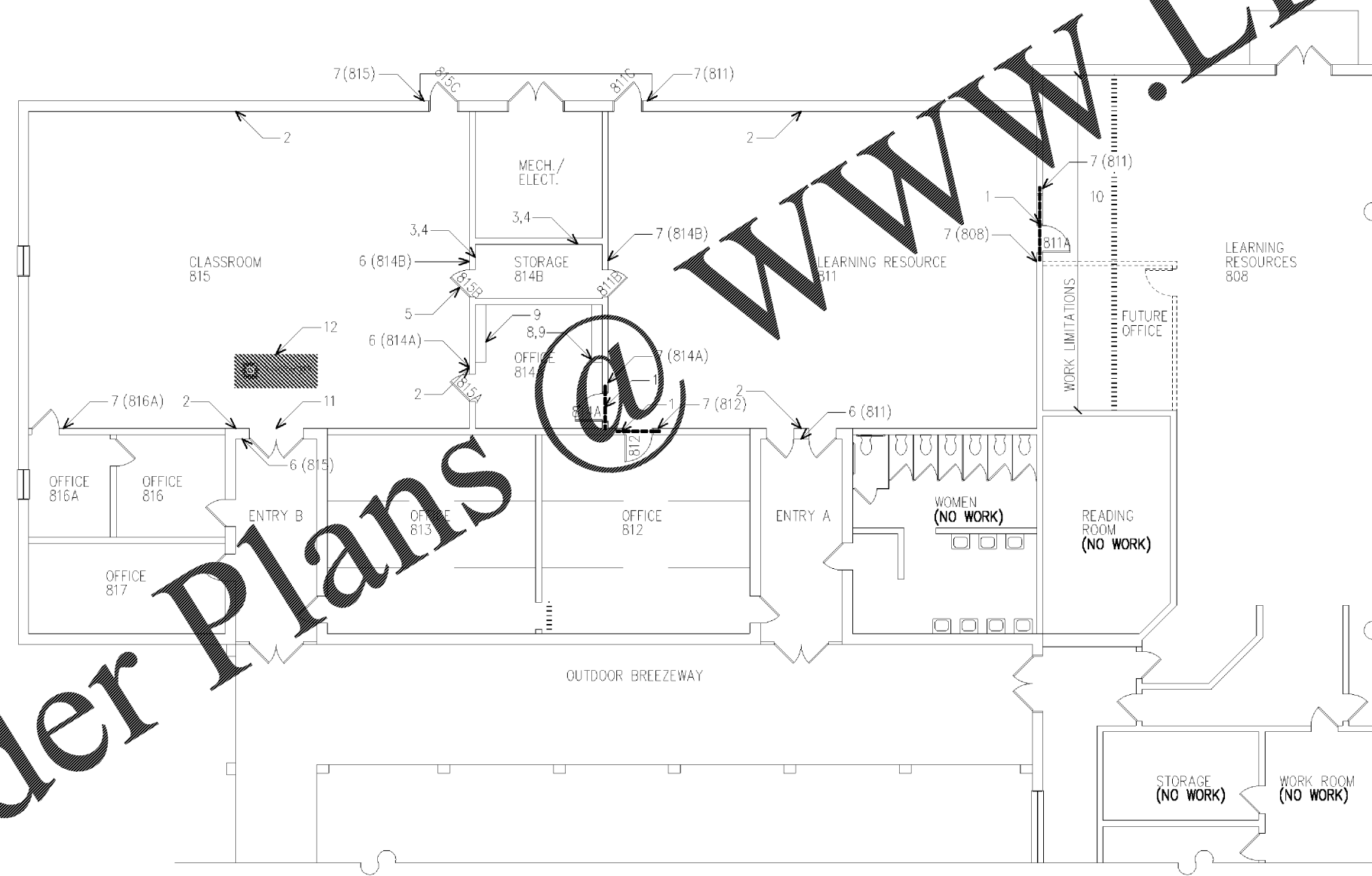

1 REVISED FLOOR PLAN - BUILDING #800
SCALE 1/16" = 1'-0"

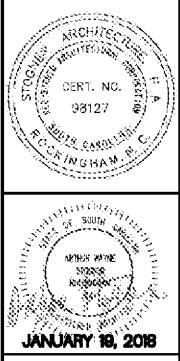
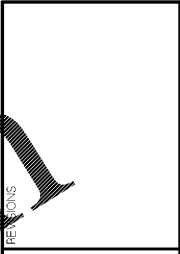
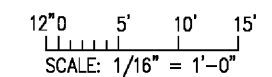

Stogner Architecture, PA
ARCHITECTURE - CONSTRUCTION MANAGEMENT - DESIGN BUILD
615 East Broad Avenue, Rockingham, North Carolina, 28379
Phone 910-895-6874 Fax 910-895-1111

**NORTHEASTERN TECHNICAL COLLEGE
BUILDING #800 RENOVATION**
CHERAW SOUTH CAROLINA

REVISED FLOOR PLAN: BUILDING #800
4420B\ A1.1.aec
COMM. NO.: 4420B
DRAWN BY: FJF
CHECKED BY: AWS
DATE: JAN. 19, 2018
SHEET NO. A1.1