

Order Plans

WWW.LDLINE.COM

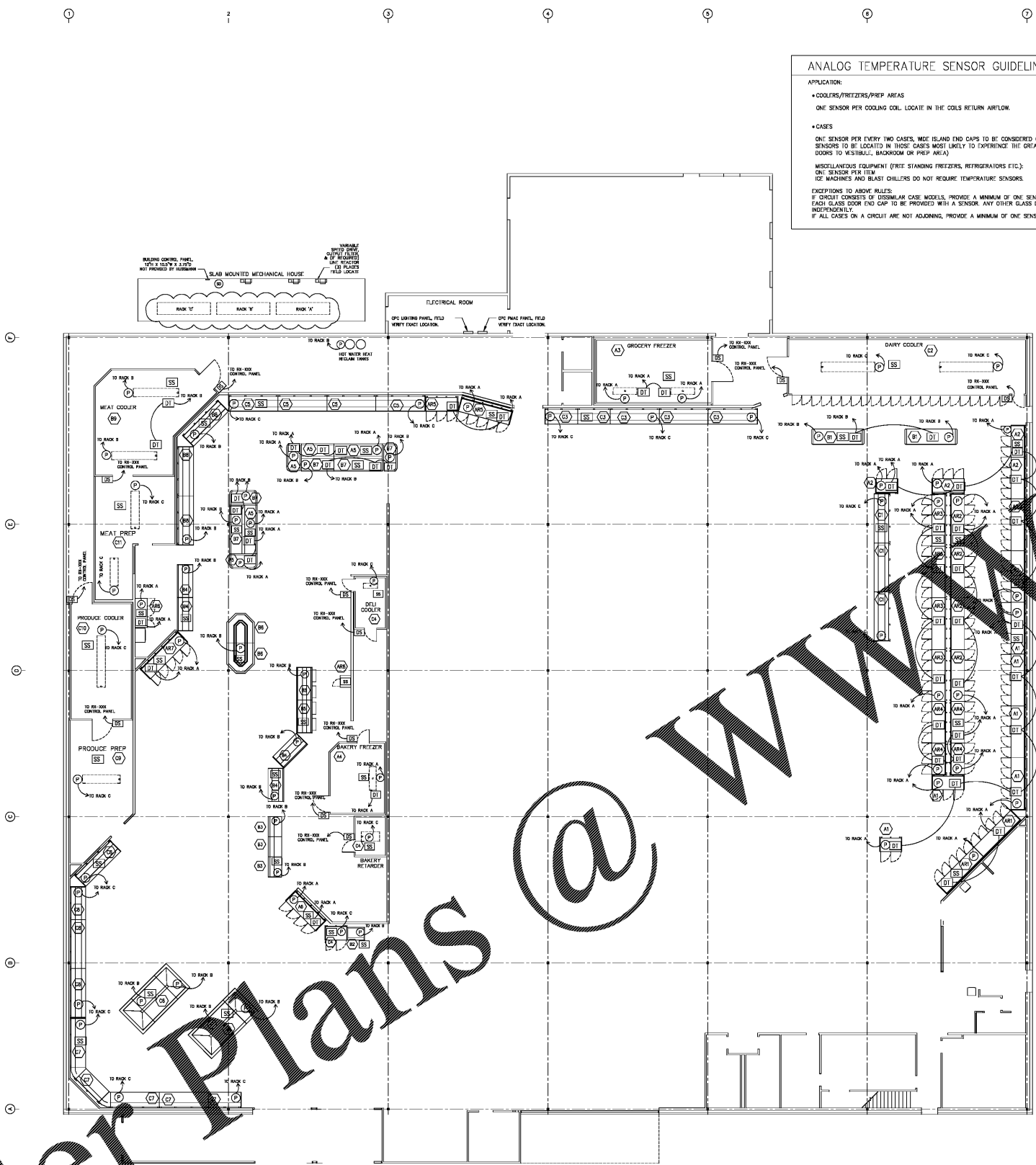

**ANALOG TEMPERATURE SENSOR GUIDELINES**

**APPLICATION:**

- COOLERS/REFRIGERATORS/PREP AREAS
- ONE SENSOR PER COOLING COIL. LOCATE IN THE COILS RETURN AIRFLOW.

**CASES**

ONE SENSOR PER EVERY TWO CASES. MID ISLAND END CAPS TO BE CONSIDERED CASES. SENSORS TO BE LOCATED IN THOSE CASES MOST LIKELY TO EXPERIENCE THE GREATEST LOAD. (CASES AT END OF LINE UPS OR NEAR DOORS TO VESTIBULE, BACKROOM OR PREP AREA)

**MISCELLANEOUS EQUIPMENT (FRITZ STANDING FREEZERS, REFRIGERATORS ETC.):**

ONE SENSOR PER ITEM. ICE MACHINES AND BLAST CHILLERS DO NOT REQUIRE TEMPERATURE SENSORS.

**EXCEPTIONS TO ABOVE RULES:**

IF CIRCUIT CONSISTS OF DISSIMILAR CASE MODELS, PROVIDE A MINIMUM OF ONE SENSOR PER MODEL TYPE. EACH GLASS DOOR END CAP TO BE PROVIDED WITH A SENSOR. ANY OTHER GLASS DOOR CASES ON CIRCUITS TO BE CONSIDERED INDEPENDENTLY. IF ALL CASES ON A CIRCUIT ARE NOT ADJOINING, PROVIDE A MINIMUM OF ONE SENSOR PER CONTINUOUS SECTION.

**FIXTURE SOLENOID POWER WIRE SIZE SCHEDULE**

VOLTAGE	DISTANCE <= 200'	200' < DISTANCE <= 400'	400' < DISTANCE
24 VOLT / SINGLE PHASE	2 #18AWG	2 #16AWG	2 #14AWG

NOTES:  
 1. WIRE SIZE CHANGES FOR SOLENOID IMPORTANCE OF GLASS DOOR.  
 2. CONTROL WIRING TO BE RUN OVERHEAD WHEREVER POSSIBLE.

**SYMBOL DESCRIPTION**

(○)	REFRIGERATION CIRCUIT IDENTIFICATION
(□)	DISCONNECT TERMINATION OR MISC. LOAD
(○)	ANALOG TEMPERATURE SENSOR
(□)	DOOR SWITCH
(○)	PHASE MONITOR
(○)	SMOKE DETECTOR
(○)	SECTION STOP ISLAND

1. WITH CASES ARE TIED FROM LOOP PANEL SECTION STOP SOLENOIDS WILL BE IN REFRIGERATION CIRCUIT ON EACH FLOOR.  
 2. REFER TO TYPING DRAWINGS (P&ID, RA, RS) FOR EXACT LOCATIONS.

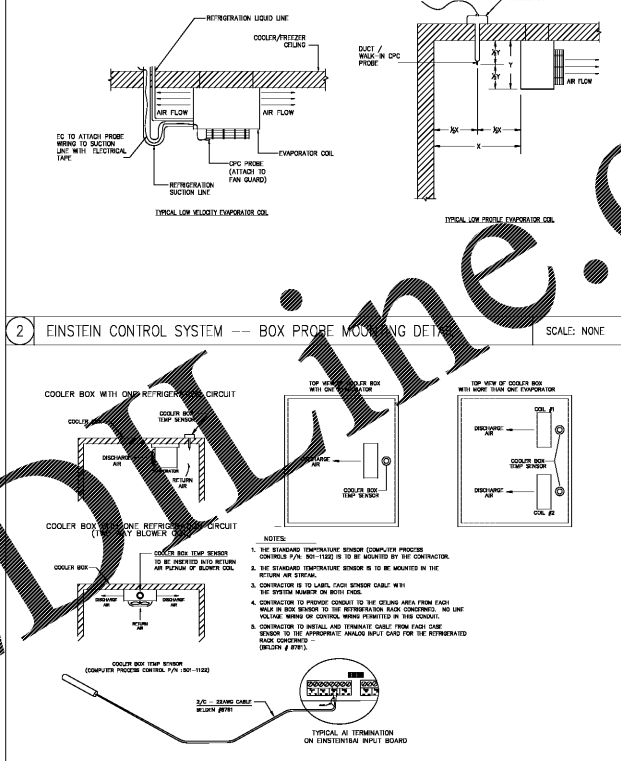

FOR REFERENCE ONLY



KROGER L-407  
 CONTROLS  
 INSTALLATION TEMPLATE

**CURRENT PLAN DATE:** 01/25/2018

**GENERAL PLAN DATE:** 1/18

DATE	BY	REVISION
1	7	
2	8	
3		
4		
5		
6		

**STANDARD PLOTTED SCALE:**

**BUILDING STAYS:**

TOTAL SHIFTLING	
SALES AREA	
BASE STORE	
MEZZANINE	
DOCK / UTILITY	

**ENERGY MANAGEMENT TERMINATION PLAN**

**SHEET:** EM-2

**DATE:**

**ATTENTION DESIGN ENGINEERS:**

THIS DRAWING REPRESENTS A TYPICAL STORE AND SERVES AS A TEMPLATE FOR DEVELOPING JOB SPECIFIC DRAWINGS. YOUR DRAWINGS SHALL REFLECT THE DESIGN REQUIREMENTS FOR YOUR SPECIFIC STORE, AND SHALL USE THE LAYOUT ESTABLISHED BY THIS TEMPLATE. USE OF THE TEMPLATE IS NECESSARY TO SUPPORT THE DESIGN AND PROGRAMMING SYSTEM WITHIN THE KROGER COMPANY.