

Key Value	Keynote Text
R1	PROVIDE (1) SET OF BELDN #8781 #22 SHELDED CABLE FOR EACH TEMPERATURE SENSOR AND DEFROST TERMINATION SENSOR SHOWN. PROVIDE 3/4" CONDUIT UNLESS NOTED OTHERWISE TO REFRIGERATION UNIT NOTED ON DRAWING. PROVIDE LENGTH OF CABLE AS REQUIRED. SEE REFRIGERATION PLANS FOR MORE INFORMATION.
R2	LEAK DETECTION SENSOR TO BE MOUNTED ON COLUMN NEAR DELI AREA REFRIGERATED CASES PER SPECIFICATION SECTION 11 41 46. COORDINATE EXACT LOCATION WITH KROGER PROJECT MANAGER. MAKE ALL FINAL CONNECTIONS.
R3	HORN AND STROBE TO BE LOCATED IN THE MANAGER'S OFFICE OR CUSTOMER SERVICE PER SPECIFICATION SECTION 11 41 46. COORDINATE WITH KROGER PROJECT MANAGER.
R4	JUNCTION BOX WITH CONCEALED CONDUIT WITH PULL WIRE, 3/4" CONDUIT UNLESS NOTED OTHERWISE. TO PROTOCOL REFRIGERATION UNIT FOR SUCTION STOP SOLENOID VALVE CONTROL WIRING. SEE GENERAL NOTE 18 FOR PROTOCOL UNIT DESIGNATION. MOUNT OUTLET 18" ABOVE FLOOR FOR WALL LOCATIONS. FOR ISLAND LOCATIONS UNLESS NOTED OTHERWISE. PROVIDE SURFACE OUTLET AT FLOOR WITH CONDUIT ROUTED IN CONCRETE SLAB. COORDINATE LOCATION OF SUCTION STOP SOLENOID VALVE WITH REFRIGERATION CONTRACTOR.
R5	REFER TO R18D-SH AND R18D-SHA IN THE FINAL REFRIGERATION PLANS (R-SHEETS) FOR PVC TUBING SIZE FEEDING REFRIGERATED CASES OVERHEAD.

Symbol	Description
[Horn and Strobe]	REFRIGERANT LEAK DETECTION HORN AND STROBE. PROVIDE AND INSTALL ALL CONDUIT, WIRING, ETC. AS REQUIRED FOR A COMPLETE INSTALLATION. SEE SPECIFICATION SECTION 11 41 46 AND SHEET EM-7 FOR MORE INFORMATION.
[Sensor]	REFRIGERANT LEAK DETECTION STHROBE ONLY. PROVIDE AND INSTALL ALL CONDUIT, WIRING, ETC. AS REQUIRED FOR A COMPLETE INSTALLATION. SEE SPECIFICATION SECTION 11 41 46 AND SHEET EM-7 FOR MORE INFORMATION.
[ID]	LEAK DETECTION SENSOR. PROVIDE AND INSTALL SENSOR, CONDUIT, WIRING, TUBING, ETC. AS REQUIRED FOR A COMPLETE INSTALLATION. SEE SPECIFICATION SECTION 11 41 46 AND MECHANICAL PLANS FOR MORE INFORMATION.

NOTE 1: PROVIDE 120V CIRCUIT, FROM NEAREST 120V PANEL WITH CAPACITY, FOR LEAK DETECTION SYSTEM POWER RELAYS AS REQUIRED. SEE SPECIFICATION SECTION 11 41 46 FOR MORE INFORMATION. COORDINATE LOCATION OF RELAYS WITH KROGER PROJECT MANAGER.

NOTE 2: INSTALL LEAK DETECTION SENSOR IN MECHANICAL HOUSE ON ROOF. INSTALL (1) HORN/STROBE INSIDE AND (1) HORN/STROBE OUTSIDE MECHANICAL HOUSE. COORDINATE LOCATIONS WITH KROGER PROJECT MANAGER.

NOTE 3: ADDITIONAL LEAK DETECTION SENSORS REQUIRED IN RTU RETURN DUCTS. SEE HVAC PLANS AND SPECIFICATION SECTION 11 41 46 FOR MORE INFORMATION.

Zone Number	Zone Description
ZONE 1:	DAIRY COOLER
ZONE 2:	GROCERY FREEZER
ZONE 3:	MEAT PREP AND MEAT COOLER
ZONE 4:	BAKERY FREEZER AND BAKERY RETARDER
ZONE 5:	PRODUCE COOLER
ZONE 6:	PRODUCE PREP
ZONE 7:	RTE DELI COOLER AND DELI FREEZER
ZONE 8:	RAW COOLER
ZONE 9:	FLORAL COOLER
ZONE 10:	CLICK LIST COOLER AND CLICK LIST FREEZER
ZONE 11:	COMPRESSOR MEZZANINE
ZONE 12:	RETURN AIR DUCT (RTU-1). SEE HVAC PLANS.
ZONE 13:	BAKERY BACK ROOM PROTOCOL LOCATION
ZONE 14:	BACKSTOCK AREA PROTOCOL LOCATION
ZONE 15:	SALES FLOOR (DELI CASES)
ZONE 16:	SALES FLOOR (FROZEN FOOD CASES)

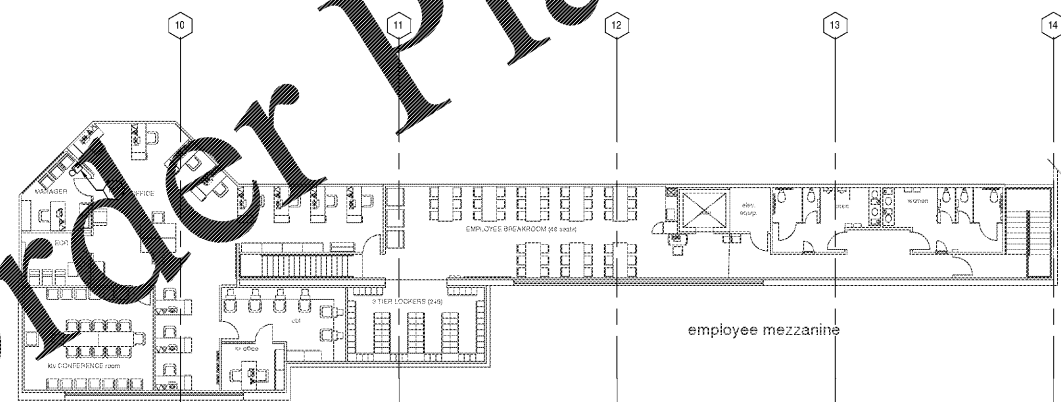

ELECTRICAL REFRIGERATION PLAN - FRONT MEZZANINE
 3/32" = 1'-0"

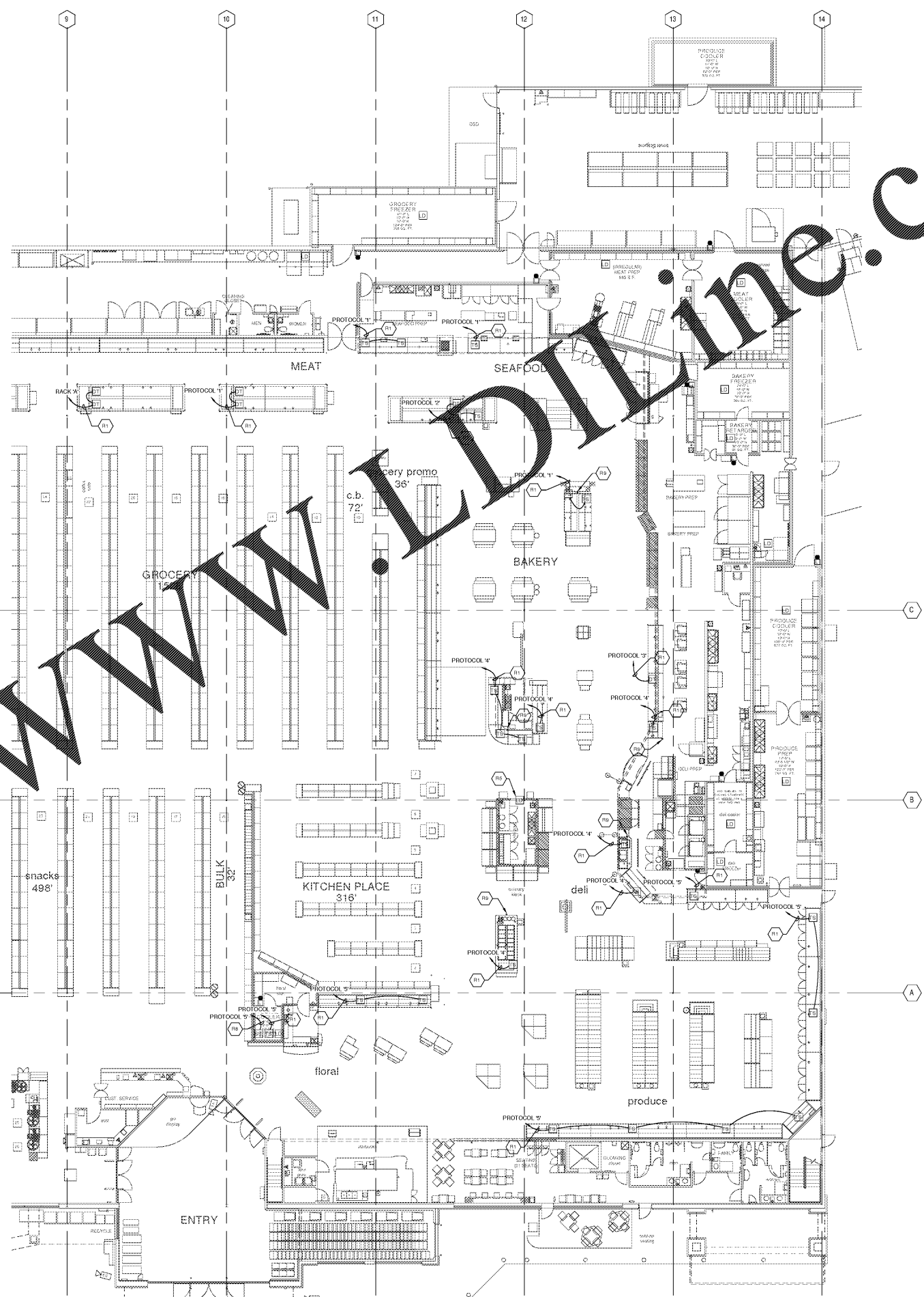

ELECTRICAL REFRIGERATION PLAN - RIGHT
 3/32" = 1'-0"

ROBERSON LOJA ROOF
 RICHMOND, KY
 ENGINEERS

THIS REPRODUCTION IS NOT A CERTIFIED DOCUMENT



Kroger L-407 - Remodel
 3101 RICHMOND ROAD
 LEXINGTON, KY
 FOR: **The Kroger Company**
 1600 Omshy Station Court, Louisville, KY 40223

REVISIONS

NO.	DATE	DESCRIPTION

ELECTRICAL REFRIGERATION PLAN - RIGHT

01-25-18
 17-125