

Order Plans

@

WWW.LDWLine.COM

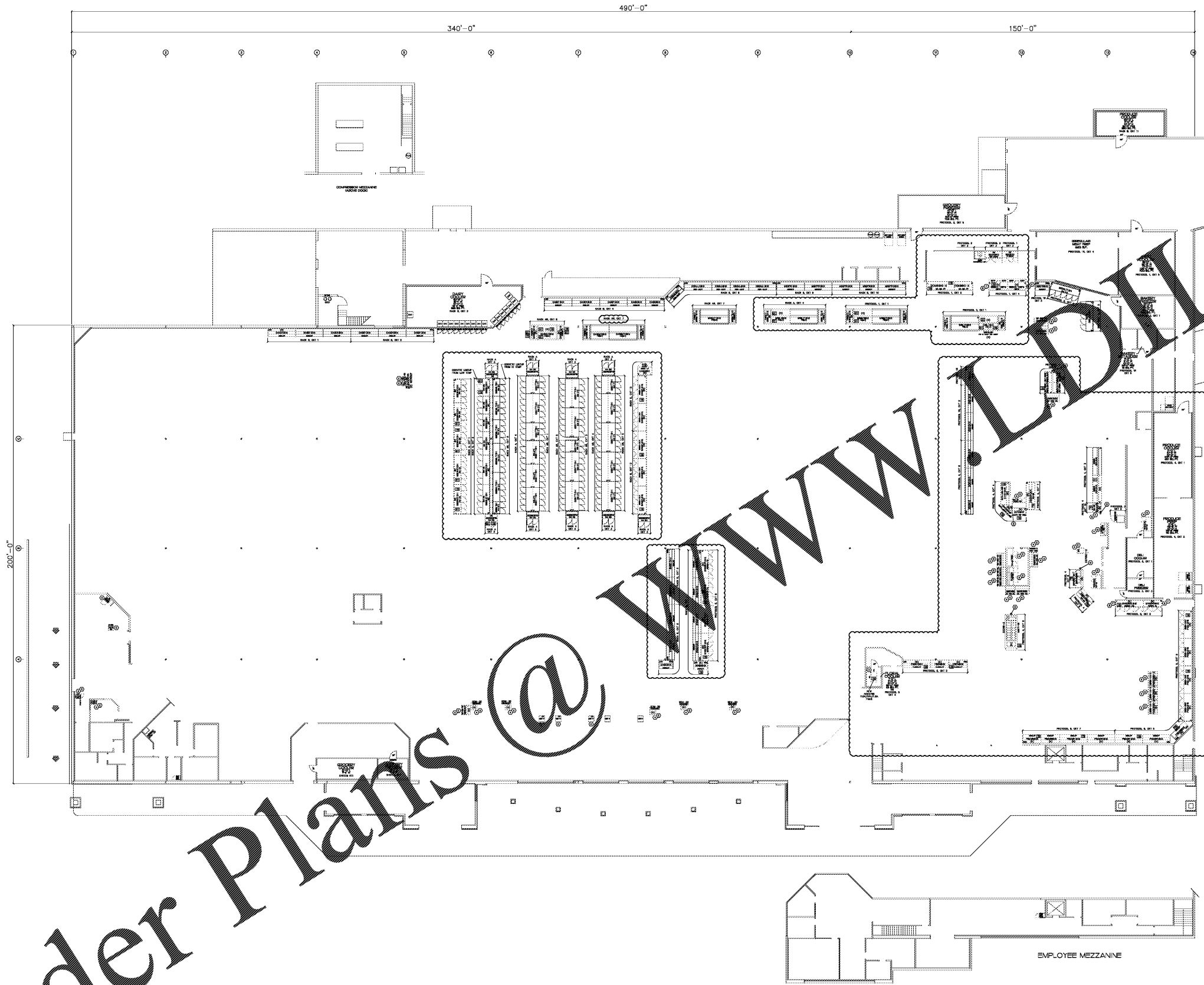

**VENDOR BID DATA:**

- 1. USE GRADES FOR EXISTING EXTERIOR FINISHES.
- 2. ALL EXISTING UTILITIES, PIPES AND CABLES SHALL BE REMOVED.
- 3. ALL EXISTING UTILITIES, PIPES AND CABLES SHALL BE REMOVED.
- 4. ALL EXISTING UTILITIES, PIPES AND CABLES SHALL BE REMOVED.
- 5. ALL EXISTING UTILITIES, PIPES AND CABLES SHALL BE REMOVED.
- 6. ALL EXISTING UTILITIES, PIPES AND CABLES SHALL BE REMOVED.
- 7. ALL EXISTING UTILITIES, PIPES AND CABLES SHALL BE REMOVED.
- 8. ALL EXISTING UTILITIES, PIPES AND CABLES SHALL BE REMOVED.
- 9. ALL EXISTING UTILITIES, PIPES AND CABLES SHALL BE REMOVED.
- 10. ALL EXISTING UTILITIES, PIPES AND CABLES SHALL BE REMOVED.

**REFRIGERATION INSTALLER NOTES:**

- 1. REFRIGERATION EQUIPMENT SHALL BE INSTALLED IN ACCORDANCE WITH THE REFRIGERATION INSTALLATION MANUAL AND THE REFRIGERATION EQUIPMENT SPECIFICATIONS.
- 2. REFRIGERATION EQUIPMENT SHALL BE INSTALLED IN ACCORDANCE WITH THE REFRIGERATION INSTALLATION MANUAL AND THE REFRIGERATION EQUIPMENT SPECIFICATIONS.
- 3. REFRIGERATION EQUIPMENT SHALL BE INSTALLED IN ACCORDANCE WITH THE REFRIGERATION INSTALLATION MANUAL AND THE REFRIGERATION EQUIPMENT SPECIFICATIONS.
- 4. REFRIGERATION EQUIPMENT SHALL BE INSTALLED IN ACCORDANCE WITH THE REFRIGERATION INSTALLATION MANUAL AND THE REFRIGERATION EQUIPMENT SPECIFICATIONS.
- 5. REFRIGERATION EQUIPMENT SHALL BE INSTALLED IN ACCORDANCE WITH THE REFRIGERATION INSTALLATION MANUAL AND THE REFRIGERATION EQUIPMENT SPECIFICATIONS.
- 6. REFRIGERATION EQUIPMENT SHALL BE INSTALLED IN ACCORDANCE WITH THE REFRIGERATION INSTALLATION MANUAL AND THE REFRIGERATION EQUIPMENT SPECIFICATIONS.
- 7. REFRIGERATION EQUIPMENT SHALL BE INSTALLED IN ACCORDANCE WITH THE REFRIGERATION INSTALLATION MANUAL AND THE REFRIGERATION EQUIPMENT SPECIFICATIONS.
- 8. REFRIGERATION EQUIPMENT SHALL BE INSTALLED IN ACCORDANCE WITH THE REFRIGERATION INSTALLATION MANUAL AND THE REFRIGERATION EQUIPMENT SPECIFICATIONS.
- 9. REFRIGERATION EQUIPMENT SHALL BE INSTALLED IN ACCORDANCE WITH THE REFRIGERATION INSTALLATION MANUAL AND THE REFRIGERATION EQUIPMENT SPECIFICATIONS.
- 10. REFRIGERATION EQUIPMENT SHALL BE INSTALLED IN ACCORDANCE WITH THE REFRIGERATION INSTALLATION MANUAL AND THE REFRIGERATION EQUIPMENT SPECIFICATIONS.

**CONTROL NOTE:**

1. ALL REFRIGERATION EQUIPMENT SHALL BE INSTALLED IN ACCORDANCE WITH THE REFRIGERATION INSTALLATION MANUAL AND THE REFRIGERATION EQUIPMENT SPECIFICATIONS.

**SHEET INDEX:**

1. REFRIGERATION EQUIPMENT LAYOUT

**LEGEND:**

1. REFRIGERATION EQUIPMENT

**GENERAL NOTES:**

1. THE CONTRACTOR SHALL BE RESPONSIBLE FOR OBTAINING ALL NECESSARY PERMITS AND APPROVALS FROM THE LOCAL AUTHORITIES.

**LOUISVILLE (NEW) BANNER**

1600 CANSBY STATION CT  
LOUISVILLE, KY

P-ONE (502) 423-4962 FAX (502) 423-2379

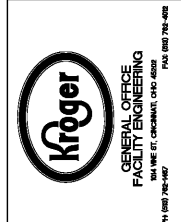

**WITHIN THE WALLS**

**L-407**

3101 RICHMOND RD  
LEXINGTON, KY

DATE: 12/20/2017	DESIGNED BY: M. GILJO	CHECKED BY:
DATE: 12/20/17	DATE: 12/20/17	DATE: 12/20/17
STANDARD PLOT SIZE: 1/16"=1'-0"		
<b>BUILDING STATS</b>		
TOTAL SHELVING	5,677 SF	
SALS AREA	91,579 SF	
4' X 8' GROSS AREA	115,608 SF	
<b>MEZZANINE:</b>		
DOCK / UTILITY	6,803 SF	
<b>GROSS BUILDING</b>		
<b>126,467 SF</b>		
<b>REFRIGERATION EQUIPMENT LAYOUT</b>		
FREE PACKAGE ID: Not Applicable		
<b>L-407</b>		
<b>R1.1</b>		
GEO FILE: LA07R1.DWG		