

① FLOOR PLAN (SCALE: 1/4" = 1'-0")

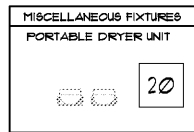
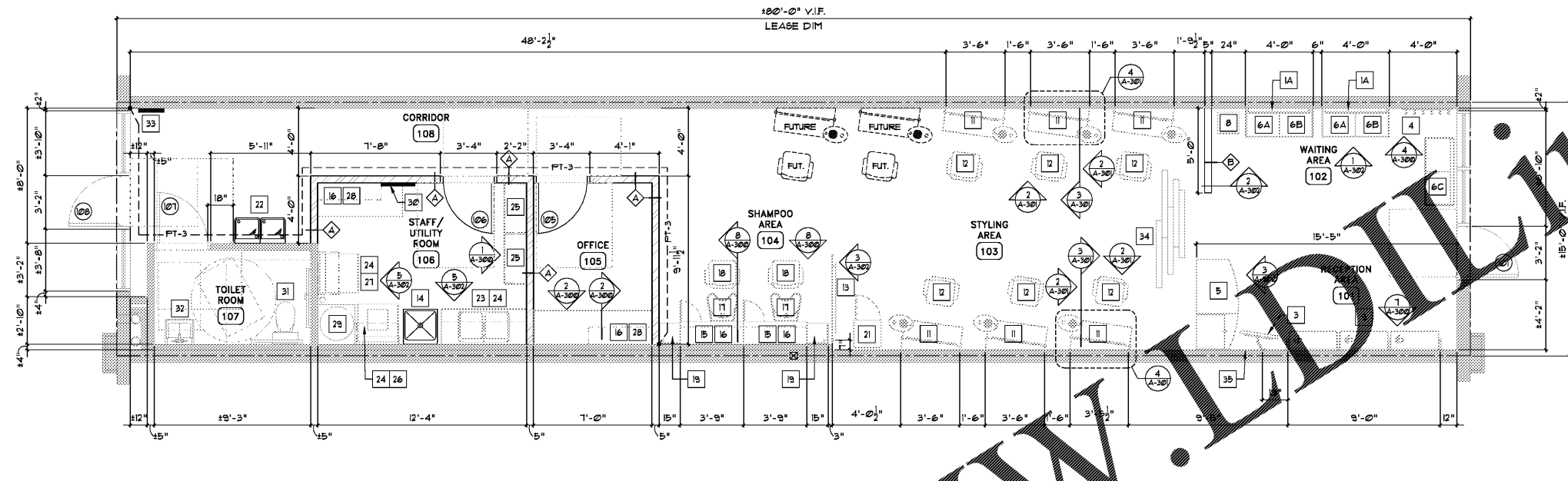

FIXTURE KEY NOTES

1	POSTER HOLDER/FRAME	43"x46" PHOTO WALL FRAME BY REGIS FIXTURE COMPANY. COLOR: "BLACK" (1A) FOR GRAY WALLS (SEE 1/A-302 & 5/A-300)	19	WAXING SHELF	WAXING SHELF TO BE INSTALLED BY CONTRACTOR, PROVIDED BY REGIS FIXTURE COMPANY (SEE DETAIL 8/A-300)
2	NOT USED		20	PORTABLE DRYER	PORTABLE DRYER UNIT FURNISHED BY REGIS VENDOR
3	SUPER SALON MENU BOARD	PURCHASED & INSTALLED BY TENANT, E.C. TO INSTALL ELECTRICAL CONNECTIONS, CONTRACTOR TO INSTALL 32"W x 24"H FIRE RETARDANT BLOCKING, CENTER 78" AFF & 16" FROM END OF RETAIL (SEE 7/A-300)	21	TOWEL WARMER/ SOILED TOWEL CABINET	SOILED TOWEL CABINET W/ FLAP DOOR BY REGIS FIXTURE COMPANY, GREY LAMINATE - ARBORITE TATAMI NAZUMI P-124, CA FINISH
4	COAT HOOKS	3/4" MAPLE BOARD W/ 6 PEGS BY REGIS FIXTURE COMPANY, MOUNTED AT 5'-6" AFF, PROVIDE FIRE RETARDANT BLOCKING AS REQUIRED (SEE 4/A-300)	22	DRINKING FOUNTAINS	HI/LO DRINKING FOUNTAIN PROVIDED AND INSTALLED BY GC.
5	RECEPTION DESK	CODE COMPLIANT RECEPTION DESK BY REGIS FIXTURE COMPANY (SEE 3/A-300)	23	DISPENSARY SINK/CABINET	LAMINATED DISPENSARY CABINET, PROVIDED BY REGIS FIXTURE COMPANY (SEE 5/A-302)
6	BENCH SEATING	LAMINATED "TATAMI NAZUMI" BENCH W/ STAINLESS STEEL LEGS AND BLACK NAUGAHIDE CUSHIONS, BY REGIS FIXTURE COMPANY (SEE 1/A-302) (6A) BENCH, (6B) BACK CUSHION, (6C) BENCH W/ ATTACHED BACK.	24	DISPENSARY UPPER SHELVING	LAMINATED FACED CABINET W/ ADJUSTABLE SHELVES, SUPPLIED BY REGIS FIXTURE COMPANY (SEE 5/A-302)
7	NOT USED		25	DISPENSARY PERMANENT TALL SHELVING UNIT	GREY LAMINATE SHELVING UNIT BY REGIS FIXTURE COMPANY (SEE 5/A-300)
8	MAGAZINE END TABLE	MAGAZINE TABLE BY REGIS FIXTURE COMPANY, GREY LAMINATE - ARBORITE TATAMI NAZUMI P-124, CA FINISH	26	WASHER	PURCHASED LOCALLY BY FRANCHISEE (SEE 5/A-302, P-100 & E-200)
9	WALL MOUNTED RETAIL DISPLAY SECTIONS	RETAIL DISPLAY W/ GREY LAMINATE SHELVES - ARBORITE TATAMI NAZUMI P-124, CA FINISH, BY REGIS FIXTURE COMPANY (SEE 7/A-300)	27	DRYER	PURCHASED LOCALLY BY FRANCHISEE (SEE 5/A-302, P-100 & E-200)
10	NOT USED		28	OFFICE & STAFF COUNTER	LAMINATED COUNTERTOP BY REGIS FIXTURE COMPANY (SEE 2/A-300) (O.C. 7'-0" & S.C. 5'-0")
11	STYLING STATION	BY REGIS FIXTURE COMPANY (SEE 1/A-302, 3/A-301 & 4/A-301)	29	EXISTING WATER HEATER	SEE PLUMBING FIXTURE SCHEDULE (P-100) FOR INFORMATION.
12	STYLING CHAIR	STYLING CHAIR PROVIDED BY REGIS FIXTURE CO., UPHOLSTERY COLOR: "BLACK"	30	IT BACKER BOARD	2'x2'x3/4" PLYWOOD BACKER BOARD FOR NETWORK EQUIPMENT, SUPPLIED BY GENERAL CONTRACTOR
13	SCREEN WALL W/ WIRE GRID	ALUMINUM SCREEN WALL UNIT WITH SUPERCUTS HEADER AND SILVER GRAPHIC DISPLAY UNIT BY REGIS FIXTURE COMPANY (SEE 3/A-302)	31	EXISTING WATER CLOSET	SEE PLUMBING FIXTURE SCHEDULE ON SHEET P-100 FOR INFORMATION
14	UTILITY/MOP SINK	UTILITY/MOP SINK PROVIDED AND INSTALLED BY G.C.	32	EXISTING LAVATORY	SEE PLUMBING FIXTURE SCHEDULE ON SHEET P-100 FOR INFORMATION
15	SHAMPOO BULKHEAD	BY REGIS FIXTURE COMPANY, GREY LAMINATE - ARBORITE TATAMI NAZUMI P-124, CA FINISH (SEE 8/A-300)	33	ELECTRICAL PANEL	ELECTRICAL PANEL. SEE ELECTRICAL FOR MORE INFORMATION
16	45" COUNTER CABINETS	BY REGIS FIXTURE COMPANY, GREY LAMINATE - ARBORITE TATAMI NAZUMI P-124, CA FINISH (SEE 8/A-300, 2/A-300)	34	KONECTO FLOOR	CONTRACTOR TO INSTALL SIDE TO SIDE (SEE SHEET A-500 FOR MORE INFORMATION)
17	SHAMPOO BOWLS	INSTALL ON BULKHEAD BY REGIS FIXTURE COMPANY, RUN SMALL BEAD OF CLEAR SILICONE CAULK ACROSS TOP OF BOWL (SEE 8/A-300)	35	MONITOR BLOCKING	CONTRACTOR TO INSTALL FIRE RETARDANT (32"W x 24" H) BACKING, CENTER 78" A.F.F. AND 16" FROM END OF RETAIL (SEE DETAIL 7/A-300 FOR MORE INFORMATION)
18	SHAMPOO CHAIR	PROVIDED BY REGIS FIXTURE COMPANY, UPHOLSTERY COLOR: "BLACK"			

GENERAL NOTES

CONTRACTOR TO NOTIFY PROJECT MANAGER OF ANY UNFORSEEN ISSUES, REPAIRS OR REPLACEMENTS REQUIRED IN THE FIELD AT THE START OF CONSTRUCTION

EXISTING STORE FRONT AND DOORS TO REMAIN. TENANT G.C. TO VERIFY CONDITIONS AND REPAIR AS NEEDED.

PROVIDE 2"x10" FIRE RETARDANT BLOCKING TO FIT BETWEEN STUDS, IN ALL WALLS WHICH ARE DESIGNATED TO HAVE STYLING STATIONS (SEE DETAIL 3/A-301). CONTRACTOR TO INSTALL W/MIN. SCREW SPACING OF 6" O.C. AND USE CONSTRUCTION ADHESIVE (SUCH AS PL200) ON ENTIRE SURFACE.

PROVIDE 2"x10" FIRE RETARDANT BLOCKING TO FIT BETWEEN STUDS, IN ALL WALLS WHICH ARE DESIGNATED TO HAVE UPPER SHELVING UNITS ABOVE DISPENSARY SINK, WASHER/DRYER, STAFF/UTILITY COUNTER & OFFICE COUNTER (SEE DETAILS 2/A-300 & 5/A-302), CONTRACTOR TO INSTALL W/MIN. SCREW SPACING OF 6" O.C. AND USE CONSTRUCTION GRADE ADHESIVE (SUCH AS PL200) ON ENTIRE SURFACE.

PROVIDE 2"x10" FIRE RETARDANT BLOCKING TO FIT BETWEEN STUDS, IN ALL WALLS WHICH ARE DESIGNATED TO HAVE SHAMPOO UPPER CABINETS. CONTRACTOR TO INSTALL W/MIN. SCREW SPACING OF 6" O.C. AND USE CONSTRUCTION GRADE ADHESIVE (SUCH AS PL200) ON ENTIRE SURFACE. (SEE DETAIL 8/A-300)

CONTRACTOR TO SUPPLY & INSTALL 5# ABC FIRE EXTINGUISHER AT LOCATION AND HEIGHT DESIGNATED BY LOCAL FIRE INSPECTOR AND HAVE TAGGED/CERTIFIED BY LOCAL AUTHORITY.

TENANT'S GENERAL CONTRACTOR TO SUPPLY AND INSTALL 2'x2'x3/4" PLYWOOD BACKER BOARD FOR NETWORK EQUIPMENT. BACKER BOARD TO BE PAINTED TO MATCH WALLS - GLUE AND SCREW INTO STUDS, INSTALL WITH BOTTOM OF BACKER BOARD @ 6'-0" A.F.F. SEE FLOOR PLAN AND ELECTRICAL PLANS FOR LOCATION.

FIELD VERIFY ALL DIMENSIONS WITH EXISTING BUILDING CONDITIONS.

PATCH ALL DISTURBED SURFACES TO MATCH EXISTING & MAINTAIN FIRE SEPARATIONS.

G.C. TO PROVIDE BARRIER FREE SIGNAGE PACKAGE AND INSTALL SIGNS AT LOCATIONS AND POSITIONS INDICATED IN PACKAGE OR AS REQUIRED BY LOCAL CODES.

G.C. AND/OR SUB-CONTRACTOR TO INSTALL ALL "KEY NOTE" ITEMS AS LISTED REGARDLESS OF WHO SUPPLIES THE ITEM.

NO EXPOSED P.V.C. PIPING OR EXPOSED COPPER PIPING ALLOWED IN ALL PUBLIC AREAS.

GC TO INSTALL R-13 BATT INSULATION ON ALL PERIMETER WALLS AS REQUIRED.

WALL KEY

	EXISTING WALL TO REMAIN
	NEW INTERIOR PARTITION
	NEW PARTIAL HEIGHT WALL
	PAINT COLOR "PT-3" (ACCENT WALL)

WALL TYPES- ALL BY TENANT'S GC

	3-5/8" METAL STUDS @ 16" O.C. W/ 5/8" GYP. BD EA. SIDE TO 10'-0" A.F.F. - BRACE TO EXISTING STRUCTURE AS REQUIRED - SEE DETAIL 5/A-301 FOR ADDITIONAL INFORMATION
	3-5/8" METAL STUDS @ 16" O.C. W/ 5/8" GYP. BD EACH SIDE TO 3'-3" A.F.F. (SEE 2/A-302)

ALEXANDRA MATIS INCARB
10755 SANDHILL ROAD
DALLAS, TEXAS 75238
214.343.1000

12/13/2017
#81973
SUPERCUTS
TENANT BUILD-OUT
LAKESIDE VILLAGE
7790 WINTER GARDEN VINELAND RD, SUITE 300
WINDERMERE, FL 34786

SUPERCUTS
DATE ISSUED
TENANT REVIEW 12.08.17
LANDLORD REVIEW 12.13.17
PERMIT 12.13.17
DRAWN BY BB
CHECKED BY AM
JOB NO. 17-678

A-100