

"LEE COUNTY LANDSCAPE CODE" REQUIREMENTS (PER DIVISION 9 - OPEN SPACE, BUFFERING AND LANDSCAPING) (SOUTH FORT MYERS PLANNING COMMUNITY)		
SEC. - 10-415 Open Space	Required	Provided
(a) Open Space Calculations:		
<i>Development Type: Commercial (Large Project)</i>		
30% of developed area shall be designated as Open Space.		
Open Space Calculation Total Development Area = 86,017 SF 86,017 SF x 0.30 (30%) = 25,805.1 SF Open Space	25,805 SF	50,686 SF
SEC. - 10-416 Landscape Standards		
(a) General Trees:		
(3) All other developments. One tree must be provided per each 3,500 SF of development area.		
General Tree Calculation Total Development Area = 86,017 SF 86,017 SF / 3,500 SF = 24.58 General Trees	25	(w/ 28 credits) 43
(b) Building Perimeter Plantings:		
All new commercial components of planned developments must provide building perimeter plantings equal to ten percent of the proposed building gross ground floor level area.		
Building Perimeter Planting Calculation Proposed Building Footprint = 7,500 SF 7,500 SF x 0.10 (10%) = 750 SF Planting Area Shrubs Calculation = (750 / 2) x 144 / 1,296 = Approx. 41.68 Shrubs 3' O.C. (@ 50% coverage)	750 SF 42	824 SF 47
(c) Landscaping of Parking and Vehicle Use Areas		
(2) Internal Landscaping		
a. At least one canopy tree or a cluster of three sabal palms must be planted or retained for every 250 square feet of required internal planting area, and no parking space may be more than 200 feet from a tree planted in a permeable peninsula or median.		
Internal Tree Calculation (1 Tree / 250 SF of Area) Internal Landscape Area = 2,074 SF 2,074 SF / 250 SF = 8.30 Internal Trees	9	9
b. Landscaped areas in the parking area perimeter or internal islands must equal or exceed a minimum of ten percent of the total paved surface area.		
Internal Landscaping Area Calculation Total Proposed Paved Surface Area = 20,737 SF 20,737 SF x 0.10 (10%) = 2,073.7 SF Planting Area Shrubs Calculation = (2,074 / 2) x 144 / 1,296 = 115.22 Shrubs (@ 50% coverage)	2,074 SF 116	2,088 SF 138
(d) Buffering Adjacent Property:		
(1) General. A buffering area is required along the entire perimeter of the proposed development whenever the proposed development abuts a different use.		
(3) Buffer Requirements.		
Buffer Determination/Requirements South = Commercial Planned Development (CPD) ↔ (ROW) East = (CPD) ↔ Residential Planned Development (RPD) West = (CPD) ↔ (CPD)	Type 'D' Type 'F' Type 'A'	Type 'D' Type 'F' Type 'A'
South Property Line (494 LF) - Hancock Bridge Pkwy 20' Wide Buffer Requirements: 494 LF - 63.32 (Densities) - 5 LF (Sidewalk) - 25 LF (UE) = 400.15 LF / 100 LF (Buffer Calc.) = 4.00 (multiplier) Trees Required = 4.00 x 5 = 20 Trees Shrubs Required = Double-Staggered Hedge Row Calculation: (400.15 LF / 3) x 2 = 266.77 Shrubs	20 266	20 247
East Property Line (353.27 LF) - RPD Vacant Land 30' Wide Buffer Requirements: Trees Required = 353.27 LF / 100 = 4.94 x 10 = 35.33 Trees Shrubs Required = Double-Staggered Hedge Row Calculation: (353.27 LF / 3) x 2 = 235.51 Shrubs	53 236	55 236
West Property Line (337.44 LF) - Access Easement (80') 5' Wide Buffer Requirements: Trees Required = 257.44 LF / 100 = 2.57 x 4 = 10.32 Trees	11	11
TOTALS	TREES: 132 SHRUBS: 868 LANDSCAPE AREA: 2,822	132 868 2,822

EXISTING PALM TREE CREDIT NOTE

14 (FOURTEEN) EXISTING PALM TREES ARE LOCATED WITHIN THE PROJECT BOUNDARIES AND SHALL REMAIN ON-SITE, BUT TRANSPLANTED TO NEW / PROPOSED LOCATIONS BY WAY OF PROPER PALM TREE TRANSPLANT METHODS. THESE "RELOCATED" OR "PLANTED" PALM TREES SHALL RECEIVE A CREDIT OF 2 TREE CREDITS PER EVERY ONE PALM TREE SUCCESSFULLY TRANSPLANTED IN AN APPROVED AND TIMELY MANNER.

EXISTING OAK TREES NOTE

EIGHT (8) EXISTING SOUTHERN LIVE OAK TREES ARE PRESENT WITHIN THE PROJECT CONSTRUCTION LIMITS. AN ATTEMPT TO RETAIN THESE TREES SHALL BE MADE, WHERE AND WHEN POSSIBLE. IN THE EVENT THE OAK TREES ARE RETAINED, THEY SHALL BE REPLACED WITH 24-FOOT OVERALL HEIGHT SOUTHERN LIVE OAK TREES ON A 1:1 BASIS.

Order Plans @ WWW.LDLINE.COM

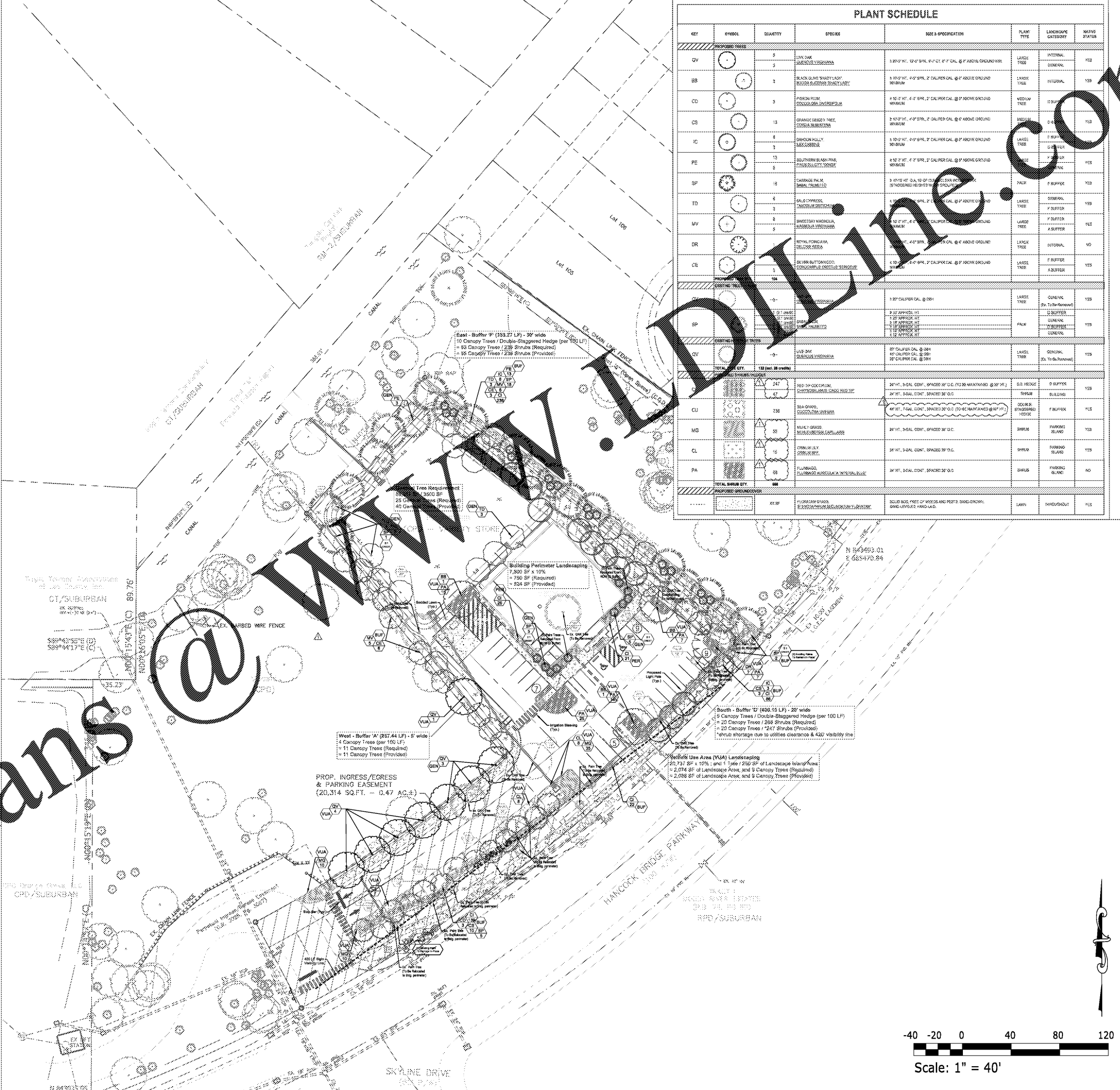

PLANT SCHEDULE						
KEY	SYMBOL	QUANTITY	SPECIES	SIZE & SPECIFICATION	PLANT TYPE	LANDSCAPE CATEGORY
QV	(Symbol)	5	QUERCUS VAGINA	1.800 FT. 12" DBH. 4" CAL. @ 4" ABOVE GROUND	LARGE TREE	INTERNAL
BB	(Symbol)	1	BLACK OLIVE BRADYBUD	1.800 FT. 10" DBH. 2" CAL. @ 4" ABOVE GROUND	LARGE TREE	EXTERNAL
CD	(Symbol)	3	CORDON ROSE	4.100 FT. 4" DBH. 2" CAL. @ 4" ABOVE GROUND	SHRUB	INTERNAL
CB	(Symbol)	13	CRANFORD GARDEN	2.100 FT. 4" DBH. 2" CAL. @ 4" ABOVE GROUND	SHRUB	INTERNAL
IC	(Symbol)	8	IRONWOOD	1.800 FT. 4" DBH. 2" CAL. @ 4" ABOVE GROUND	LARGE TREE	INTERNAL
PE	(Symbol)	13	PINE	4.100 FT. 4" DBH. 2" CAL. @ 4" ABOVE GROUND	SHRUB	INTERNAL
SP	(Symbol)	18	SPIRUEA	3.100 FT. 4" DBH. 2" CAL. @ 4" ABOVE GROUND	SHRUB	INTERNAL
TD	(Symbol)	8	TRE	4.100 FT. 4" DBH. 2" CAL. @ 4" ABOVE GROUND	LARGE TREE	INTERNAL
MP	(Symbol)	3	MIR	1.800 FT. 4" DBH. 2" CAL. @ 4" ABOVE GROUND	LARGE TREE	INTERNAL
DR	(Symbol)	3	DRE	1.800 FT. 4" DBH. 2" CAL. @ 4" ABOVE GROUND	LARGE TREE	INTERNAL
CE	(Symbol)	3	CE	1.800 FT. 4" DBH. 2" CAL. @ 4" ABOVE GROUND	LARGE TREE	INTERNAL
SP	(Symbol)	18	SP	3.100 FT. 4" DBH. 2" CAL. @ 4" ABOVE GROUND	SHRUB	INTERNAL
QV	(Symbol)	5	QV	1.800 FT. 12" DBH. 4" CAL. @ 4" ABOVE GROUND	LARGE TREE	INTERNAL
BB	(Symbol)	1	BB	1.800 FT. 10" DBH. 2" CAL. @ 4" ABOVE GROUND	LARGE TREE	INTERNAL
CD	(Symbol)	3	CD	4.100 FT. 4" DBH. 2" CAL. @ 4" ABOVE GROUND	SHRUB	INTERNAL
CB	(Symbol)	13	CB	2.100 FT. 4" DBH. 2" CAL. @ 4" ABOVE GROUND	SHRUB	INTERNAL
IC	(Symbol)	8	IC	1.800 FT. 4" DBH. 2" CAL. @ 4" ABOVE GROUND	LARGE TREE	INTERNAL
PE	(Symbol)	13	PE	4.100 FT. 4" DBH. 2" CAL. @ 4" ABOVE GROUND	SHRUB	INTERNAL
SP	(Symbol)	18	SP	3.100 FT. 4" DBH. 2" CAL. @ 4" ABOVE GROUND	SHRUB	INTERNAL
TD	(Symbol)	8	TD	4.100 FT. 4" DBH. 2" CAL. @ 4" ABOVE GROUND	LARGE TREE	INTERNAL
MP	(Symbol)	3	MP	1.800 FT. 4" DBH. 2" CAL. @ 4" ABOVE GROUND	LARGE TREE	INTERNAL
DR	(Symbol)	3	DR	1.800 FT. 4" DBH. 2" CAL. @ 4" ABOVE GROUND	LARGE TREE	INTERNAL
CE	(Symbol)	3	CE	1.800 FT. 4" DBH. 2" CAL. @ 4" ABOVE GROUND	LARGE TREE	INTERNAL
SP	(Symbol)	18	SP	3.100 FT. 4" DBH. 2" CAL. @ 4" ABOVE GROUND	SHRUB	INTERNAL
QV	(Symbol)	5	QV	1.800 FT. 12" DBH. 4" CAL. @ 4" ABOVE GROUND	LARGE TREE	INTERNAL
BB	(Symbol)	1	BB	1.800 FT. 10" DBH. 2" CAL. @ 4" ABOVE GROUND	LARGE TREE	INTERNAL
CD	(Symbol)	3	CD	4.100 FT. 4" DBH. 2" CAL. @ 4" ABOVE GROUND	SHRUB	INTERNAL
CB	(Symbol)	13	CB	2.100 FT. 4" DBH. 2" CAL. @ 4" ABOVE GROUND	SHRUB	INTERNAL
IC	(Symbol)	8	IC	1.800 FT. 4" DBH. 2" CAL. @ 4" ABOVE GROUND	LARGE TREE	INTERNAL
PE	(Symbol)	13	PE	4.100 FT. 4" DBH. 2" CAL. @ 4" ABOVE GROUND	SHRUB	INTERNAL
SP	(Symbol)	18	SP	3.100 FT. 4" DBH. 2" CAL. @ 4" ABOVE GROUND	SHRUB	INTERNAL
TD	(Symbol)	8	TD	4.100 FT. 4" DBH. 2" CAL. @ 4" ABOVE GROUND	LARGE TREE	INTERNAL
MP	(Symbol)	3	MP	1.800 FT. 4" DBH. 2" CAL. @ 4" ABOVE GROUND	LARGE TREE	INTERNAL
DR	(Symbol)	3	DR	1.800 FT. 4" DBH. 2" CAL. @ 4" ABOVE GROUND	LARGE TREE	INTERNAL
CE	(Symbol)	3	CE	1.800 FT. 4" DBH. 2" CAL. @ 4" ABOVE GROUND	LARGE TREE	INTERNAL
SP	(Symbol)	18	SP	3.100 FT. 4" DBH. 2" CAL. @ 4" ABOVE GROUND	SHRUB	INTERNAL
QV	(Symbol)	5	QV	1.800 FT. 12" DBH. 4" CAL. @ 4" ABOVE GROUND	LARGE TREE	INTERNAL
BB	(Symbol)	1	BB	1.800 FT. 10" DBH. 2" CAL. @ 4" ABOVE GROUND	LARGE TREE	INTERNAL
CD	(Symbol)	3	CD	4.100 FT. 4" DBH. 2" CAL. @ 4" ABOVE GROUND	SHRUB	INTERNAL
CB	(Symbol)	13	CB	2.100 FT. 4" DBH. 2" CAL. @ 4" ABOVE GROUND	SHRUB	INTERNAL
IC	(Symbol)	8	IC	1.800 FT. 4" DBH. 2" CAL. @ 4" ABOVE GROUND	LARGE TREE	INTERNAL
PE	(Symbol)	13	PE	4.100 FT. 4" DBH. 2" CAL. @ 4" ABOVE GROUND	SHRUB	INTERNAL
SP	(Symbol)	18	SP	3.100 FT. 4" DBH. 2" CAL. @ 4" ABOVE GROUND	SHRUB	INTERNAL
TD	(Symbol)	8	TD	4.100 FT. 4" DBH. 2" CAL. @ 4" ABOVE GROUND	LARGE TREE	INTERNAL
MP	(Symbol)	3	MP	1.800 FT. 4" DBH. 2" CAL. @ 4" ABOVE GROUND	LARGE TREE	INTERNAL
DR	(Symbol)	3	DR	1.800 FT. 4" DBH. 2" CAL. @ 4" ABOVE GROUND	LARGE TREE	INTERNAL
CE	(Symbol)	3	CE	1.800 FT. 4" DBH. 2" CAL. @ 4" ABOVE GROUND	LARGE TREE	INTERNAL
SP	(Symbol)	18	SP	3.100 FT. 4" DBH. 2" CAL. @ 4" ABOVE GROUND	SHRUB	INTERNAL
QV	(Symbol)	5	QV	1.800 FT. 12" DBH. 4" CAL. @ 4" ABOVE GROUND	LARGE TREE	INTERNAL
BB	(Symbol)	1	BB	1.800 FT. 10" DBH. 2" CAL. @ 4" ABOVE GROUND	LARGE TREE	INTERNAL
CD	(Symbol)	3	CD	4.100 FT. 4" DBH. 2" CAL. @ 4" ABOVE GROUND	SHRUB	INTERNAL
CB	(Symbol)	13	CB	2.100 FT. 4" DBH. 2" CAL. @ 4" ABOVE GROUND	SHRUB	INTERNAL
IC	(Symbol)	8	IC	1.800 FT. 4" DBH. 2" CAL. @ 4" ABOVE GROUND	LARGE TREE	INTERNAL
PE	(Symbol)	13	PE	4.100 FT. 4" DBH. 2" CAL. @ 4" ABOVE GROUND	SHRUB	INTERNAL
SP	(Symbol)	18	SP	3.100 FT. 4" DBH. 2" CAL. @ 4" ABOVE GROUND	SHRUB	INTERNAL
TD	(Symbol)	8	TD	4.100 FT. 4" DBH. 2" CAL. @ 4" ABOVE GROUND	LARGE TREE	INTERNAL
MP	(Symbol)	3	MP	1.800 FT. 4" DBH. 2" CAL. @ 4" ABOVE GROUND	LARGE TREE	INTERNAL
DR	(Symbol)	3	DR	1.800 FT. 4" DBH. 2" CAL. @ 4" ABOVE GROUND	LARGE TREE	INTERNAL
CE	(Symbol)	3	CE	1.800 FT. 4" DBH. 2" CAL. @ 4" ABOVE GROUND	LARGE TREE	INTERNAL
SP	(Symbol)	18	SP	3.100 FT. 4" DBH. 2" CAL. @ 4" ABOVE GROUND	SHRUB	INTERNAL
QV	(Symbol)	5	QV	1.800 FT. 12" DBH. 4" CAL. @ 4" ABOVE GROUND	LARGE TREE	INTERNAL
BB	(Symbol)	1	BB	1.800 FT. 10" DBH. 2" CAL. @ 4" ABOVE GROUND	LARGE TREE	INTERNAL
CD	(Symbol)	3	CD	4.100 FT. 4" DBH. 2" CAL. @ 4" ABOVE GROUND	SHRUB	INTERNAL
CB	(Symbol)	13	CB	2.100 FT. 4" DBH. 2" CAL. @ 4" ABOVE GROUND	SHRUB	INTERNAL
IC	(Symbol)	8	IC	1.800 FT. 4" DBH. 2" CAL. @ 4" ABOVE GROUND	LARGE TREE	INTERNAL
PE	(Symbol)	13	PE	4.100 FT. 4" DBH. 2" CAL. @ 4" ABOVE GROUND	SHRUB	INTERNAL
SP	(Symbol)	18	SP	3.100 FT. 4" DBH. 2" CAL. @ 4" ABOVE GROUND	SHRUB	INTERNAL
TD	(Symbol)	8	TD	4.100 FT. 4" DBH. 2" CAL. @ 4" ABOVE GROUND	LARGE TREE	INTERNAL
MP	(Symbol)	3	MP	1.800 FT. 4" DBH. 2" CAL. @ 4" ABOVE GROUND	LARGE TREE	INTERNAL
DR	(Symbol)	3	DR	1.800 FT. 4" DBH. 2" CAL. @ 4" ABOVE GROUND	LARGE TREE	INTERNAL
CE	(Symbol)	3	CE	1.800 FT. 4" DBH. 2" CAL. @ 4" ABOVE GROUND	LARGE TREE	INTERNAL
SP	(Symbol)	18	SP	3.100 FT. 4" DBH. 2" CAL. @ 4" ABOVE GROUND	SHRUB	INTERNAL
QV	(Symbol)	5	QV	1.800 FT. 12" DBH. 4" CAL. @ 4" ABOVE GROUND	LARGE TREE	INTERNAL
BB	(Symbol)	1	BB	1.800 FT. 10" DBH. 2" CAL. @ 4" ABOVE GROUND	LARGE TREE	INTERNAL
CD	(Symbol)	3	CD	4.100 FT. 4" DBH. 2" CAL. @ 4" ABOVE GROUND	SHRUB	INTERNAL
CB	(Symbol)	13	CB	2.100 FT. 4" DBH. 2" CAL. @ 4" ABOVE GROUND	SHRUB	INTERNAL
IC	(Symbol)	8	IC	1.800 FT. 4" DBH. 2" CAL. @ 4" ABOVE GROUND	LARGE TREE	INTERNAL
PE	(Symbol)	13	PE	4.100 FT. 4" DBH. 2" CAL. @ 4" ABOVE GROUND	SHRUB	INTERNAL
SP	(Symbol)	18	SP	3.100 FT. 4" DBH. 2" CAL. @ 4" ABOVE GROUND	SHRUB	INTERNAL
TD	(Symbol)	8	TD	4.100 FT. 4" DBH. 2" CAL. @ 4" ABOVE GROUND	LARGE TREE	INTERNAL
MP	(Symbol)	3	MP	1.800 FT. 4" DBH. 2" CAL. @ 4" ABOVE GROUND	LARGE TREE	INTERNAL
DR	(Symbol)	3	DR	1.800 FT. 4" DBH. 2" CAL. @ 4" ABOVE GROUND	LARGE TREE	INTERNAL
CE	(Symbol)	3	CE	1.800 FT. 4" DBH. 2" CAL. @ 4" ABOVE GROUND	LARGE TREE	INTERNAL
SP	(Symbol)	18	SP	3.100 FT. 4" DBH. 2" CAL. @ 4" ABOVE GROUND	SHRUB	INTERNAL
QV	(Symbol)	5	QV	1.800 FT. 12" DBH. 4" CAL. @ 4" ABOVE GROUND	LARGE TREE	INTERNAL
BB	(Symbol)	1	BB	1.800 FT. 10" DBH. 2" CAL. @ 4" ABOVE GROUND	LARGE TREE	INTERNAL
CD	(Symbol)	3	CD	4.100 FT. 4" DBH. 2" CAL. @ 4" ABOVE GROUND	SHRUB	INTERNAL
CB	(Symbol)	13	CB	2.100 FT. 4" DBH. 2" CAL. @ 4" ABOVE GROUND	SHRUB	INTERNAL
IC	(Symbol)	8	IC	1.800 FT. 4" DBH. 2" CAL. @ 4" ABOVE GROUND	LARGE TREE	INTERNAL
PE	(Symbol)	13	PE	4.100 FT. 4" DBH. 2" CAL. @ 4" ABOVE GROUND	SHRUB	INTERNAL
SP	(Symbol)	18	SP	3.100 FT. 4" DBH. 2" CAL. @ 4" ABOVE GROUND	SHRUB	INTERNAL
TD	(Symbol)	8	TD	4.100 FT. 4" DBH. 2" CAL. @ 4" ABOVE GROUND	LARGE TREE	INTERNAL
MP	(Symbol)	3	MP	1.800 FT. 4" DBH. 2" CAL. @ 4" ABOVE GROUND	LARGE TREE	INTERNAL
DR	(Symbol)	3	DR	1.800 FT. 4" DBH. 2" CAL. @ 4" ABOVE GROUND	LARGE TREE	INTERNAL
CE	(Symbol)	3	CE	1.800 FT. 4" DBH. 2" CAL. @ 4" ABOVE GROUND	LARGE TREE	INTERNAL
SP	(Symbol)	18	SP	3.100 FT. 4" DBH. 2" CAL. @ 4" ABOVE GROUND	SHRUB	INTERNAL
QV	(Symbol)	5	QV	1.800 FT. 12" DBH. 4" CAL. @ 4" ABOVE GROUND	LARGE TREE	INTERNAL
BB	(Symbol)	1	BB	1.800 FT. 10" DBH. 2" CAL. @ 4" ABOVE GROUND	LARGE TREE	INTERNAL
CD	(Symbol)	3	CD	4.100 FT. 4" DBH. 2" CAL. @ 4" ABOVE GROUND	SHRUB	INTERNAL
CB	(Symbol)	13	CB	2.100 FT. 4" DBH. 2" CAL. @ 4" ABOVE GROUND	SHRUB	INTERNAL
IC	(Symbol)	8	IC	1.800 FT. 4" DBH. 2" CAL. @ 4" ABOVE GROUND	LARGE TREE	INTERNAL
PE	(Symbol)	13	PE	4.100 FT. 4" DBH. 2" CAL. @ 4" ABOVE GROUND	SHRUB	INTERNAL
SP	(Symbol)	18	SP	3.100 FT. 4" DBH. 2" CAL. @ 4" ABOVE GROUND	SHRUB	INTERNAL
TD	(Symbol)	8	TD	4.100 FT. 4" DBH. 2" CAL. @ 4" ABOVE GROUND	LARGE TREE	INTERNAL
MP	(Symbol)	3	MP	1.800 FT. 4" DBH. 2" CAL. @ 4" ABOVE GROUND	LARGE TREE	INTERNAL
DR	(Symbol)	3	DR	1.800 FT. 4" DBH. 2" CAL. @ 4" ABOVE GROUND	LARGE TREE	INTERNAL
CE	(Symbol)	3	CE	1.800 FT. 4" DBH. 2" CAL. @ 4" ABOVE GROUND	LARGE TREE	INTERNAL
SP	(Symbol)	18	SP	3.100 FT. 4" DBH. 2" CAL. @ 4" ABOVE GROUND	SHRUB	INTERNAL
QV	(Symbol)	5	QV	1.800 FT. 12" DBH. 4" CAL. @ 4" ABOVE GROUND	LARGE TREE	INTERNAL
BB	(Symbol)	1	BB	1.800 FT. 10" DBH. 2" CAL. @ 4" ABOVE GROUND	LARGE TREE	INTERNAL
CD	(Symbol)	3	CD	4.100 FT. 4" DBH. 2" CAL. @ 4" ABOVE GROUND	SHRUB	INTERNAL
CB	(Symbol)	13	CB	2.100 FT. 4" DBH. 2" CAL. @ 4" ABOVE GROUND	SHRUB	INTERNAL
IC	(Symbol)	8	IC	1.800 FT. 4" DBH. 2" CAL. @ 4" ABOVE GROUND	LARGE TREE	INTERNAL
PE	(Symbol)	13	PE	4.100		