

P:\CAD\2017\17-108\CONSTRUCTION\17-108.dtl-site.dwg, 6 TYPICAL SITE &, 1/26/2018 8:08:39 AM, Avalon Engineering Inc.

**HOOP RACK - Specifications and Space Use**

**Product Name:** Duro Hoop Rack  
As manufactured by Duro Bike Racks  
**Bikes Parked per Unit:** 2  
**Materials:** 1.3" schedule 40 pipe (1.9" O.D.)  
**Finish:** An after fabrication hot dipped galvanized finish is standard. 250 TGC powder coat colors and a stainless steel option are also available.  
**Our powder coat finish assures a high level of adhesion and durability by following these steps:**  
1. Sandblast  
2. Zinc phosphate pretreatment  
3. Epoxy primer electrostatically applied  
4. Final thick TGC polyester powder coat  
**Stainless steel 304 grade stainless steel material finished to either a high polished shine or a satin finish.**  
A rubbery PVC clip is also available.  
**Installation Methods:**  
• In ground mounts is embedded into concrete base. Specify to ground mount for this option.  
• Post Mount has two 2.5" x 2.5" x .25" feet with two anchors per foot. Specify post mount for this option.  
• Rail Mount has two 1/2" x 2" x 1/4" bolts to two parallel rails which can be left freestanding or anchored to the ground. Rails are heavy duty 3" x 1/4" x 3/16" thick galvanized mounting rails. Specify rail mount for this option.  
**SETBACKS:**  
**Wall setbacks:** For racks set parallel to a wall: Minimum: 24" Recommended: 36"  
**For racks set perpendicular to a wall:** Minimum: 28" Recommended: 36"  
**Distance between racks:** Minimum: 24" Recommended: 36"  
**Street setbacks:** Minimum: 24" Recommended: 36"

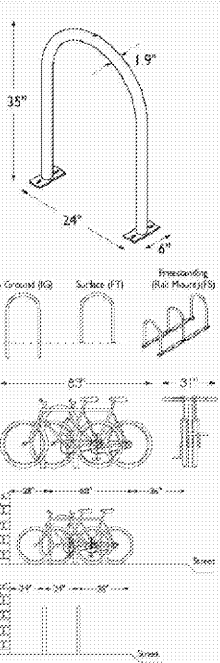

**HOOP BIKE RACK DETAIL**

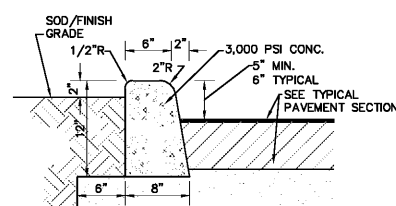

**STRAIGHT 6"x12" CURB**

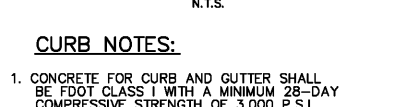

- CURB NOTES:**
- CONCRETE FOR CURB AND GUTTER SHALL BE FDOT CLASS II WITH A MINIMUM 28-DAY COMPRESSIVE STRENGTH OF 3,000 P.S.I.
  - WHEN USED ON HIGH SIDE OF ROADWAY, THE CROSS SLOPE OF THE GUTTER SHALL MATCH THE CROSS SLOPE OF THE ADJACENT PAVEMENT. THE THICKNESS OF THE LIP SHALL BE 6" MIN.
  - CONSTRUCT 1/2" EXPANSION JOINTS AT 100' O.C AND SAWCUT CONTRACTION JOINTS AT 10' O.C. (MAX.).
  - REFER TO FDOT INDEX #300 FOR ADDITIONAL DETAILS
  - LOCATIONS FOR USE OF REVEAL WILL BE DETERMINED BY THE ENGINEERING DEPT AT TIME OF STAKEOUT
  - MIN. SAWCUT DEPTH IS 1/4 THE DEPTH OF THE MIN. CURB DEPTH FOR VALLEY GUTTER. SAW CUT DEPTHS FOR TYPES 'E' AND 'F' CURBS PER FDOT INDEX #300

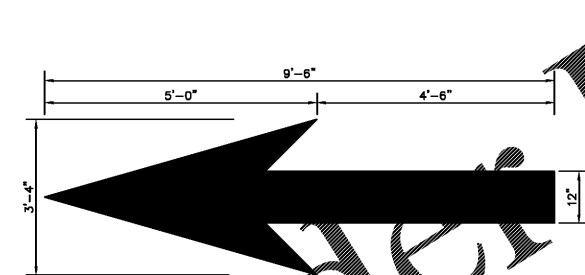

**TYPICAL DIRECTIONAL ARROW**



**TYPICAL HANDICAP SIGN**

ALL LETTERS ARE 1" SERIES 'C'.  
TOP PORTION OF SIGN SHALL HAVE A REFLECTORIZED BLUE BACKGROUND W/ WHITE REFLECTORIZED LEGEND & BORDER.  
BOTTOM PORTION OF SIGN SHALL HAVE A REFLECTORIZED WHITE BACKGROUND W/ BLACK OPAQUE LEGEND & BORDER.

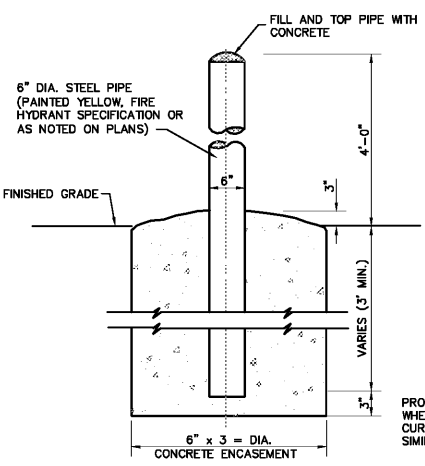

**BOLLARD POST DETAIL**

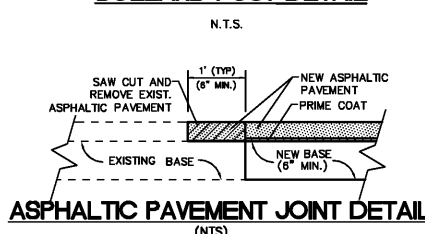

**ASPHALTIC PAVEMENT JOINT DETAIL**

**HEAVY DUTY CONCRETE APRON (TRUCK AREA)**

7" MIN. REINF. FDOT CLASS 1 CONC. (W/#4 BAR, 12" O.C. BOTHWAYS)  
12" MIN. STABILIZED SUBGRADE AND SHOULDERS (L.B.R.40) COMPACTED TO A MIN. OF 98% AASHTO T-180 F.D.O.T.

**TYPICAL CONCRETE APRON SECTIONS**

- NOTES:**
- REFER TO FDOT SECTION 350.
  - ALL EXPOSED CONCRETE TO HAVE SMOOTH BROOM FINISH, INCLUDING WALKS, APRONS & PARKING LOT UNLESS OTHERWISE NOTED
  - SEE SIDEWALK DETAIL SPEC'S AND JOINT REQUIREMENTS.

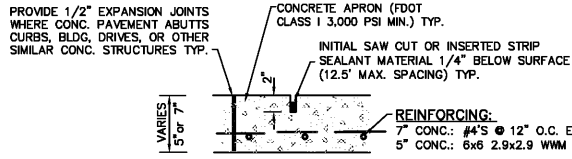

- NOTES:**
- REFER TO FDOT SECTION 350.
  - ALL EXPOSED CONCRETE TO HAVE SMOOTH BROOM FINISH, INCLUDING WALKS, APRONS & PARKING LOT UNLESS OTHERWISE NOTED
  - SEE SIDEWALK DETAIL SPEC'S AND JOINT REQUIREMENTS.

**TYPICAL CONCRETE APRON JOINT SECTION/DETAIL**

N.T.S.

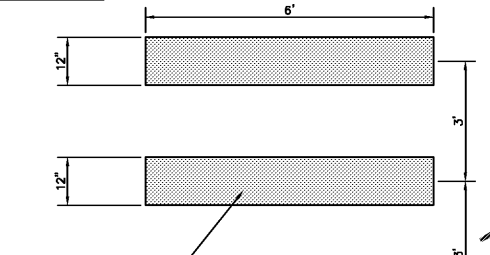

**TYPICAL HIGH VISIBILITY CROSSWALK FOR PARKING LOTS**

N.T.S.

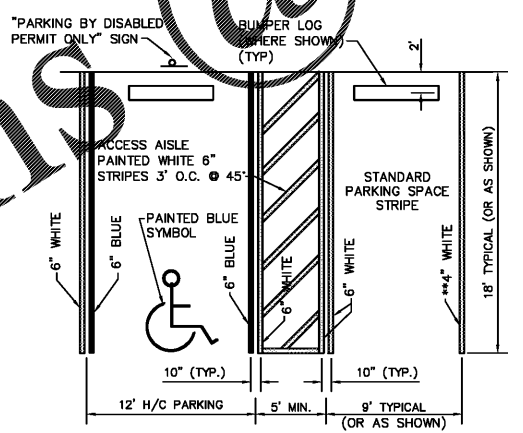

**TYPICAL STRIPING DETAIL**

N.T.S.

- STRIPING NOTE:**
- THE CONTRACTOR SHALL COMPLY WITH THE "STATE OF FLORIDA MANUAL OF TRAFFIC CONTROL AND SAFE PRACTICES FOR STREET AND HIGHWAY CONSTRUCTION, MAINTENANCE, AND UTILITY OPERATIONS" AND WITH THE "MANUAL ON UNIFORM TRAFFIC CONTROL DEVICES"
  - ALL STRIPING AND PAVEMENT MARKINGS WITHIN SITE SHALL BE TWO (2) COATS OF TRAFFIC REFLECTIVE PAINT (F.D.O.T. SECT. #710) UNLESS OTHERWISE NOTED ON PLANS OR SPECIFICATION.
  - ALL PAVEMENT MARKING AND STRIPING WITHIN A COUNTY R/W SHALL BE IN THERMOPLASTIC.
  - THE CONTRACTOR TO INSTALL BLUE//BLUE RPM'S IN THE CENTER OF THE LANE ADJACENT TO ALL FIRE HYDRANTS.

**STANDARD (STD) PAVEMENT SECTION PARKING LOT**

1 1/2" ASPHALTIC CONC (SP-12.5) FDOT SPEC 334  
PRIME COAT, GRADE RC-70 OR RC-250, SHALL BE APPLIED AT A RATE OF 0.10 GAL. SQ. YD. F.D.O.T. SPEC. 300  
6" LIMEROCK BASE COURSE COMPACTED TO A MIN DENSITY OF 98% AASHTO T-180 F.D.O.T. SPEC 200 (LBR 100)  
6" STABILIZED SUBGRADE AND SHOULDERS (L.B.R.40) COMPACTED TO A MIN. OF 98% AASHTO T-180 F.D.O.T. SPEC. 100

**HEAVY DUTY (HD) PAVEMENT SECTION TRUCK TRAFFIC AREAS**

1-1/4" ASPHALTIC CONC (SP-12.5) & 3/4" (SP-9.5) WEARING SURFACE FDOT SPEC 334, OVER TACK COAT  
PRIME COAT, GRADE RC-70 OR RC-250, SHALL BE APPLIED AT A RATE OF 0.10 GAL. SQ. YD. F.D.O.T. SPEC. 300  
8" LIMEROCK BASE COURSE COMPACTED TO A MIN DENSITY OF 98% AASHTO T-180 F.D.O.T. SPEC 200 (LBR 100)  
12" STABILIZED SUBGRADE AND SHOULDERS (L.B.R.40) COMPACTED TO A MIN. OF 98% AASHTO T-180 F.D.O.T. SPEC. 100

**TYPICAL PAVEMENT SECTIONS**

N.T.S.

**REFUSE/WASTE MANAGEMENT REQUIREMENTS**

COMMERCIAL BUSINESS (3,000 SQ.FT. - 10,000 SQ.FT.):  
BUILDING: 7.50 SQ.FT.  
MINIMUM SQ. FT. FOR GARBAGE COLLECTION: 80 SQ.FT.  
MINIMUM SQ. FT. FOR RECYCLABLE COLLECTION: 48 SQ.FT.  
REQUIRE: 128 SQ.FT. MINIMUM PROVIDED: 246.7 SQ.FT. (INTERIOR)

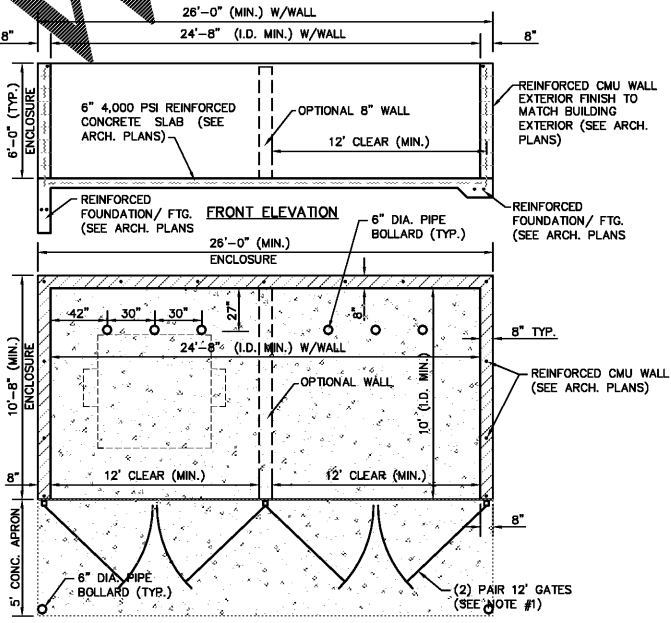

**DOUBLE MASONRY TRASH PAD AND RECYCLE ENCLOSURE**

N.T.S.

- GENERAL NOTES:**
- OPAQUE GATES (SEE ARCHITECTURAL PLANS, DETAILS AND SPECIFICATIONS)
  - 6" DIA. PIPE BOLLARD FILLED WITH CONCRETE SET IN CONC. 3' DEPTH & 4" ABOVE FIN. GRADE, PAINTED OSHA YELLOW. OR APPROVED EQUAL
  - CONTRACTOR TO SUPPLY SHOP DRAWINGS FOR ALL DUMPSTER ENCLOSURE HARDWARE INCLUDING GATES PRIOR TO INSTALLATION.
  - CONTRACTOR SHALL SUPPLY AND INSTALL ALL MATERIALS UNLESS OTHERWISE NOTED.
  - REFER TO ARCHITECTURAL PLANS FOR ALL DETAILS & STRUCTURAL DESIGN. ENCLOSURE EXTERIOR FINISHES TO MATCH COLOR, TEXTURE, BANDING, ETC. OF THE PRIMARY BUILDING FACADE (SEE ARCHITECTURAL PLANS).
  - A MINIMUM OF 22' FEET OF CLEAR HEIGHT IS REQUIRED ABOVE ALL ENCLOSURES.

**DOUBLE MASONRY TRASH PAD AND RECYCLE ENCLOSURE**

N.T.S.

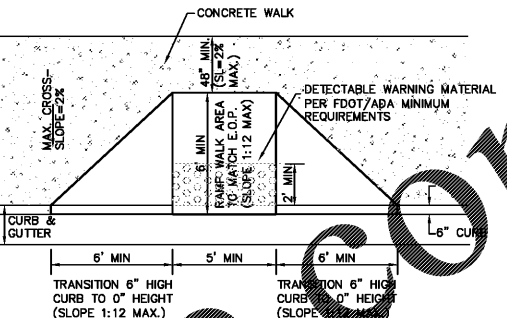

**HANDICAP RAMP**

N.T.S.

- NOTE:**
- DETECTABLE WARNING MATERIAL SHALL BE PROVIDED (24" MIN. DEPTH FROM BACK OF CURB AND FULL WIDTH OF FLUSH TRANSITION) AT ALL HANDICAP RAMPS AND WHERE WALKWAY ENTERS CIRCULAR TRAFFIC AREAS, AND SHALL MEET MINIMUM FDOT/ADA REQUIREMENTS. REFER TO FDOT 304 FOR ADDITIONAL DETECTABLE WARNING DETAILS.

**TABLE OF SIDEWALK JOINTS**

TYPE	LOCATION
A	PC & PT OF CURVES
B	JUNCTION OF EXISTING NEW SIDEWALKS
C	5'-0" CENTER TO CENTER ON SIDEWALKS
C	WHERE SIDEWALK ABUTS CONCRETE DRIVEWAYS AND SIMILAR STRUCTURES.

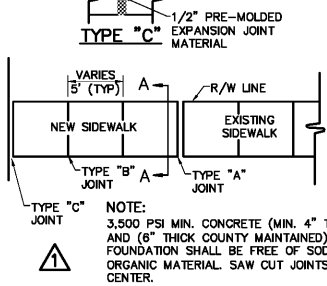

**SIDEWALK JOINTS DETAIL**

N.T.S.

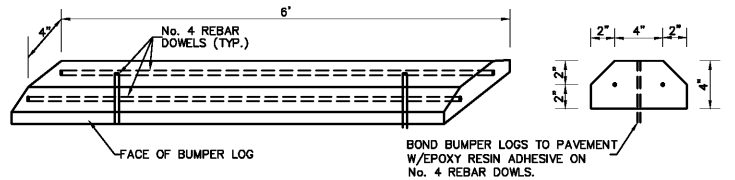

**6" PRE-CAST CONCRETE BUMPER LOG**

N.T.S.

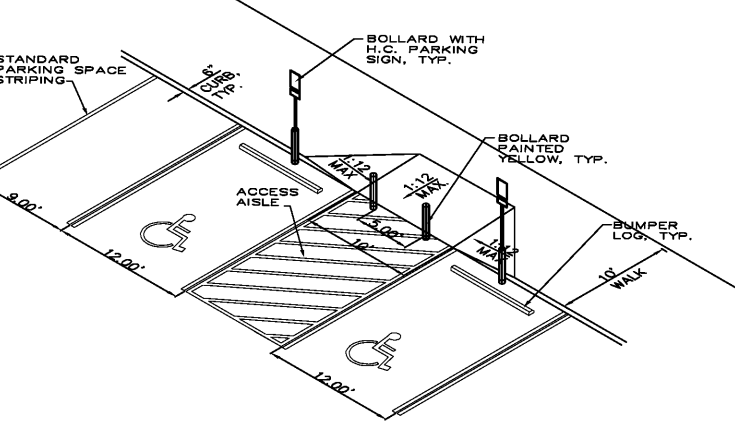

**HANDICAP PARKING, ACCESS RAMP AND ACCESS AISLE DETAIL**

N.T.S.

ALL EXISTING AND PROPOSED GRADES SHOWN REFER TO N.A.V.D. 88 (PER SURVEY)

BID SET (NOT FOR CONSTRUCTION)

01/26/18

Brannon D. Sloan  
FL. LICENSE # 69978

DATE	BY	REVISION DESCRIPTION
10/15/17	BS	COUNTY A.G. INITIAL SUBMITTAL
12/15/17	BS	COUNTY COMMENTS 11/15/17
01/23/18	BS	PER LOG COMMENTS
01/26/18	BS	REV SET

**AVALON ENGINEERING, INC.**  
2503 DEL PRADO BLVD. #200  
CAPE CORAL, FLORIDA 33904  
FBPE#3128 (239) 573-2077

**DEVELOPER:** Dollar General, LLC  
1643 Williamsburg Square  
Lakeland, Florida 33803  
(863) 808-1320

**DOLLAR GENERAL**  
4055 HANCOCK BRIDGE PARKWAY  
LEE COUNTY, FLORIDA

**TYPICAL SITE & STRIPING DETAILS**

#17-108/CONST