

⊕ KEY PLAN
HH A1.2 SCALE: 1/32" = 1'-0"

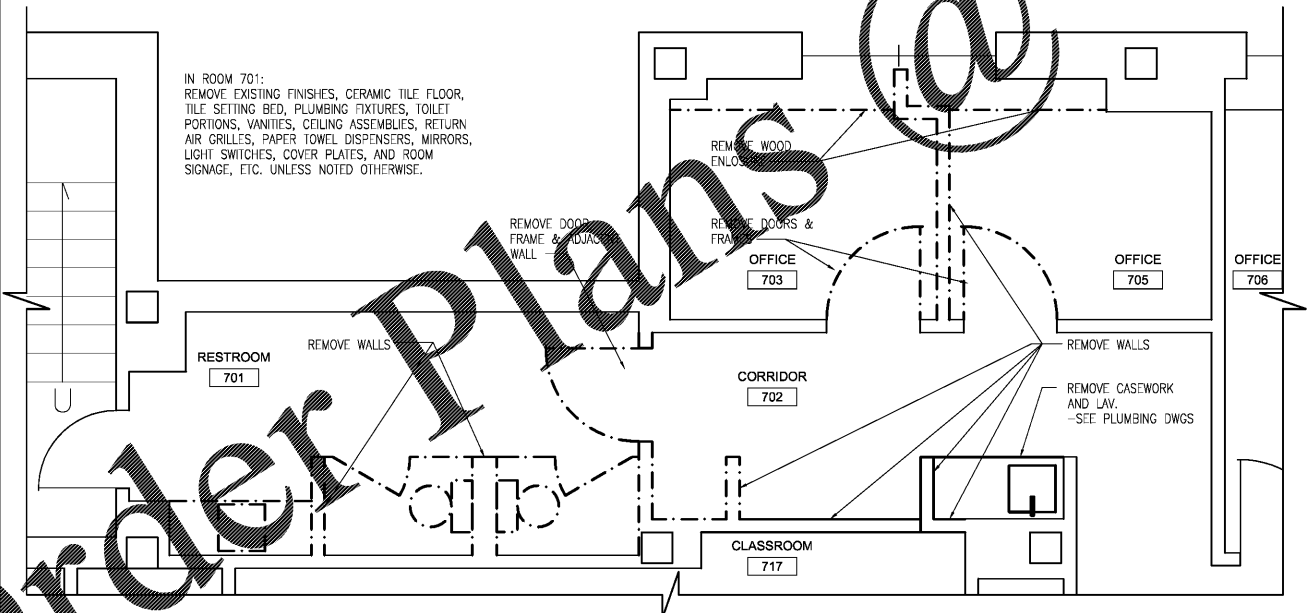

⊕ HAAS-HOWELL 7th FLOOR RESTROOM DEMOLITION PLAN
HH A1.2 SCALE: 1/4" = 1'-0"

GENERAL NOTES:

1. INFORMATION SHOWN IS NOT PURPORTED TO BE AN ACCURATE AND/OR DETAILED REPRESENTATION OF EXISTING CONDITIONS. CONTRACTOR SHALL FIELD VERIFY EXISTING CONDITIONS, (INCLUDING PARTITIONS, UTILITIES, AND EQUIPMENT) PRIOR TO COMMENCEMENT OF CONSTRUCTION IN ANY AREA. CONDITIONS AT A VARIANCE WITH THE INFORMATION CONTAINED ON THE CONTRACT DOCUMENTS SHALL BE BROUGHT TO THE ARCHITECT'S ATTENTION FOR ADDITIONAL INSTRUCTIONS PRIOR TO PROCEEDING WITH WORK IN THAT AREA.
2. FIELD VERIFY ALL DIMENSIONS.
3. BUILDING WILL BE OCCUPIED BY OWNER DURING CONSTRUCTION. PROVIDE TEMPORARY PARTITIONS AS REQUIRED. EGRESS TO FIRE EXITS MUST BE MAINTAINED AT ALL TIMES. ALL DEMOLITION WORK SHALL COMPLY WITH THE REQUIREMENTS OF THE 2013 EDITION OF NFPA 241 STANDARD FOR SAFEGUARDING CONSTRUCTION, ALTERATION, AND DEMOLITION OPERATIONS. REFER TO NFPA 101:4.6.10.1, 2012 EDITION: "BUILDINGS OR PORTIONS OF BUILDINGS SHALL BE PERMITTED TO BE OCCUPIED DURING CONSTRUCTION, REPAIR, ALTERATIONS, OR ADDITIONS ONLY IF ALL REQUIRED MEANS OF EGRESS AND ALL REQUIRED FIRE PROTECTION FEATURES ARE IN PLACE AND CONTINUOUSLY MAINTAINED FOR THE PORTION OCCUPIED..."
4. NO MORE THAN ONE SET OF TOILET ROOMS TO BE OUT OF SERVICE AT ANY TIME.
5. REPAIR ALL DAMAGE RESULTING FROM THE PROJECT AND LEAVE ALL AREAS CLEAN AND FREE OF DUST AND DEBRIS AT THE COMPLETION OF THE PROJECT.
6. ALL FLOOR PENETRATIONS THROUGH EXISTING SLABS CREATED BY REMOVAL OF EXISTING UTILITIES SHALL BE FILLED WITH CONCRETE AND LEVELED WITH EXISTING FLOOR.
7. AT NEW OPENINGS IN EXISTING WALLS REMOVE THE EXISTING WALL FOR THE OPENING WITH A REQUIRED PLUS MINUS 2" EACH SIDE FOR NEW LEVEL BEARING. PATCH EXISTING OR INSTALL NEW FINISH AS INDICATED OR DETAILED.
8. THE EXISTING CONDITION OF ALL ITEMS NOTED OR SHOWN TO BE REMOVED FOR REUSE SHALL BE FIELD VERIFIED PRIOR TO DEMOLITION. ANY EXISTING DAMAGE SHALL BE BROUGHT TO THE OWNER AND ARCHITECT'S ATTENTION AND NOTED PRIOR TO DEMOLITION. ANY ITEM DAMAGED DURING CONSTRUCTION SHALL BE THE RESPONSIBILITY OF THE CONTRACTOR TO CORRECT OR REPLACE.
9. REMOVE EXISTING CERAMIC WALL, BASE AND FLOOR TILE. REMOVE SETTING BED DOWN TO SUBSTRATE. CLEAN AND PREP FOR PROPOSED FINISHES.
10. PATCH AND REPAIR ANY DAMAGE CAUSED BY REMOVAL OF FLOORING WITH ARDEX REPAIR SYSTEM OR EQUAL.
11. REMOVE SIGNAGE ON EXISTING DOORS
12. SAW CUT ALL MASONRY OPENINGS
13. ALL EXISTING AREAS DISTURBED DIRECTLY OR INDIRECTLY BY NEW CONSTRUCTION SHALL BE PATCHED TO MATCH EXISTING, UNLESS OTHERWISE NOTED.
14. SEE PLUMBING DRAWINGS FOR DEMOLITION AND NEW WORK PERTINENT TO THAT TRADE.
15. ALL PENETRATIONS THROUGH EXISTING SLABS OR WALLS CREATED BY REMOVAL OF EXISTING UTILITIES SHALL BE PATCHED TO MATCH EXISTING.
16. INSTALL NEW LIGHT FIXTURES, MOTION DETECTORS, LIGHT SWITCHES AND OUTLETS TO CONFORM WITH CAMPUS STANDARDS
17. CLEAN SUBSTRATES AND PREP FOR NEW FINISH
18. ANY WORK REQUIRING THE USE OF A CONCRETE SAW, HAMMER DRILL, CHIPPING HAMMER, ETC. THAT PRODUCES LOUD NOISES SHALL BE LIMITED TO NON OWNER OCCUPIED TIMES SUCH AS WEEKENDS OR 10PM TO 8AM ON WEEKDAYS. COORDINATE WITH OWNER.

ASBESTOS HAZARD NOTIFICATION:

THE OWNER IS RESPONSIBLE FOR THE REMOVAL OF ASBESTOS THAT MAY EXIST IN THE WORK AREA. DO NOT DISTURB ANY MATERIALS THAT CONTAIN ASBESTOS. SEE SPECIAL CONDITIONS OF THE CONTRACT DOCUMENTS FOR REQUIREMENTS REGARDING ASBESTOS.

DEDUCTIVE ALTERNATES:

- BIDS SHOULD INDICATE THE FOLLOWING DEDUCTIVE ALTERNATES IN THIS ORDER:
1. 7TH FLOOR HAAS-HOWELL
 2. 6TH FLOOR HAAS-HOWELL
 3. 8TH FLOOR HAAS-HOWELL

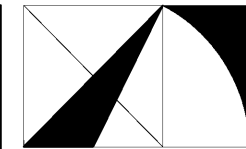

THE ARCHITECTURE GROUP, INC.

381 Virginia St.
Atlanta, GA 30313
Phone: (678) 222-0375
Fax: (678) 222-0384
tag@architecturegroup.com

COPYRIGHT © 2018 BY THE ARCHITECTURE GROUP, INC. ALL RIGHTS RESERVED.

THIS DRAWING MAY NOT BE USED IN ANY MANNER NOR REPRODUCED IN ANY FORM WITHOUT PRIOR WRITTEN CONSENT FROM THE ARCHITECTURE GROUP, INC.

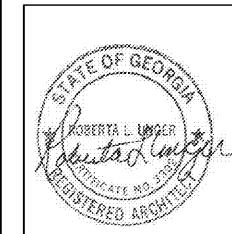

2018 MRRF CAMPUS-WIDE ADA IMPROVEMENTS

PROJECT No. 1GSU-026-18

TAG PROJECT No. 1706

GEORGIA STATE UNIVERSITY

ATLANTA, GEORGIA

REVISIONS	DATE

DATE	2/5/2017
DRAWN BY	MW
CHECKED	MC
APPROVED	BU
SCALE	AS NOTED
PROJECT NUMBER	1706

DRAWING TITLE
**HAAS-HOWELL
DEDUCTIVE
ALTERNATE #1
7th FLOOR
RESTROOM
DEMOLITION PLAN**
DRAWING NUMBER

HH A1.2