

REVISIONS

No	Date	Description
01/22/18		90% OWNER REVIEW
01/26/18		PERMIT

SYMBOL KEY

	EXISTING PIPING	
	NEW PIPING	
	EXISTING PIPING TO BE REMOVED	
	EXISTING SPRINKLER TO BE REMOVED	
	NEW CHROME RECESSED	ORD5.6QR
	NEW EC BRASS PENDENT	NT25.2SR
	EXISTING CHROME RECESSED	ORD5.6QR
	EXISTING BRASS PENDENT	NT25.2SR
	CENTER LINE OF SPRINKLER. ALIGN WITH OTHER SPRINKLERS. COORDINATE WITH OTHER METAL DECK	
	RECOMMENDED CENTER LINE ELEVATION OF PIPE BELOW METAL DECK	
	APPROXIMATE CENTER LINE ELEVATION OF EXISTING PIPE BELOW METAL DECK	
	PIPE FROM LEFT TO RIGHT AND FROM RIGHT TO LEFT	
	PIPE	
	HYDRANT REFERENCE POINT	
	NOT IN SCOPE	
	NEW CONNECTION TO EXISTING PPE	

- FIRE SPRINKLER DEMOLITION NOTES
- FIRE SPRINKLER CONTRACTOR'S SCOPE OF WORK SHALL INCLUDE:
    - SHUT DOWN AND DRAINING OF EXISTING SYSTEM.
    - DEMOLITION OF ALL EXISTING SPRINKLERS, PIPING, HANGERS, ETC. THROUGHOUT THE NEW BABIES R US SPACE BACK TO THE BASE OF THE RISER, U.N.O.
  - FIRE SPRINKLER CONTRACTOR SHALL BE RESPONSIBLE FOR REPLACING ANY EXISTING PIPE OR FITTINGS TO REMAIN THAT ARE DAMAGED AS A RESULT OF THEIR WORK AT NO COST TO THE OWNER.

SEE SHEET FP101 FOR GENERAL NOTES, HANGER NOTES, DESIGN CRITERIA, ETC.

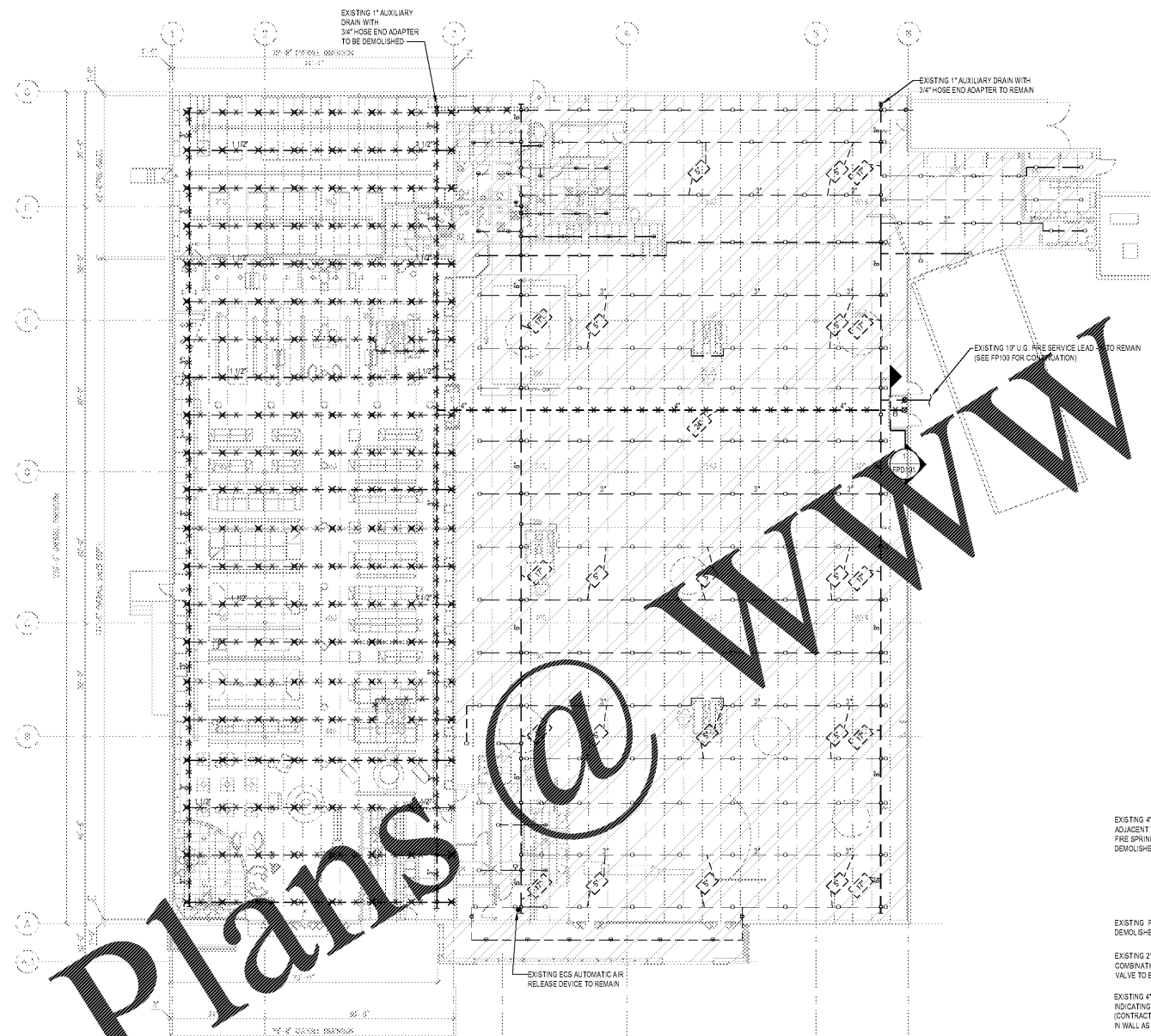

**FIRE SPRINKLER DEMOLITION PLAN**  
SCALE: 1/16" = 1'-0"  
FIN. FLOOR ELEV. = 100'-0"

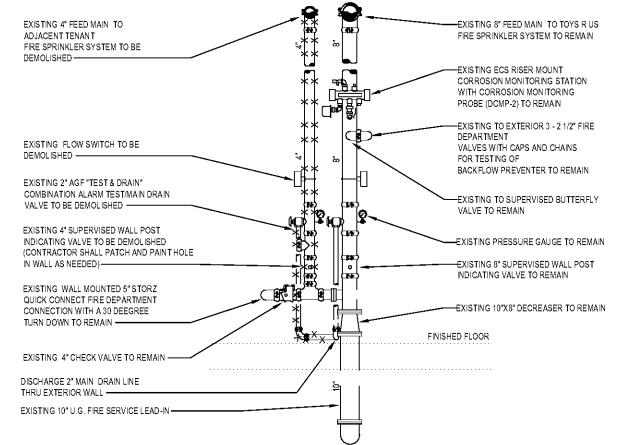

**ELEVATION AT RISER MANIFOLD - DEMOLITION WORK**  
FIN. FLOOR ELEV. = 100'-0"

**NO SUBSTITUTIONS SHALL BE ALLOWED UNLESS OTHERWISE NOTED (REFER TO SPECIFICATIONS)**



**CODE CONSULTANTS, INC.**  
2043 WOODLAND PKWY, SUITE 300  
ST. LOUIS, MISSOURI 63146-4235  
314-991-2633  
www.codeconsultants.com



**CASCO**  
10877 WATSON ROAD  
ST. LOUIS, MO 63127  
PROJECT MANAGERS

BD DATE: 2/1/2018  
CAG NAME: 2/1/2018  
DRAWN BY: JSM  
PROJECT NO.: 20180306-001  
CHECKED BY: JSM  
PROTOTYPE

**FIRE PROTECTION ENGINEER OF RECORD:**  
WILLIAM B. SMITH, PE  
LICENSE NO. 88528  
STATE OF FLORIDA  
PROFESSIONAL ENGINEER



GLOBAL RESOURCE CENTER  
ONE GEOFFREY WAY  
WAYNE, NJ 07140  
(973) 617-3500

THIS DRAWING IS THE EXCLUSIVE PROPERTY OF TOYS "R" US. THE INFORMATION SHOWN MAY NOT BE USED NOR THE DRAWINGS REPRODUCED WITHOUT PERMISSION OF TOYS "R" US.

Location  
**LAKELAND, FLORIDA**  
3770 US HIGHWAY 98 NORTH-33809

Drawing Title  
**FIRE SPRINKLER DEMOLITION PLAN**

Scale: Date: 1/26/18

Sheet No.  
**FPD101**

Order Plans @ WWW.LDILLINE.COM