

REVISIONS

No.	Date	Description
01/22/18		30% OWNER REVIEW
01/25/18		ISSUED FOR PERMITTING

NO SUBSTITUTIONS SHALL BE ALLOWED UNLESS OTHERWISE NOTED (REFER TO SPECIFICATIONS)

DESIGNED FOR: FLORIDA BUILDING CODE, 6TH EDITION (2017).



Architecture & Engineering
10577 WATSON ROAD
SAINT LOUIS, MO 63127
TEL: (314) 821-1100

BD DATE: 01/23/18 PROJECT NO: 918219
CAD NAME: JMS CHECKED BY: JMS
DRAWN BY: JMS
PROTOTYPE:

CASCO PROFESSIONAL SERVICES LLC
LIC #4488024241 EXPIRES: 02/28/18
JAN 29 2018
PROFESSIONAL OF RECORD
JAMES S. JOSEPH
LIC #44983228 EXPIRES: 02/28/19



GLOBAL RESOURCE CENTER
ONE GEOFFREY WAY
WAYNE, NJ 07470
(973) 617-5500

THIS DRAWING IS THE EXCLUSIVE PROPERTY OF TOYS 'R' US. THE INFORMATION SHOWN MAY NOT BE USED NEAR THE DRAWINGS REPRODUCED WITHOUT PERMISSION OF TOYS 'R' US.

Location
LAKELAND, FLORIDA
3770 US HIGHWAY 98 NORTH 33809

Drawing Title
FLOOR FINISH PLAN & DETAILS

Scale AS NOTED Date 1/29/18

Sheet No. **A103**

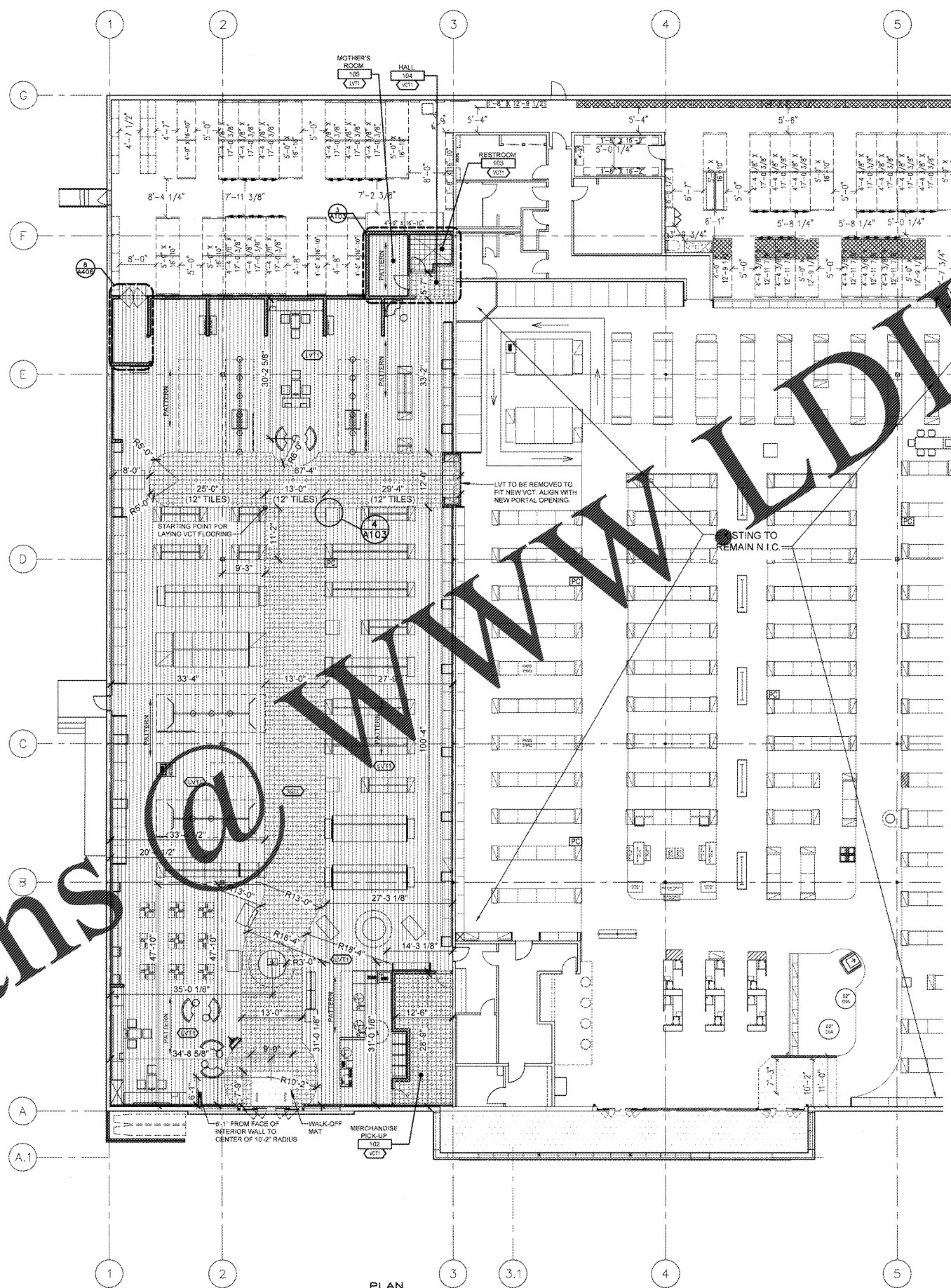

FLOOR FINISH PLAN
SCALE = 3/32" = 1'-0"

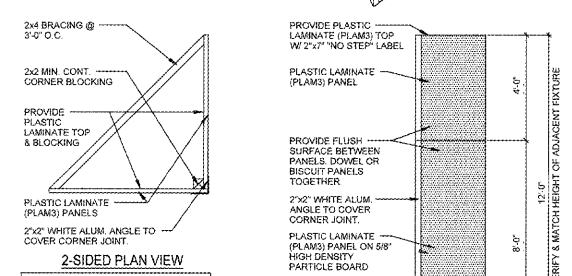
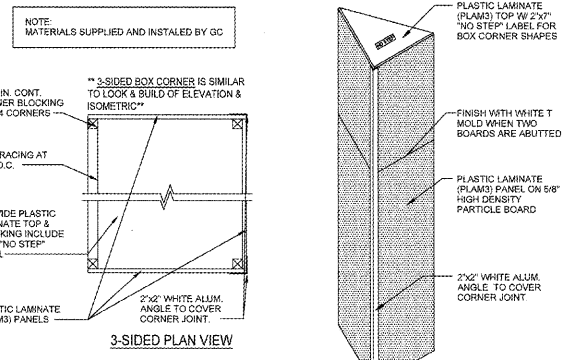

1 DETAIL @ BOXED CORNER
A103 SCALE: 1/2" = 1'-0"

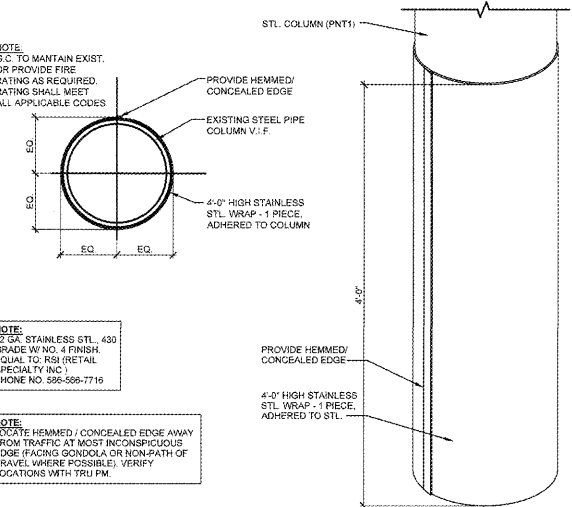

2 DETAIL
A103 SCALE: 1 1/2" = 1'-0"

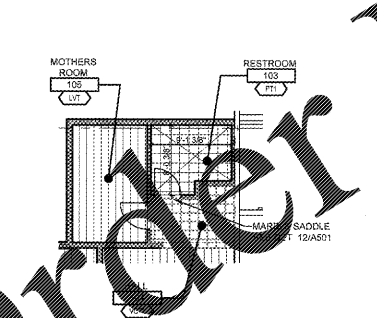

FLOORING SQ. FT.

FINISH	SQ. FT.
VCT	10,142
PT	97
PT	57

FLOORING AREAS ARE APPROXIMATE AND NOT FOR ORDERING INFORMATION

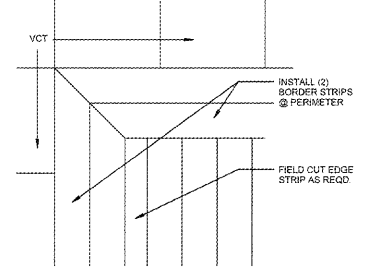

4 VINYL STRIP TILE DETAIL
A103 SCALE: 1 1/2" = 1'-0"

GENERAL FLOORING INSTALLATION

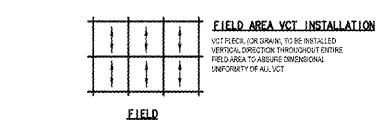
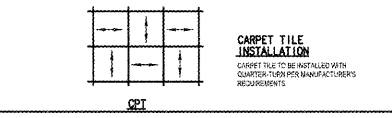

GENERAL NOTES

- THE CONTRACTOR SHALL INSTALL STORE FIXTURES & END PANELS. FIELD VERIFY THE FIXTURE GRID/LAYOUT W/ FIXTURE PLAN "F1" PRIOR TO INSTALLATION.
- THE CONTRACTOR SHALL PROVIDE AND INSTALL ALL SEISMIC ANCHORS, BRACING, STRAPS, ETC. WHERE REQUIRED BY LOCAL LAWS, CODES & ORDINANCES, INCLUDING AT ALL MERCHANDISE FIXTURES.
- THE CONTRACTOR IS RESPONSIBLE FOR CONSTRUCTION OF ALL BOXED CORNERS. (REFER TO FIXTURE PLAN "F1" FOR SCOPE & QUANTITY, AND DETAIL 1/A103 FOR MATERIALS & FINISHES.)

FLOOR FINISH LEGEND

VCT	VINYL COMP. TILE	PT	PORCELAIN TILE (FIELD)
CPT	CARPET TILE	PT	PORCELAIN TILE (ACCENT)
VST	VINYL STRIP TILE	ECS	EXPOSED CONCRETE SLAB
ETR	EXISTING TO REMAIN	AT	ALUMINUM TRANSITION
		VT	REDUCER MOLDING

Order Plans