

GA-414 STORE
66,672 S.F.

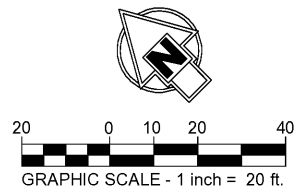

EXISTING CONDITIONS NOTE:
THIS SITE WAS NOT RECENTLY SURVEYED. EXISTING CONDITIONS ARE BASED ON AERIALS, MAPS, AN AS-BUILT TOPOGRAPHIC SURVEY BY SURVEYS PLUS, INC., DATED 05-15-2015. THE EXACT LOCATION OF EXISTING UTILITIES IS NOT KNOWN. CONTRACTOR SHALL USE CAUTION DURING EXCAVATION AND CONSTRUCTION, ESPECIALLY WHEN INSTALLING PROPOSED CLICKLIST SIGNS. CONTRACTOR SHALL CALL 811 TO VERIFY LOCATION OF UNDERGROUND UTILITIES.

CLICKLIST EXISTING CONDITIONS

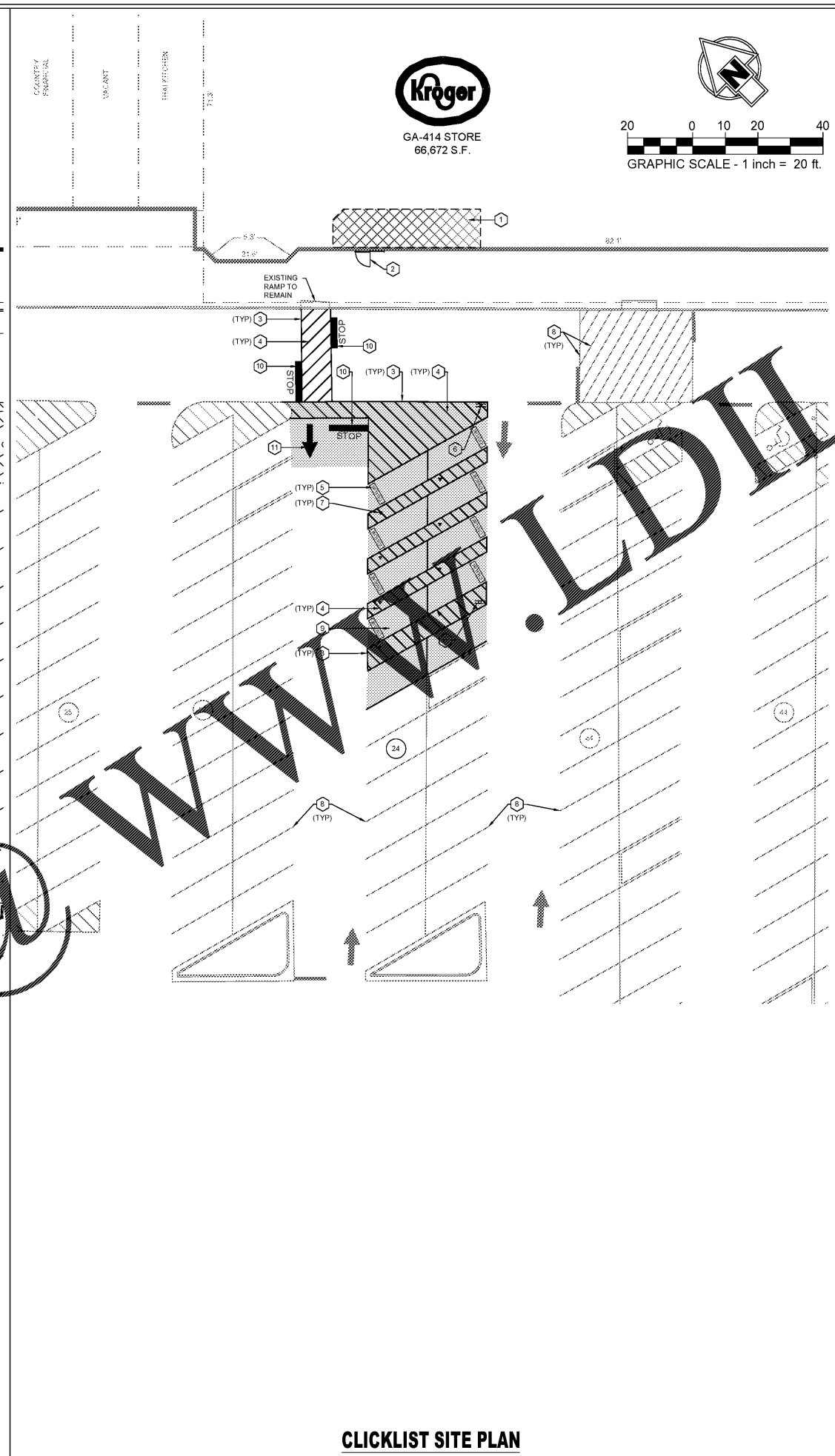

GA-414 STORE
66,672 S.F.

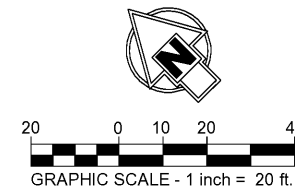

CLICKLIST SITE PLAN



100 NORTH MAIN STREET, SUITE F (615) 855-2220 (V)
GOODLETTSVILLE, TENNESSEE 37072 (615) 855-2221 (F)



Know what's below.
Call before you dig.

PAVING LEGEND:

SEAL COAT

SITE KEY NOTES:

- 1 PROPOSED CLICKLIST AREA (REF. ARCH. PLANS)
- 2 CLICKLIST DOORS (REF. ARCH. PLANS)
- 3 4" PAINTED SSWL
- 4 4" PAINTED SSWL @ 3' O.C. @ 45°
- 5 PAINTED PAVEMENT MARKINGS, COLOR - WHITE LETTERS ON A CLICKLIST BLUE BACKGROUND (REF. C-5.1)
- 6 INSTALL CLICKLIST DIRECTIONAL SIGN 62A (SIGN PROVIDED BY KROGER, INSTALLED BY CONTRACTOR) (REF. C-5.1)
- 7 INSTALL CLICKLIST INFORMATIONAL SIGN 63A (SIGN PROVIDED BY KROGER, INSTALLED BY CONTRACTOR) (REF. C-5.1)
- 8 EXISTING STRIPING TO REMAIN
- 9 SEAL COAT EXISTING PAVEMENT
- 10 24" WIDE WHITE PAINTED STOP BAR & "STOP" (MATCH EXISTING)
- 11 PAINTED WHITE DIRECTIONAL ARROW (MATCH EXISTING)

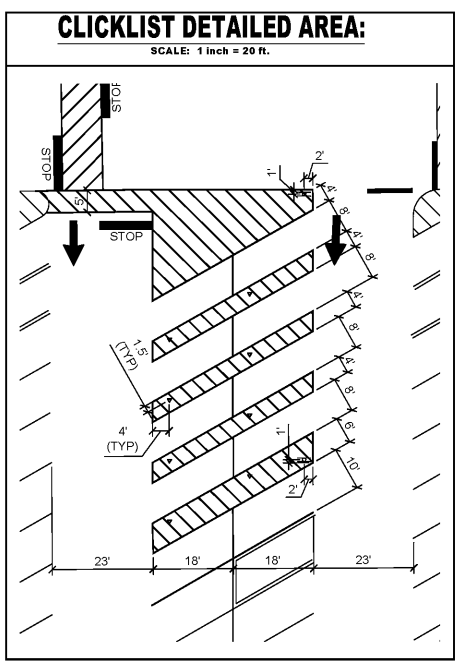

CLICKLIST DETAILED AREA:

SCALE: 1 inch = 20 ft.



111 E. Jackson Avenue • Suite 101
Knoxville, Tennessee • 37915
phone: 865-546-9374 • fax: 865-673-9028
e-mail: design@dollar-ewers.com

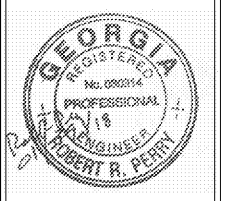

NO.	REVISIONS

A With-in-the-Walls Remodel for:
KROGER STORE #GA-414
4355 WASHINGTON ROAD, EVANS, GEORGIA 30809
CLICKLIST PLANS

COPYRIGHT
ALL DRAWINGS, SPECIFICATIONS AND COPIES THEREOF FURNISHED BY DOLLAR & EWBERS ARCHITECTURE, INC. ARE AND SHALL REMAIN THE PROPERTY OF DE&E. THEY ARE TO BE USED ONLY WITH RESPECT TO THE PROJECT, PROJECT AND SITE SPECIFIC. USE WITH ANY OTHER PROJECT OR SITE WITHOUT THE WRITTEN CONTRACT IS FOR EACH PARTY TO THE CONTRACT. SUCH DOCUMENTS ARE TO BE RETURNED TO DOLLAR & EWBERS ARCHITECTURE, INC. OR DESTROYED AT THE COMPLETION OF THE WORK. SUBMISSION OF THIS DRAWING TO ANY OTHER PARTY OR FOR OTHER PURPOSES IN CONNECTION WITH THE PROJECT IS NOT TO BE CONSIDERED A PUBLICATION IN VIOLATION OF DE&E'S COMMON LAW COPYRIGHT OR OTHER RESERVED RIGHTS.
COPYRIGHT

ISSUE DATE: JANUARY 29, 2018
PROJECT NO: PELLC # 125-228
SHEET NUMBER

C-2.1

Order Plans @