

STRUCTURAL COORDINATION NOTES:
 CLOSELY COORDINATE THE PLUMBING INSTALLATION WITH THE STRUCTURE, OTHER TRADES, AND CORRESPONDING OBSTRUCTIONS. SET INVERT ELEVATIONS OF ALL BRANCH LINES. LAYOUT EXACT RUNS, AND DETERMINE FINAL PITCH ADJUSTMENTS FOR UNDERFLOOR PIPING AS NECESSARY TO ACCOMMODATE FOUNDATION WALLS, PIERS, AND FOOTINGS. ADJUST PIPING AS NEEDED TO AVOID CONFLICT IN THE FIELD. CLOSELY COORDINATE ALL UNDERFLOOR PIPING LAYOUTS WITH THE GENERAL CONTRACTOR PRIOR TO CONSTRUCTION. VERIFY ALL PIPE ROUTING THROUGH OR BENEATH THE FOUNDATION WALLS WITH THE STRUCTURAL ENGINEER TO ENSURE PROPER PLACEMENT. DO NOT PIERCE, PENETRATE, OR OTHERWISE MODIFY ANY STRUCTURAL COMPONENTS WITHOUT PRIOR WRITTEN APPROVAL FROM THE STRUCTURAL ENGINEER.

DENTAL EQUIPMENT COORDINATION:
 - PLUMBING CONTRACTOR TO VERIFY TYPE AND LOCATION OF ALL DENTAL EQUIPMENT, ROUGH-IN DIMENSIONS, AND REQUIRED PLUMBING CONNECTIONS. PLUMBING CONTRACTOR SHALL FURNISH AND INSTALL ALL FLOOR FIXTURES, FLOOR DRAINS, HUB DRAINS, WATER CLOSETS, LAVATORIES AND FLOOR SINKS. DENTAL EQUIPMENT SUPPLIER SHALL FURNISH AND INSTALL ALL FIXTURES IDENTIFIED ON THEIR PLANS (WITH THE EXCEPTION OF THOSE IDENTIFIED ABOVE). INSTALL ALL DENTAL EQUIPMENT AND PROVIDE ALL FIXTURE TRAPS, SUPPLIES AND STOPS, ISOLATION VALVES, MIXING VALVES, ETC. AND MAKE FINAL CONNECTIONS TO DENTAL EQUIPMENT WITH THE EXCEPTION OF FINAL CONNECTION OF AIR COMPRESSOR AND VACUUM SYSTEM BY PLUMBING CONTRACTOR. VERIFY ALL EQUIPMENT CONNECTIONS WITH THE TENANT AND EQUIPMENT SUPPLIER PRIOR TO INSTALLATION. PROVIDE ADDITIONAL CONNECTIONS AS REQUIRED. COORDINATE ALL WORK ACCORDINGLY.

- UNDERFLOOR PIPING NOTES:**
- REFER TO SHEET P-1 PRIOR TO ROUGH-IN OF FIXTURES.
 - P.C. SHALL VERIFY ELEVATION OF SANITARY MANHOLE UPSTREAM OF BUILDING POWER CONNECTION TO THE MAIN IS BELOW FLOOR ELEVATION OF TENANT BUILDING. MAINS ABOVE FLOOR ELEVATION, PROVIDE PRICE FOR A BACKWATER VALVE AND NOTIFY EXCEL ENGINEERING.
- 1 ROUTE 2" UNDERFLOOR SANITARY UP TO LAVATORY (L-1).
 - 2 ROUTE 2" UNDERFLOOR SANITARY UP TO WATER CLOSET (WC-1H).
 - 3 ROUTE 3" UNDERFLOOR SANITARY UP TO FLOOR DRAIN (FD-1). SEE "SLAB LEAVE OUT AT FLOOR DRAIN DETAIL" # D-11MD.
 - 4 ROUTE 2" UNDERFLOOR SANITARY UP TO TREATMENT SINK (S-1).
 - 5 ROUTE 2" UNDERFLOOR SANITARY UP TO TREATMENT SINK (S-2).
 - 6 ROUTE 2" UNDERFLOOR SANITARY UP TO STERILIZATION SINK (S-3).
 - 7 ROUTE 2" UNDERFLOOR SANITARY UP TO LABORATORY SINK (S-4) WITH PLASTER TRAP. PLASTER TRAP ASSEMBLY FURNISHED BY SULLIVAN-SCHIEIN AND INSTALLED BY THE PLUMBING CONTRACTOR ON THE SINK WASTE LINE. SEE DETAIL # D17MD.
 - 8 ROUTE 2" UNDERFLOOR SANITARY UP TO BREAKROOM SINK (S-5).
 - 9 ROUTE 2" UNDERFLOOR SANITARY UP TO SERVICE SINK (SS-1).
 - 10 ROUTE 3" UNDERFLOOR SANITARY UP TO A HEIGHT OF 18" FOR VACUUM WASTE. SEE RAM-VAC DETAIL SHEET P1.2 FOR MORE INFORMATION.
 - 11 PROVIDE UNDERFLOOR SANITARY WASTE CONNECTIONS TO THE EXISTING SANITARY SERVICE (PROVIDED BY LANDLORD). FIELD VERIFY EXISTING UNDERGROUND PIPING LOCATION, DEPTH AND SIZE AT POINT OF NEW CONNECTION PRIOR TO INSTALLATION OF ANY UNDERGROUND PIPING.
 - 12 TRAP PRIMER PIPING.
 - 13 ESTABLISH THE EXACT LOCATION AND SIZE OF UTILITY SERVICES PRIOR TO BUILDING ROUGH-IN. COORDINATE LOCATION OF BUILDING SERVICE ENTRANCES AND SYSTEM PIPE ROUTING WITH UTILITY SERVICE MAINS ON SITE AND ADJUST FOR SPECIFIC SITE FEATURES AND FIELD CONDITIONS ENCOUNTERED.
 - 14 ROUTE 2" UNDERFLOOR SANITARY UP TO BOTTLE FILLING STATION (BFS-1).

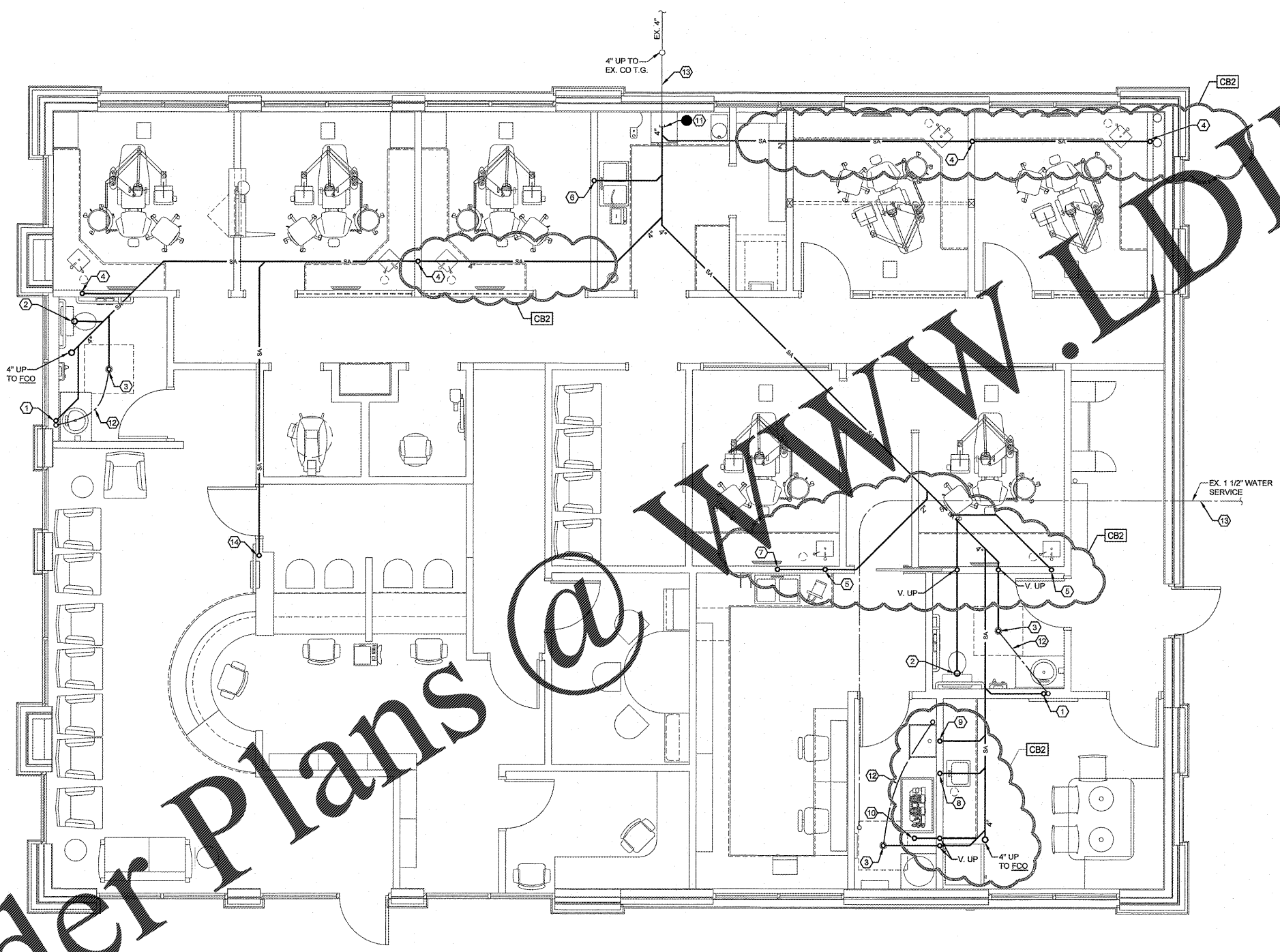

UNDERGROUND PLAN
 SCALE: 1/4" = 1'-0"



Order Plans @

WWW.LDILLINE.COM



COLLABORATION
AspenDental

PROJECT INFORMATION

PROJECT NUMBER 1712680

TENANT BUILD-OUT FOR:
ASPEN DENTAL
 3070 WILLIAM STREET • CAPE GIRARDEAU, MO 63703

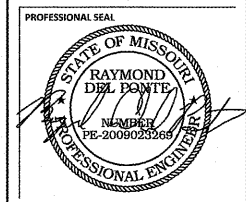

SHEET DATES

ISSUE DATE	JUNE 1, 2017
REVISIONS	
AD1	JUNE 6, 2017
AD2	JUNE 22, 2017
ENTIRE SHEET	
CB2	DEC. 19, 2017

SHEET INFORMATION

UNDERGROUND PLAN

SHEET NUMBER

P1.U

REVIEWED FOR
 CODE COMPLIANCE
 JAN 05 2018
 RETAIN AT JOB SITE
 Approved By: [Signature]
 CITY OF CAPE GIRARDEAU, Inspection Services