

12/19/2017 2:43:00 PM

BIM 360://38227 7-11 Kissimmee, FL @ Carroll St. & Dyer Blvd (17111)/38227 KISSIMMEE\_FL\_Central MEP\_R16.rvt

UNDERGROUND CONDUIT SCHEDULE		
DESIGNATOR	CONDUIT SIZE	NOTE
P1	3/4"	REFER TO E 1.0 FOR ELECTRICAL CIRCUITS. VERIFY LOCATION IS ACCEPTABLE AND FREE OF OBSTACLES PRIOR TO TRENCHING.
P2	1"	REFER TO E 1.4 FOR DATA CIRCUITS. VERIFY LOCATION IS ACCEPTABLE AND FREE OF OBSTACLES PRIOR TO TRENCHING.
P3	--	COORDINATE CONDUIT SIZE, TYPE, QUANTITY AND LOCATIONS WITH FUELING. VERIFY LOCATION IS ACCEPTABLE AND FREE OF OBSTACLES PRIOR TO TRENCHING.

KEYNOTES - SLAB	
1	DIMENSIONS TAKEN FROM GRIDLINES.

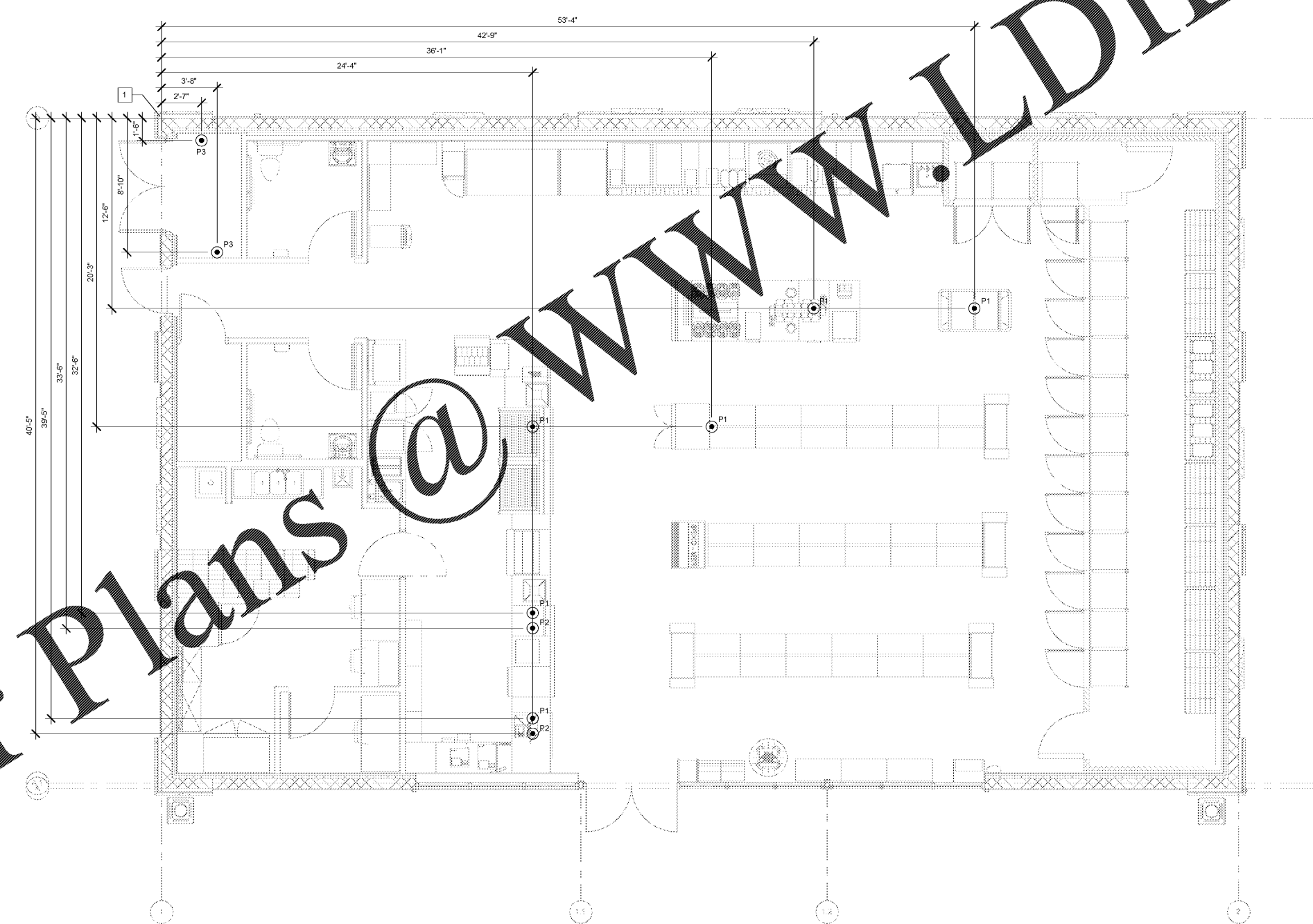

1 SLAB PENETRATION PLAN  
E1.2  
1/4" = 1'-0"

**bates**  
106 N 37TH STREET, SUITE C  
ROGERS, ARKANSAS 72756  
WWW.BATESARCHITECTS.COM  
TEL: 479.633.1111

Florida Certified Professional Engineer #12366  
Professional Seal of Andrew D. Finnegan, P.E.  
All drawings and specifications are the property of Bates Architects, Inc. and shall remain the property of Bates Architects, Inc. No part of this document may be reproduced, stored in a retrieval system, or transmitted in any form or by any means, electronic, mechanical, photocopying, recording, or by any information storage and retrieval system, without the prior written permission of Bates Architects, Inc. The user of this document is deemed to have agreed to these terms and conditions.

STORE #:  
38227

CONSTRUCTION MANAGER  
CREIGHTON CONSTRUCTION & MANAGEMENT, LLC  
900 SW PINE ISLAND ROAD, SUITE 202  
CAPE CORAL, FL 33991

TENANT  
7-ELEVEN INC.  
3200 HACKBERRY ROAD  
IRVING, TX 75063  
CONTACT: DANIEL TUBB  
STRUCTURAL CONSULTANT  
SELECT STRUCTURAL  
12573 NEW BRITANNY BLVD FORT MYERS, FL 33907

PROTO:08-21-2017

7-ELEVEN STORE  
SW/O CARROLL ST. & DYER BLVD.  
KISSIMMEE, FL 34741

CREIGHTON CONSTRUCTION & MANAGEMENT, LLC  
900 SW PINE ISLAND ROAD, SUITE 202  
CAPE CORAL, FL 33991

Engineer Name - ANDREW D FINNEGAN  
Engineer Number - 80051  
THE SEAL AND SIGNATURE APPLY ONLY TO THE DOCUMENT TO WHICH THEY ARE APPLIED AND WE HEREBY DISCLAIM ANY RESPONSIBILITY FOR ALL OTHER PLANS, SPECIFICATIONS, ESTIMATES, REPORTS OR OTHER DOCUMENTS OR INSTRUMENTS RELATING TO OR INTENDED TO BE USED FOR ANY PART OF THE PROJECT.

REVISIONS		
NO.	DATE	DESCRIPTION

PROJECT NUMBER: 17111  
RELEASE DATE: 12/19/2017

ELECTRICAL SLAB PENETRATION PLAN

**E1.2**