

3 FLOOR DRAIN DETAIL
A5.4 3" = 1'-0"

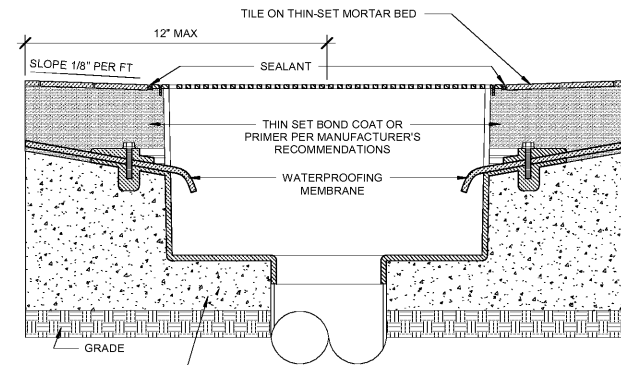

2 FLOOR SINK DETAIL (FLUSH)
A5.4 N.T.S.

KEYNOTES - FINISH FLOOR PLAN 1

- 8" (33%) OFFSET RUNNIN GBOND PORCELAIN TILE FLOOR PER MATERIAL SCHEDULE ON A3.0. 24" EDGE OF TILE TO RUN PARALLEL WITH ENTRY STOREFRONT. BEGIN FULL SIZE TILE AT EDGE OF ENTRY THRESHOLD.
- TILE TO BE INSTALLED UP TO EDGE OF MOP SINK
- THRESHOLD TO BE SET IN FULL BED OF MASTIC.
- FLOOR SINK/DRAIN PER PLAN. REF. DETAILS ON THIS SHEET & PLUMBING DRAWINGS FOR LOCATION.
- CONTRACTOR TO CUT TILE STRIGHT AND TRUE. NOT LESS THAN 1/2 A TILE.
- TEXTURED PORTION OF RAMP INDICATES DETECTABLE WARNING: ARMORE TILE TACTILE SURFACE. BRICK RED. SIZE AND PATTERN SUBJECT OT LOCAL AND STATE REQUIREMENTS. REF CIVIL SHEETS.
- REFER TO CIVIL DRAWINGS FOR EXACT REQUIREMENTS FOR RAMP, STRIPING AND TACTILE SURFACE LAYOUT.
- IF SIDEWALK DEPTH IS BETWEEN 6'-0" AND 8'-0" IN FRONT OF EQUIPMENT, CURBSTOPS OR BOLLARDS MUST BE PROVIDED ON PARKING SPACE SIDE OF CURB. TYP.

A5.4 - GENERAL NOTES

- ALL INTERIOR FINISHES TO BE CLASS 2 OR BETTER.
- CONTRACTOR TO FLOAT AND SCRAPE FLOOR TO BE LEVEL AND PREPARE FOR NEW SCHEDULED FINISH.
- CONTRACTOR TO RESERVE SPECIFIED FLOORING AND BASE UPON BEING AWARDED THE BID TO ENSURE AVAILABILITY AND TIMELY INSTALLATION. SUBSTITUTIONS ARE NOT PERMITTED.
- FLOORS IN WET AREAS TO SLOPE TO DRAINS 1/8" PER FOOT. TYP.
- PROVIDE A BEAD OF CAULK AT INTERIOR CONDITIONS PER OWNER DIRECTION AND PROJECT NEEDS. CAULK IS TO MATCH COLOR OF ADJACENT MATERIAL.
- REFERENCE INTERIOR ELEVATIONS FOR WALL FINISHES.
- REFERENCE SHEET A7.0 FOR BASE TYPES & DETAILS.
- FIRE EXTINGUISHER: #10 CLASS ABC WITH UL RATING 4A-60BC. SURFACE MOUNTED ON WALL WITH MANUFACTURERS ALL STEEL WALL BRACKET. JI INDUSTRIES INC. (COSMIC 10E) OR APPROVED EQUAL WITH INSPECTION TAG AS REQUIRED BY LOCAL CODES.
- ALL WALL FINISHES IN THE MERCHANDISE/ SALES AREAS SHALL BE FRP WALL PANEL "FR-A" UNLESS NOTED OTHERWISE ON THE FLOOR PLAN. (REFERENCE MATERIALS SCHEDULE 100)
- CONTRACTOR TO INSTALL COAT HOOKS FOR EMPLOYEES. REFERENCE SHEET A7.0. INSTALL 2 IN OFFICE AND 3 IN BACKROOM. LOCATION TO BE DETERMINED BY CONSTRUCTION MANAGER. SEE DOOR HARDWARE SCHEDULES.
- APPLY 3M SUN CONTROL WINDOW FILMS @ ALL SOUTH, EAST, AND WEST FACING GLASS (3M-1). NOTE NO FILM SHOULD BE APPLIED TO THE STOREFRONT DOOR. (REFERENCE MATERIALS SCHEDULE)
- G.C. TO FURNISH AND INSTALL RIS BACKBOARD AT WORK. REFERENCE MATERIALS SCHEDULE ON SHEET A6.1.

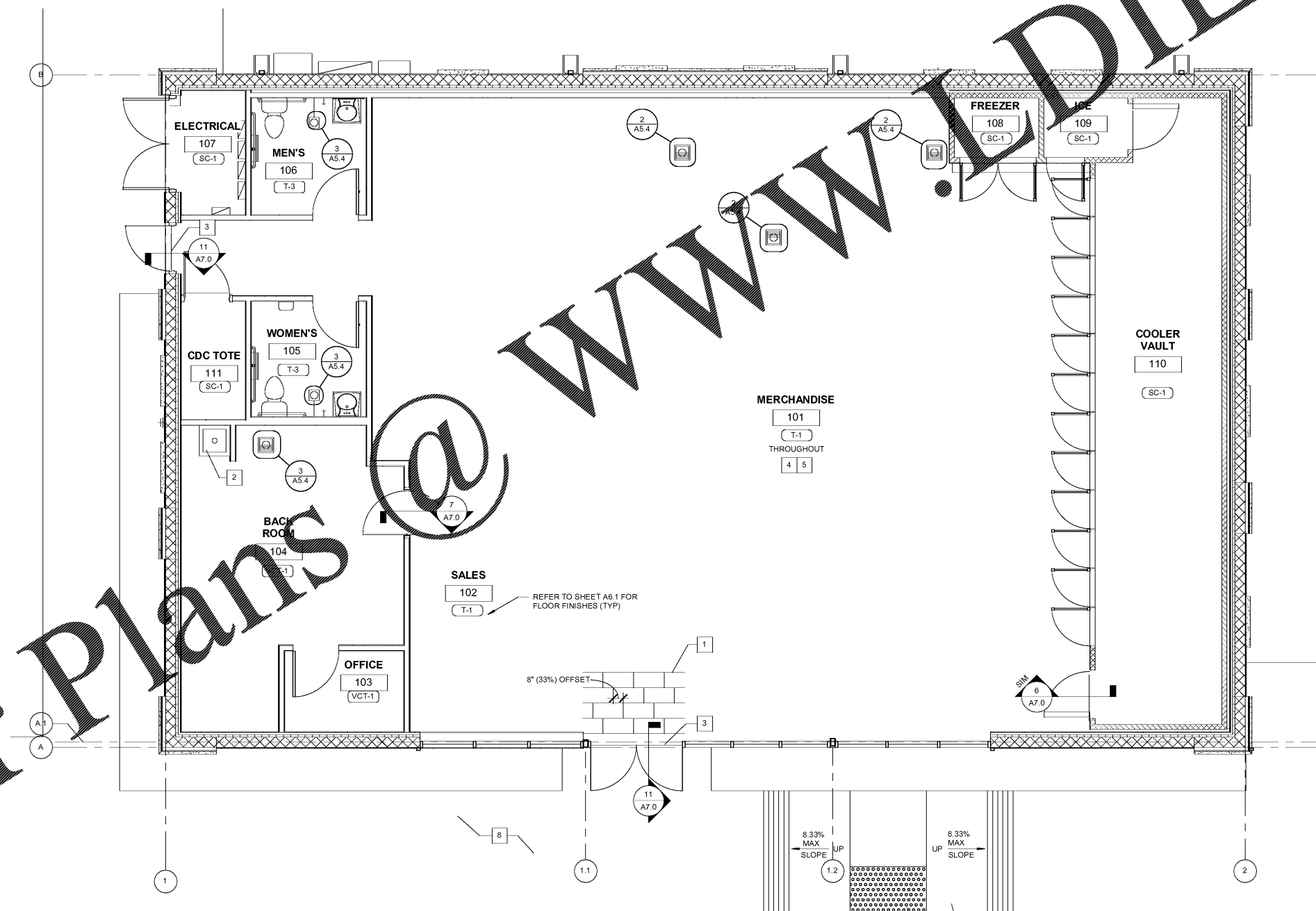

1 FLOOR FINISH PLAN
A5.4 1/4" = 1'-0"

bates

106 N 37TH STREET, SUITE C
ROGERS, ARKANSAS 72756
WWW.BATESINSPECTS.COM
TEL: 479.633.8888

Florida Certified Authority #12366

CONSTRUCTION MANAGER
CREIGHTON CONSTRUCTION & MANAGEMENT, LLC
900 SW PINE ISLAND ROAD, SUITE 202
CAPE CORAL, FL 33991

TENANT
7-ELEVEN INC.
3200 HACKBERRY ROAD
IRVING, TX 75063

STRUCTURAL CONSULTANT
SELECT STRUCTURAL
12573 NEW BRITANNY BLVD FORT MYERS, FL 33907

PROTO:08-21-2017

7-ELEVEN STORE
SW CO CARROLL ST. & DYER BLVD.
KISSIMMEE, FL 34741

CREIGHTON CONSTRUCTION & MANAGEMENT, LLC
900 SW PINE ISLAND ROAD, SUITE 202
CAPE CORAL, FL 33991

12/19/2017
Architect Name - RYAN M FAUST
Architect Number - AR97905

THE SEAL AND SIGNATURE APPLY ONLY TO THE DOCUMENT TO WHICH THEY ARE APPLIED AND WE WILL NOT ASSUME ANY RESPONSIBILITY FOR ALL OTHER PLANS, SPECIFICATIONS, ESTIMATES, REPORTS OR OTHER DOCUMENTS OR INSTRUMENTS RELATING TO OR INTENDED TO BE USED FOR ANY PART OF THE PROJECT.

REVISIONS	
NO.	DESCRIPTION

PROJECT NUMBER: 17111
RELEASE DATE: 12/19/2017

FINISH FLOOR PLAN

A5.4