

OCCUPANCY SIGNAGE NOTES
SIGNS STATING THE MAXIMUM OCCUPANT CONTENT SHALL BE CONSPICUOUSLY POSTED IN EACH AREA OF ASSEMBLY, ASSEMBLY ROOM, OR ROOM USED FOR SIMILAR PURPOSE.

LEGEND

- EGRESS PATH DIRECTION & WIDTH (INCHES)
- EXIT DIRECTION
- FIRE RATED WALL PARTITION (WHERE REQUIRED)

OCCUPANCY LOAD

ROOM NO.	USE	USE CLASS	SIZE SQFT	SQFT/PERSON	PERSONS
101	MERCHANDISE	M	1629.61 SF	30.00 SF	55
102	SALES	B	298.96 SF	30.00 SF	10
103	OFFICE	B	41.15 SF	100.00 SF	1
104	BACK ROOM	M	237.73 SF	300.00 SF	1
105	WOMEN'S	M		PLUMBING FIXTURE COUNT, SHEET A1.5	
106	MEN'S	M		PLUMBING FIXTURE COUNT, SHEET A1.5	
107	ELECTRICAL	M	34.40 SF	300.00 SF	1
108	FREEZER	M	21.49 SF	0.00 SF	
109	ICE	M	21.43 SF	0.00 SF	
110	COOLER VAULT	M	329.42 SF	300.00 SF	2
111	CDC TOTE	M	32.32 SF	300.00 SF	1
					71

BUILDING CODES

BUILDING CODE:	2010 FLORIDA BUILDING CODE 5TH EDITION
ELECTRICAL CODE:	2011 NATIONAL ELECTRICAL CODE
MECHANICAL CODE:	2010 FLORIDA MECHANICAL CODE 5TH EDITION
PLUMBING CODE:	2010 FLORIDA PLUMBING CODE 5TH EDITION
FIRE CODE:	2010 FLORIDA FIRE PREVENTION CODE 5TH EDITION
ACCESSIBILITY CODE:	2012 FLORIDA BUILDING CODE ACCESSIBILITY 5TH EDITION
ENERGY CODE:	2010 FLORIDA ENERGY CODE

RESTROOM PLUMBING FIXTURES

BUILDING OCCUPANCY CALCULATION = 71
1 PER 500 MALE AND FEMALE = 71/500 = .142 = 1 FIXTURE REQUIRED

REQUIRED	PROVIDED
W.C. (1:500) 1	W.C. (1:500) 2
URINAL 0	URINAL 0
LAVATORY 1	LAVATORY 2

EGRESS DISTANCES

Exit Path	Exit Path Distance
A	109'
B	58'
C	63'
D	4'

OCCUPANCY USE GROUP
MERCANTILE, GROUP M

BUILDING CONSTRUCTION TYPE & FIRE PROTECTION
TYPE: VB - NOT SPRINKLERED

EXITING REQUIREMENTS
7.5.1.3.3 OF NFPA 101 LIFE SAFETY CODE
MERCANTILE AREA: 2 EXITS
DIAGONAL OF MERCANTILE AREA = 80'-4"
DISTANCE OF MAX. OVERALL DIAGONAL W/O AUTOMATIC SPRINKLER SYSTEM = 80'-4" 1/2" / 2 = 40'-2" 1/4" MIN REQUIRED
DISTANCE BETWEEN EXIT DOORS = 4'-1 1/2" PROVIDED
ELECTRICAL ROOM: 1 EXIT
*REFER TO SHEET A2.3 FOR ILLUMINATED EXIT SIGN LOCATIONS.

EGRESS CAPACITY

MAIN ENTRY DOOR WIDTH	= 68" / 0.2" = 340 PERSONS
SECONDARY DOOR WIDTH	= 34" / 0.2" = 170 PERSONS
ELECTRICAL DOOR WIDTH	= 68" / 0.2" = 340 PERSONS

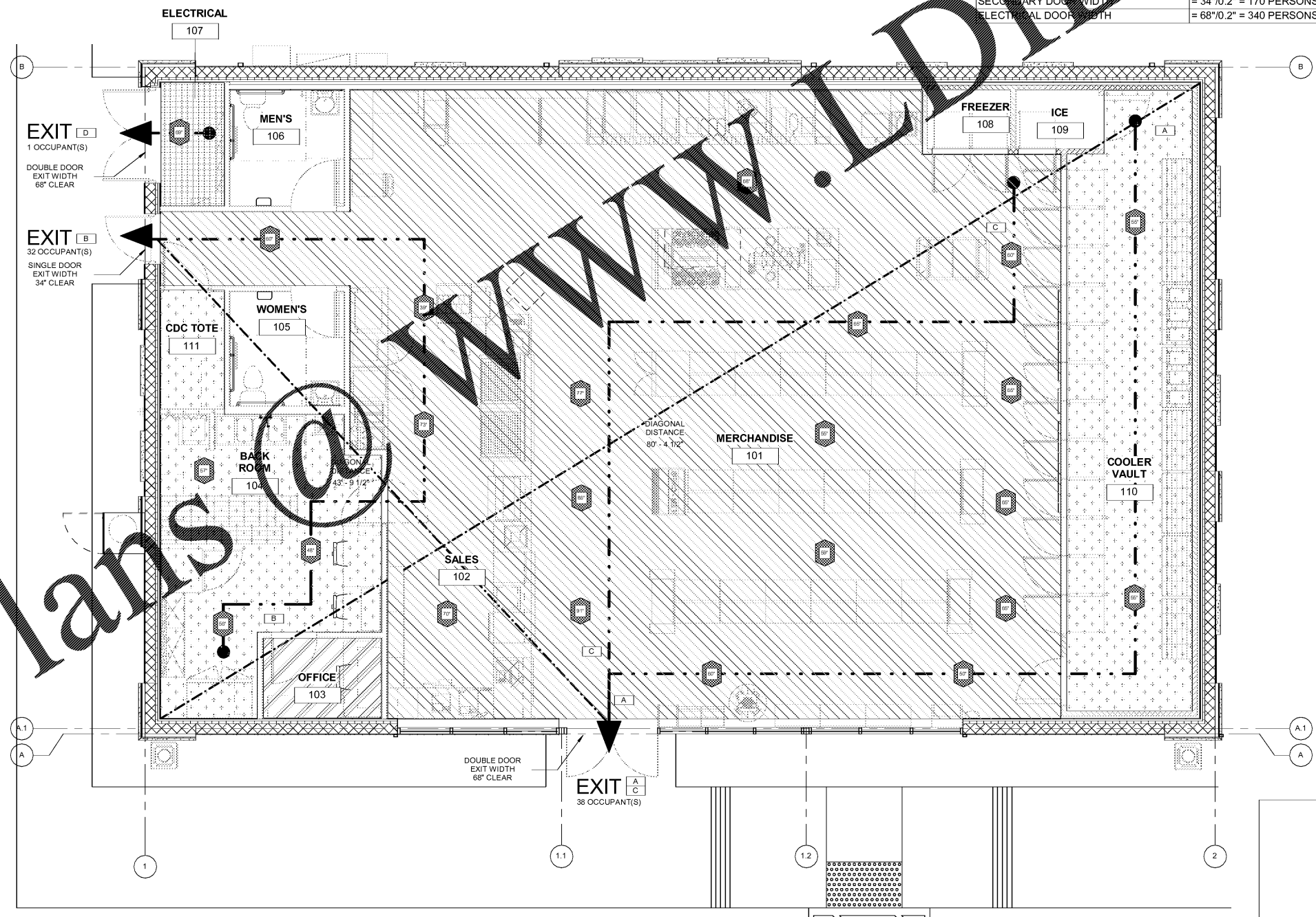

1
A1.5
EGRESS PLAN
1/4" = 1'-0"

bates
106 N 37TH STREET, SUITE C
ROGERS, ARKANSAS 72756
WWW.BATESINSPECTORS.COM
TEL: 479.633.1111

Florida Certified Authority #12366
Bates Inspectors & Associates, Inc.
Bates Inspectors & Associates, Inc. is an equal opportunity employer. All applicants should be aware that only those applicants who are qualified by education, experience and training will be considered for employment. Bates Inspectors & Associates, Inc. is not responsible for construction means, methods, materials, equipment or procedures, or for safety precautions and other matters in connection with the project.

STORE #:
38227

CONSTRUCTION MANAGER
CREIGHTON CONSTRUCTION & MANAGEMENT, LLC
900 SW PINE ISLAND ROAD, SUITE 202
CAPE CORAL, FL 33991

TENANT
7-ELEVEN INC.
3200 HACKBERRY ROAD
IRVING, TX 75063

STRUCTURAL CONSULTANT
SELECT STRUCTURAL
12573 NEW BRITANNY BLVD FORT MYERS, FL 33907

PROTO:08-21-2017

7-ELEVEN STORE
SW CO CARROLL ST. & DYER BLVD.
KISSIMMEE, FL 34741

CREIGHTON CONSTRUCTION & MANAGEMENT, LLC
900 SW PINE ISLAND ROAD, SUITE 202
CAPE CORAL, FL 33991

12/19/2017

Architect Name - RYAN M FAUST
Architect Number - AR97905

THE SEAL AND SIGNATURE APPLY ONLY TO THE DOCUMENT TO WHICH THEY ARE APPLIED AND WE EXPRESSLY DISCLAIM ANY RESPONSIBILITY FOR ALL OTHER PLANS, SPECIFICATIONS, ESTIMATES, REPORTS OR OTHER DOCUMENTS OR INSTRUMENTS RELATING TO OR INTENDED TO BE USED FOR ANY PART OF THE PROJECT.

REVISIONS	
NO.	DESCRIPTION

PROJECT NUMBER: 17111
RELEASE DATE: 12/19/2017

EGRESS PLAN

A1.5