

GENERAL CONSTRUCTION NOTES

- DO NOT SCALE OFF DRAWINGS.
- GENERAL CONTRACTOR SHALL FIELD VERIFY ALL DIMENSIONS, ALIGNMENTS, AND CENTERLINE NOTATIONS. ANY CONFLICT WITH FIELD CONDITIONS, DRAWINGS AND/OR TRADES SHALL BE REPORTED TO THE DESIGNER IMMEDIATELY UPON DISCOVERY FOR CLARIFICATION PRIOR TO PROCEEDING WITH ASSOCIATED WORK.
- GENERAL CONTRACTOR SHALL VISIT THE JOB SITE AND NOTIFY THE DESIGNER OR LANDLORD OF ANY PHYSICAL CONDITIONS NOT INDICATED IN THE CONSTRUCTION DOCUMENTS THAT WOULD REQUIRE CORRECTIVE ACTION PRIOR TO SUBMITTING A BID.
- ALL DIMENSIONS ARE TO FACE OF FINISH U.N.O.
- PARTITION FLOOR TRACK METAL STUD SYSTEM SHALL BE BUTT JOINTED TO ENSURE STRUCTURAL STABILITY. PROVIDE BLOCKING PER AWHI CUSTOM GRADE STANDARDS IN PARTITIONS AT ALL LOCATIONS WHERE MILLWORK OR MISC. ITEMS ARE SUPPORTED BY PARTITION.
- ALL EXISTING EXTERIOR CMU WALLS TO RECEIVE FOAMED IN PLACE INSULATION IN ALL CAVITIES (R-14.2).
- INSULATING MATERIALS WHEN INSTALLED IN BUILDINGS OF ANY TYPE CONSTRUCTION SHALL COMPLY WITH THE LOCAL JURISDICTION & CODE. INSULATING MATERIALS WHEN EXPOSED AS INSTALLED IN BUILDINGS OF ANY TYPE CONSTRUCTION, SHALL HAVE A FLAME SPREAD OF NOT MORE THAN 25 AND A SMOKE-DEVELOPED INDEX OF NOT MORE THAN 450 (AS PER CODE).
- UPON COMPLETION OF THE PROJECT THE CONTRACTOR SHALL CLEAN THE WORK SITE. DUST, DEBRIS, OILS, STAINS, FINGERPRINTS, AND LABELS (EXCEPT FOR THOSE THAT SHALL BE REMOVED FROM ALL EXPOSED SURFACES)



REV #	DATE	DESCRIPTION

**REFORMATION BREWERY**  
 105 ELBA STREET  
 WOODSTOCK, GEORGIA 30188  
**REFORMATION BREWERY**

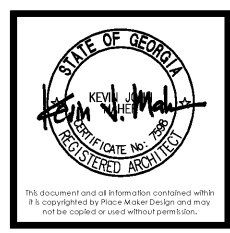

**PLACE MAKER DESIGN**  
 1000 CIRCLE 75 PARKWAY  
 SUITE 400  
 ATLANTA, GEORGIA 30339  
 404.549.4499

ISSUE DATE	01/05/2018
DRAWN BY	B.K. / T.H.
CHECKED BY	T.M.V.
PWD PROJ #	17072

**FLOOR PLAN**  
 SHEET # **A1.1**

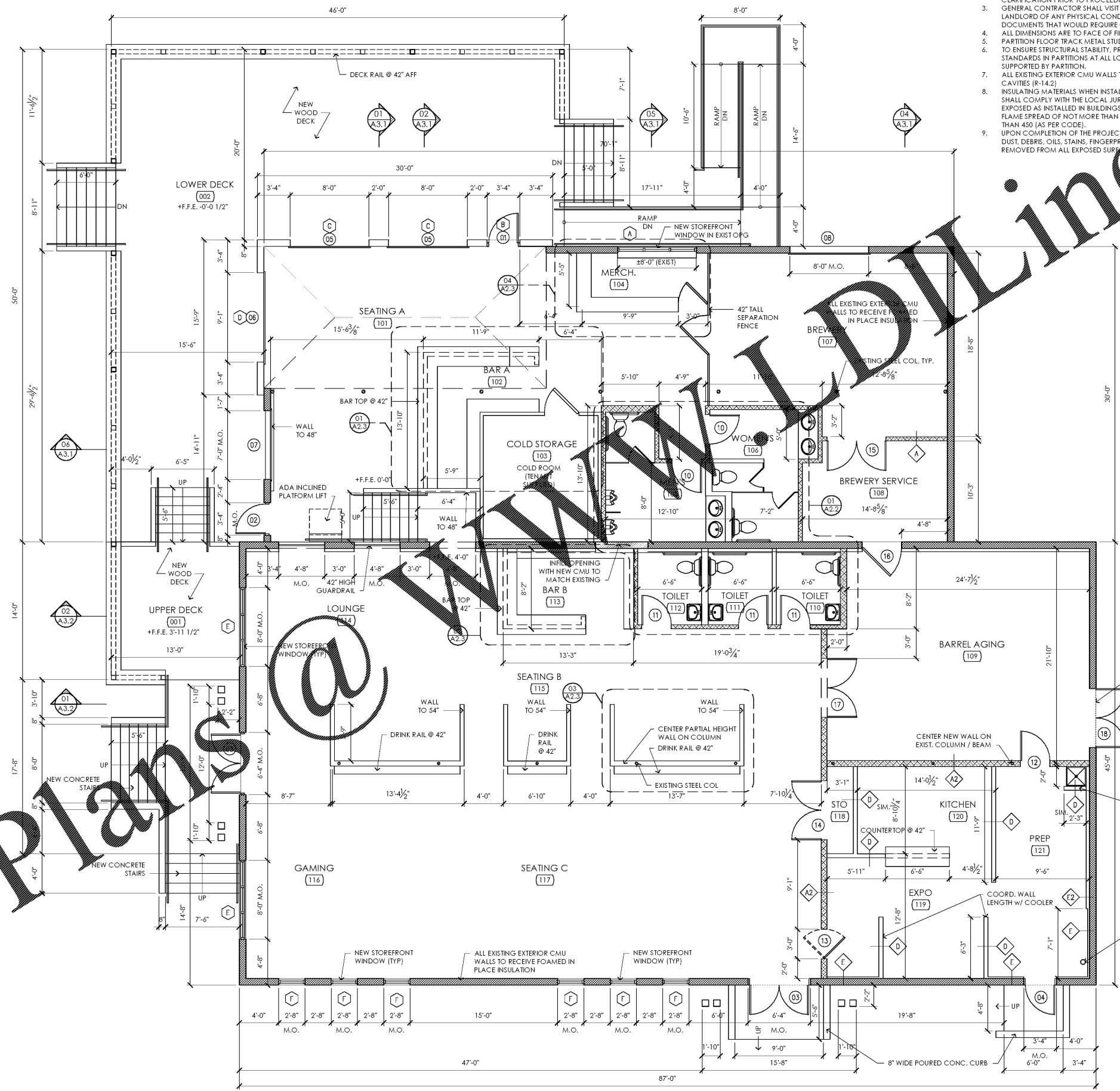

- CONTINUE WALL TO UNDERSIDE OF ROOF SHEATHING
- A - 2x4 STUDS @ 16" O.C., TYP.
- A2 - 2x6 STUDS @ 16" O.C., TYP.
- 1 LAYER 5/8" GYP. BOARD\* EA SIDE - FULL HEIGHT (OR TO UNDERSIDE OF GYP. BD. CLG)
- A2 A FULL HEIGHT PARTITION WALL**
- BRACING TO STRUCTURE 4'-0" O.C. (MAX.) AND WITHIN 2'-0" OF ALL CORNERS
- GYP. BOARD\* CEILING @ 8'-8" A.F.F.
- B - 2x4 STUDS @ 16" O.C., TYP.
- B2 - 2x6 STUDS @ 16" O.C., TYP.
- 1 LAYER 5/8" GYP. BOARD\* EA SIDE TO UNDERSIDE OF CEILING
- B2 B INTERIOR PARTITION WALL**
- EXIST. ROOF TRUSS FRAMING
- MR GYP. BOARD\* CEILING @ 8'-8" A.F.F.
- 1 LAYER 5/8" MR GYP BOARD\* TO UNDERSIDE OF CEILING
- 2x4 STUDS @ 16" O.C., TYP.
- 1/2" THK. FURRING, TYP.
- EXISTING CMU WALL (BASE COURSES 4" WIDER)
- C INTERIOR FURRING**
- BRACING TO STRUCTURE 4'-0" O.C. (MAX.) AND WITHIN 2'-0" OF ALL CORNERS
- ACT CEILING; REFER TO RCP
- 2x4 STUDS @ 16" O.C., TYP.
- 1 LAYER 5/8" GYP BOARD\* EA SIDE TO MIN. 6" ABOVE CEILING
- PROVIDE FRP FULL HEIGHT BOTH SIDES OF WALL IN KITCHEN AREAS & STAINLESS STEEL BEHIND COOKLINE, TYPICAL
- D INTERIOR PARTITION WALL - KITCHEN**
- EXIST. ROOF TRUSS FRAMING
- ACT CEILING; REFER TO RCP
- E2 - 2x4 FURRING @ 16" O.C., TYP.
- E2 - 2x4 STUDS @ 16" O.C., TYP.
- 1 LAYER 5/8" MR GYP BOARD\* EA SIDE TO UNDERSIDE OF ROOF TRUSS FRAMING; PROVIDE FRP FULL HEIGHT
- EXISTING CMU WALL
- E2 E INTERIOR FURRING - KITCHEN**
- PROVIDE MR GYPSUM BOARD AT ALL BATHROOM AND INTERIOR AREAS AND ON ALL WET WALLS
- 02 WALL TYPE LEGEND**
- A1.1 NOT TO SCALE

**01 FLOOR PLAN**  
 A1.1 3/16" = 1'-0"