

**DEMOLITION SCOPE**

1. SITE SPECIFIC DEMOLITION FOR THIS STRUCTURE SHALL COVER:
  - A. ALL EXISTING DOORS, FRAMES, MILLWORK, ETC. UNLESS NOTED OTHERWISE.
  - B. COMPLETE REMOVAL OF ALL FINISHES ON INTERIOR SIDE OF EXTERIOR WALLS DOWN TO EXISTING MASONRY STRUCTURE UNLESS NOTED OTHERWISE.
  - C. ALL DOORS TO BE FULLY REMOVED BACK TO EXISTING MASONRY OPENING.
  - D. ALL ELECTRICAL EQUIPMENT, DEVICES AND WIRING TO BE REMOVED BACK TO EXISTING UTILITY POLE - SEE ELECTRICAL DRAWINGS FOR NEW FEED.
  - E. COMPLETELY REMOVE ALL EXISTING AND FORMER UTILITY CONNECTIONS, PIPING, AND DEVICES FROM EXISTING BUILDING, INCLUDING, BUT NOT LIMITED TO GAS PIPING, HVAC CONDENSATE LINES, ELECTRICAL CONDUITS AND WEATHER HEADS.
  - F. COMPLETELY REMOVE EXISTING HVAC SYSTEMS AND DUCTING.
  - G. REMOVE EXISTING CONCRETE RAMP ON INTERIOR.
  - H. REMOVE EXISTING RAISED CONCRETE DOCK AREA ON EXTERIOR.
2. CLEAN UP
  - A. REMOVE DEMOLISHED MATERIALS FROM SITE AS WORK PROGRESSES.
  - B. COORDINATE DUMPSTER REQUIREMENTS AND LOCATIONS WITH LOCAL JURISDICTION.
  - C. STRUCTURE IS TO BE LEFT IN BROOM FINISH CONDITION AT COMPLETION OF DEMOLITION ACTIVITIES.
3. SALVAGING
  - A. CONTRACTOR IS TO SALVAGE ANY ITEMS AND MATERIALS THAT COULD BE CONSIDERED HISTORICAL OR USED ECONOMICALLY FOR THE BENEFIT OF THE OWNER. ALL EXISTING MATERIALS ARE TO BE CONSIDERED PROPERTY OF THE OWNER AND ARE TO BE STORED, DISCARDED, OR DONATED AS DIRECTED BY THE OWNER.

**GENERAL DEMOLITION NOTES**

1. GENERAL CONTRACTOR SHALL VERIFY EXISTING CONDITIONS AND NOTIFY DESIGNER OF ANY DISCREPANCIES PRIOR TO COMMENCING DEMOLITION.
2. GENERAL CONTRACTOR IS RESPONSIBLE FOR ANY DAMAGE TO FINISHES OR COMPONENTS NOT SCHEDULED FOR DEMOLITION. CONTRACTOR SHALL REPLACE ANY DAMAGED ITEMS OR REPAIR TO MEET OR EXCEED FORMER CONDITIONS.
3. GENERAL CONTRACTOR RESPONSIBLE FOR SHORING EXISTING MASONRY WALLS DURING DEMOLITION / RECONSTRUCTION.
4. ASBESTOS ABATEMENT IS SPECIFICALLY EXCLUDED.

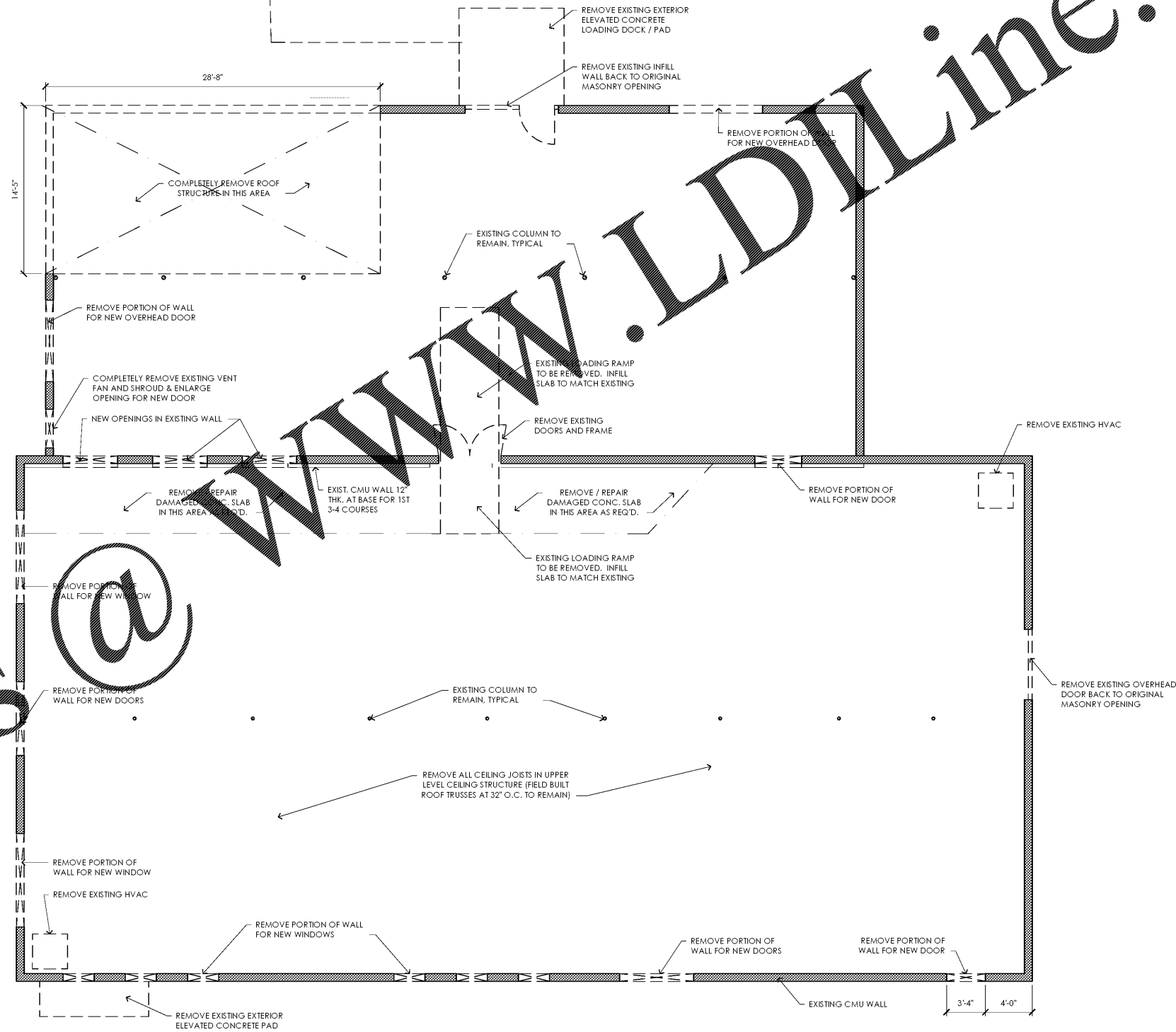

Order Plans @

WWW.LDILine.com



| REV # | DATE | DESCRIPTION |
|-------|------|-------------|
|       |      |             |
|       |      |             |
|       |      |             |
|       |      |             |
|       |      |             |

**REFORMATION BREWERY**  
 105 ELAM STREET  
 WOODSTOCK, GEORGIA 30188  
**REFORMATION BREWERY**

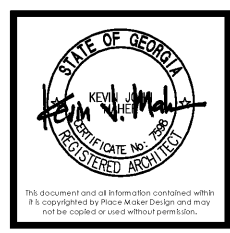

**PLACE MAKER DESIGN**  
 1000 CIRCLE 75 PARKWAY  
 SUITE 400  
 ATLANTA, GEORGIA 30339  
 404.549.4499

|            |            |
|------------|------------|
| ISSUE DATE | 01/05/2018 |
| DRAWN BY   | BJK / TJH  |
| CHECKED BY | TMV        |
| PWD PROJ # | 17072      |

SHEET TITLE

**DEMOLITION PLAN**

**A1.0**

01 DEMOLITION PLAN  
 A1.0 3/16" = 1'-0"