

This information is intended for the use of the professional engineer or architect. It is not to be used for any other purpose. The user hereby represents and warrants that it will be used in accordance with the intended purpose of the information.

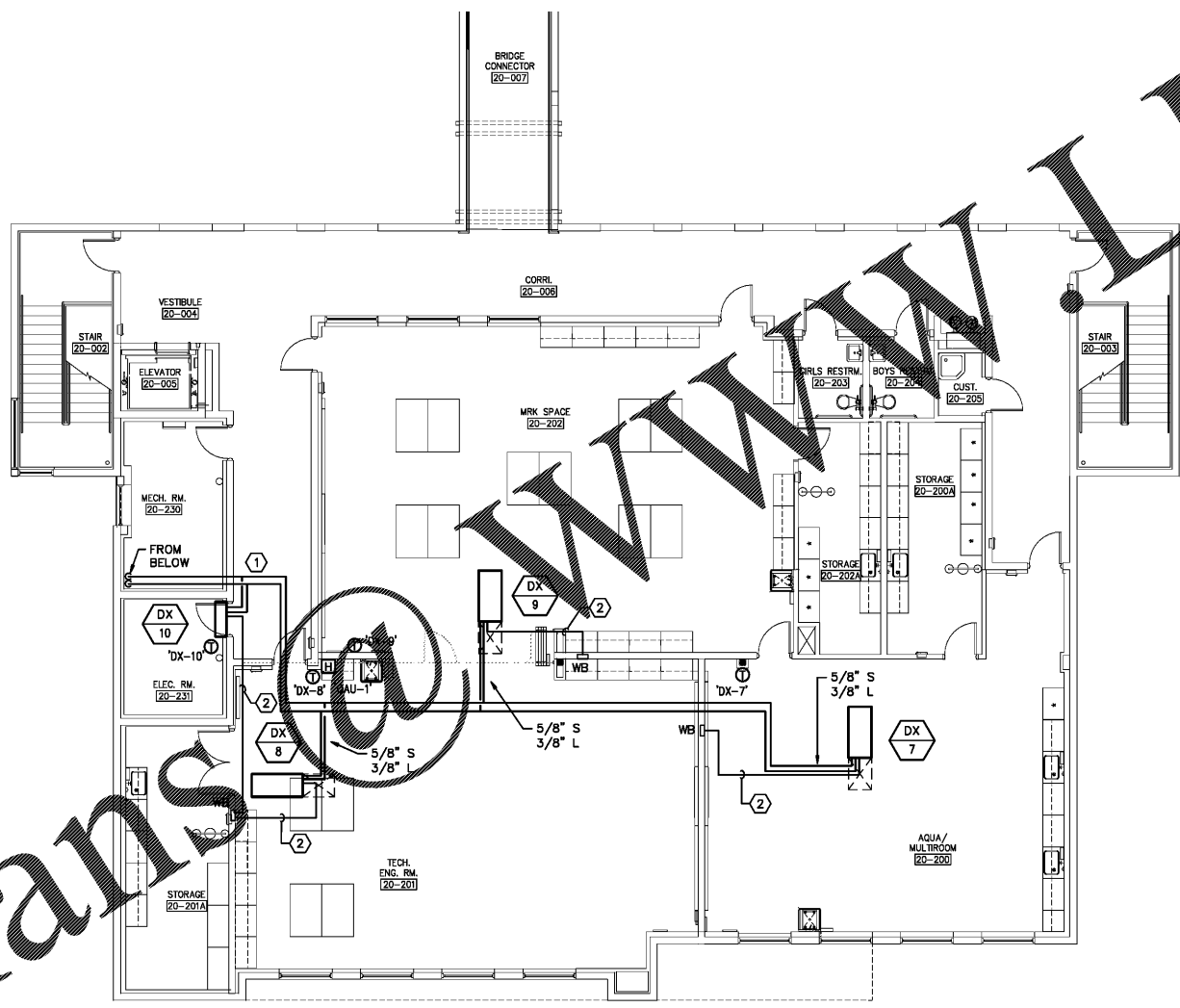

GENERAL NOTES

- REFRIGERANT PIPE ROUTING IS SCHEMATIC IN NATURE AND DOES NOT INDICATE EVERY ELBOW OR OFFSET REQUIRED TO COORDINATE WITH ABOVE CEILING ELEMENTS. LINE SIZES SHOWN MAY VARY BASED ON EQUIPMENT FURNISHED. COORDINATE LINE SIZES AND REQUIRED ACCESSORIES ALONG WITH LENGTH LIMITATIONS WITH EQUIPMENT MANUFACTURER.
- ALL EXTERIOR PIPING SHALL BE INSULATED AND COATED WITH TWO COATS OF UV INHIBITOR PAINT.
- SUPPORT ALL ABOVE CEILING REFRIGERANT LINE SETS WITH UNI-STRUT FROM STRUCTURE. SEE DETAIL. MAXIMUM SPACING SHALL BE 5'-0" ON CENTER.
- LINE SET SIZES SHOWN ARE FOR BIDDING PURPOSES ONLY. COORDINATE FINAL LINE SIZES WITH MANUFACTURER OF FURNISHED EQUIPMENT.

PLAN NOTES

- ROUTE REFRIGERANT LINE SET UP FROM FIRST FLOOR TO ASSOCIATED EVAPORATORS TO CLEAR ABOVE CEILING ELEMENTS.
- ROUTE INSULATED FULL SIZE COPPER CONDENSATE LINE WITH P-TRAP SLOPED TO CONDENSATE WALL BOX (WB) AS SHOWN. COORDINATE WALL BOX LOCATION WITH PLUMBING.

NOTE: CONTRACTOR SHALL SUBMIT AN ALTERNATE COST IN A SEPARATE LINE ITEM FOR A HEAT RECOVERY VRV SYSTEM WITH ONE BRANCH SELECTOR PER CONDENSING UNIT SIZED FOR EVAPORATORS SERVED IN BASE BID. VERIFY CONDENSING UNIT MODEL NUMBERS WITH MANUFACTURER.

1 2ND FLOOR MECHANICAL PIPING PLAN
M1.4 SCALE: 1/8"=1'-0"

J L R D
JOHNSON, LEVINSON, RAGAN, DAVILA, INC.
1450 Centrepark Boulevard, Suite 350
West Palm Beach, Florida 33401
(561) 689-2303 (561) 689-2302 Fax
www.jlr.com
Certification Number 6059
Michael P. Landen, P.E. 30594
Charles C. Chubberson, P.E. 31936

**STEM BUILDING
THE BENJAMIN SCHOOL - LOWER/MIDDLE SCHOOL**
11000 Ellison Wilson Road, North Palm Beach, FL 33408
CONSTRUCTION DOCUMENTS

Comm. No: 16117.00
Job No: 117030
Date: 10-23-17
Drawn: WLM

Revisions		
No.	Date	Note

TO THE BEST OF MY KNOWLEDGE, THE PLANS AND SPECIFICATIONS COMPLY WITH THE MINIMUM BUILDING CODES.