

This information is intended to be used for informational purposes only and is not to be construed as a contract. The user hereby represents and warrants that it will be used for informational purposes only and will not be used for any other purpose. The user hereby represents and warrants that it will be used for informational purposes only and will not be used for any other purpose.

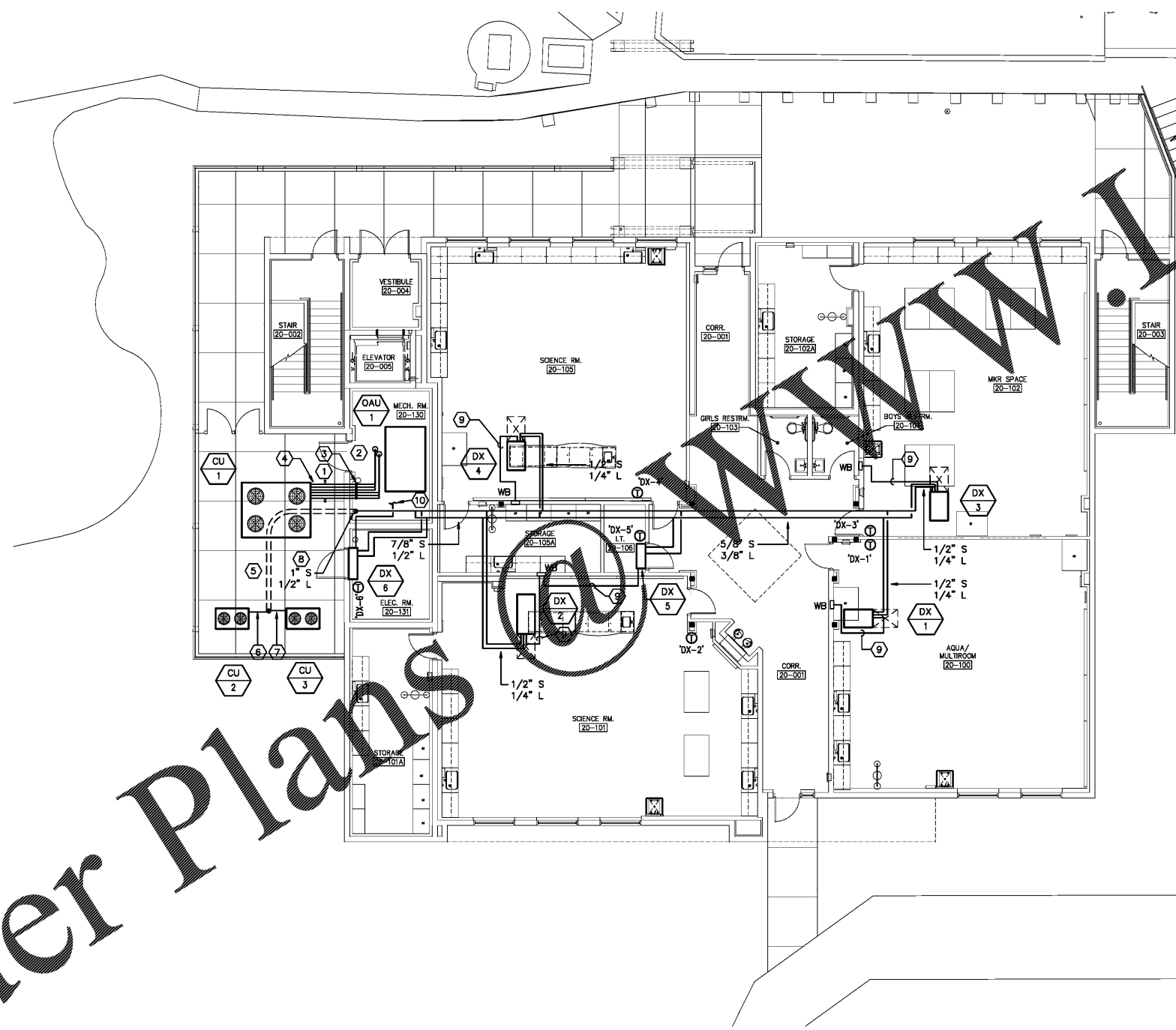

1 1ST FLOOR MECHANICAL PIPING PLAN
M1.3

SCALE: 1/8"=1'-0"

GENERAL NOTES

1. REFRIGERANT PIPE ROUTING IS SCHEMATIC IN NATURE AND DOES NOT INDICATE EVERY ELBOW OR OFFSET REQUIRED TO COORDINATE WITH ABOVE CEILING ELEMENTS. LINE SIZES SHOWN MAY VARY BASED ON EQUIPMENT FURNISHED. COORDINATE LINE SIZES AND REQUIRED ACCESSORIES ALONG WITH LENGTH LIMITATIONS WITH EQUIPMENT MANUFACTURER.
2. ALL EXTERIOR PIPING SHALL BE INSULATED AND COATED WITH TWO COATS OF UV INHIBITOR PAINT.
3. SUPPORT ALL ABOVE CEILING REFRIGERANT LINE SETS WITH UNI-STRUT FROM STRUCTURE. SEE DETAIL. MAXIMUM SPACING SHALL BE 5'-0" ON CENTER.
4. LINE SET SIZES SHOWN ARE FOR BIDDING PURPOSES ONLY. COORDINATE FINAL LINE SIZES WITH MANUFACTURER OF FURNISHED EQUIPMENT.

PLAN NOTES

- 1 PROVIDE UNI-STRUT PIPE SUPPORT WITH PIPE SHIELD ON INSULATED REFRIGERANT.
- 2 ROUTE REFRIGERANT LINE SETS AS HIGH AS POSSIBLE SUPPORTED FROM STRUCTURE ON UNI-STRUT WITH THREADED RODS TO COIL CONNECTS AS REQUIRED.
- 3 PROVIDE OPENING IN WALL TO ACCEPT ALL REQUIRED REFRIGERANT LINE SETS AND CONTROL WIRING. SEAL BUILDING OPENINGS WATERTIGHT.
- 4 PROVIDE 1 5/8" SUCTION, 7/8" LIQUID, +7/8" HOT GAS BYPASS LINE SET FOR EACH REFRIGERANT CIRCUIT. CONFIRM LINE SIZE AND LENGTH LIMITATIONS WITH ACTUAL EQUIPMENT FURNISHED.
- 5 REFRIGERANT PIPE SLEEVE ROUTED BELOW GRADE FROM MECHANICAL ROOM TO ASSOCIATED CONDENSING UNITS. PIPE SLEEVE SHALL BE SIZE TO ACCEPT REFRIGERANT SETS AND INSULATION. LONG SWEEP PIPE SLEEVE ELBOWS SHALL BE USED. SEAL OPENINGS OF SLEEVE ABOVE GRADE WATERTIGHT.
- 6 PROVIDE 7/8" SUCTION, 1/2" LIQUID INSULATED LINE SET FROM CONDENSING UNIT AND PIPE SLEEVE TO BUILDING INTERIOR.
- 7 PROVIDE 1" SUCTION, 1/2" LIQUID INSULATED LINE SET FROM CONDENSING UNIT AND PIPE SLEEVE TO BUILDING INTERIOR.
- 8 ROUTE 1" SUCTION, 1/2" LIQUID LINE SET UP TO SERVE EVAPORATORS ON SECOND FLOOR. SEAL FLOOR PENETRATION WATERTIGHT.
- 9 ROUTE INSULATED FULL SIZE COPPER CONDENSATE LINE WITH P-TRAP SLOPED TO CONDENSATE WALL BOX (WB) AS SHOWN. COORDINATE WALL BOX LOCATION WITH PLUMBING.
- 10 FULL SIZE INSULATED COPPER DRAINLINE TO HUBRAIN LOCATED IN MECH ROOM. SEE LARGE SCALE PLAN FOR LOCATION. COORDINATE LOCATION WITH PLUMBING DRAWINGS.

NOTE: CONTRACTOR SHALL SUBMIT AN ALTERNATE COST IN A SEPARATE LINE ITEM FOR A HEAT RECOVERY WRV SYSTEM WITH ONE BRANCH SELECTOR PER CONDENSING UNIT SIZED FOR EVAPORATORS SERVED IN BASE BID. VERIFY CONDENSING UNIT MODEL NUMBERS WITH MANUFACTURER.

Contract No:	16117.00
Job No:	117030
Date:	10-23-17
Drawn:	WLM

Revisions		
No.	Date	Note

TO THE BEST OF MY KNOWLEDGE, THE PLANS AND SPECIFICATIONS COMPLY WITH THE MINIMUM BUILDING CODES.