

P:\1817\_00\_Bangham Lower School New STEM Building\18 Project Development\14 Drawings\Sheet\20-001A1.2.dwg, 10/27/2017 3:52:54 PM, DWG, 10-01-17.rvt

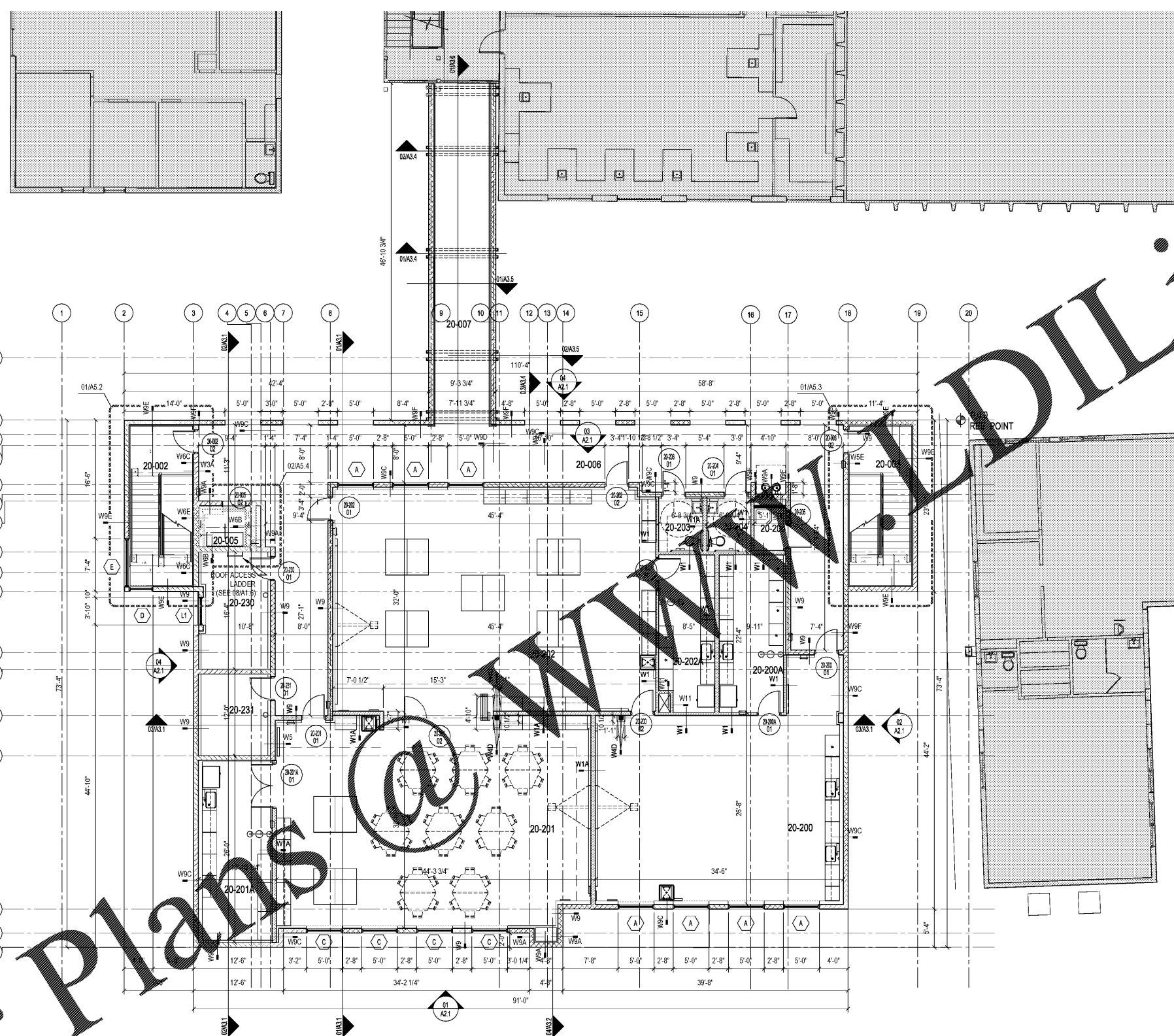

01 2ND FLOOR PLAN  
SCALE: 1/8" = 1'-0" TRUE NORTH

BUILDING NO. 20 - FIRST FLOOR		
ROOM #	ROOM NAME	SF
20-001	CORRIDOR	695
20-002	STAIR	175
20-003	STAIR	175
20-004	VESTIBULE	62
20-005	ELEVATOR	42
20-100	AQUA/MULTIROOM LAB	927
20-101	SCIENCE ROOM LAB	1,048
20-101A	STORAGE	232
20-102	MKR SPACE LAB	92
20-102A	STORAGE	22
20-103	GIRLS RESTROOM	41
20-104	BOYS RESTROOM	41
20-105	SCIENCE ROOM LAB	927
20-105A	STORAGE	232
20-106	IT	4
20-130	MECHANICAL	153
20-131	ELECTRICAL	103

BUILDING NO. 20 - SECOND FLOOR		
ROOM #	ROOM NAME	SF
20-002	STAIR	192
20-003	STAIR	192
20-005	ELEVATOR	42
20-006	CORRIDOR	1,189
20-007	EDGE CONNECTOR	380
20-008	AQUA/MULTIROOM LAB	844
20-009	STORAGE	190
20-010	TEACHERS ROOM LAB	1,259
20-201A	STORAGE	251
20-202	MKR SPACE LAB	1,379
20-202A	STORAGE	178
20-203	GIRLS RESTROOM	49
20-204	BOYS RESTROOM	49
20-205	CUSTODIAL	24
20-230	MECHANICAL	143
20-231	ELECTRICAL	103

HARVARD JOLLY ARCHITECTURE  
2047 VISTA PARKWAY, SUITE 100 | WEST PALM BEACH, FL 33411 | www.harvardjolly.com | 561-475-4457 | AAC000119

STEM BUILDING  
THE BENJAMIN SCHOOL - LOWER/MIDDLE SCHOOL  
11000 Ellison Wilson Road, North Palm Beach, FL 33408  
CONSTRUCTION DOCUMENTS

Comm. No: 16117.00  
Date: 10-23-17

Drawn: ms

Revisions		
No.	Date	Note

TO THE BEST OF MY KNOWLEDGE, THE PLANS AND SPECIFICATIONS COMPLY WITH THE MINIMUM BUILDING CODES.

RENÉ TERCILLA AIA, REFP  
© 2017 HARVARD JOLLY, INC.

FLOOR PLAN

A1.2