

P:\1817_00_Benjamin Lower School New STEM Building\01 Project Development\14 Drawings\Sheet\A1.02.dwg, 10/27/2017 11:59:24 AM, DWG3 T:PDF.ppt

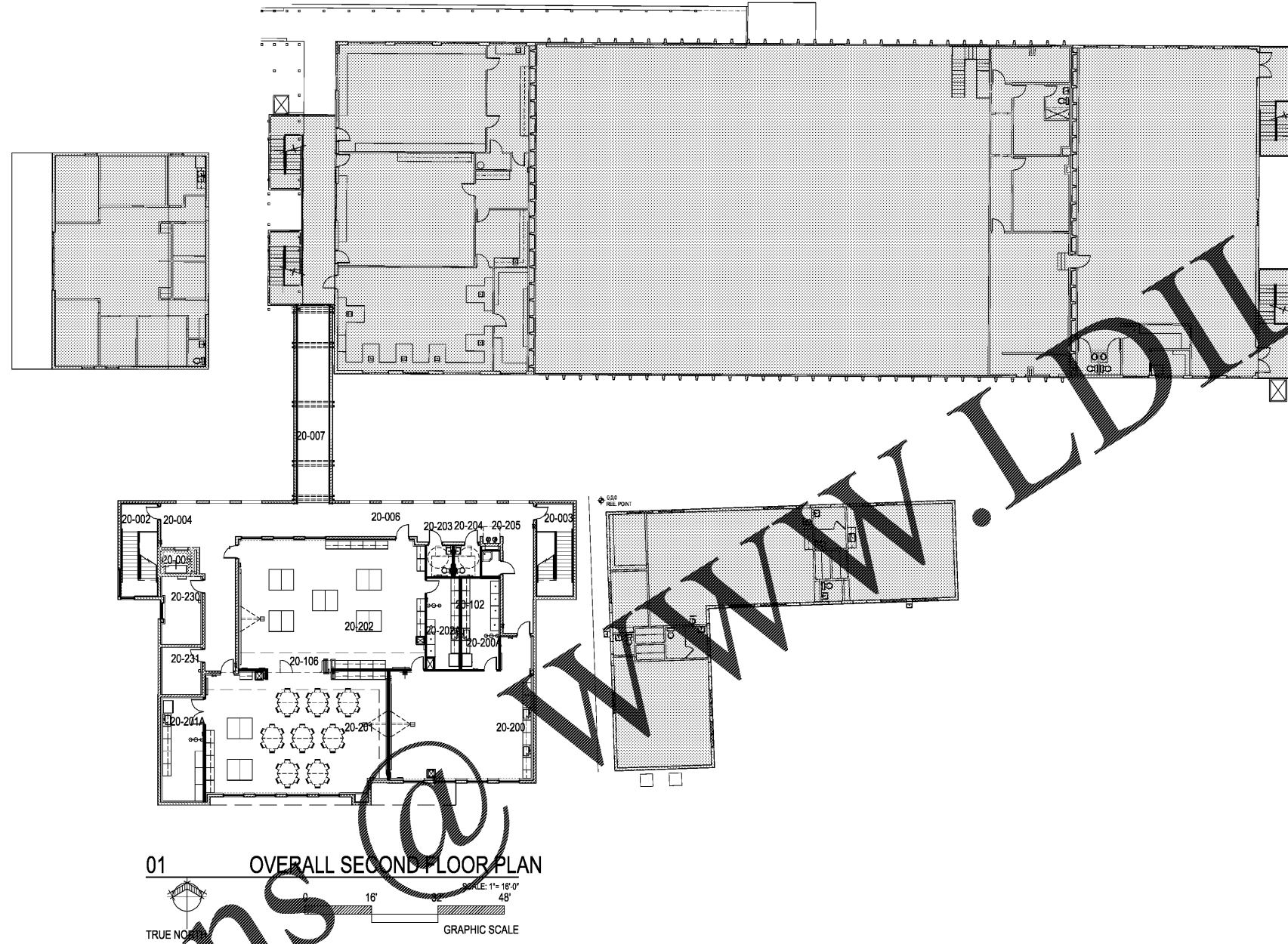

BUILDING NO. 20 - FIRST FLOOR		
ROOM #	ROOM NAME	SF
20-001	CORRIDOR	896
20-002	STAIR	175
20-003	STAIR	175
20-004	VESTIBULE	62
20-005	ELEVATOR	42
20-100	AQUA/MULTI-ROOM LAB	927
20-101	SCIENCE ROOM LAB	1,040
20-101A	STORAGE	232
20-102	MK SPACE LAB	253
20-102A	STORAGE	196
20-103	GIRLS RESTROOM	45
20-104	BOYS RESTROOM	45
20-105	SCIENCE ROOM LAB	941
20-105A	STORAGE	182
20-106	IT	41
20-130	MECHANICAL	150
20-131	ELECTRICAL	105

BUILDING NO. 20 - SECOND FLOOR		
ROOM #	ROOM NAME	SF
20-202	STAIR	192
20-203	STAIR	192
20-205	ELEVATOR	192
20-206	CORRIDOR	1,189
20-207	BRIDGE CONNECTOR	380
20-208	AQUA/MULTI-ROOM LAB	944
20-208A	STORAGE	196
20-201	TECH ENG ROOM LAB	1,269
20-201A	STORAGE	251
20-202	MK SPACE LAB	1,579
20-202A	STORAGE	176
20-203	GIRLS RESTROOM	45
20-204	BOYS RESTROOM	45
20-205	CUSTODIAL	24
20-230	MECHANICAL	143
20-231	ELECTRICAL	103

HARVARD • JOLLY
ARCHITECTURE

2017 VISTA PARKWAY, SUITE 100 | WEST PALM BEACH, FL 33411 | www.harvardjolly.com | AAC000119

STEM BUILDING
THE BENJAMIN SCHOOL - LOWER/MIDDLE SCHOOL
 11000 Ellison Wilson Road, North Palm Beach, FL 33408
 CONSTRUCTION DOCUMENTS

Comm. No: 16117.00
 Date: 10-23-17

Drawn: me

Revisions		
No.	Date	Note

TO THE BEST OF MY KNOWLEDGE, THE PLANS AND SPECIFICATIONS COMPLY WITH THE MINIMUM BUILDING CODES.

RENÉ TERCILLA AIA, REPP
 © 2017 HARVARD JOLLY, INC.

FLOOR PLAN

A1.02

Order Plans @