

P:\1817.00\Benjamin Lower School New STEM Building\18 Project Development\14 Drawings\Sheet\AS1.2.dwg, 10/24/2017 8:57:02 AM, DWG TO PDF .pc3

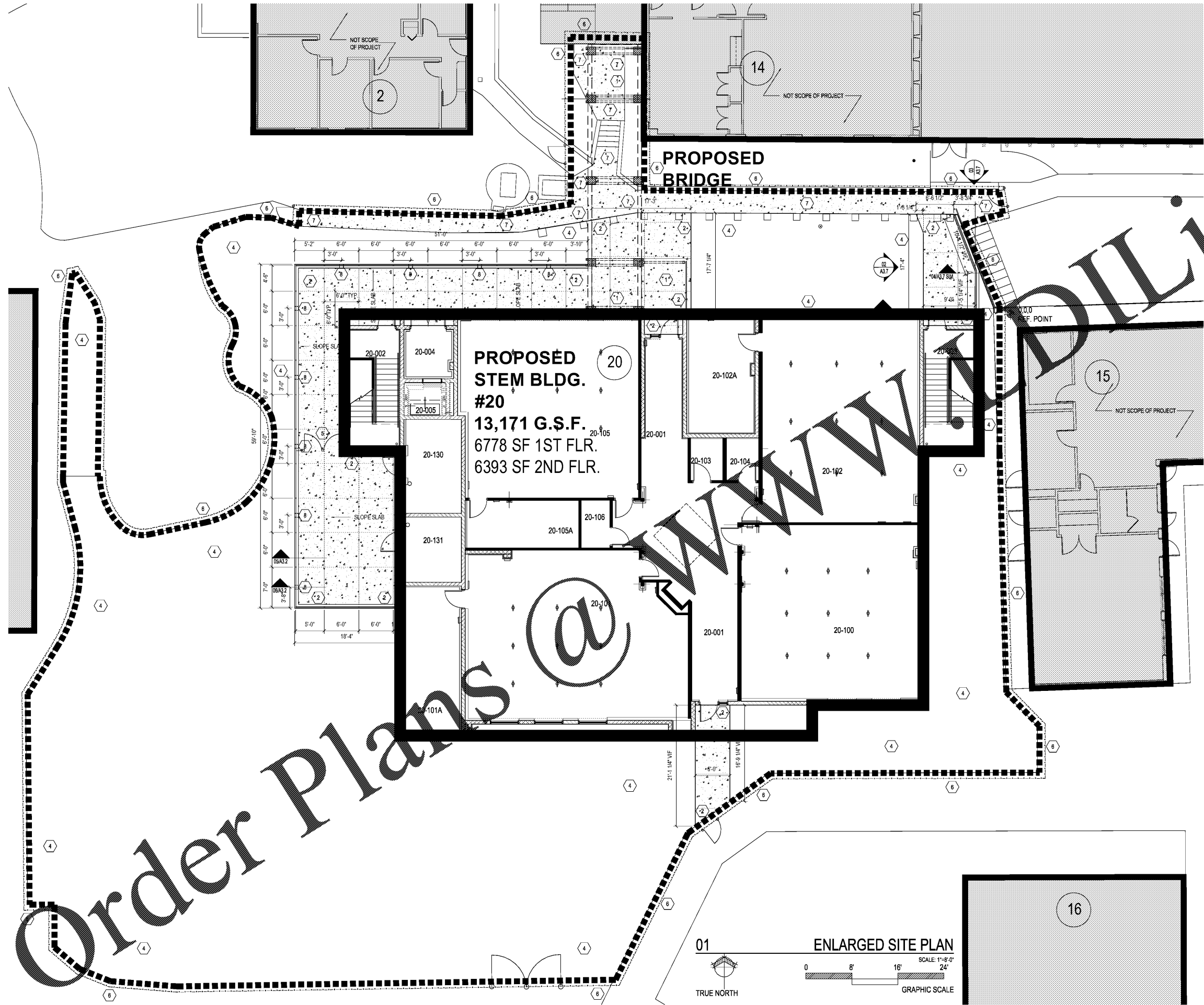

SITE PLAN KEY NOTES

REFER TO LANDSCAPE & CIVIL DWG. FOR MORE INFORMATION AS IT RELATES TO THIS PROJECT.

- AREA OF WORK FOR THIS PROJECT, TYPICAL.
- ① NEW ALUMINUM CANOPY SYSTEM PER THE PRE MANUFACTURED ALUMINUM COVERED WALKWAY SYSTEM COMPANY. FINISH TO BE CLEAR ANODIZED ALUM. SEE 01/AS2.1, A3.4, A3.5, & A3.6.
- ② NEW CONCRETE SIDEWALK, INSTALL A NEW 4" THK. CONC. SIDEWALK, 3000 PSI W/ WEXWB-1.4X1.4 WWF. PROVIDE CONTROL & EXPANSION JOINTS PER INDUSTRY STANDARDS TYP. SEE CIVIL & LANDSCAPE FOR MORE INFORMATION.
- ③ NEW ALUM. POWDER COATED GUARD RAIL 4" H. W/ 2" RIB.
- ④ INSTALL NEW SOD IN PROJECT AREA OF WORK. NEW HARDSCAPE LANDSCAPE AREAS, SEE LANDSCAPE DWGS. FOR MORE INFORMATION.
- ⑤ NEW ALUM. POWDER COATED GATE "A" SYS.
- ⑥ INSTALL CONSTRUCTION FENCING, CHAINLINK FENCE & GATE SYS. W/ ALV. COATED CHAINLINK FENCE 1X1 CHAINLINK FABRIC AND W/ PRIVACY SCREEN FABRIC TYP.
- ⑦ REMOVE EXISTING SIDEWALK AREAS AS INDICATED WITH THE HATCH SYMBOL IN ORDER TO INSTALL SYSTEMS AND UTILITIES. INSTALL NEW CONCRETE SIDEWALK TO MATCH EXIST. GRADES & WIDTH OF EXIST. SIDEWALK REMOVED-INSTALL A NEW 4" THK. CONC. SIDEWALK, 3000 PSI W/ WEXWB-1.4X1.4 WWF. PROVIDE CONTROL & EXPANSION JOINTS PER INDUSTRY STANDARDS TYP. SEE CIVIL & LANDSCAPE FOR MORE INFORMATION.
- ⑧ S.S. SCUPPER - 2 1/2" H. X 8" W. S.S. SCUPPER SLEEVE POURED INTO CONC. CAP TYP.

NOTE: GENERAL CONTRACTOR IS REQUIRED TO INSTALL ALL CONSTRUCTION FENCING W/ FABRIC & WIND SCREEN FABRIC TO REMAIN IN PLACE THRU THE DURATION OF THE PROJECT. ALL CONSTRUCTION ACTIVITIES SHALL BE SEPARATED FROM THE OCCUPIED SITE BY AT LEAST ONE SECURE BARRIER. PROVIDE GATES FOR ACCESS REQUIRED TO AREAS ON THE SITE.

HARVARD • JOLLY
ARCHITECTURE

STEM BUILDING
THE BENJAMIN SCHOOL - LOWER/MIDDLE SCHOOL
11000 Ellison Wilson Road, North Palm Beach, FL 33408
CONSTRUCTION DOCUMENTS

Comm. No: 16117.00
Date: 10-23-17

Revisions		
No.	Date	Note

TO THE BEST OF MY KNOWLEDGE, THE PLANNING SPECIFICATIONS COMPLY WITH THE MINIMUM BUILDING CODES.

RENÉ TERCILLA AIA, REFP
© 2017 HARVARD JOLLY, INC.

ENLG. SITE PLAN

AS1.2

