

SCO# 2014-01A  
NBCCS# 223

CULINARY LAB

LS3P

227 WEST TRADE STREET SUITE 700  
CHARLOTTE, NORTH CAROLINA 28202  
TEL. 704.333.9888 FAX 704.333.2928  
WWW.LS3P.COM

BSDI  
BULLA SMITH  
DESIGN ENGINEERING  
NC Certificate of Licensure C-3232  
1347 Harding Place Suite 201  
Charlotte, NC 28204  
© 704.333.3122  
A STANLEY D. LINDSEY AND ASSOCIATES, LTD. OFFICE



MEMBERS OF THE AMERICAN INSTITUTE OF ARCHITECTS

COPYRIGHT 2018 ALL RIGHTS RESERVED  
PRINTED OR ELECTRONIC DRAWINGS AND DOCUMENTATION MAY NOT BE REPRODUCED IN ANY FORM WITHOUT WRITTEN PERMISSION FROM LS3P ASSOCIATES LTD.

REVISIONS:

No.	Description	Date

PROJECT: 5202-189770  
DATE: January 2, 2018  
DRAWN BY: S.H.D.  
CHECKED BY: J.L.S.

UTILITY PLAN  
**C-040**

BID SET

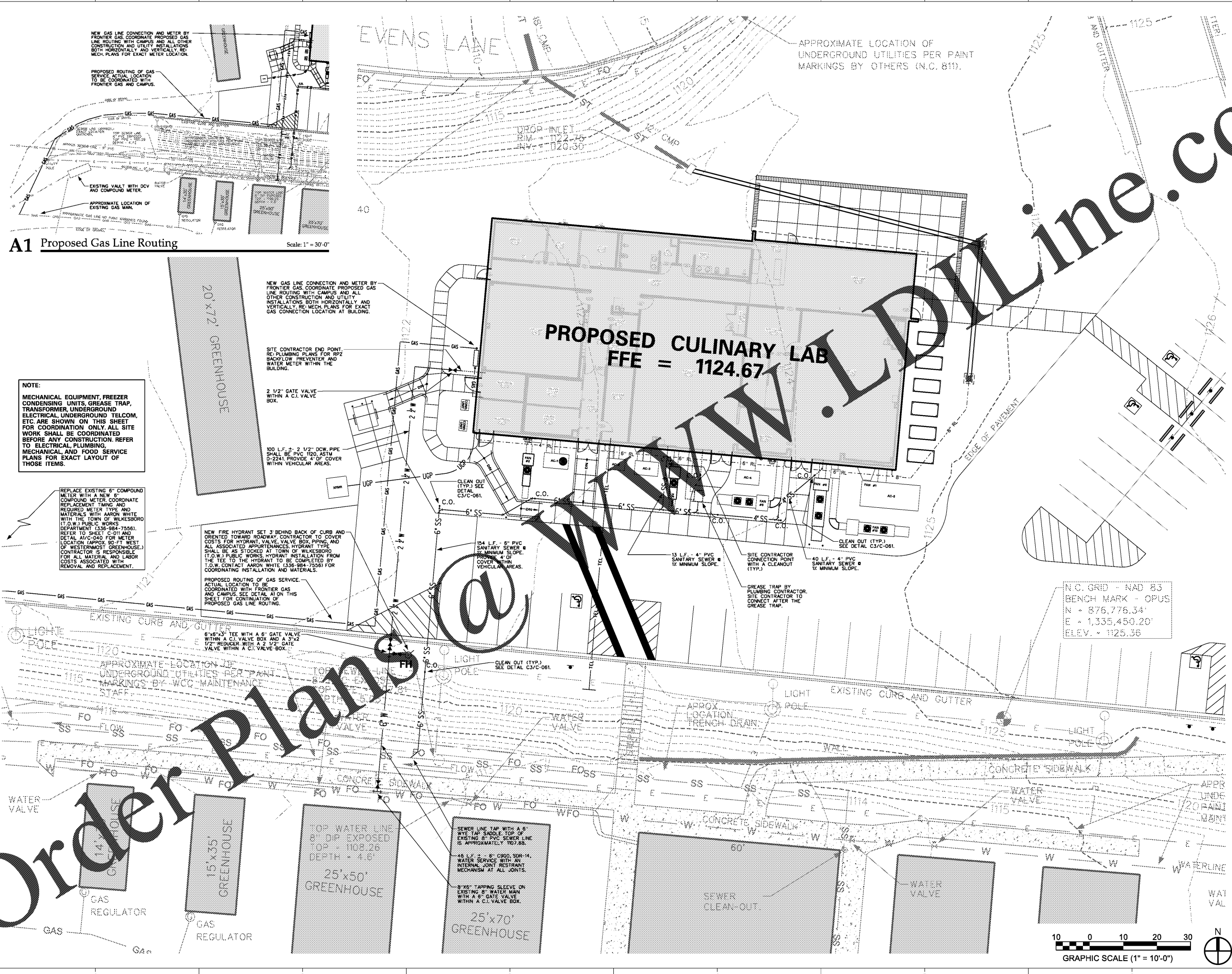

**A1 Proposed Gas Line Routing** Scale: 1" = 30'-0"

NOTE:  
MECHANICAL EQUIPMENT, FREEZER CONDENSING UNITS, GREASE TRAP, TRANSFORMER, UNDERGROUND ELECTRICAL, UNDERGROUND TELCOM, ETC. ARE SHOWN ON THIS SHEET FOR COORDINATION ONLY. ALL SITE WORK SHALL BE COORDINATED BEFORE ANY CONSTRUCTION. REFER TO ELECTRICAL, PLUMBING, MECHANICAL AND FOOD SERVICE PLANS FOR EXACT LAYOUT OF THOSE ITEMS.

REPLACE EXISTING 6" COMPOUND METER WITH A NEW 6" COMPOUND METER. COORDINATE REPLACEMENT TIMING AND REQUIRED METER TYPE AND MATERIALS WITH AARON WHITE WITH THE TOWN OF WILKESBORO (T.O.W.) PUBLIC WORKS DEPARTMENT (336-984-7556). REFER TO SHEET C-011 AND DETAIL A1/C-040 FOR METER LOCATION (APPROX. 90'-FT WEST OF WESTERMOST GREENHOUSE). CONTRACTOR IS RESPONSIBLE FOR ALL MATERIAL AND LABOR COSTS ASSOCIATED WITH REMOVAL AND REPLACEMENT.

NEW FIRE HYDRANT SET 3' BEHIND BACK OF CURB AND ORIENTED TOWARD ROADWAY. CONTRACTOR TO COVER COSTS FOR HYDRANT, VALVE, VALVE BOX, PIPING, AND ALL ASSOCIATED APPURTENANCES. HYDRANT TYPE SHALL BE AS STOCKED AT TOWN OF WILKESBORO (T.O.W.) PUBLIC WORKS DEPARTMENT. INSTALLATION FROM THE TEE TO THE HYDRANT TO BE COMPLETED BY T.O.W. CONTRACTOR AARON WHITE (336-984-7556) FOR COORDINATING INSTALLATION AND MATERIALS.

PROPOSED ROUTING OF GAS SERVICE. ACTUAL LOCATION TO BE COORDINATED WITH FRONTIER GAS AND CAMPUS. SEE DETAIL A1 ON THIS SHEET FOR CONTINUATION OF PROPOSED GAS LINE ROUTING.

TOP WATER LINE 8" DP EXPOSED TOP = 108.26' DEPTH = 4.6'

SEWER LINE TAP WITH A 6" WYE TAP SADDLE TOP OF EXISTING 8" WATER SERVICE LINE IS APPROXIMATELY 107.88'

P:\2017\2017.05 Wilkes CC Building\CD\ Flist\wccC040.dgn  
 19-DEC-2017 2:12:2

APPROXIMATE LOCATION OF UNDERGROUND UTILITIES PER PAINT MARKINGS BY OTHERS (N.C. 811).

**PROPOSED CULINARY LAB**  
**FFE = 1124.67**