

NOTES

- CONDUIT RUN BELOW GRADE SHALL BE PVC SCHEDULE 40. ELBOWS 2" AND LARGER SHALL BE GALVANIZED RIGID CONDUIT(S). RISERS SHALL BE RIGID STEEL CONDUIT(S) WHERE EXPOSED TO OUTSIDE ELEMENTS. REFER TO SPECIFICATIONS.
- ALL UNDERGROUND SITE CONDUIT SHALL BE BURIED A MINIMUM OF 36 INCHES DEEP BELOW FINISHED GRADE TO TOP OF CONDUIT UNLESS OTHERWISE NOTED.
- PROVIDE COLOR TAPE FOR IDENTIFICATION AT 18 INCHES DEEP (ABOVE SERVICE CONDUIT RUNS) PER N.E.C. 300-5 (D) (3).
- ALL TURNS SHALL BE MADE WITH LONG SHEEP ELLS.
- CONTRACTOR SHALL PROVIDE ALL EXCAVATING AND BACK FILLING REQUIRED FOR ALL NEW WORK INCLUDING FILL, COMPACTION, SURFACE, ETC. TO MEET ALL REQUIREMENTS AS APPLICABLE FOR THE AREA.
- PRIOR TO THE START OF CONSTRUCTION, CONTRACTOR SHALL DETERMINE THE PRESENCE AND LOCATION OF ANY UNDERGROUND FACILITIES SUCH AS TELEPHONE, ELECTRIC POWER, WATER, GAS, SEWAGE LINES, ETC. WHETHER PREVIOUSLY EXISTING OR AS INSTALLED BY OTHER TRADES, TO AVOID INTERFERENCE WITH ANY SUCH SYSTEM.
- ALL SPARE, EMPTY CONDUITS SHALL BE LABELED AS TO THEIR FUNCTION.
- CONTRACTOR SHALL MAINTAIN AN AS-BUILT DIMENSIONAL DRAWING ON SITE SHOWING ALL UNDERGROUND SERVICE ROUTING AND TERMINATION POINTS.
- CONTRACTOR SHALL MEET ON SITE WITH REPRESENTATIVES OF THE UTILITY COMPANIES INCLUDING POWER, TELEPHONE, AND CABLE TO DETERMINE THE FOLLOWING: (PRIOR TO BID AND PRIOR TO ROUGH IN).
 - POWER COMPANY:
 - A - VERIFY EXACT TRANSFORMER(S) LOCATION PRIOR TO BID.
 - B - VERIFY PRIMARY CONDUIT WORK REQUIRED AND RESPONSIBILITY PRIOR TO BID.
 - C - VERIFY METERING METHOD AND REQUIREMENTS, IF DIFFERENT FROM WHAT IS SHOWN ON THE DRAWINGS, NOTIFY ENGINEER IMMEDIATELY.
 - TELEPHONE COMPANY:
 - A - ORIGINATE AND TERMINATION OF THE SERVICE CONDUITS.
 - B - INSTALLATION SPECIFICATIONS, SIZE AND QUANTITY REQUIRED. HOWEVER, MAINTAIN QUANTITY AND SIZES SHOWN ON PLANS, IF IN EXCESS OF UTILITY REQUIREMENTS.

NOTE: CONTRACTOR'S FAILURE TO COMPLY WITH THESE COORDINATION PROCEDURES WILL CONSTITUTE THE CONTRACTOR ASSUMING ALL COSTS ASSOCIATED WITH REPLACING ANY AND ALL WORK ALREADY IN PLACE TO MEET UTILITY COMPANIES' RULES AND REQUIREMENTS.

KEY NOTES

- CLEARANCE BAR. SEE DETAIL #3 THIS SHEET.
- PROPOSED STARBUCKS PANEL LOCATIONS.
- PROVIDE ONE 1" CONDUIT WITH FULLWIRE FROM WEATHERPROOF JUNCTION BOX AT PROPOSED SIGN LOCATION AND RUN UNDERGROUND BACK TO PANELS' PROPOSED LOCATION IN THE SPACE.
- ELECTRICAL SERVICE LOCATION. SEE POWER RISER DIAGRAM ON SHEET E3.0.
- SECONDARY POWER CONDUITS, FURNISHED AND INSTALLED BY ELECTRICAL CONTRACTOR. SEE POWER RISER DIAGRAM ON SHEET E3.0.
- THO 4" CONDUITS WITH FULLWIRE BY ELECTRICAL CONTRACTOR FOR TELEPHONE SERVICE. CONDUIT TO BE STUBBED UP IN SPACE AT LOCATION IDENTIFIED BY TENANT.
- ONE 2" CONDUIT WITH FULLWIRE BY ELECTRICAL CONTRACTOR FOR CABLE T.V. SERVICE. CONDUIT TO BE STUBBED UP IN SPACE AT A LOCATION IDENTIFIED BY TENANT.
- EXISTING POLE TO BE MODIFIED WITH 3-PH, 120/208V. POLE PROVIDED TRANSFORMERS BY UTILITY COMPANY. REFER TO POWER RISER DIAGRAM ON SHEET E3.0 FOR ADDITIONAL DETAILS. VERIFY EXACT LOCATION AND REQUIREMENTS WITH JEA. SEE CONTACT INFORMATION BELOW.
- PRE MENU BOARD. SEE DETAIL #2 THIS SHEET.
- SPEAKER POST ORDER CONFIRMATION SYSTEM WITH DETECTABLE LOOP. SEE DETAIL #4 THIS SHEET.
- MENU BOARD SEE DETAIL #1 THIS SHEET.
- TERMINATE TELEPHONE CONDUITS AT PROPERTY LINE. COORDINATE WITH ATT. PHONE COMPANY REPRESENTATIVE.
- TERMINATE CABLE CONDUITS AT PROPERTY LINE. COORDINATE WITH UTILITY COMPANY REPRESENTATIVE.
- COMMUNICATION BOARD PROPOSED LOCATION. SEE SHEET E2.0 FOR LOCATION.
- 4 - 1/2" - #8 E.S. IN 1-1/4" CONDUIT.
- OPTICS ORIENTATION FOR THE SITE LIGHT FIXTURE.
- FIXTURE IS PROVIDED WITH DUAL SWITCHING OPTION (DS) SEE FIXTURE SCHEDULE.
- SITE POLE AND FIXTURE. SEE LIGHTING FIXTURE SCHEDULE ON THIS SHEET AND SHEET E1.1 FOR POLE DETAIL.
- ONE CIRCUIT CONTROLLED VIA PHOTOCELL ON TIMELOCK OFF AND ONE CIRCUIT CONTROLLED VIA PHOTOCELL 'ON', PHOTOCELL 'OFF'.

UTILITY CONTACTS

POWER COMPANY: JEA
 NAME: ROBERT SIMPSON
 PHONE No.: (904) 665-1783
 EMAIL: SIMPRB@JEA.COM

TELEPHONE COMPANY: AT&T
 NAME: CHRISTOPHER FERNANDEZ
 PHONE No.: (904) 721-1554
 EMAIL: CF953@ATT.COM

CONTRACTOR SHALL NOTIFY EACH UTILITY COMPANY REPRESENTATIVE LISTED ABOVE OF THE PRE-CONSTRUCTION MEETING SCHEDULE.

LIGHTING FIXTURE SCHEDULE

TYPE	MANUF.	CATALOG NO.	VOLT	LAMPS	LOAD (W)	MOUNTING
9A	LITHONIA	(2) DSX1-LED-F1-40K-T5H-MVOLT-DS	208	LED	366	CONCRETE POLE 25'-0" A.F.S. SEE SHEET E1.1 FOR POLE DETAIL
9B	LITHONIA	DSX1-LED-F1-40K-T4H-MVOLT-DS-HS	208	LED	183	
9C	LITHONIA	DSX1-LED-F1-40K-T5H-MVOLT-DS	208	LED	183	

GENERAL NOTES:

- PROVIDE NECESSARY MOUNTING HARDWARE AND ACCESSORIES FOR ALL FIXTURES.
- PROVIDE FUSES FOR ALL SITE LIGHTING FIXTURES.
- ALL FIXTURE SUBSTITUTIONS MUST BE SUBMITTED FOR APPROVAL (EQUALS ONLY).
- FUSES SHALL BE INSTALLED AT THE BASE OF POLE.
- FIXTURE AND POLE FINISH COLOR AS SELECTED BY ARCHITECT.

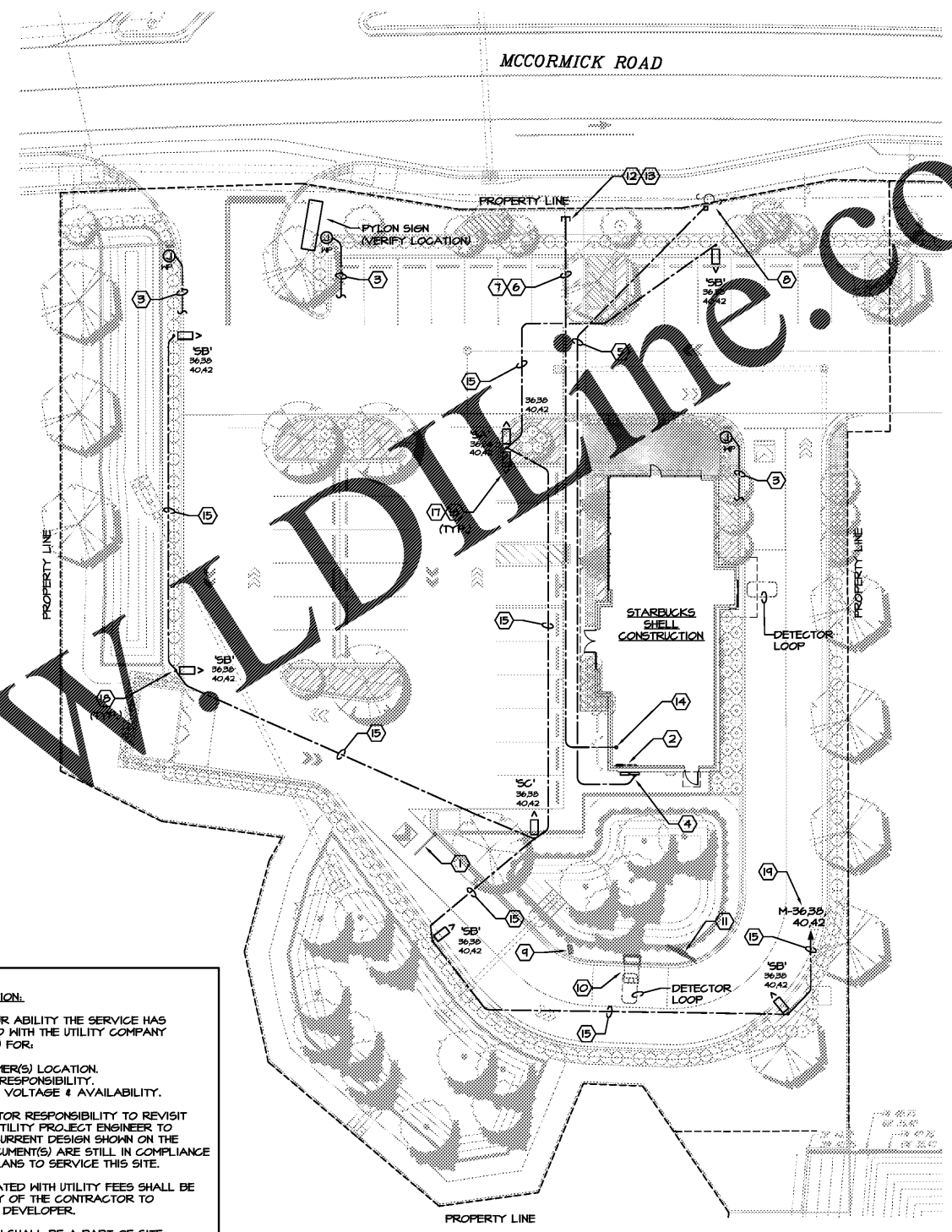

NORTH
ELECTRICAL SITE PLAN
 SCALE: 1" = 20'-0"

PROJECT SCOPE:
 THE WORK SHOWN ON THESE DOCUMENTS REPRESENT THE LANDLORD SCOPE OF WORK (MODIFIED SHELL DOCUMENT). ALL INTERIOR WORK INCLUDING INTERIOR LIGHTING, ADDITIONAL PANELS, WIRING, ETC., IS PART OF TENANT IMPROVEMENT DOCUMENT, THAT IS DESIGNED AND PERMITTED SEPARATELY.

CHEHAYEB & ASSOCIATES, INC.
 CONSULTING PROFESSIONAL ENGINEERS
 8702 AZEEL ST. TAMPA, FL 33609
 (813) 876-1415 (Fax) 876-0918
 LIC. #49521 SOUHEIL CHEHAYEB CERT. #7340 17-110

FWH Architects
 3336 Gandy Blvd, Suite 201
 Holiday, Florida 34690
 Ph. 727. 815. 3336
 Fax 727. 815. 3337

brightwork real estate
 3706 WEST SWANN AVE, SUITE 200
 TAMPA, FL 33609
 PHONE: 813.874.1770

TO THE BEST OF THE KNOWLEDGE OF THE ARCHITECTS AND ENGINEERS, PLANS AND SPECIFICATIONS COMPLY WITH THE APPLICABLE MINIMUM BUILDING CODES AND THE APPLICABLE MINIMUM FIRE SAFETY STANDARDS

SOUHEIL CHEHAYEB, P.E.
 FL License No. 49521

no.	date	revision descriptions

STARBUCKS SHELL CONSTRUCTION
 2500 MONUMENT ROAD
 JACKSONVILLE, FL

12.13.17 date
 17.047 comm. no.

ELECTRICAL SITE PLAN

E1.0