

**STORM DRAINAGE NOTES:**

- A. GENERAL:**
  - DISTANCES AND LENGTHS OF PIPE SHOWN ON PLANS ARE REFERENCED TO THE CENTER OF STRUCTURES.
  - PROPERTY OWNER SHALL BE RESPONSIBLE FOR THE OPERATION AND MAINTENANCE OF THE STORMWATER FACILITIES ONSITE TO BE MAINTAINED IN FUNCTIONING ORDER AS DESIGNED.
- B. MATERIALS:**
  - REINFORCED CONCRETE PIPE (RCP) SHALL MEET THE REQUIREMENTS OF ASTM C-76, CLASS III, WALL THICKNESS "B", LATEST REVISION. RUBBER GASKETS OR OTHER MANUFACTURER SUPPLIED JOINT SEALER SHALL BE USED.
  - ALL PVC DRAINAGE PIPE AND FITTINGS SHALL BE NON-PRESSURE POLYVINYL CHLORIDE (PVC) PIPE CONFORMING TO ASTM D 3034, SDR 35, WITH PUSH-ON RUBBER GASKET JOINTS.
  - ALL HIGH DENSITY POLYETHYLENE PIPE AND FITTINGS SHALL MEET THE REQUIREMENTS OF AASHTO M - 294 LATEST REVISIONS. ALL PIPING TO BE NON-PERFORATED TUBING.
- C. INSTALLATION:**
  - PIPE SHALL BE PLACED ON A MINIMUM OF 8 INCHES STABLE GRANULAR MATERIAL FREE OF ROCK FORMATION AND OTHER FOREIGN FORMATIONS, AND CONSTRUCTED TO A UNIFORM GRADE AND LINE.
  - BACKFILL MATERIAL SHALL BE WELL GRADED GRANULAR MATERIAL, WELL TAMPIED IN LAYERS NOT TO EXCEED 6 INCHES TO A HEIGHT OF 12 INCHES ABOVE PIPE AS SHOWN ON THE PLANS.
  - PROVIDE A MINIMUM PROTECTIVE COVER OF 18 INCHES OVER STORM SEWER AND AVOID UNNECESSARY CROSSING BY HEAVY CONSTRUCTION VEHICLES DURING CONSTRUCTION.

**DATUM NOTE:**

**BENCHMARKS:**  
CONTROL BENCHMARK: ELEVATIONS SHOWN HEREON ARE BASED ON NATIONAL GEODETIC SURVEY BENCHMARK PD 1815757. A SURVEY DISK SET IN TOP OF A CONCRETE MONUMENT, LOCATED ABOUT 350' SOUTH OF THE CENTERLINE OF MCCORMICK ROAD, 37' EAST OF THE CENTERLINE OF THE NORTHBOUND LANES OF MONUMENT ROAD, AND 2' WEST OF A CONCRETE LIGHT POLE AND A CARSONITE WITNESS POST.  
ELEVATION: 41.28' (NAVD 1988)

**TBM #1:**  
STATION IS A BOX CUT LOCATED ON THE CONCRETE SIDEWALK ALONG THE SOUTH SIDE OF MCCORMICK ROAD, NEAR THE NORTHEAST CONCRETE ENTRYWAY OF THE PARKING LOT SHOWN HEREON.  
ELEVATION: 39.85' (NAVD 1988)

**TBM #2:**  
STATION IS A BOX CUT LOCATED ON TOP OF A CURB INLET ON THE WEST SIDE OF MONUMENT ROAD NEAR THE SOUTHEAST CONCRETE ENTRYWAY OF THE PARKING LOT SHOWN HEREON.  
ELEVATION: 40.41' (NAVD 1988)

**FEMA NOTE:**

THE PROPERTY SHOWN HEREON APPEARS TO LIE IN FLOOD ZONE "X" ACCORDING TO THE FLOOD INSURANCE RATE MAP, COMMUNITY NUMBER 120077, PANEL NUMBER 0382, SUFFIX H, EFFECTIVE JUNE 3, 2013 FOR THE CITY OF JACKSONVILLE, FLORIDA. MAP NUMBER 12031C0382H.

**STORMWATER SUMMARY:**

THE PROPOSED DRAINAGE PLAN CONSIST OF TWO (2) DRY RETENTION PONDS WHICH WILL DISCHARGE TO THE ADJACENT PROPERTY VIA A WEIR WALL TO MATCH EXISTING DRAINAGE PATTERNS. THE ONSITE STORMWATER MANAGEMENT SYSTEM WILL COLLECT AND CONVEY STORMWATER THROUGH ONSITE GRATE INLETS AND STORMWATER PIPES TO THE PROPOSED PONDS. THE PONDS HAVE BEEN DESIGNED TO MEET CITY OF JACKSONVILLE, SJRWMD, AND FDOT DESIGN STANDARDS FOR TREATMENT AND ATTENUATION.

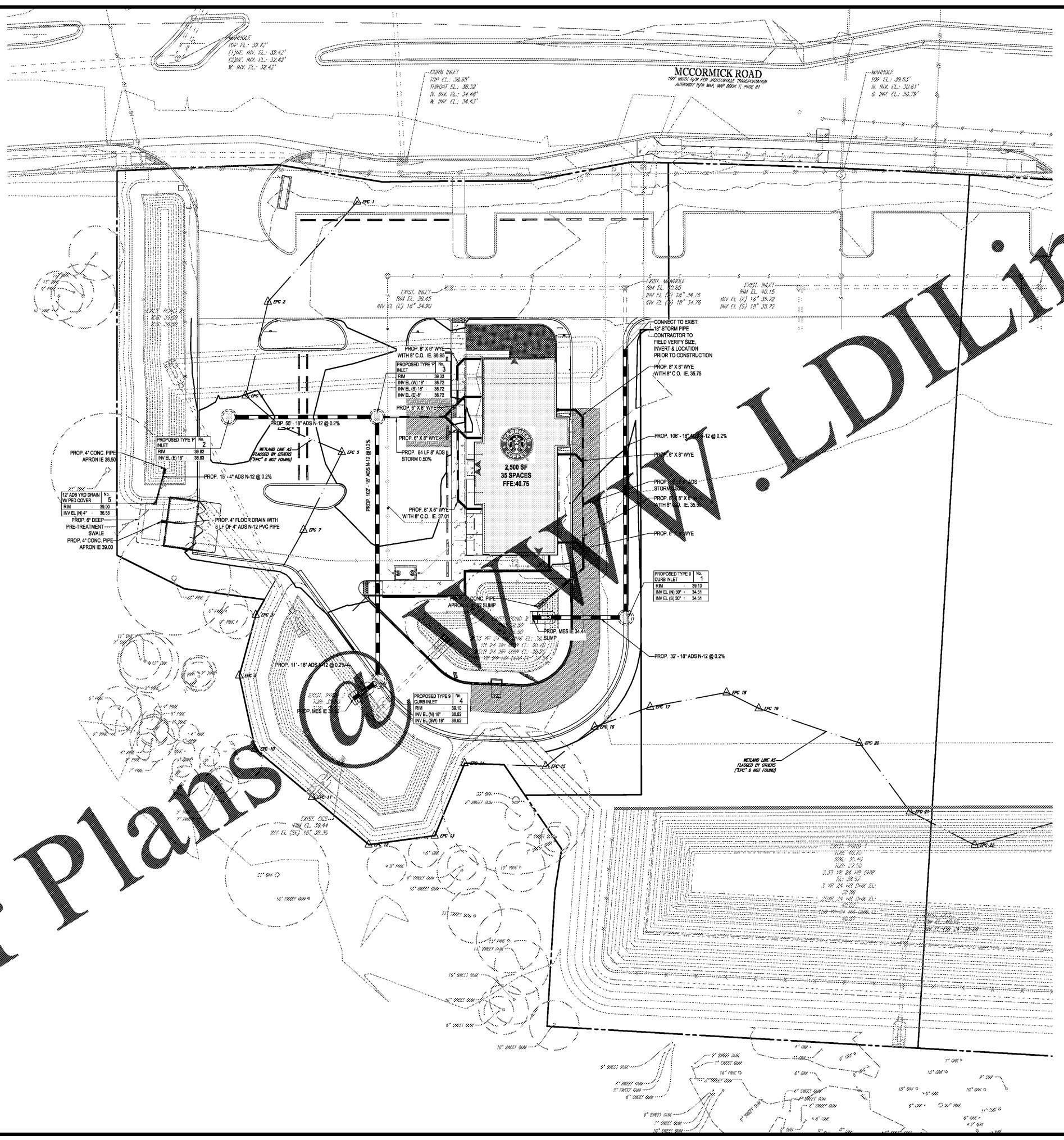

**LEGEND**

TYPE	NOTE TEXT	NOTE
ONSITE LINE / R.O. LINE		---
PROPERTY LINE / INTERIOR PARCEL LINE		---
PROP. BUILDING OUTLINE		---
PROP. BUILDING COVER		---
PROP. BUILDING ENTRANCES		▲
EXIST. STORM PIPE		---
EXIST. STORM STRUCTURE		---
PROP. 4" CONC. PAVING		---
PROP. 6" BLACK CONC. PAVING		---
PROP. DRAINAGE STRUCTURE		---

Order Plans

**BOHLER ENGINEERING**  
SITE CIVIL AND CONSULTING ENGINEERING ARCHITECTURE INTERIORS SUSTAINABLE DESIGN PERMITTING SERVICES  
LAND SURVEYING  
SOUTHERN NEW JERSEY: PHILADELPHIA, PA: LEHIGH VALLEY, PA: SOUTH FLORIDA: FT. LAUDERDALE, FL  
CHARLOTTE, NC: RICHMOND, VA: WASHINGTON, DC: DALLAS, TX: HOUSTON, TX: AUSTIN, TX: SAN ANTONIO, TX: DALLAS, TX: PHOENIX, AZ: LOS ANGELES, CA: SAN FRANCISCO, CA: SEATTLE, WA: PORTLAND, OR: DENVER, CO: COLORADO SPRINGS, CO: CHICAGO, IL: MIAMI, FL: TAMPA, FL: JACKSONVILLE, FL: ORLANDO, FL: WINTER SPRING, FL: NORTON MASSACHUSETTS, MASSACHUSETTS

REV	DATE	COMMENT	BY

KNOW WHAT'S BELOW  
ALWAYS CALL 811  
BEFORE YOU DIG  
www.callsunshine.com

**PERMIT SET**

PROJECT No.: FL177090  
DRAWN BY: JOP  
CHECKED BY: GRR  
DATE: 11/20/2017  
SCALE: 1" = 20'  
CAD I.D.: GPO

FOR  
**BW McCORMICK, LLC**  
LOCATION OF SITE  
McCORMICK RD  
JACKSONVILLE, FL  
CITY OF JACKSONVILLE

**BOHLER ENGINEERING**  
3820 NORTHALE BLVD., SUITE 300B  
TAMPA, FLORIDA 33624  
Phone: (813) 812-4100  
Fax: (813) 812-4101  
FLORIDA BUSINESS CERT. OF AUTH. No. 30790  
LANDSCAPE ARCHITECT/BUSINESS LIC. No. C00000010

**Gregory Robert Hoff, P.E.**  
No. 74566  
STATE OF FLORIDA  
PROFESSIONAL ENGINEER  
12/15/2017

**SHEET TITLE:**  
**DRAINAGE PLAN**

**SHEET NUMBER:**  
**C-7**