

GENERAL NOTES:

1. ALL WATER AND/OR SEWER CONSTRUCTION SHALL CONFORM TO THE CURRENT JEA WATER AND SEWER STANDARDS MANUAL AND THE JEA DIS MANUAL.
2. ALL EXISTING OR PROPOSED WATER, SEWER, OR REUSE APPURTENANCES AFFECTED BY THE DEVELOPMENT OF THIS SITE ARE TO BE RAISED TO THE FINAL GRADE PRIOR TO ISSUANCE OF THE C.O.

WATER DISTRIBUTION NOTES:

1. CONTRACTOR SHALL FOLLOW GUIDELINES AND PROCEDURES OUTLINED BY UTILITY PROVIDER, AND HAVE UTILITY PROVIDER'S MANUAL ON-SITE AT ALL TIMES. THIS POLICY MANUAL SHALL BE CONSIDERED PART OF THE CONSTRUCTION DOCUMENTS AS IT PERTAINS TO APPROVED MATERIALS, INSTALLATION METHODS, INSPECTION NOTIFICATION AND AS-BUILT PROJECT CLOSEOUT REQUIREMENTS.
2. ALL HIGH DENSITY POLYETHYLENE PIPE AND FITTINGS SHALL MEET THE REQUIREMENTS OF AASHTO M - 294 LATEST REVISIONS. ALL PIPING TO BE NON-PERFORATED TUBING.
3. BACKFLOW PREVENTER TO BE INSTALLED ON CUSTOMER SIDE OF THE WATER METER BOX AT A MINIMUM OF 18" FROM FINAL GRADE TO THE BOTTOM OF THE BACKFLOW.

SANITARY SEWER NOTES:

- A. GENERAL:**
1. DISTANCE AND LENGTHS SHOWN ON PLANS AND PROFILE DRAWINGS ARE REFERENCED TO THE CENTER OF STRUCTURES.
 2. PRIOR TO COMMENCING CONSTRUCTION, CONTRACTOR TO TELEVIEW EXISTING SANITARY SEWER LINE FROM POINT OF CONNECTION THROUGH THE NEXT SEQUENTIAL DOWNSTREAM RUN OF PIPE. ADDITIONALLY, PRIOR TO COMPLETION OF CONSTRUCTION, CONTRACTOR SHALL TELEVIEW THE NEWLY INSTALLED SANITARY SEWER MAIN TO ENSURE NO DIPS OR DEBRIS WITHIN LINE.
- B. MATERIALS:**
1. ALL PVC GRAVITY SEWER PIPE AND FITTINGS SHALL BE NON-PRESSURE POLY(VINYL CHLORIDE) (PVC) PIPE CONFORMING TO ASTM D 3034, SDR 26, WITH PUSH-ON RUBBER GASKET JOINTS.
 2. PIPE SHALL CONFORM TO AWWA STANDARDS C900 FOR 4 INCH THROUGH 12 INCH PIPE, AND AWWA STANDARD C905 FOR 14 INCH THROUGH 36 INCH PIPE. PIPE IS TO BE MANUFACTURED TO DUCTILE IRON PIPE EQUIVALENT OUTSIDE DIAMETER.
 3. PIPE SHALL CONFORM TO ASTM D1784 AND D1785. GREEN COLOR PIPE. PIPE TO BE MANUFACTURED TO I.P.S. (STEEL) STANDARD PIPE EQUIVALENT OUTSIDE DIAMETERS. PIPE SHALL BE MARKED NSF-PW APPROVED. TO INSURE A WATER-TIGHT CONNECTION, THE CONTRACTOR SHALL UTILIZE "PURPLE PRIMER" AND "RAIN OR SHINE GLUE" OR JEA APPROVED EQUAL.
 4. ALL FITTINGS AND ACCESSORIES SHALL BE AS MANUFACTURED OR SUPPLIED BY THE PIPE MANUFACTURER OR APPROVED EQUAL.
 5. ALL SANITARY CLEANOUTS WITHIN PAVEMENT SHALL HAVE A LID THAT IS H20 LOADING.
- C. INSTALLATION:**
1. PIPE AND FITTINGS:
 - a. SEWER PIPE SHALL BE INSTALLED IN ACCORDANCE WITH ASTM D2321, AND THE UNI-BELL PLASTICS PIPE ASSOCIATION'S RECOMMENDED PRACTICE FOR THE INSTALLATION OF PVC SEWER PIPE.
 - b. BEDDING AND INITIAL BACKFILL (12 INCHES) OVER SEWER MAINS AND SERVICES SHALL BE SAND WITH NO ROCK LARGER THAN 1" IN DIAMETER. PEA ROCK OR 3/4" WASHED ROCK WILL BE USED IN WATER OR WHERE UNSUITABLE BEDDING EXISTS. ALL OTHER FILL SHALL NOT HAVE ROCK LARGER THAN 6" IN DIAMETER.
 2. CLEANOUTS:
 - a. CLEANOUTS SHALL BE SET PLUMB TO LINE AND GRADE ON FIRM CLEAN SUBGRADE PROVIDING UNIFORM BEARING UNDER THE BASE.
 - b. ALL OPENINGS AND JOINTS SHALL BE SEALED WATER-TIGHT.
 3. SERVICE:
 - a. MINIMUM SLOPE OF ALL SERVICE LINES SHALL BE 1.00%.
 - b. EACH SERVICE CONNECTION SHALL BE PLUGGED WATER-TIGHT WITH AN APPROVED PLUG.
 - c. CONNECTION OF SERVICES TO BUILDING'S PLUMBING SHALL BE COORDINATED WITH THE ARCHITECTURAL DRAWINGS.

DATUM NOTE:

BENCHMARKS:

CONTROL BENCHMARK:
ELEVATIONS SHOWN HEREON ARE BASED ON NATIONAL GEODETIC SURVEY BENCHMARK PID "DL5763", A SURVEY DISK SET IN TOP OF A CONCRETE MONUMENT, LOCATED ABOUT 350.0' SOUTH OF THE CENTERLINE OF MCCORMICK ROAD, 37.3' EAST OF THE CENTERLINE OF THE NORTHBOUND LANES OF MONUMENT ROAD, AND 2.0' WEST OF A CONCRETE LIGHT POLE AND A CARSONITE WITNESS POST.

ELEVATION: 41.28' (NAVD 1988)

TBM #1:
STATION IS A BOX CUT LOCATED ON THE CONCRETE SIDEWALK ALONG THE SOUTH SIDE OF MCCORMICK ROAD, NEAR THE NORTHEAST CONCRETE ENTRYWAY OF THE PARKING LOT SHOWN HEREON.

ELEVATION: 39.85' (NAVD 1988)

TBM #2:
STATION IS A BOX CUT LOCATED ON TOP OF A CURB INLET ON THE WEST SIDE OF MONUMENT ROAD NEAR THE SOUTHEAST CONCRETE ENTRYWAY OF THE PARKING LOT SHOWN HEREON.

ELEVATION: 40.41' (NAVD 1988)

FEMA NOTE:

THE PROPERTY SHOWN HEREON APPEARS TO LIE IN FLOOD ZONE "X" ACCORDING TO THE FLOOD INSURANCE RATE MAP, COMMUNITY NUMBER 120077, PANEL NUMBER 0382, SUFFIX H, EFFECTIVE JUNE 3, 2013 FOR THE CITY OF JACKSONVILLE, FLORIDA, MAP NUMBER 12031039211.

DOMESTIC WATER PRESSURE REQUIREMENTS:

THE DOMESTIC WATER SERVICE SHALL BE A MINIMUM OF 50 PSI AND NO GREATER THAN 65 PSI DYNAMIC PRESSURE AT THE POINT OF BUILDING ENTRY. IF THE SERVICE STATIC IS OVER 65 PSI, A PRESSURE REDUCING VALVE TO BE PROVIDED BY THE SHELL GENERAL CONTRACTOR. IF THE PRESSURE IS UNDER 50 PSI AT THE POINT OF ENTRY, A BOOSTER PUMP AND SURGE TANK SHALL BE PROVIDED AND INSTALLED. IMMEDIATELY UPON INSTALLATION OF THE WATER SERVICE TO THE BUILDING, THE PLUMBING CONTRACTOR SHALL PERFORM A PRESSURE TEST. SHOULD THE PRESSURES NOT MEET THE ABOVE STATED CRITERIA, THE GENERAL CONTRACTOR SHALL PROVIDE RESULTS TO THE ARCHITECT AT THE EARLIEST POSSIBLE DATE. THE ARCHITECT WILL THEN PROVIDE THE NECESSARY DESIGN REMEDIES TO THE CONTRACTOR FOR PRICING, PERMIT AND CONSTRUCTION.

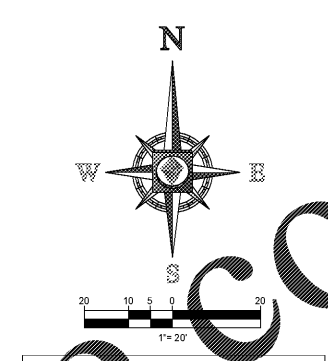
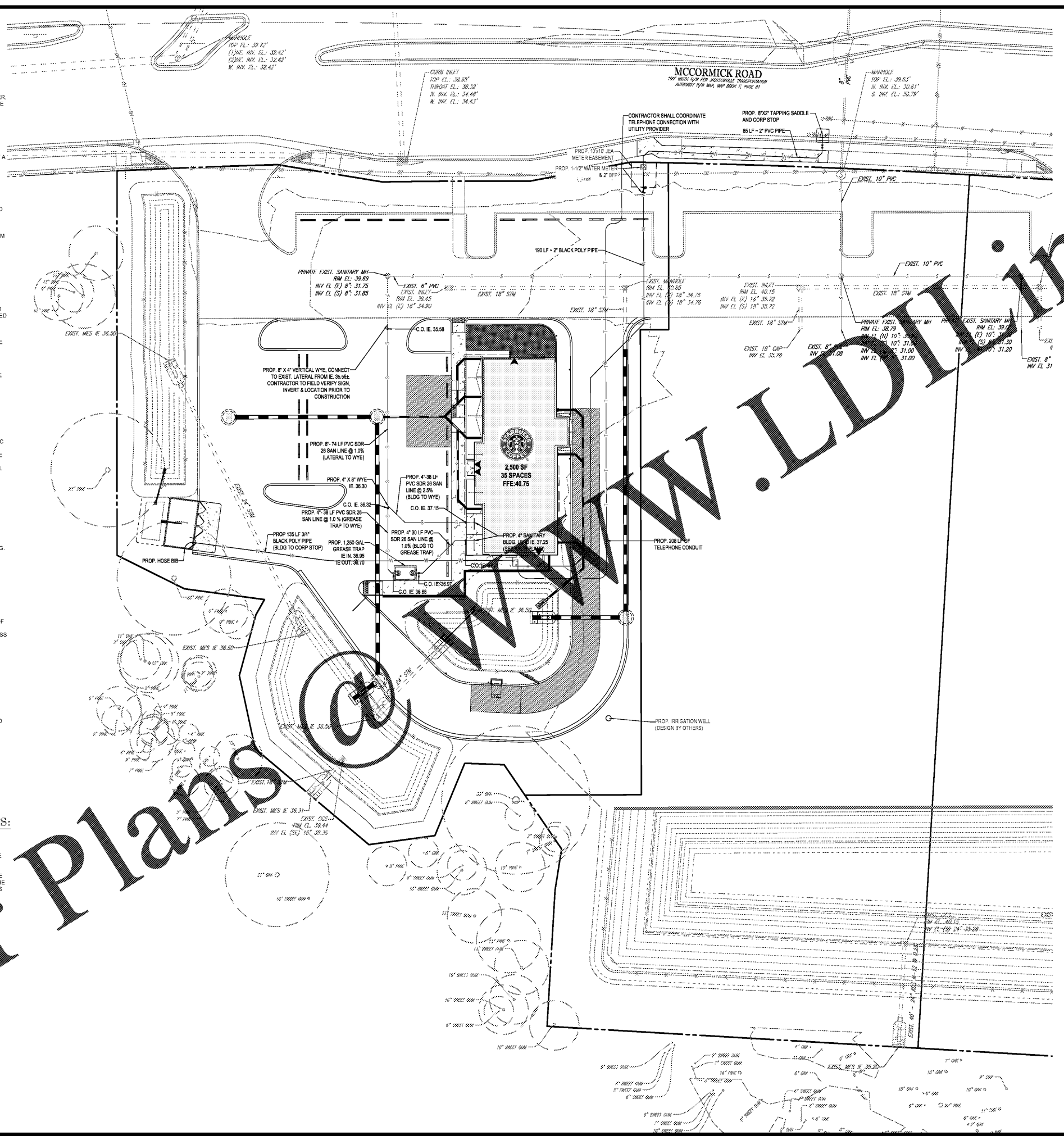

LEGEND

| SYMBOL | NOTE |
|--------|--------------------------------------|
| --- | PROPERTY LINE / R.O.W. LINE |
| --- | PROPERTY LINE / INTERIOR PARCEL LINE |
| --- | PROP. BUILDING OUTLINE |
| --- | PROP. BUILDING COVERAGE |
| --- | PROP. BUILDING ENTRANCES |
| --- | EXIST. STORM PIPE |
| --- | EXIST. STORM STRUCTURE |
| --- | PROP. STORM PIPE |
| --- | PROP. WATER MAIN |
| --- | PROP. GRAVITY SAN SEWER |
| --- | PROP. ELECTRIC CONDUIT |
| --- | PROP. TELEPHONE CONDUIT |
| --- | PROP. GREASE TRAP |
| --- | PROP. CLEAN OUT |
| --- | EXIST. WATER MAIN |
| --- | EXIST. OVERHEAD WIRE |

BOHLER ENGINEERING

SITE CIVIL AND CONSULTING ENGINEERING ARCHITECTURE INTERIOR DESIGN SUSTAINABLE DESIGN PERMITTING SERVICES

LAND SURVEYING AND CONSULTING ENGINEERING ARCHITECTURE INTERIOR DESIGN SUSTAINABLE DESIGN PERMITTING SERVICES

CHARLOTTE, NC
 FARGO, ND
 GREENSBORO, NC
 HUNTSVILLE, AL
 JACKSONVILLE, FL
 KANSAS CITY, MO
 LITTLE ROCK, AR
 MEMPHIS, TN
 MIAMI, FL
 NASHVILLE, TN
 OKLAHOMA CITY, OK
 PHOENIX, AZ
 RICHMOND, VA
 TAMPA, FL
 WASHINGTON, DC

1400 W. UNIVERSITY BLVD., SUITE 1000, TAMPA, FL 33606
 TEL: (813) 812-4100 FAX: (813) 812-4101
 LICENSE NO. 74566

REVISIONS

| REV | DATE | COMMENT | BY |
|-----|------|---------|----|
| | | | |

811 KNOW WHAT'S BELOW ALWAYS CALL 811 BEFORE YOU DIG
 www.callsunshine.com

PERMIT SET

PROJECT No.: FL170090
 DRAWN BY: JOP
 CHECKED BY: GRR
 DATE: 11/20/2017
 SCALE: 1"=20'
 CAD I.D.: UPD

STARBUCKS COFFEE

FOR
BW McCORMICK, LLC
 LOCATION OF SITE
 McCORMICK RD
 JACKSONVILLE, FL
 CITY OF JACKSONVILLE

BOHLER ENGINEERING
 3820 NORTHDALE BLVD., SUITE 300B
 TAMPA, FLORIDA 33624
 Phone: (813) 812-4100
 Fax: (813) 812-4101
 FLORIDA BUSINESS CERT. OF AUTH. No. 30700
 LANDSCAPE ARCHITECT LICENSE No. LC-00000001

GREGORY ROBERT NOTZ
 LICENSE
 No. 74566
 STATE OF FLORIDA
 PROFESSIONAL ENGINEER
 12/15/2017

SHEET TITLE:
UTILITY PLAN

SHEET NUMBER:
C-6

Order Plans @