

GENERAL NOTES

- A. OSB IS NOT AN APPROVED CONSTRUCTION MATERIAL AND SHALL NOT BE SUBSTITUTED FOR FIRE TREATED PLYWOOD.
- B. ALWAYS WATERPROOF DEMISING WALLS IN WET AREAS, INCLUDING BEHIND COOLER/ FREEZER AND BEVERAGE COUNTER.
- C. ALL SUBSTRATES ARE TO EXTEND TO DECK, UNLESS NOTED OTHERWISE.
- D. PROVIDE FULL HEIGHT CORNER GUARDS AND "T" MOLDING AS REQUIRED AT ALL OUTSIDE CORNERS AND PANEL JOINTS. CORNER GUARDS SHOULD BE FOR MATERIAL FINISH SPECIFIED IN FINISH AND MATERIAL SCHEDULES ON SHEET A3.0.
- E. ALL INTERIOR FACE OF EXTERIOR WALLS TO BE COVERED WITH 1/2" GYP BOARD FROM FLOOR TO ROOF DECK TO MEET FLAME SPREAD RATING. ATTACHED W/ 1" TYPE 'S' SCREWS @ 8" O.C. ALONG EDGES, @ 12" O.C. IN THE FIELD OF THE BOARD. JOINTS ORIENTED VERTICALLY AND STAGGERED ON OPPOSITE SIDES OF ASSEMBLY TO BOTTOM OF ROOF DECK.
- F. **ALL SUBSTRATES ARE TO BE APPLIED OVER AND IN ADDITION TO THE WALLBOARD REQUIRED FOR FIRE RATED CONSTRUCTION DESCRIBED ON THIS SHEET.**

SEAL:

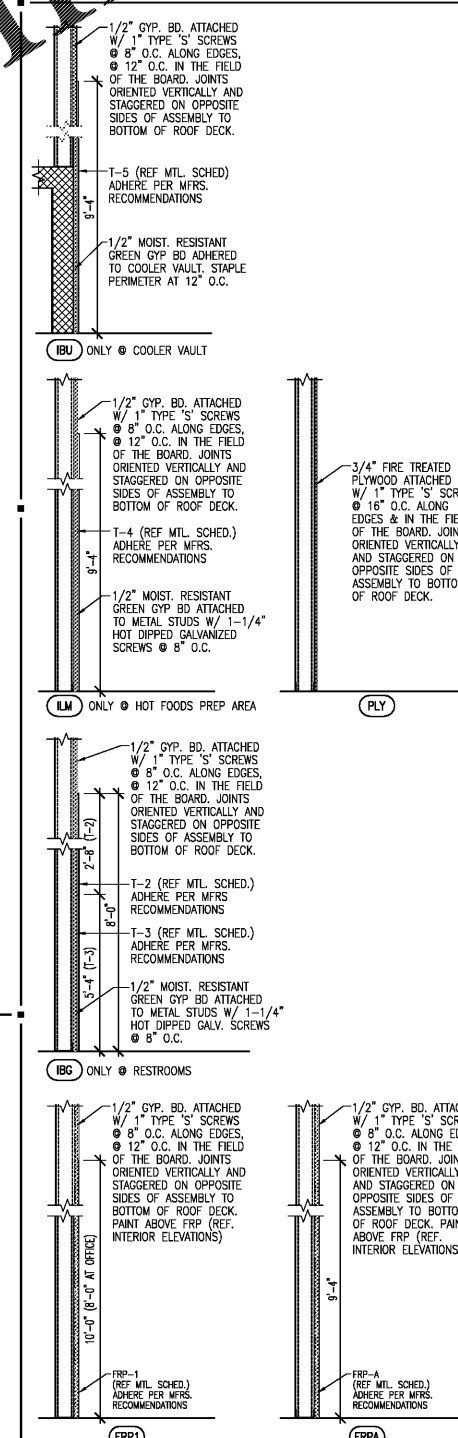

2 07/07/17 PEER REVIEW COMMENTS
1 05/21/17 PEER REVIEW COMMENTS
NO. DATE REMARKS

REVISIONS



BID SET
JANUARY 8, 2018

7-ELEVEN
STORE #32810

5544 RONALD REAGAN PARKWAY
DAVENPORT, FL
33896

PROJECT NO: 2016.0305
DATE: MAY 31, 2017

A2.1
WALL SUBSTRATE - FINISH PLAN

CHECKED: RW DRAWN: JUM

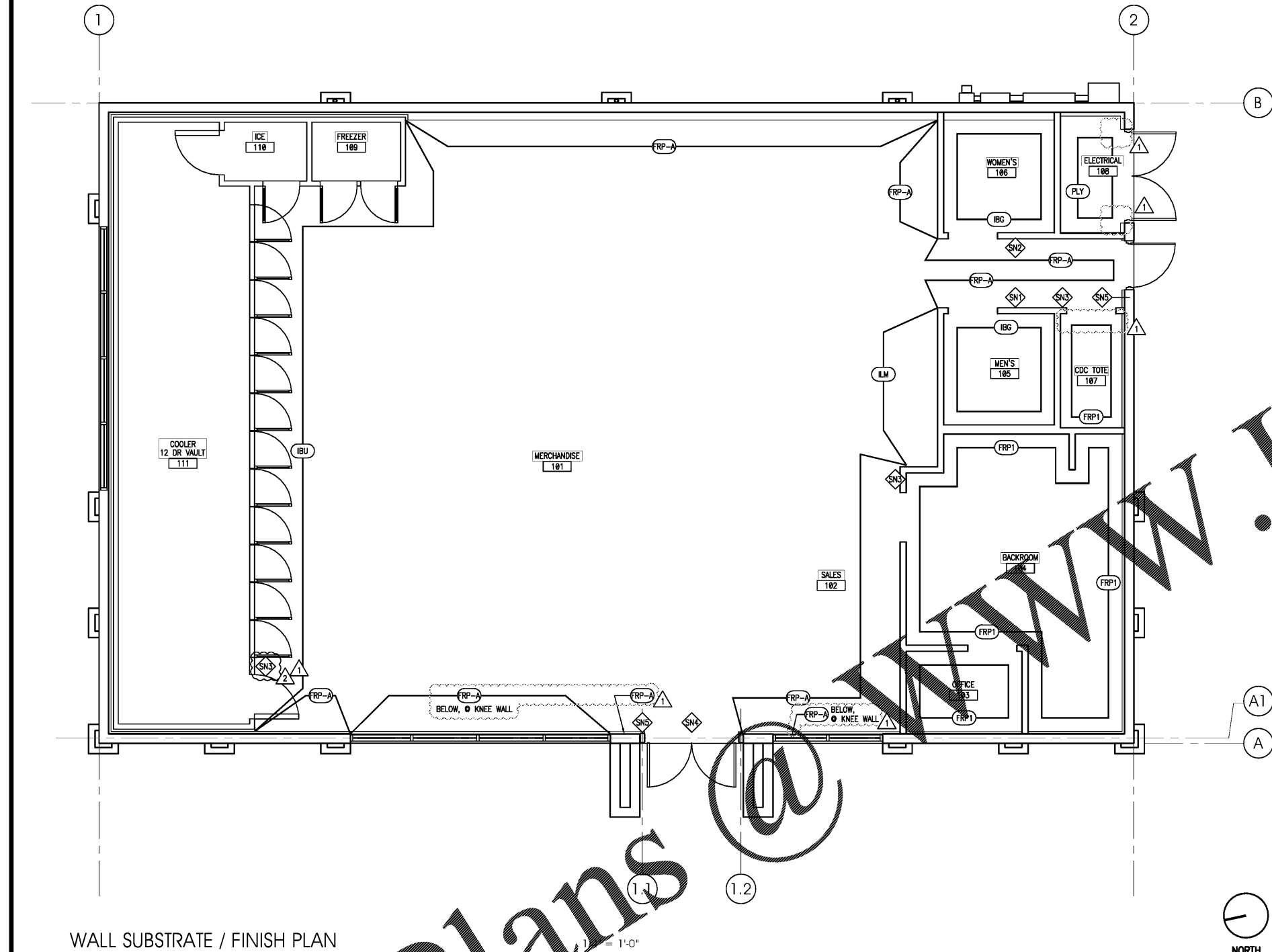

WALL SUBSTRATE / FINISH PLAN

WALL TYPE NOTES

- A. CONTRACTOR SHALL ALLOW FOR DRYWALL CORNER BEADS AND FRP PANELS FOR PROPER FINISHED DIMENSIONS REQUIRED AT CRITICAL DIMENSIONS TO INSTALL EQUIPMENT.
- B. REFER TO SECTIONS AND DETAILS FOR INSULATION THICKNESS AND 'R' RATINGS.
- C. ALL INTERIOR PARTITIONS FULL HEIGHT TO DECK ABOVE (FRAME & GYP BOARD).
- D. ALL GYPSUM BOARD INSTALLED VERTICALLY.

SIGNAGE

- SN1 MEN'S TOILET - SEE THIS SHEET
 - SN2 WOMEN'S TOILET - SEE THIS SHEET
 - SN3 EMPLOYEES ONLY
 - SN4 DOORS TO REMAIN UNLOCKED DURING BUSINESS HOURS
 - SN5 TACTILE EXIT SIGN PER LOCAL LAW
- NOTE: REFER TO EF1 & EF2 DWGS FOR EQUIP. LAYOUT

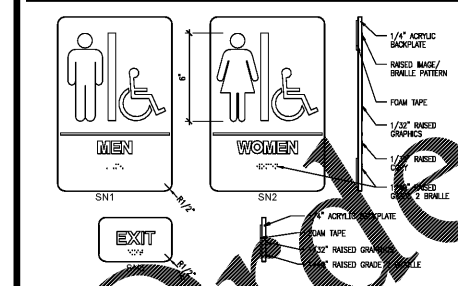

RESTROOM SIGNAGE SPECIFICATIONS

1. LETTERS AND SYMBOLS SHALL BE INKED OR LITHO ON SIGNAGE. SIGN TYPE AND SHALL BE ACCORDING TO GRADE 2 BRILLE. BRILLE CHARACTER HEIGHT SHALL BE AT LEAST 5/8" HIGH, BUT NO HIGHER THAN 2". BRILLE CHARACTER HEIGHT SHALL BE ACCORDING TO THE BRaille INSTRUCTIONS. BRILLE CHARACTER HEIGHT SHALL BE 60% A.F.T. TO THE CENTERLINE OF THE SIGN. BRILLE CHARACTER HEIGHT SHALL BE 60% A.F.T. TO THE CENTERLINE OF THE SIGN. BRILLE CHARACTER HEIGHT SHALL BE 60% A.F.T. TO THE CENTERLINE OF THE SIGN. BRILLE CHARACTER HEIGHT SHALL BE 60% A.F.T. TO THE CENTERLINE OF THE SIGN.
2. THE CHARACTER BACKGROUND OF SIGNS SHALL BE EITHER LIGHT OR DARK BACKGROUND OR DARK BACKGROUND. THE CHARACTER BACKGROUND SHALL BE EITHER LIGHT OR DARK BACKGROUND OR DARK BACKGROUND.
3. WHERE PERMANENT MOUNTING IS PROVIDED, SIGNS SHALL BE INSTALLED ON THE WALL ADJACENT TO THE LATCH SIDE OF THE DOOR. WHERE THERE IS NO WALL SPACE TO THE LATCH SIDE OF THE DOOR, INCLUDING DOUBLE LEAF DOORS, SIGNS SHALL BE INSTALLED ON THE NEAREST ADJACENT WALL. SIGNING HEIGHT SHALL BE 60% A.F.T. TO THE CENTERLINE OF THE SIGN. BRILLE CHARACTER HEIGHT SHALL BE 60% A.F.T. TO THE CENTERLINE OF THE SIGN. BRILLE CHARACTER HEIGHT SHALL BE 60% A.F.T. TO THE CENTERLINE OF THE SIGN.

EXIT / RESTROOM WALL SIGNAGE & SYMBOL DETAIL