

REVISIONS	
#	DATE

A
NEW TOWN
HALL FOR:

THE TOWN OF
NORTH
HIGH
SHOALS

260 HILLSBORO
ROAD

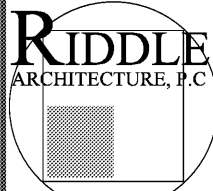

1481 HODGES MILL ROAD
WATKINSVILLE, GA
30677
(404) 285-8646

TITLE: FLOOR
PLAN

JOB #: 1510
DATE: 11.17.17

SHEET #
LSP

HP-1
5 TONS

HP-2
3 TONS

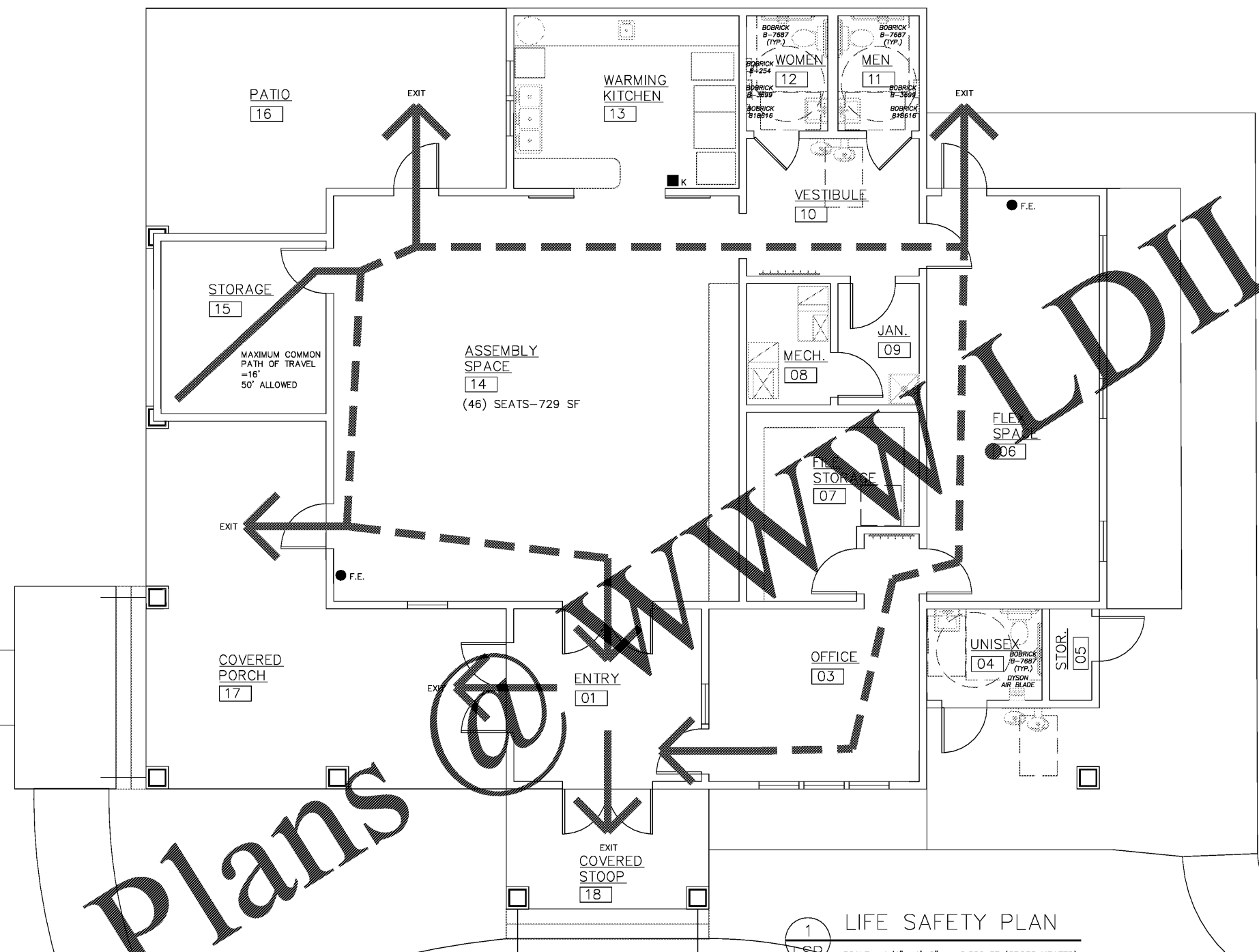

1 LIFE SAFETY PLAN

LSP SCALE: 1/4" = 1'-0" 2,320 SF (GROSS HEATED)
3,561 SF (UNDER ROOF)

- K TYPE K FIRE EXTINGUISHER AS DIRECTED BY COUNTY FIRE MARSHAL'S OFFICE
- F.E. DENOTES PORTABLE FIRE EXTINGUISHER (TYPE 2A10BC) PER NFPA 10. EXACT LOCATIONS PER FIRE MARSHAL'S OFFICE

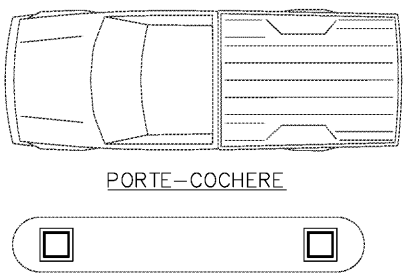
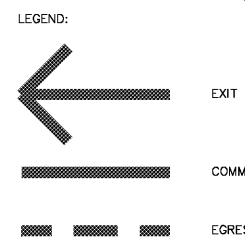

Order Plans