

Order Plans

@

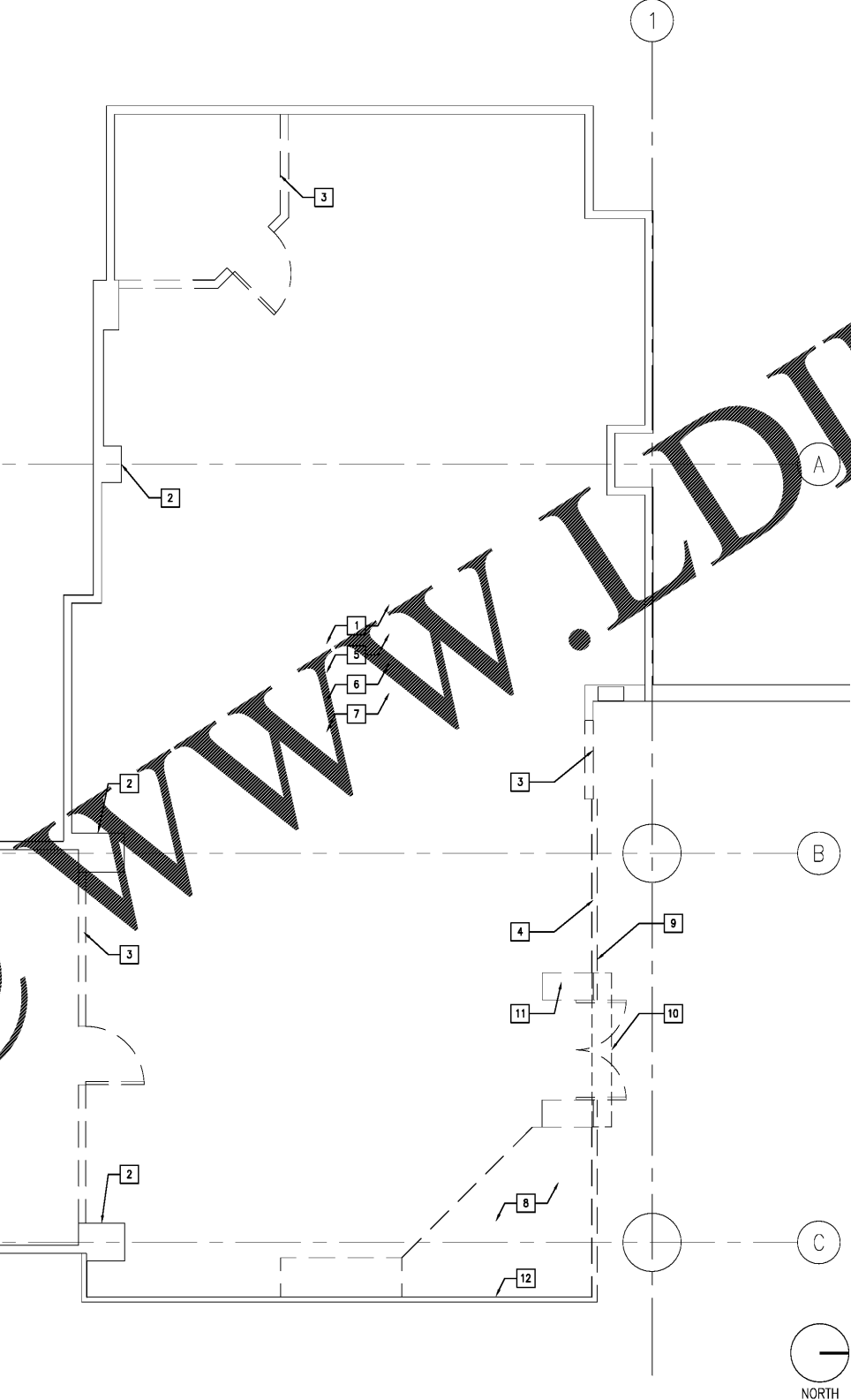

DEMOLITION PLAN

SCALE: 1/4" = 1'-0"

DEMOLITION KEYNOTES: f

1. EXISTING STRUCTURAL CONCRETE FLOOR SYSTEM, PROVIDED BY LANDLORD.
2. EXISTING COLUMN, PROVIDED BY LANDLORD.
3. DEMOLISH EXISTING WALLS AND ASSOCIATED DOORS PER PLAN.
4. REMOVE PORTION OF EXISTING DOOR/WINDOW/GLAZING.
5. REMOVE EXISTING CARPETING PER PLAN. PREP FOR NEW FLOORING.
6. REMOVE ALL EXISTING WALL FINISHES. PATCH/REPAIR GYP AS REQUIRED. REMOVE GYP BO IF DAMAGED BEYOND REPAIR FROM DEMOLITION.
7. REMOVE EXISTING CEILING/SOFFITS IN ITS ENTIRETY (CON. ACT, LIGHTING, ETC). PREP FOR NEW ACT & GYP PER RCP.
8. REMOVE EXISTING RAISED PLATFORM & DECORATIVE PERGOLA STRUCTURE.
9. REMOVE NORTH PORTION OF EXISTING HANDRAIL AS INDICATED.
10. REMOVE EXISTING SIGNAGE BOX.
11. REMOVE EXISTING ENTRY PORTAL IN ITS ENTIRETY.
12. EXISTING GLAZING PROVIDED BY LANDLORD.

INTERPLAN

ARCHITECTURE
ENGINEERING
INTERIOR DESIGN
PROJECT MANAGEMENT

604 COURTLAND STREET
SUITE 100
ORLANDO, FLORIDA 32804
PH 407.645.5008
FX 407.629.9124

SEAL:
THIS DOCUMENT IS NOT FOR CONSTRUCTION
UNLESS THE ARCHITECT OR ENGINEER'S
SIGNATURE AND SEAL APPEAR BELOW.

NO.	DATE	REVISIONS
2	01.04.18	ISSUED/RELEASED FOR CONSTRUCTION
1	12.28.17	LANDLORD COMMENTS

Salata
PEACHTREE CENTER MALL
231 PEACHTREE ST., NE SUITE B14
ATLANTA, GA 30303

PROJECT NO: 2017.0221
DATE: 12.08.2017

D1.0
DEMOLITION PLAN

CHECKED: MW DRAWN: MP

COPYRIGHT © 2017 INTERPLAN, LLC. RESERVE COPYRIGHT & OTHER RIGHTS RESTRICTING THESE DOCUMENTS TO THE ORIGINAL SITE OR PURPOSE FOR WHICH THEY WERE PREPARED. REPRODUCTIONS, CHANGES OR ASSIGNMENTS ARE PROHIBITED.