

Order Plans

WWW.DLINE.COM

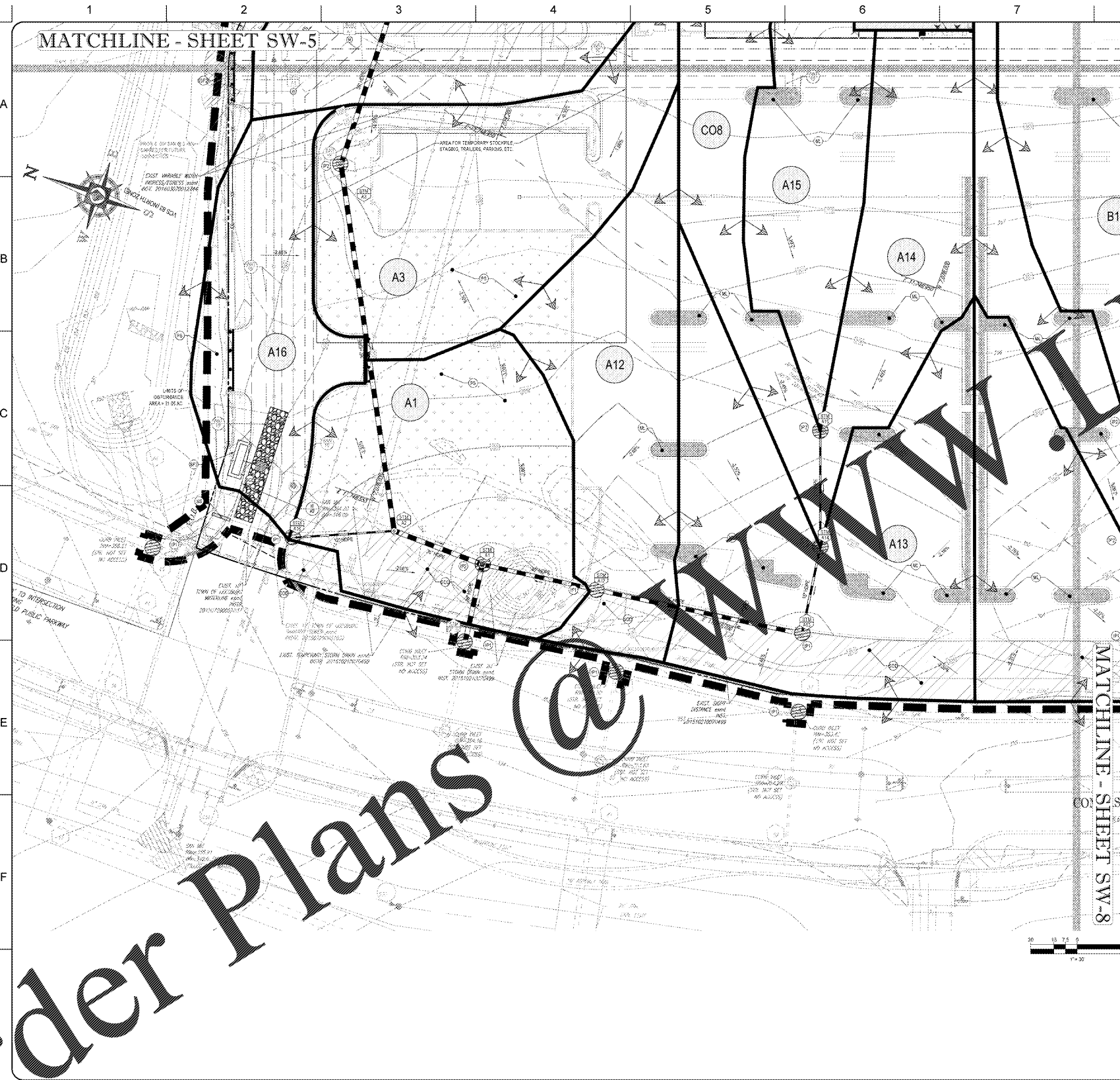

**VIRGINIA UNIFORM CODING SYSTEM FOR EROSION AND SEDIMENT CONTROL PRACTICES**

NO.	TITLE	KEY	SYMBOL
102	TEMPORARY EROSION CONTROL ENTRANCE	(SCE)	[Symbol]
105	SILT FENCE	(SF#)	[Symbol]
106	RAPID CURB	(RC)	[Symbol]
204	BLOCK & GRAVEL CURB WITH SEDIMENT FILTER	(P1)	[Symbol]
205	BLOCK & GRAVEL CURB WITH SEDIMENT FILTER	(P2)	[Symbol]
206	GRAVEL SLOPE TRAP	(GST)	[Symbol]
207	SEDIMENT TRAP	(ST)	[Symbol]
208	SEDIMENT TRAP	(ST)	[Symbol]
209	SEDIMENT TRAP	(ST)	[Symbol]
210	SEDIMENT TRAP	(ST)	[Symbol]
211	SEDIMENT TRAP	(ST)	[Symbol]
212	SEDIMENT TRAP	(ST)	[Symbol]
213	SEDIMENT TRAP	(ST)	[Symbol]
214	SEDIMENT TRAP	(ST)	[Symbol]
215	SEDIMENT TRAP	(ST)	[Symbol]
216	SEDIMENT TRAP	(ST)	[Symbol]
217	SEDIMENT TRAP	(ST)	[Symbol]
218	SEDIMENT TRAP	(ST)	[Symbol]
219	SEDIMENT TRAP	(ST)	[Symbol]
220	SEDIMENT TRAP	(ST)	[Symbol]
221	SEDIMENT TRAP	(ST)	[Symbol]
222	SEDIMENT TRAP	(ST)	[Symbol]
223	SEDIMENT TRAP	(ST)	[Symbol]
224	SEDIMENT TRAP	(ST)	[Symbol]
225	SEDIMENT TRAP	(ST)	[Symbol]
226	SEDIMENT TRAP	(ST)	[Symbol]
227	SEDIMENT TRAP	(ST)	[Symbol]
228	SEDIMENT TRAP	(ST)	[Symbol]
229	SEDIMENT TRAP	(ST)	[Symbol]
230	SEDIMENT TRAP	(ST)	[Symbol]
231	SEDIMENT TRAP	(ST)	[Symbol]
232	SEDIMENT TRAP	(ST)	[Symbol]
233	SEDIMENT TRAP	(ST)	[Symbol]
234	SEDIMENT TRAP	(ST)	[Symbol]
235	SEDIMENT TRAP	(ST)	[Symbol]
236	SEDIMENT TRAP	(ST)	[Symbol]
237	SEDIMENT TRAP	(ST)	[Symbol]
238	SEDIMENT TRAP	(ST)	[Symbol]
239	SEDIMENT TRAP	(ST)	[Symbol]
240	SEDIMENT TRAP	(ST)	[Symbol]
241	SEDIMENT TRAP	(ST)	[Symbol]
242	SEDIMENT TRAP	(ST)	[Symbol]
243	SEDIMENT TRAP	(ST)	[Symbol]
244	SEDIMENT TRAP	(ST)	[Symbol]
245	SEDIMENT TRAP	(ST)	[Symbol]
246	SEDIMENT TRAP	(ST)	[Symbol]
247	SEDIMENT TRAP	(ST)	[Symbol]
248	SEDIMENT TRAP	(ST)	[Symbol]
249	SEDIMENT TRAP	(ST)	[Symbol]
250	SEDIMENT TRAP	(ST)	[Symbol]

**SWPPP UPDATES AND AMENDMENTS**

THE GC MUST UPDATE THE SWPPP, INCLUDING THE JOB SITE MAPS, TO REFLECT THE PROGRESS OF CONSTRUCTION ACTIVITIES AND GENERAL CHANGES TO THE PROJECT SITE. UPDATES SHOULD BE MADE DAILY TO TRACK PROGRESS WHEN ANY OF THE FOLLOWING ACTIVITIES OCCUR: BMP INSTALLATION, MODIFICATION OR REMOVAL, CONSTRUCTION ACTIVITIES (E.G., PAVING, STORM SEWER INSTALLATION, FOOTING INSTALLATION, CLEARING, GRUBBING OR CHANGING, OR TEMPORARY OR PERMANENT STABILIZATION).

**IMPORTANT:** THE GENERAL CONTRACTOR MUST SUBMIT A REQUEST FOR INFORMATION (RFI) TO THE CEC AND OBTAIN WRITTEN CEC APPROVAL BEFORE DOING ANY OF THE FOLLOWING:

1. MODIFYING EROSION OR SEDIMENT CONTROL BMPs (SUBSTITUTIONS ARE TYPICALLY ONLY APPROVED IF SPECIFIED MATERIALS ARE NOT AVAILABLE OR THERE IS A VALID REASON THE SPECIFIED BMP WILL NOT WORK).
2. ACCOMPLISHING EROSION OR SEDIMENT CONTROL BMPs.
3. MODIFYING THE SWPPP IMPLEMENTATION SEQUENCE, OR
4. PERFORMING ANY ACTIONS OR IN ANY MANNER THAT IS CONTRARY TO THE SWPPP.

THE CONTRACTOR MAY MODIFY OR ADD ADDITIONAL BMPs, WITHOUT CEC APPROVAL, IN AN EMERGENCY SITUATION TO PREVENT SEDIMENT DISCHARGE OR PROTECT WATER QUALITY. HOWEVER, GC MUST NOTIFY THE CEC AS SOON AS PRACTICAL AS TO THEIR ACTIONS TO DISCUSS THE NEED FOR ADDITIONAL OR SUPPLEMENTAL MEASURES AND TO OBTAIN THE REQUIRED APPROVALS. THE CONTRACTOR IS ULTIMATELY RESPONSIBLE TO ENSURE COMPLIANCE WITH THE PERMIT AND PROTECTION OF DOWNSTREAM WATER QUALITY.

AMENDING THE SWPPP DOES NOT MEAN THAT IT HAS TO BE REPRINTED. IT IS ACCEPTABLE TO ADD ADDENDA, SKETCHES, NEW SECTIONS, DETAILS, AND/OR REVISED DRAWINGS THAT HAVE THE CEC NAME IN PRINT, ARE STAMPED, SIGNED, DATED, AND ARE ACCOMPANIED BY WRITTEN COPY OF THE ASSOCIATED RFI AND ITS RESPONSE FROM CEC ENGINEERED ITEMS MUST BE SIGNED AND STAMPED BY THE CEC OF RECORD FOR THE PROJECT.

**T.B.M.**  
MAGNAIL LOCATED AT NORTHEAST CORNER OF THE PROPERTY ADJACENT TO LEESBURG EXECUTIVE AIRPORT WITH AN ELEVATION OF 340.38' MVD 95 BASED ON SURVEY CONTROL PROVIDED BY GENBERNY ON MARCH 2, 2015.

**SITE FEATURES**

[Symbol]	ONSITE PROPERTY LINE / R.O.W. LINE
[Symbol]	PROPOSED BUILDING FOOTPRINT
[Symbol]	LIMITS OF DISTURBANCE
[Symbol]	BASEMENT LINE
[Symbol]	EXISTING CONTOUR LINES
[Symbol]	PROPOSED CONTOUR LINES
[Symbol]	EXISTING STORM SEWER
[Symbol]	SOIL BOUNDARY
[Symbol]	LIMITS OF DRAINAGE SUB-BASIN
[Symbol]	SLOPE ARROW

**DEVELOPER/OWNER:**  
WAL-MART REAL ESTATE BUSINESS TRUST  
MAIL STOP 5570  
2001 SE 10TH STREET  
BENTONVILLE, AR  
72716-5570  
479-204-3314

**SITE OPERATOR/GENERAL CONTRACTOR:**  
WAL-MART STORES, INC.  
BENTONVILLE, AR

**SUPERINTENDENT:**

**REVISIONS**

NO.	DATE	DESCRIPTION
1		REVISED PER COUNTY AND TOWN COMMENTS
2		REVISED PER COUNTY AND TOWN COMMENTS
3		REVISED PER COUNTY AND TOWN COMMENTS

**BOHLER ENGINEERING**  
22838 DAVIS DRIVE, SUITE 250  
STERLING, VIRGINIA 20164  
Phone: (703) 705-5500  
Fax: (703) 705-8501  
VA@BohlerEng.com

**PHASE II EROSION AND SEDIMENT CONTROL PLAN**  
WALMART SUPERCENTER #1904-005 - SPAM #1  
CATOCTIN ELECTION DISTRICT,  
LEESBURG, LOUDOUN COUNTY, VA  
WAL-MART STORES, INC.  
BENTONVILLE, AR

DRAWN	GRP
CHECKED	MJB
DATE	12/22/16
SCALE	1" = 30'
JOB NO.	S148000
SHEET	SW-7

SHEET 41 OF 103