

Order Plans @ www.dline.com

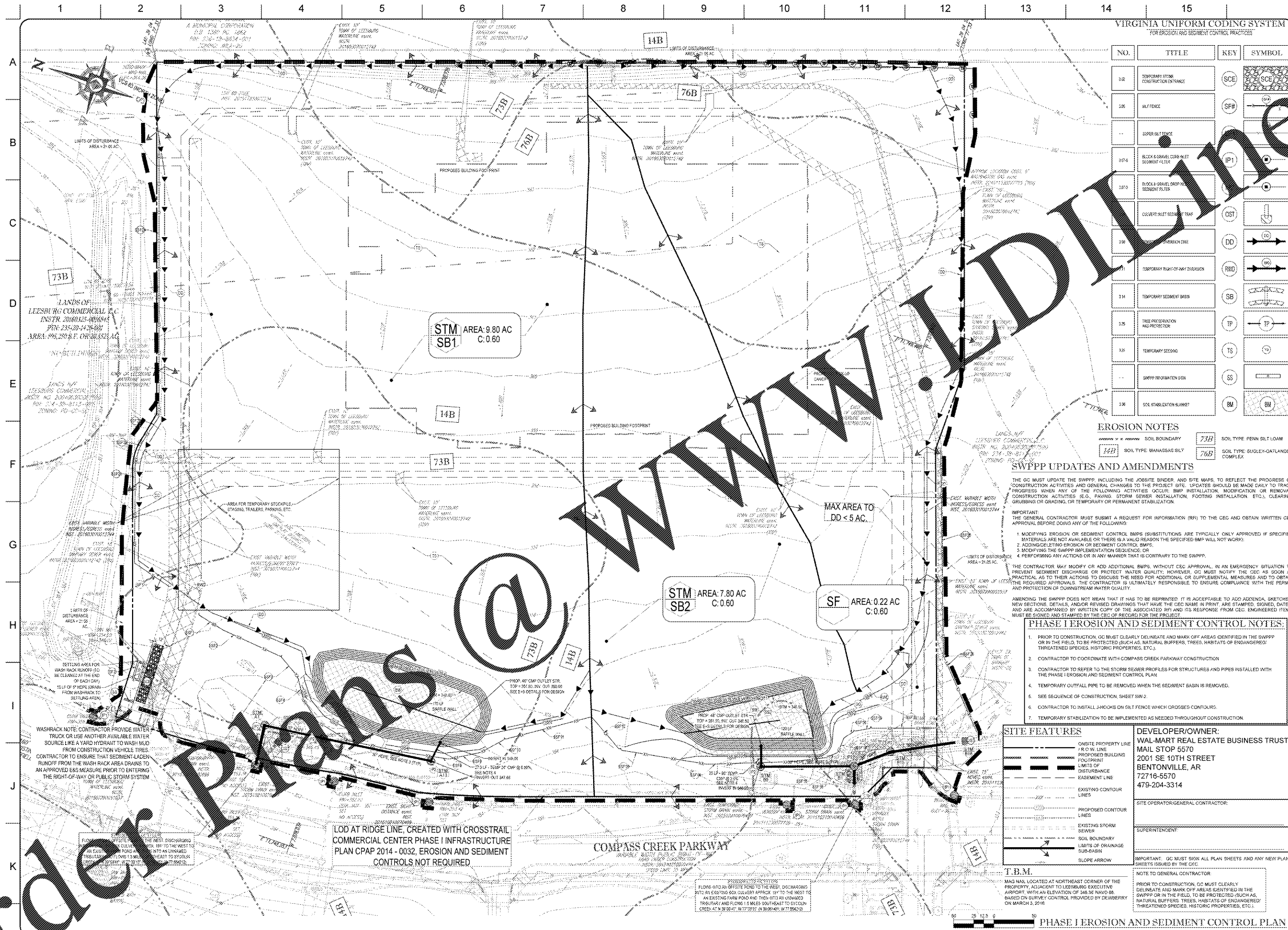

VIRGINIA UNIFORM CODING SYSTEM FOR EROSION AND SEDIMENT CONTROL PRACTICES

NO.	TITLE	KEY	SYMBOL
102	TEMPORARY SITING CONSTRUCTION ENTRANCE	SCE	[Symbol]
106	ALTITUDE	SPE	[Symbol]
107	SUPER ALTITUDE	SAP	[Symbol]
1074	SOIL & SLOPE COVER BUILT SEDIMENT FENCE	IP1	[Symbol]
1073	SOIL & SLOPE DROP SEDIMENT FILTER	[Symbol]	[Symbol]
1075	COVERT BUILT SEDIMENT FENCE	OST	[Symbol]
109	ROADWAY DRAIN	DD	[Symbol]
11	TEMPORARY POINT OF DIVERSION	RID	[Symbol]
114	TEMPORARY SEDIMENT BASIN	SB	[Symbol]
135	TREE PROTECTION AND PROTECTIVE	TP	[Symbol]
136	TEMPORARY SEEDING	TS	[Symbol]
137	SWPPP REFORMATION SOIL	SS	[Symbol]
138	SOIL STABILIZATION SLURRY	SM	[Symbol]

EROSION NOTES

- 73B SOIL TYPE PENN SILT LOAM
- 14B SOIL TYPE MANASSAS SILT
- 76B SOIL TYPE GUILFORD-LANGLIS COMPLEX

SWPPP UPDATES AND AMENDMENTS

THE GC MUST UPDATE THE SWPPP INCLUDING THE JOBSITE BINDER AND SITE MAPS, TO REFLECT THE PROGRESS OF CONSTRUCTION ACTIVITIES AND GENERAL CHANGES TO THE PROJECT SITE. UPDATES SHOULD BE MADE DAILY TO TRACK PROGRESS WHEN ANY OF THE FOLLOWING ACTIVITIES OCCUR: BMP INSTALLATION, MODIFICATION OR REMOVAL, CONSTRUCTION ACTIVITIES (E.G., PAVING, STORM SEWER INSTALLATION, FOOTINGS INSTALLATION, ETC.), CLEARING, GRUBBING OR GRADING, OR TEMPORARY OR PERMANENT STABILIZATION.

IMPORTANT: THE GENERAL CONTRACTOR MUST SUBMIT A REQUEST FOR INFORMATION (RFI) TO THE CEC AND OBTAIN WRITTEN CEC APPROVAL BEFORE DOING ANY OF THE FOLLOWING:

1. MODIFYING EROSION OR SEDIMENT CONTROL BARRIERS (SUBSTITUTIONS ARE TYPICALLY ONLY APPROVED IF SPECIFIED MATERIALS ARE NOT AVAILABLE OR THERE IS A VALID REASON THE SPECIFIED BMP WILL NOT WORK);
2. ADDING NEW EROSION OR SEDIMENT CONTROL BARRIERS;
3. MODIFYING THE SWPPP IMPLEMENTATION SEQUENCE; OR
4. PERFORMING ANY ACTIONS OR PLANNING ACTIONS THAT ARE CONTRARY TO THE SWPPP.

THE CONTRACTOR MAY MODIFY OR ADD ADDITIONAL BMPs WITHOUT CEC APPROVAL IN AN EMERGENCY SITUATION TO PREVENT SEDIMENT DISCHARGE OR PROTECT WATER QUALITY. HOWEVER, GC MUST NOTIFY THE CEC AS SOON AS PRACTICAL AS TO THEIR ACTIONS TO DISCUSS THE NEED FOR ADDITIONAL OR SUPPLEMENTAL MEASURES AND TO OBTAIN THE REQUIRED APPROVALS. THE CONTRACTOR IS ULTIMATELY RESPONSIBLE TO ENSURE COMPLIANCE WITH THE PERMIT AND PROTECTION OF DOWNSTREAM WATER QUALITY.

AMENDING THE SWPPP DOES NOT MEAN THAT IT HAS TO BE REPRINTED. IT IS ACCEPTABLE TO ADD APPENDIX, SKETCHES, NEW SECTIONS, DETAILS, AND/OR REVISED DRAWINGS THAT HAVE THE CEC NAME IN PRINT ARE STAMPED, DATED, AND ARE ACCOMPANIED BY WRITTEN COPY OF THE ASSOCIATED RFI AND ITS RESPONSE FROM CEC. ENGINEERED ITEMS MUST BE SIGNED AND STAMPED BY THE CEC AS REQUIRED FOR THE PROJECT.

PHASE I EROSION AND SEDIMENT CONTROL NOTES:

1. PRIOR TO CONSTRUCTION, GC MUST CLEARLY DELINEATE AND MARK OFF AREAS IDENTIFIED IN THE SWPPP OR IN THE FIELD TO BE PROTECTED (SUCH AS NATURAL BARRIERS, TREES, HABITATS OF ENDANGERED/THREATENED SPECIES, HISTORIC PROPERTIES, ETC.).
2. CONTRACTOR TO COORDINATE WITH COMPASS CREEK PARKWAY CONSTRUCTION.
3. CONTRACTOR TO REFER TO THE STORM SEWER PROFILES FOR STRUCTURES AND PIPES INSTALLED WITH THE PHASE I EROSION AND SEDIMENT CONTROL PLAN.
4. TEMPORARY OUTFALL PIPE TO BE REMOVED WHEN THE SEDIMENT BASIN IS REMOVED.
5. SEE SEQUENCE OF CONSTRUCTION, SHEET SW-2.
6. CONTRACTOR TO INSTALL HOOKS ON SILT FENCE WHICH CROSS CONTOURS.
7. TEMPORARY STABILIZATION TO BE IMPLEMENTED AS NEEDED THROUGHOUT CONSTRUCTION.

SITE FEATURES

- ON-SITE PROPERTY LINE
- PROPOSED BUILDING FOOTPRINT
- LIMITS OF DISTURBANCE
- EXISTING CONTOUR LINES
- PROPOSED CONTOUR LINES
- EXISTING STORM SEWER
- SOIL BOUNDARY
- LIMITS OF ORANGE SUB-BASIN
- SLOPE ARROW

DEVELOPER/OWNER:

WAL-MART REAL ESTATE BUSINESS TRUST
MAIL STOP 6570
2001 SE 10TH STREET
BENTONVILLE, AR
72716-5570
479-204-3314

NOTE TO GENERAL CONTRACTOR:

IMPORTANT: GC MUST SIGN ALL PLAN SHEETS AND ANY NEW PLAN SHEETS ISSUED BY THE CEC.

PRIOR TO CONSTRUCTION, GC MUST CLEARLY DELINEATE AND MARK OFF AREAS IDENTIFIED IN THE SWPPP OR IN THE FIELD TO BE PROTECTED (SUCH AS NATURAL BARRIERS, TREES, HABITATS OF ENDANGERED/THREATENED SPECIES, HISTORIC PROPERTIES, ETC.).

REVISIONS

NO.	DATE	DESCRIPTION
1		
2		
3		
4		
5		
6		
7		
8		
9		
10		
11		
12		
13		
14		
15		

BOHLER ENGINEERING
22638 DAVIS DRIVE, SUITE 260
STERLING, VIRGINIA 20164
Phone: (703) 706-6500
Fax: (703) 706-6501
VA@BohlerEng.com

PHASE I EROSION AND SEDIMENT CONTROL PLAN
WALMART SUPERCENTER #1904-005 - SPAM #1
CATOCTIN ELECTION DISTRICT,
LEESBURG, LOUDOUN COUNTY, VA

Walmart
WAL-MART STORES, INC.
BENTONVILLE, AR

DRAWN	GRP
CHECKED	MJB
DATE	12/22/16
SCALE	1" = 50'
JOB NO.	5149000
SHEET	SW-3
SHEET 37 OF 103	