

Order Plans @ www.LDILine.com

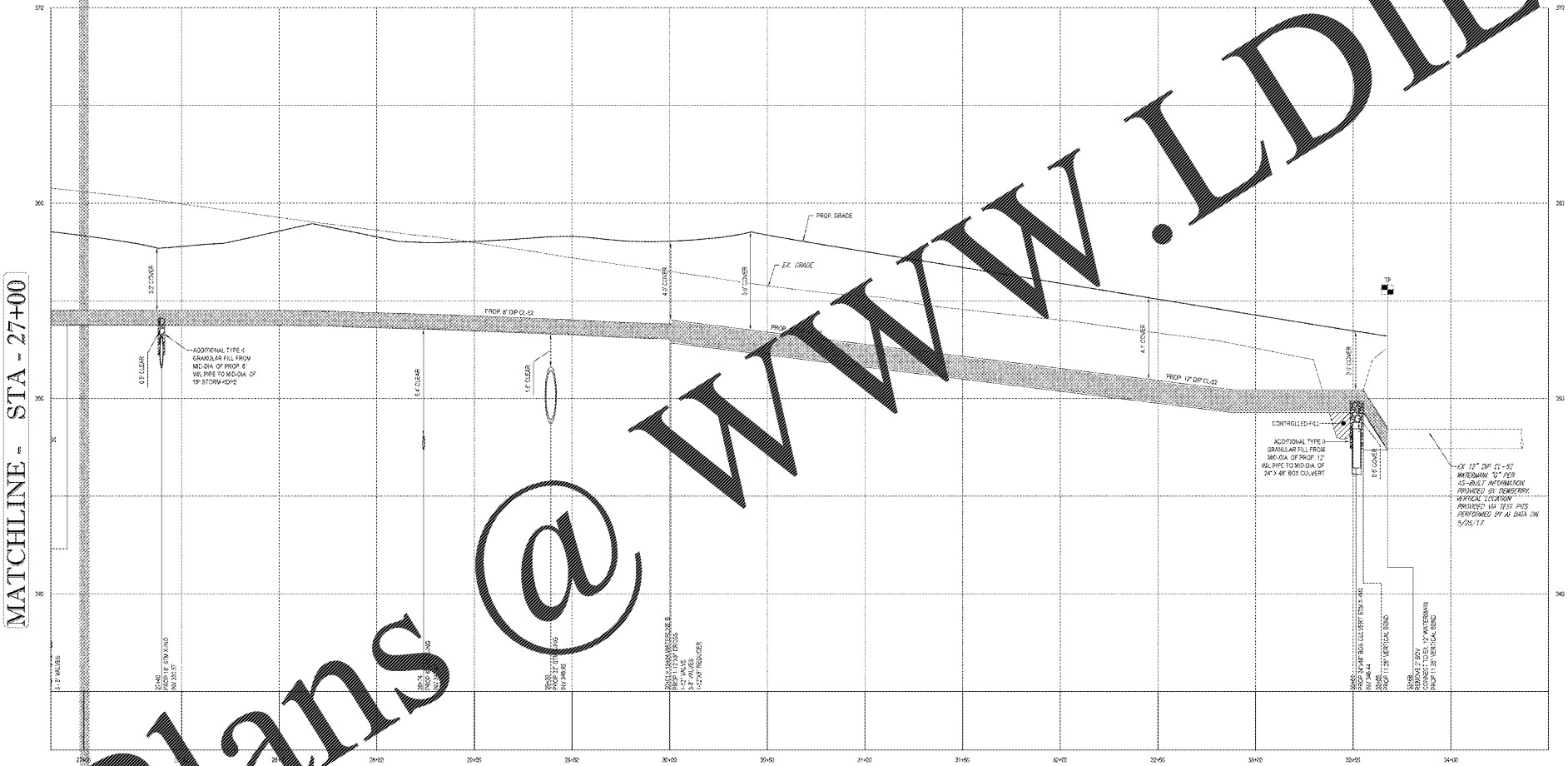

PROPOSED WATERLINE 'A' PROFILE
SCALE: 1"=30' HORIZONTAL
1"=4' VERTICAL

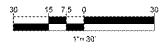

FOR CONSTRUCTION AND INSTALLATION NOTES,
SEE UTILITY PLAN SHEETS C-16 TO C-19.

REVISIONS	BY
△ REVISED PER COUNTY AND TOWN COMMENTS	
△ REVISED PER COUNTY AND TOWN COMMENTS	
△ REVISED PER COUNTY AND TOWN COMMENTS	
△	
△	
△	

THE FOLLOWING STATE REGISTRATION INFORMATION IS FOR INFORMATIONAL PURPOSES ONLY. IT IS NOT A GUARANTEE OF THE QUALITY OF THE SERVICES PROVIDED BY BOHLER ENGINEERING. BOHLER ENGINEERING IS NOT A PROFESSIONAL ENGINEERING FIRM IN THE STATE OF VIRGINIA. BOHLER ENGINEERING IS A LIMITED LIABILITY COMPANY UNDER THE LAWS OF THE STATE OF VIRGINIA. BOHLER ENGINEERING IS NOT A MEMBER OF THE NATIONAL SOCIETY OF PROFESSIONAL ENGINEERS.

BOHLER ENGINEERING
22636 DAVIS DRIVE, SUITE 260
STERLING, VIRGINIA 20154
Phone: (703) 709-0503
Fax: (703) 709-9501
VA@BohlerEng.com

WATER PROFILES
WALMART SUPERCENTER #1904-005 - SPAM #1
CATOCTIN ELECTION DISTRICT
LEESBURG, LOUDOUN COUNTY, VA
WAL-MART STORES, INC.
BENTONVILLE, AR

DRAWN	DRB
CHECKED	MJB
DATE	12/22/16
SCALE	AS SHOWN
JOB NO.	S148200
SHEET	

C-28

SHEET 32 OF 103